

SPECIFICATION CONTROL DRAWING

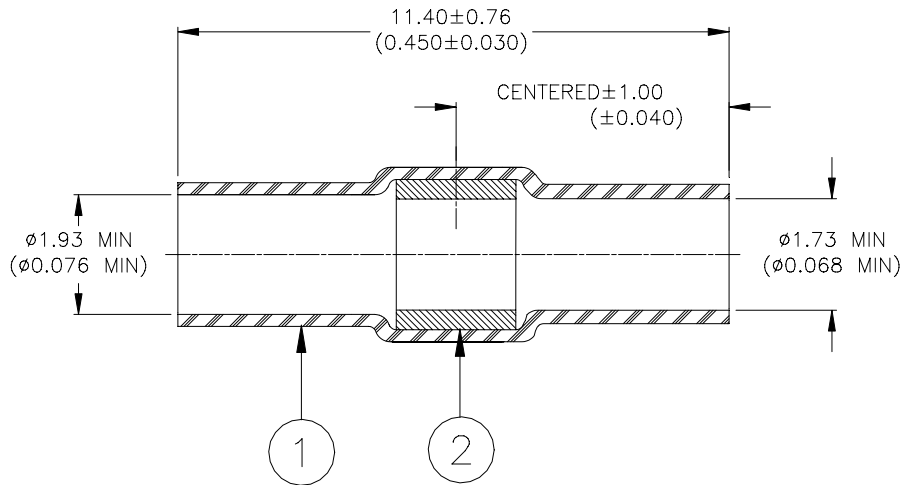

MATERIALS

1. **INSULATION SLEEVE:** Heat-shrinkable, transparent blue, radiation cross-linked polyvinylidene fluoride.
2. **SOLDER PREFORM WITH FLUX:**
 SOLDER: TYPE Sn63 per ANSI-J-STD-006.
 FLUX: TYPE ROL1 per ANSI-J-STD-004.

APPLICATION

1. This part is designed to be used in making a one-to-one in-line splice in wires having tin or silver-plated conductors and insulations rated for at least 125°C.
 Wire Accommodation:
 CMA Range: 500 to 950
 Jacket Diameter: 0.76 to 1.65 (0.030 to 0.065)
2. Wires are to be stripped 3.81 to 5.08 (0.150 to 0.200) and centered under solder preform.
3. Part may be installed with Raychem hot-air or infrared heaters.

tyco / Electronics / Raychem <small>307 Constitution Drive Menlo Park, CA 94025, USA</small>		Wire and Harnessing Products	TITLE: SOLDERSLEEVE WIRE SPLICE				
<small>UNLESS OTHERWISE SPECIFIED DIMENSIONS ARE IN MILLIMETERS. INCHES DIMENSIONS ARE BETWEEN BRACKETS.</small>			DOCUMENT NO.: D-110-0124				
<small>TOLERANCES: 0.00 N/A 0.0 N/A 0 N/A</small>	<small>ANGLES: N/A ROUGHNESS IN MICRON</small>	<small>Tyco Electronics reserves the right to amend this drawing at any time. Users should evaluate the suitability of the product for their application.</small>	<small>DCR NUMBER: D010096</small>	<small>REPLACES: N/A</small>			
<small>DRAWN BY: M. FORONDA</small>	<small>DATE: 04-Apr.-01</small>	<small>PROD. REV. A</small>	<small>DOC ISSUE: 1</small>	<small>SCALE: None</small>	<small>SIZE: A</small>	<small>SHEET: 1 of 1</small>	

If this document is printed it becomes uncontrolled. Check for the latest revision.

单击下面可查看定价，库存，交付和生命周期等信息

[>>TE Connectivity\(泰科\)](#)