

THIS DRAWING IS UNPUBLISHED. RELEASED FOR PUBLICATION
 © COPYRIGHT BY TYCO ELECTRONICS CORPORATION. ALL RIGHTS RESERVED.

LOC	DIST	REVISIONS					
GP	00	P	LTR	DESCRIPTION	DATE	DWN	APVD
			C1	REVISED	27MAY2020	CZ	SZ

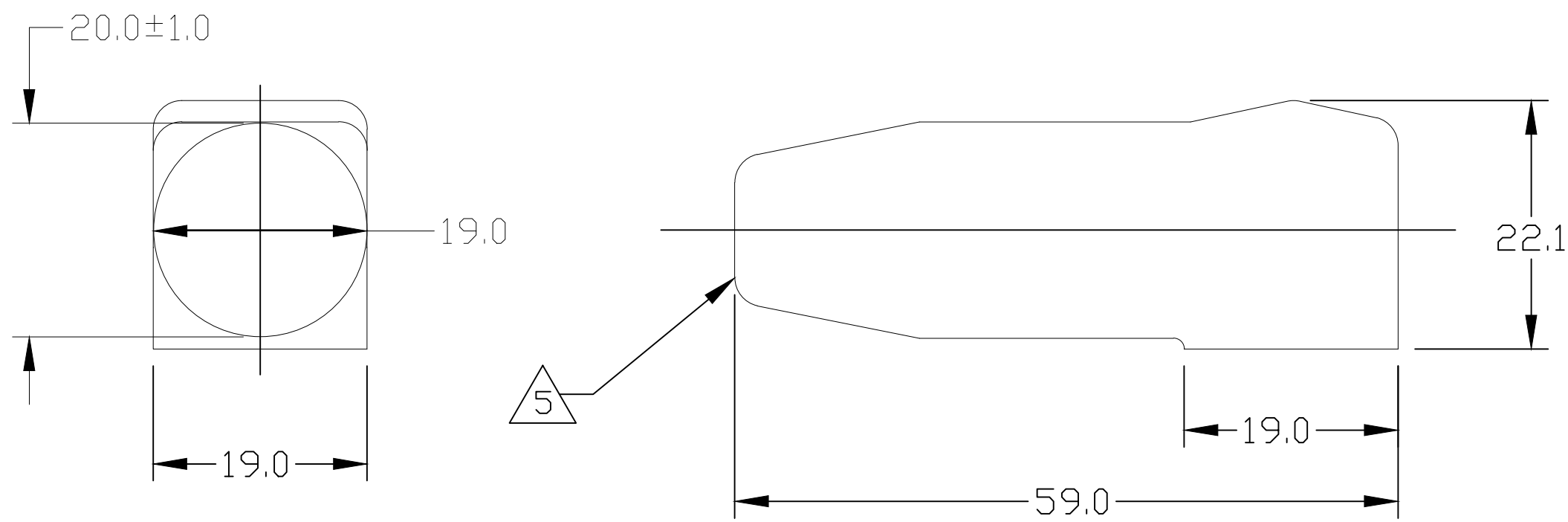

- 5 CABLE ENTRY OF BOOT IS MOULDED SOLID AND CROPPED TO SUIT CABLE USED BY CUSTOMER.
1. PART NUMBER CHANGES AND OR DESIGN CHANGES AFFECTING ITEM INTERCHANGEABILITY REQUIRE PRIOR TYCO APPROVAL AND AUTHORIZATION BY REVISION TO THIS DRAWING.
 2. ITEMS PROVIDED TO THIS SPECIFICATION SHALL BE IDENTIFIED ON THE CONTAINER WITH THE FOLLOWING INFORMATION: PART NUMBER & DATE CODE OF MANUFACTURE.
 3. FINISH: GLOSSY, CLEAN WITH NO INTERNAL & EXTERNAL BURRS.
 4. MATERIAL: ALL COLORS TO BE FIRE RETARDANT GRADE PVC 55 SHORE A, RATED TO UL94V-0. COLORS: SEE TABLE

1766600-4	BLUE
1766600-3	GREY
1766600-2	RED
1766600-1	BLACK
TYCO PN:	COLOR

ELCON RAPID LOCK

THIS DRAWING IS A CONTROLLED DOCUMENT.		DWN	16FEB05	Tyco Electronics Corporation		
		CHK	M.C.CANT/GRZYBOWSKI	Harrisburg, PA 17105-3608		
DIMENSIONS: mm		APVD	25FEB05	NAME		
TOLERANCES UNLESS OTHERWISE SPECIFIED:		PRODUCT SPEC	D.CHAU	INSULATION BOOT		
0 PLC ± -		APPLICATION SPEC	-	SIZE #2		
1 PLC ± .5		SIZE	A3	CAGE CODE	00779	DRAWING NO
2 PLC ± .25		RESTRICTED TO	C-1766600			
3 PLC ± -		SCALE	1:1			
4 PLC ± -		SHEET	1 OF 1			
ANGLES ± .5		REV	C1			
MATERIAL	FINISH	WEIGHT	CUSTOMER DRAWING			
-	-	-				

单击下面可查看定价，库存，交付和生命周期等信息

[>>TE Connectivity\(泰科\)](#)