

LOC	QTY	REV	DATE	BY	APPV
CM	53				

REVISIONS					
REV	DESCRIPTION	DATE	BY	APPV	
C	REV & REDWN PER EC 0L30-0270-97	12-11-97	KW	RS	

AMP LOGO AND CAVITY NUMBER LOCATED THIS SURFACE.

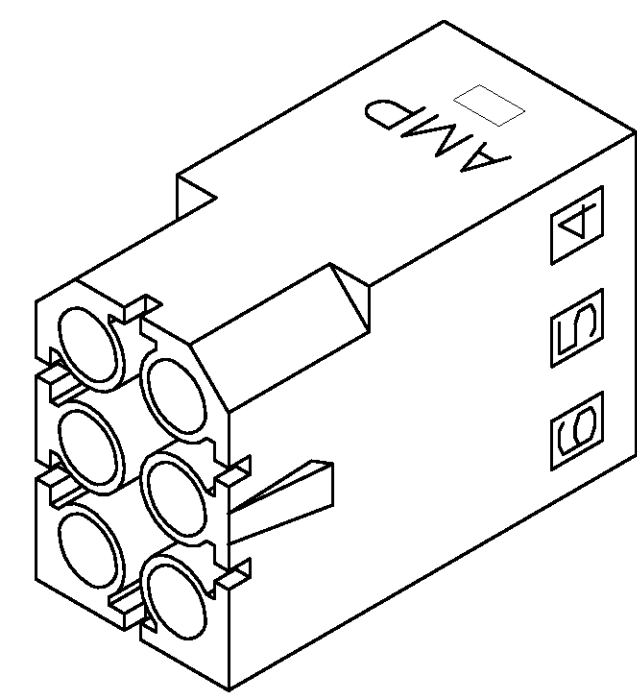
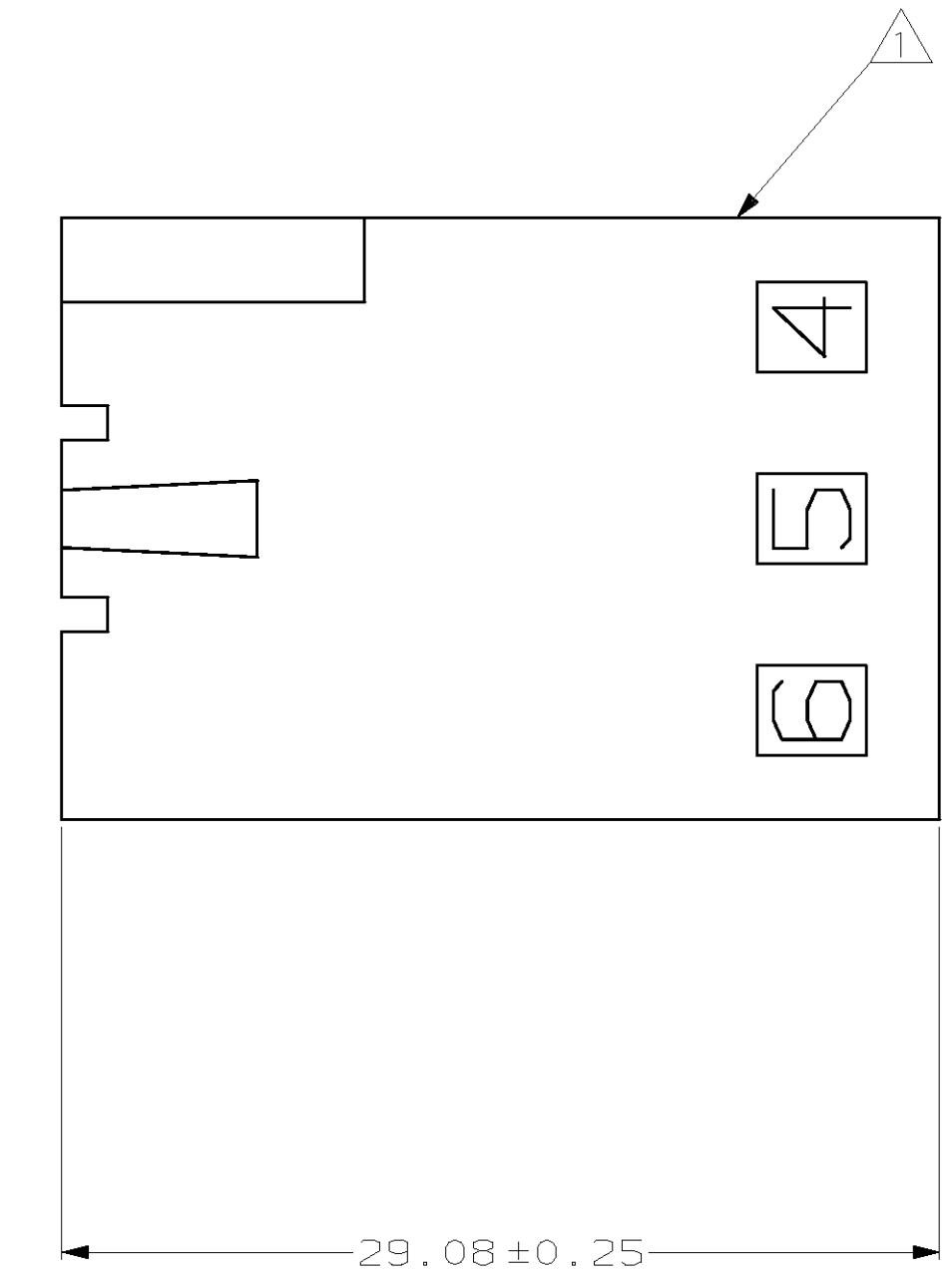
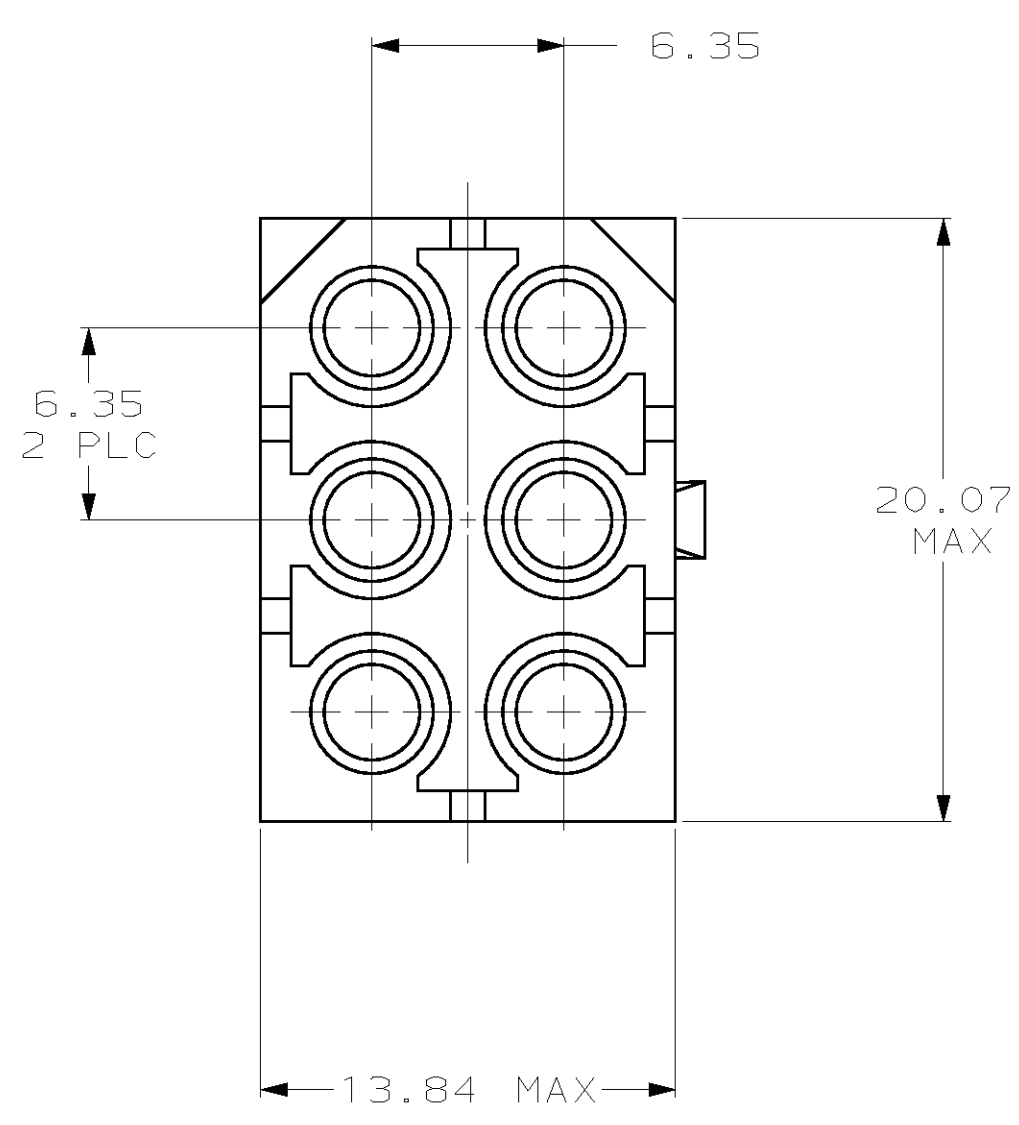
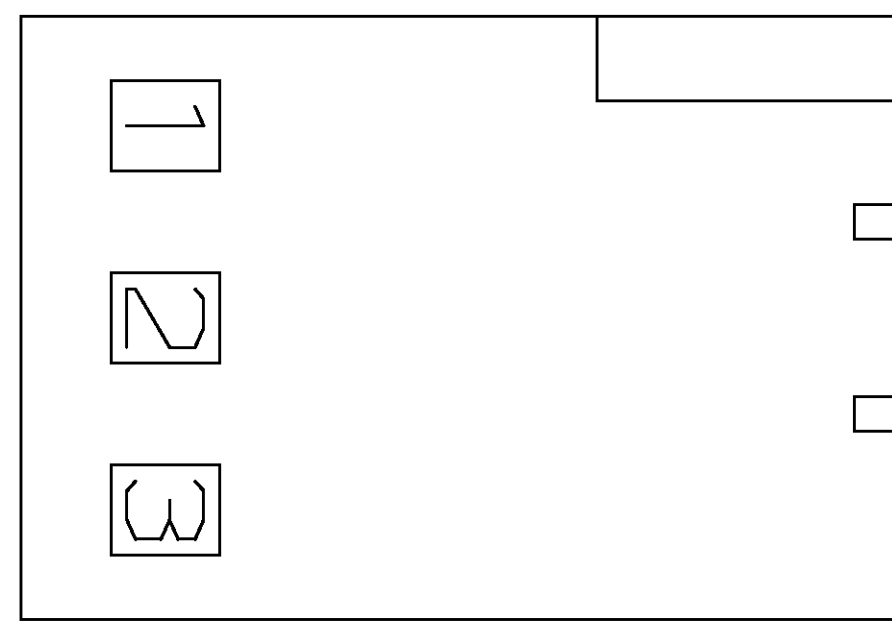

3-DIMENSIONAL MODEL
NTS

MM	IN
29.08	1.145
20.07	.790
13.84	.545
6.35	.250
0.25	.010
0.13	.005

CONVERSION TABLE

770360-1
PART NUMBER

METRIC

THIS DRAWING IS A CONTROLLED DOCUMENT.		OWN: K. WHITAKER 12-11-97	AMP Incorporated Harrisburg, PA 17105-3608
DIMENSIONS: mm		CHK: R. SWING 12-11-97	
TOLERANCES UNLESS OTHERWISE SPECIFIED:		APVD: K. CORLE 12-11-97	NAME: RECEPTACLE, 6 CIRCUIT, .250 PIN AND SOCKET
0 PLC ± 1 PLC ± 2 PLC ±0.13 3 PLC ± 4 PLC ± ANGLES ±		PRODUCT SPEC: -	RESTRICTED TO: -
MATERIAL: NYLON, UL 94V-2, NATURAL		FINISH: -	HEIGHT: -
CUSTOMER DRAWING		SCALE: 4:1	SHEET 1 OF 1 REV C

单击下面可查看定价，库存，交付和生命周期等信息

[>>TE Connectivity\(泰科\)](#)