

REVISIONS				
P.	LTN	DESCRIPTION	DATE	APVD
1		PROPOSAL	18OCT2018	SZ SZ

NOTES, UNLESS OTHERWISE SPECIFIED  
 1. MATERIAL:  
 HOUSING - THERMOPLASTIC, GLASS PREINFORCED, COLOR, BLACK, UL 94V-0  
 CONTACTS- COPPER ALLOY.  
 2. FINISH:  
 MATING AREA - NOBLE METAL OVERALL NICKEL.  
 SOLDER TAIL - MATTE TIN OVERALL NICKEL.  
 ⚠️ MARK P/N AND DATA CODE IN APPROX. AREA AS SHOWN.

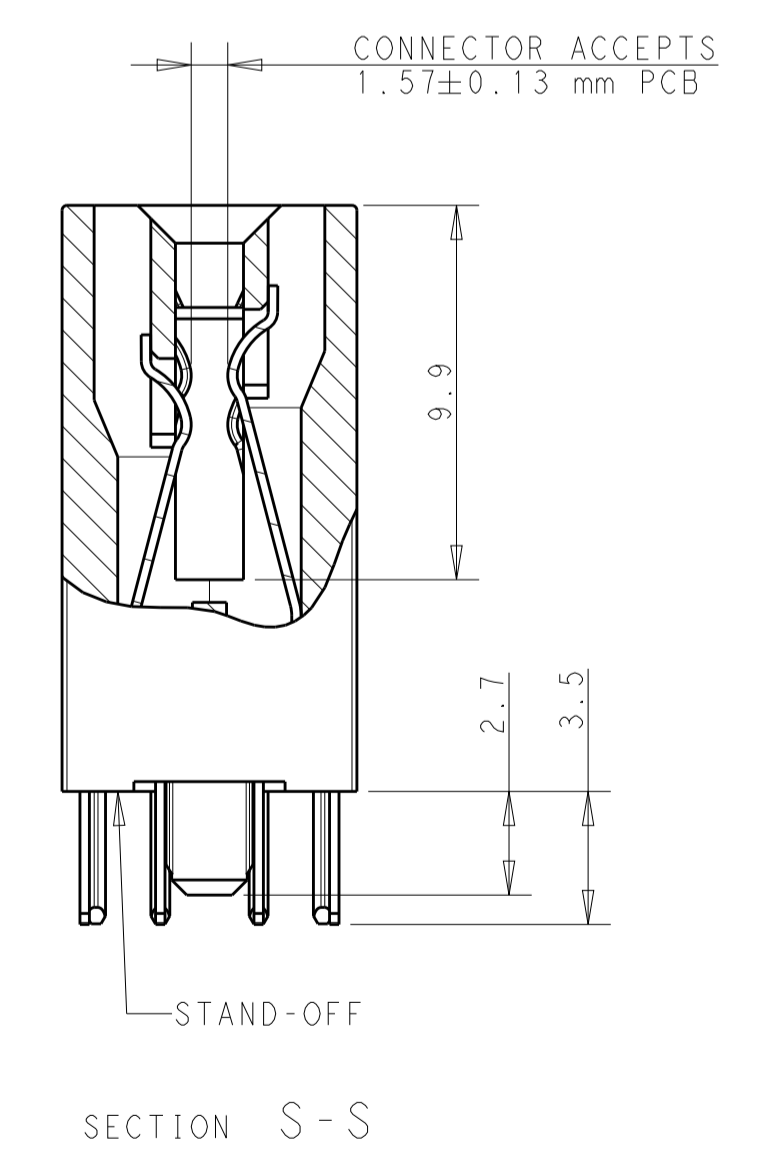
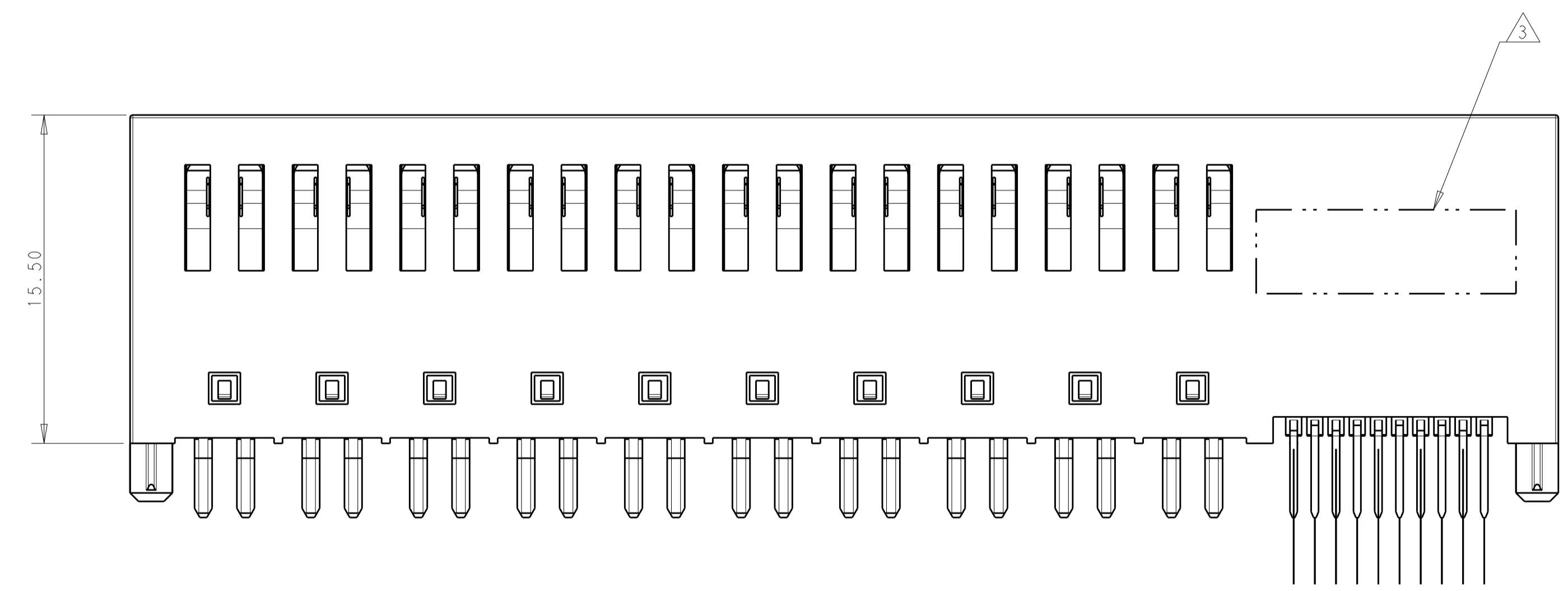
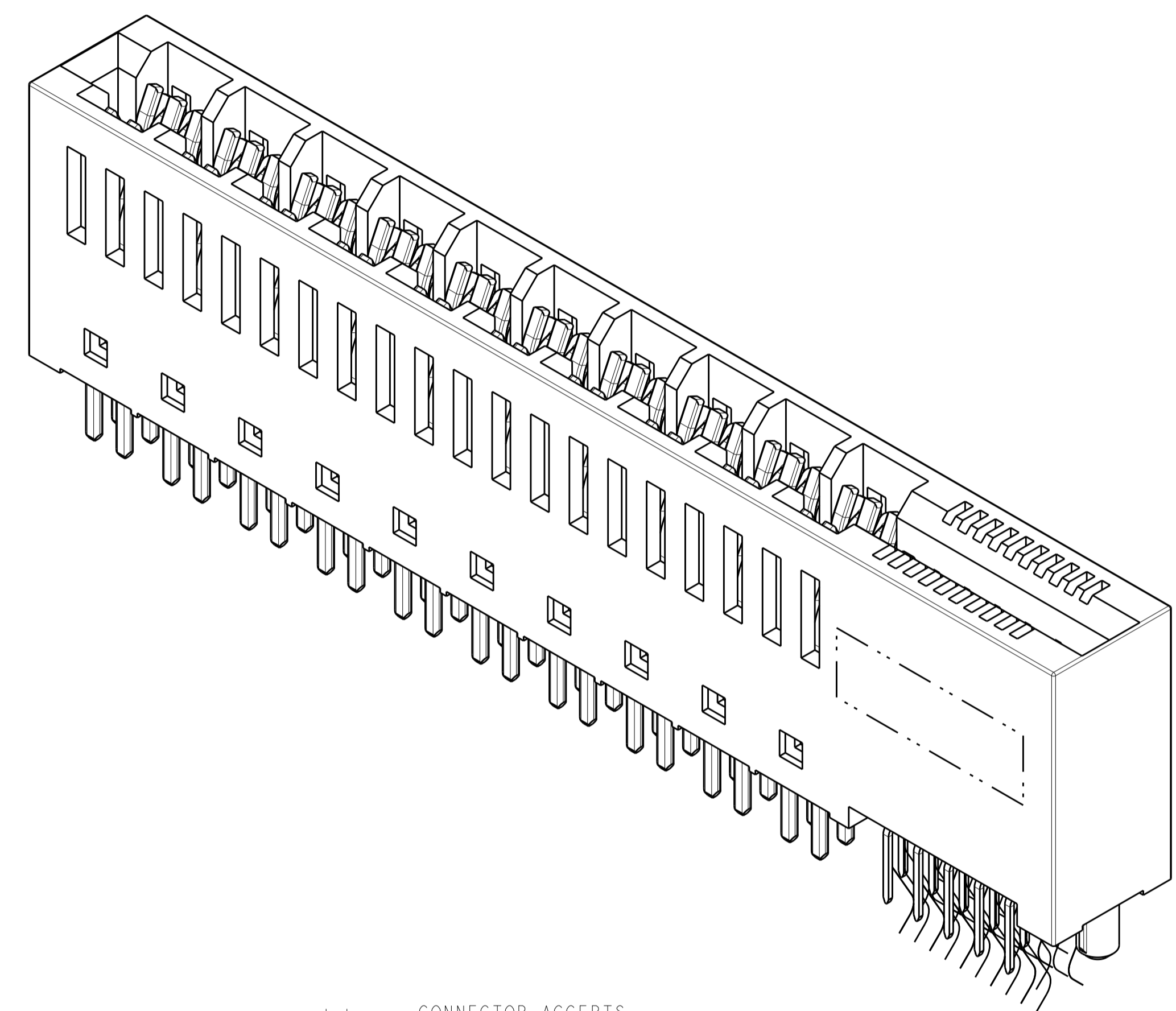
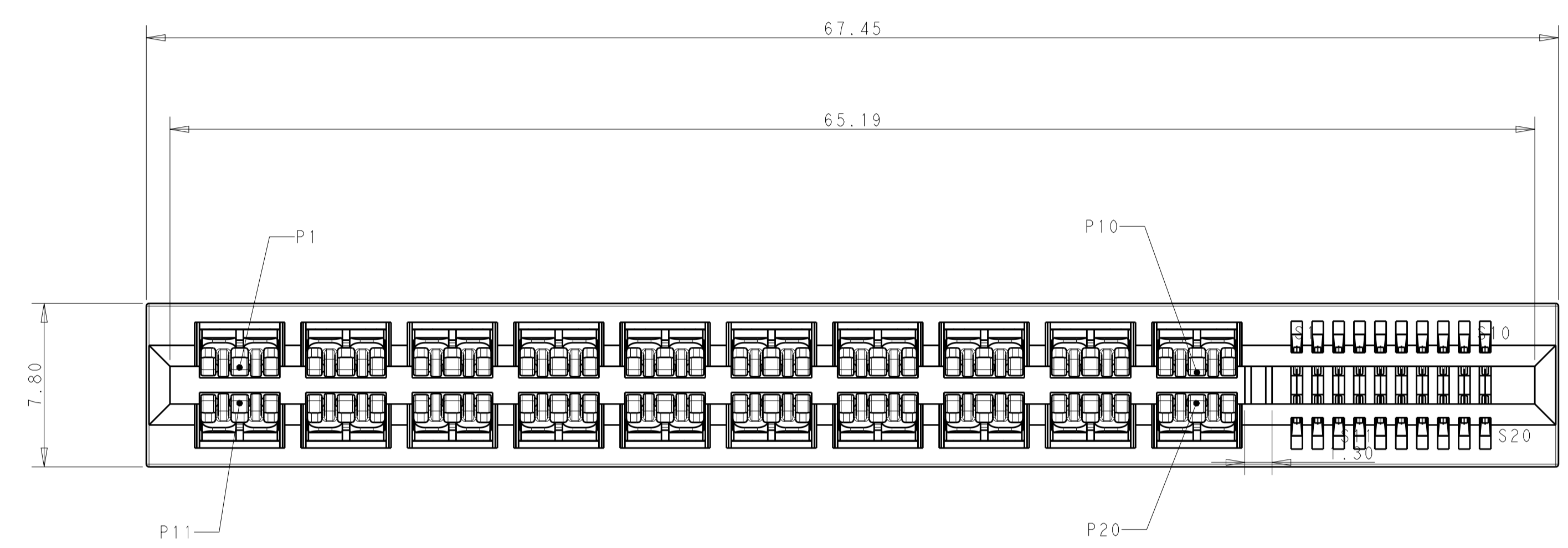

THIS DRAWING IS A CONTROLLED DOCUMENT.		DWN: SEAN_ZHANG	18OCT2018	PART NUMBER: 2345246-1	
DIMENSIONS: mm		CHK: SUNYI_ZHAO	18OCT2018	TE Connectivity	
TOLERANCES UNLESS OTHERWISE SPECIFIED:		APVD: SUNYI_ZHAO	18OCT2018	NAME: HD+ CARD EDGE VERTICAL, 2X10P-2X10S	
0 PLC	±	PRODUCT SPEC		SIZE: A100779	
1 PLC	±0.50	APPLICATION SPEC		CAGE CODE: C=2345246	
2 PLC	±0.25			RESTRICTED TO: -	
3 PLC	±			SCALE: 5:1	
4 PLC	±			SHEET 1 OF 2	
ANGLES	±			REV: A	
MATERIAL: SEE NOTE	FINISH: SEE NOTE	WEIGHT: -		CUSTOMER DRAWING	

REVISIONS				
P.	LTN	DESCRIPTION	DATE	APVD
-	-	SEE SHEET 1	-	-

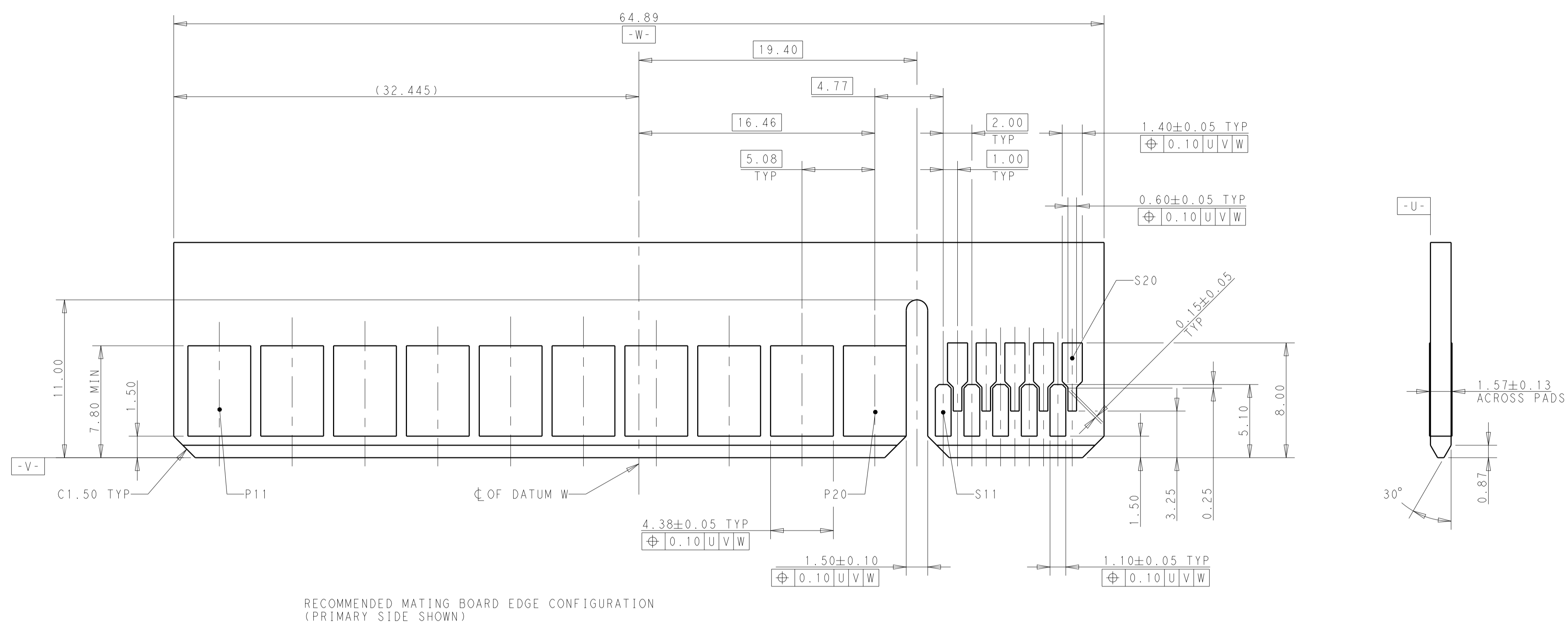

RECOMMENDED MATING BOARD EDGE CONFIGURATION  
 (PRIMARY SIDE SHOWN)

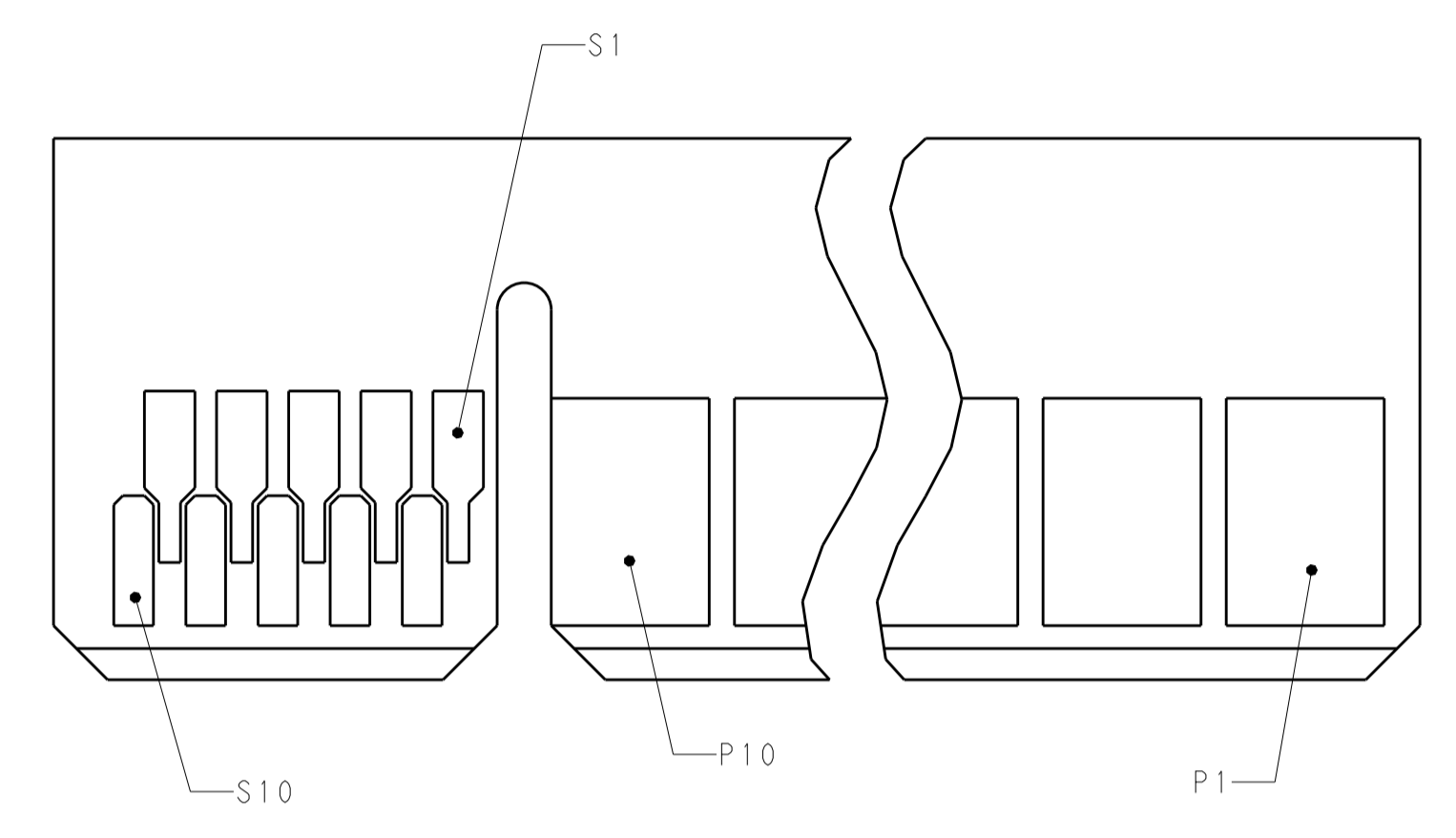

RECOMMENDED MATING BOARD EDGE CONFIGURATION  
 (SECONDARY SIDE SHOWN)

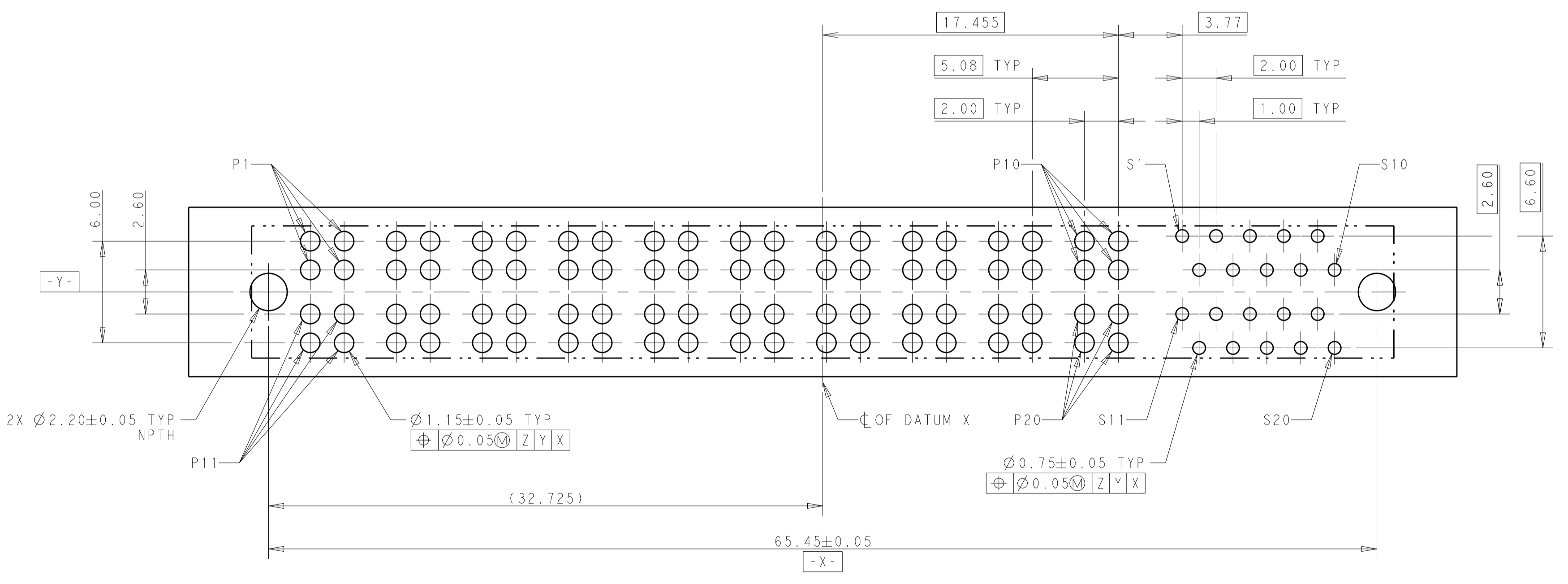

RECOMMENDED MOUNTING BOARD CONFIGURATION LAYOUT  
 VIEW FROM COMPONENT SIDE

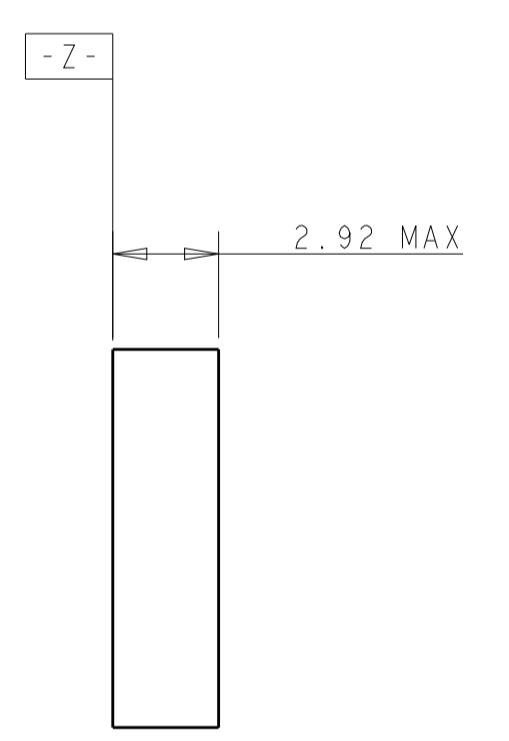

- NOTES FOR MOUNTING BOARD, UNLESS OTHERWISE SPECIFIED:
1. PLATED THROUGH HOLE, SIGNAL:  
 FINISHED HOLE SIZE: 0.75mm.  
 DRILL HOLE SIZE: 0.85±0.025mm.
  2. PLATED THROUGH HOLE, POWER:  
 FINISHED HOLE SIZE: 1.15mm.  
 DRILL HOLE SIZE: 1.25±0.025mm.
  3. COPPER PLATING THICKNESS: 0.025-0.05mm.
  4. SURFACE FINISH: OSP OR IMMERSION TIN PLATING IS RECOMMENDED.

THIS DRAWING IS A CONTROLLED DOCUMENT.		DWN: SEAN_ZHANG 18OCT2018	TE Connectivity
DIMENSIONS: mm		CHK: SUNYI_ZHAO 18OCT2018	
0 PLC ± 1 PLC ±0.20 2 PLC ±0.10 3 PLC ± 4 PLC ± ANGLES ±		NAME: HD+ CARD EDGE VERTICAL, 2X10P-2X10S PRODUCT SPEC APPLICATION SPEC	
MATERIAL: SEE NOTE	FINISH: SEE NOTE	WEIGHT: -	SIZE: A100779 CAGE CODE: 2345246 CUSTOMER DRAWING
SCALE: 5:1			SHEET 2 OF 2

单击下面可查看定价，库存，交付和生命周期等信息

[>>TE Connectivity\(泰科\)](#)