

THIS DRAWING IS UNPUBLISHED. RELEASED FOR PUBLICATION
 © COPYRIGHT 19 BY AMP INCORPORATED. ALL INTERNATIONAL RIGHTS RESERVED.

PROD CODE	LOC	DIST	P	F	ZONE	LTR	DESCRIPTION	DATE	APPD
4092	DF	SO				G	REDRAWN & ADDED 1-865765-1 & 1-865765-2 PER NPR'S 89-0342 & 89-0343	T.S. 8-18-89	WS
			✓			H	ADD -9 PER 0600-1422-93	CT 11-93	SG
			✓	✓		J	REV PER 0600-6810-97 JB	03-98	DE

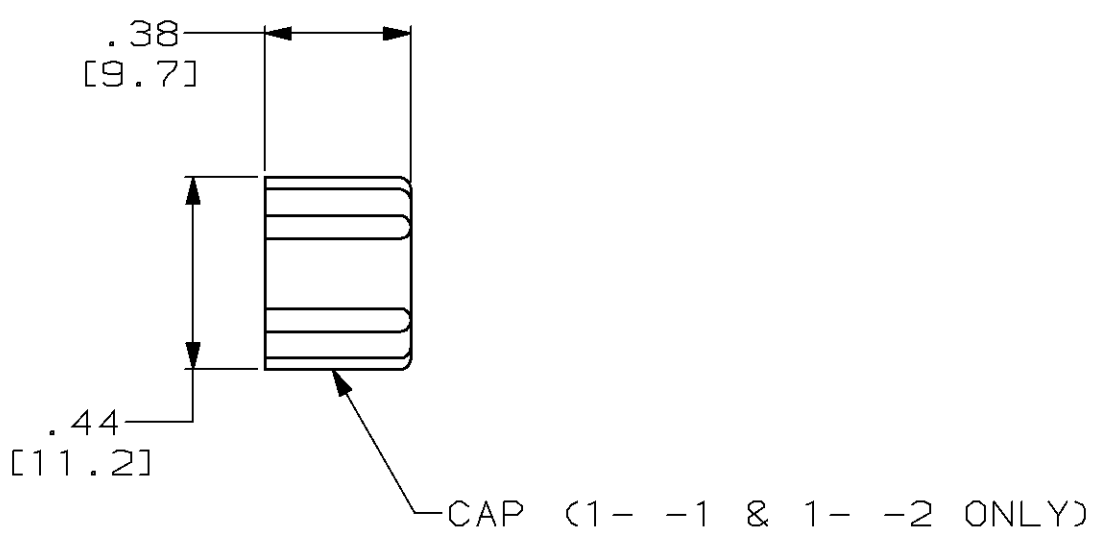
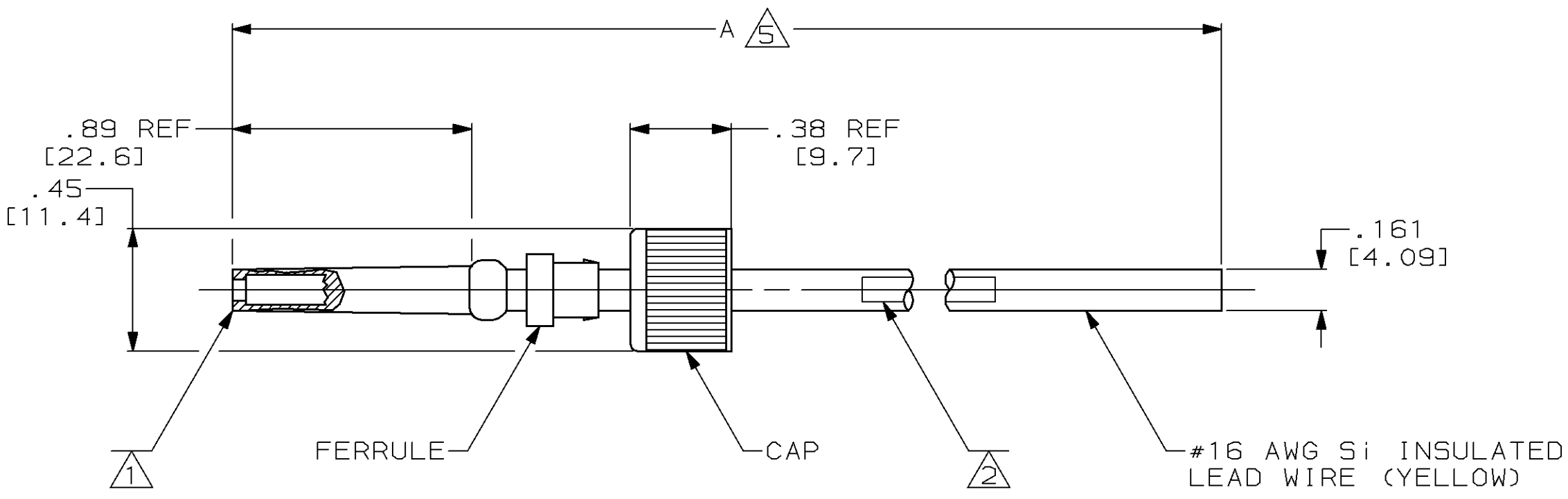

SIZE	CAGE CODE	DRAWING NO	PART NUMBER
12.00 [304.8]			1-865765-2
18.00 [457.2]			1-865765-1
NOT RELEASED			1-865765-0
36.00±.36 [914.4±9.1]			865765-9
NOT RELEASED			865765-8
24.00 [609.6]			865765-7
OBSOLETE	336.00±3.36 [8534.4±85.3]		865765-6
	72.00±.72 [182.8±18.3]		865765-5
	12.00 [304.8]		865765-4
OBSOLETE	11.00 [279.4]		865765-3
OBSOLETE	240.00±2.40 [6096.±61.0]		865765-2
	48.00±.46 [1219.2±12.2]		865765-1

- ① TO MATE WITH AMP LGH 1/2L RECEPTACLE WITH A .89 BARREL LENGTH.
- ② MARK PER MIL-STD-130.
- 3. OPERATING CONDITIONS: 15KVDC TO 70,000 FEET AT -55°C TO +125°C.
- 4. DIMENSIONS IN BRACKETS ARE IN MILLIMETERS. METRIC EQUIVALENTS ARE BASED UPON 1.00 inch = 25.4 mm.
- ⑤ TOLERANCE OF LEAD LENGTH:
UP TO 24 INCHES ±.12
24 INCHES AND UP ±1%

DO NOT SCALE PRINT. UNLESS SPECIFIED DIMENSIONS IN INCHES [mm]		DR 8-18-89 T. SHUEY		AMP INCORPORATED Harrisburg, Pa. 17105	
TOLERANCES ON: 2 PLC DEC ± .12 [3.0] 3 PLC DEC ± .005 [0.13] ANGLES ±		CHK 9-5-89 W. SHATTO			
MATERIAL		APPD 9-5-89 W. SHATTO		NAME	
FINISH		APPD 9-5-89 T. SHUEY		LEAD ASSEMBLY, LGH 1/2L POSITIVE STOP	
WEIGHT		PRODUCT SPEC			
		APPLICATION SPEC		SIZE	CAGE CODE
				C	00779
				DRAWING NO	865765
				SCALE	2:1
				SHEET	1 OF 1

单击下面可查看定价，库存，交付和生命周期等信息

[>>TE Connectivity\(泰科\)](#)