

THIS DRAWING IS UNPUBLISHED. RELEASED FOR PUBLICATION  
 © COPYRIGHT BY TYCO ELECTRONICS CORPORATION. ALL INTERNATIONAL RIGHTS RESERVED.

| LOC |     | DIST                  |  | REVISIONS |     |      |  |
|-----|-----|-----------------------|--|-----------|-----|------|--|
| P   | LTR | DESCRIPTION           |  | DATE      | DWN | APVD |  |
|     | H   | REV PER ECO-09-028160 |  | 29DEC09   | PY  | JW   |  |

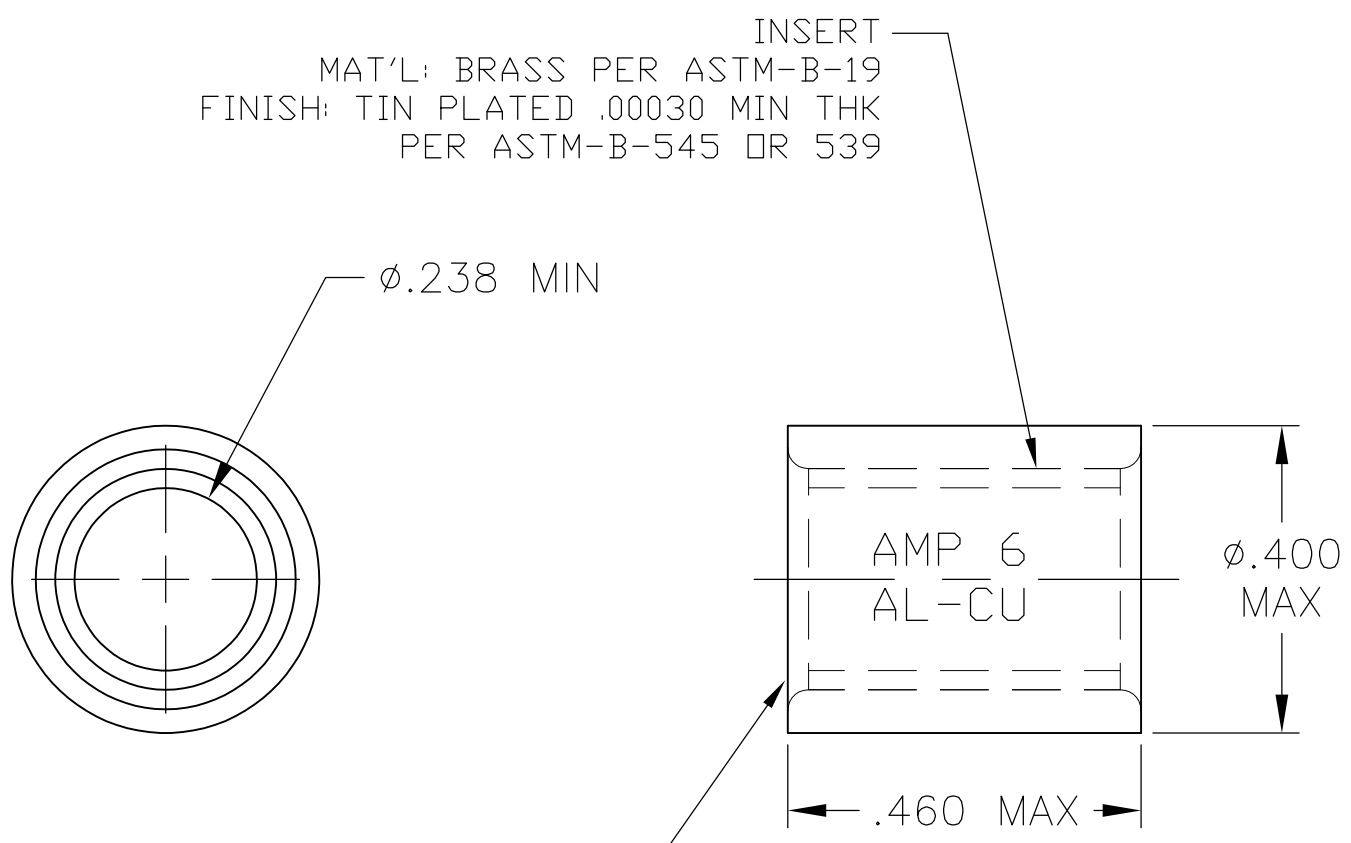

INSERT  
 MAT'L: BRASS PER ASTM-B-19  
 FINISH: TIN PLATED .00030 MIN THK  
 PER ASTM-B-545 OR 539

BODY  
 MAT'L: COPPER PER ASTM-B-152  
 FINISH: TIN PLATED  
 PER ASTM-B-545 OR 539

52746  
 PART NUMBER

|  |                     |                             |  |                    |                       |       |     |       |     |       |     |        |     |                  |  |               |
|--|---------------------|-----------------------------|--|--------------------|-----------------------|-------|-----|-------|-----|-------|-----|--------|-----|------------------|--|---------------|
| THIS DRAWING IS A CONTROLLED DOCUMENT.   |                     | DWN<br>C.C.THOMAS<br>9-2-09 | Tyco Electronics Corporation<br>Harrisburg, PA 17105-3608          |                    |                       |       |     |       |     |       |     |        |     |                  |  |               |
| DIMENSIONS:<br>INCHES  |                     | CHK<br>J.WEAVER<br>9-2-09   | NAME<br>SPLICE, PARALLEL, COPALUM,<br>STRANDED/SOLID, WIRE SIZE #6 |                    |                       |       |     |       |     |       |     |        |     |                  |  |               |
| TOLERANCES UNLESS<br>OTHERWISE SPECIFIED:  |                     | APVD<br>J.WEAVER<br>9-2-09  | PRODUCT SPEC   |                    |                       |       |     |       |     |       |     |        |     |                  |  |               |
| <table border="0"> <tr><td>0 PLC</td><td>± -</td></tr> <tr><td>1 PLC</td><td>± -</td></tr> <tr><td>2 PLC</td><td>± -</td></tr> <tr><td>3 PLC</td><td>± -</td></tr> <tr><td>4 PLC</td><td>± -</td></tr> <tr><td>ANGLES</td><td>± -</td></tr> </table> |                     | 0 PLC                       | ± -  | 1 PLC              | ± -                   | 2 PLC | ± - | 3 PLC | ± - | 4 PLC | ± - | ANGLES | ± - | APPLICATION SPEC |  | RESTRICTED TO |
| 0 PLC  | ± -                 |                             |  |                    |                       |       |     |       |     |       |     |        |     |                  |  |               |
| 1 PLC  | ± -                 |                             |  |                    |                       |       |     |       |     |       |     |        |     |                  |  |               |
| 2 PLC  | ± -                 |                             |  |                    |                       |       |     |       |     |       |     |        |     |                  |  |               |
| 3 PLC  | ± -                 |                             |  |                    |                       |       |     |       |     |       |     |        |     |                  |  |               |
| 4 PLC  | ± -                 |                             |  |                    |                       |       |     |       |     |       |     |        |     |                  |  |               |
| ANGLES   | ± -                 |                             |  |                    |                       |       |     |       |     |       |     |        |     |                  |  |               |
| MATERIAL<br>SEE TABLE  | FINISH<br>SEE TABLE | WEIGHT<br>-                 | SIZE<br>A3   | CAGE CODE<br>00779 | DRAWING NO<br>C-52746 |       |     |       |     |       |     |        |     |                  |  |               |
| CUSTOMER DRAWING   |                     |                             | SCALE<br>2:1   | SHEET<br>1 OF 1    | REV<br>H              |       |     |       |     |       |     |        |     |                  |  |               |

单击下面可查看定价，库存，交付和生命周期等信息

[>>TE Connectivity\(泰科\)](#)