

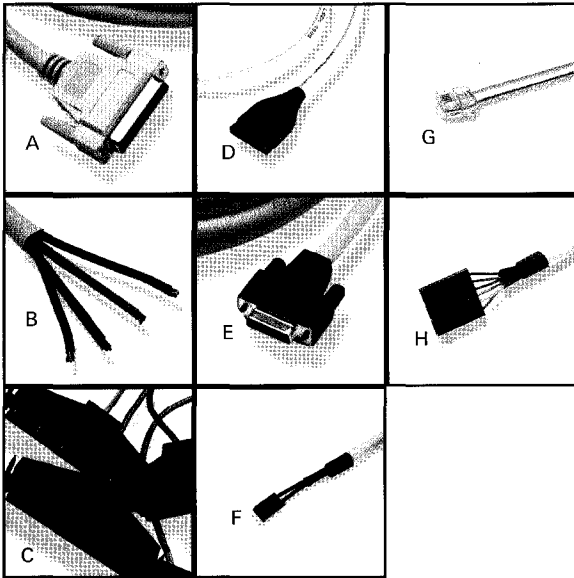

AMPTRAC Analyzer I/O Cable Assemblies

Analyzer I/O Cable Assemblies



Product Facts

- :: AMPTRAC Connectivity Management System I/O Cable Assemblies are available with the following connectors
- ... DB25 connector (on Analyzer)
- ... 2.0 mm AMPMODU connector (used with the Analyzer DB25 adapter 1499641-1)
- ... 2.0 mm AMPMODU (on sensor strips and shielded patch panels)
- ... 6-position modular plug (RJ11) (on MT-RJ and LC Duplex MPO cassettes)
- ... 6-position 2.54 MTE connector (on Duplex SC adapter plates and MPO cassettes)
- ... HD22 connector (on MRJ21 and shielded patch panels)
- ... 110 Plug and Play connector (on AMPTRAC UTP SL Series patch panels)
- :: All 24-conductor I/O cables come with molded boots on both ends
- :: All I/O cables come with molded boots on the analyzer connector end
- :: I/O Cable Assemblies are Non-Plenum (CM rated) and Listed

Monitored Device	Connector End 1 (Figure)	Connector End 2 (Figure)	Application	Number of Conductors	Part Number
AMPTRAC Patch Panel	DB25 - Analyzer (A)	None, used for IDC (B) 110 - Plug & Play (C)	Cat 5e, Cat 6, MT-RJ, LC Cat 5e, Cat 6, MT-RJ, LC	24	1435844-X 1499656-Y
PCB Sensor	DB25 - Analyzer (A)	Over Molded 2.0 mm, AMPMODU (D)	LAN Switches, Cat6 Shielded	24	1435845-Y
MRJ21 Patch Panel	DB25 - Analyzer (A)	HD22 (E)	MRJ21, Cat 6 Shielded	24	1499507-Y
PCB Sensor	*Single 2.0 mm, AMPMODU (F)	Single 2.0 mm, AMPMODU (F)	LAN Switches, Cat6 Shielded	16	*1499686-Y
				12	*1499687-Y
				8	*1499688-Y
				6	*1499689-Y
Cassettes	*Single 2.0 mm, AMPMODU (F)	6-Position, RJ11 (G)	MT-RJ, LC	6	*1499684-Y
Duplex SC Adapter Plates	*Single 2.0 mm, AMPMODU (F)	6-Position, 2.5 mm MTE (H)	Duplex SC Adapter Plates and Cassettes	6	*1499685-Y
PCB Sensor	*Single 2.0 mm, AMPMODU (F)	Single 2.0 mm, AMPMODU (F)	LAN Switches, Cat6 Shielded	2	*1499690-Y

X denotes length in feet: -7 = 7, 1-4 = 14, 5-0 = 50, 9-9 = 100 (Note: Can be cut to length)
 Y denotes length in feet: -4 = 4, -7 = 7, 1-0 = 10, 1-4 = 14, 2-5 = 25, 5-0 = 50, 7-5 = 75, 9-9 = 100
 *NOTE: Use with DB25 Adapter P/N: 1499641-1 to connect monitored device to AMPTRAC Analyzer.

Adapter, DB25 to 2.0 mm AMPMODU

PART NUMBER 1499641-1

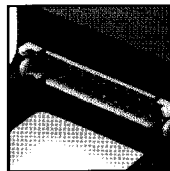
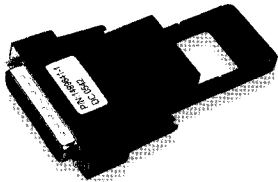

Back Detail - 24 Position
2.0 mm AMPMODU

Product Facts

- :: For use with 2.0 mm AMPMODU connectors less than 24 position (Single 2.0 mm AMPMODU)
- :: Allows for side-by-side connections of multiple Single 2.0 mm AMPMODU connectors
- :: Allows for use of all analyzer ports
- :: Built-in strain relief and cable management

110 Plug and Play Kit

PART NUMBER 1479960-1

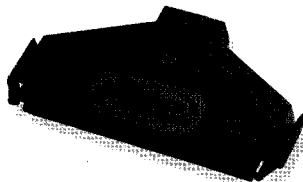

110 Plug and Play Kit
As Shipped



110 Plug and Play Kit
Assembled

Product Facts

- :: Used with I/O Cable Assembly part number 1435844
- :: Easy to lace and field terminate (no special tools required)
- :: Built-in latches and orientation features

单击下面可查看定价，库存，交付和生命周期等信息

[>>TE Connectivity\(泰科\)](#)