

THIS DRAWING IS UNPUBLISHED. RELEASED FOR PUBLICATION APRIL , 2004.
 © COPYRIGHT 2004 By - ALL RIGHTS RESERVED.

REVISIONS					
P	LTR	DESCRIPTION	DATE	DWN	APVD
A2		ECO-18-009885	24JUL2018	RZ	RS

- NOTES:
- ① SINGLE PACK IN ACCORDANCE WITH SPEC 107-3275
 - ② 100 TRAY PACK IN ACCORDANCE WITH SPEC 107-3275
 - ③ 0.08µm Au PLATING OVER 1.27µm Ni PLATING
 - ④ 0.08µm Au PLATING OVER 1.27µm Ni PLATING OVER 0.76µm Cu PLATING
 - ⑤ 0.76µm Au PLATING OVER 1.27µm Ni PLATING OVER 0.76µm Cu PLATING
 - ⑥ PASSIVATED
 - 7 FOR TECHNICAL DATA REFER TO YOUR LOCAL TYCO ELECTRONICS SALES OFFICE
 - 8 ALL DIMENSIONS ARE NOMINAL FOR REFERENCE ONLY UNLESS OTHERWISE STATED

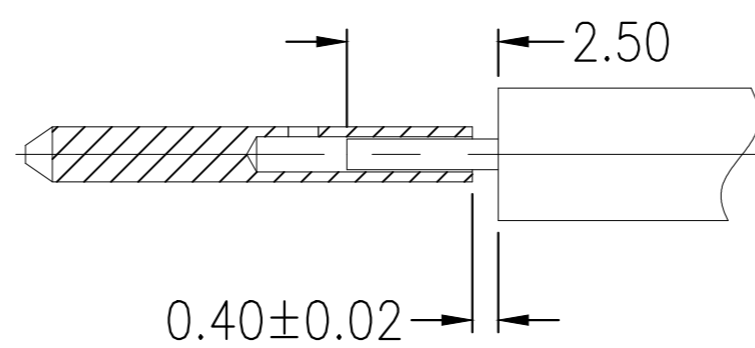
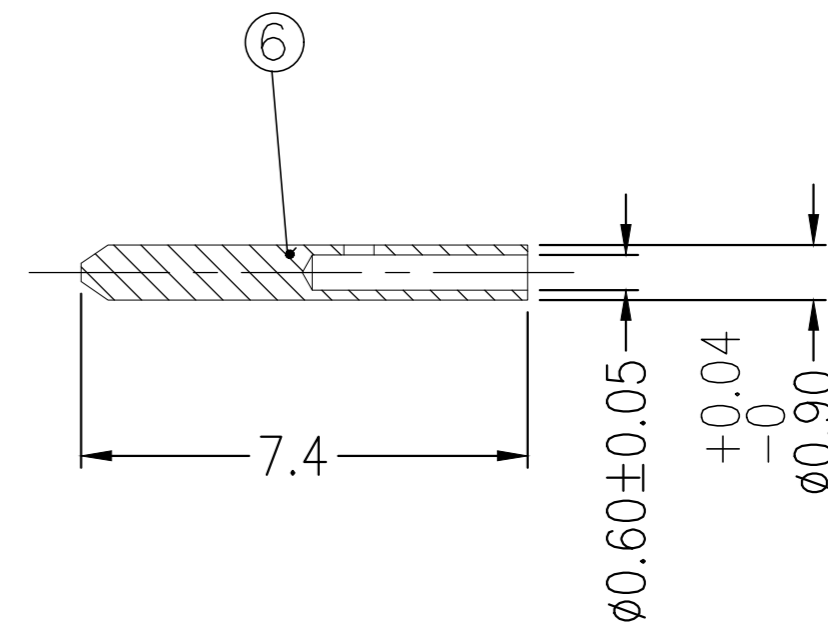
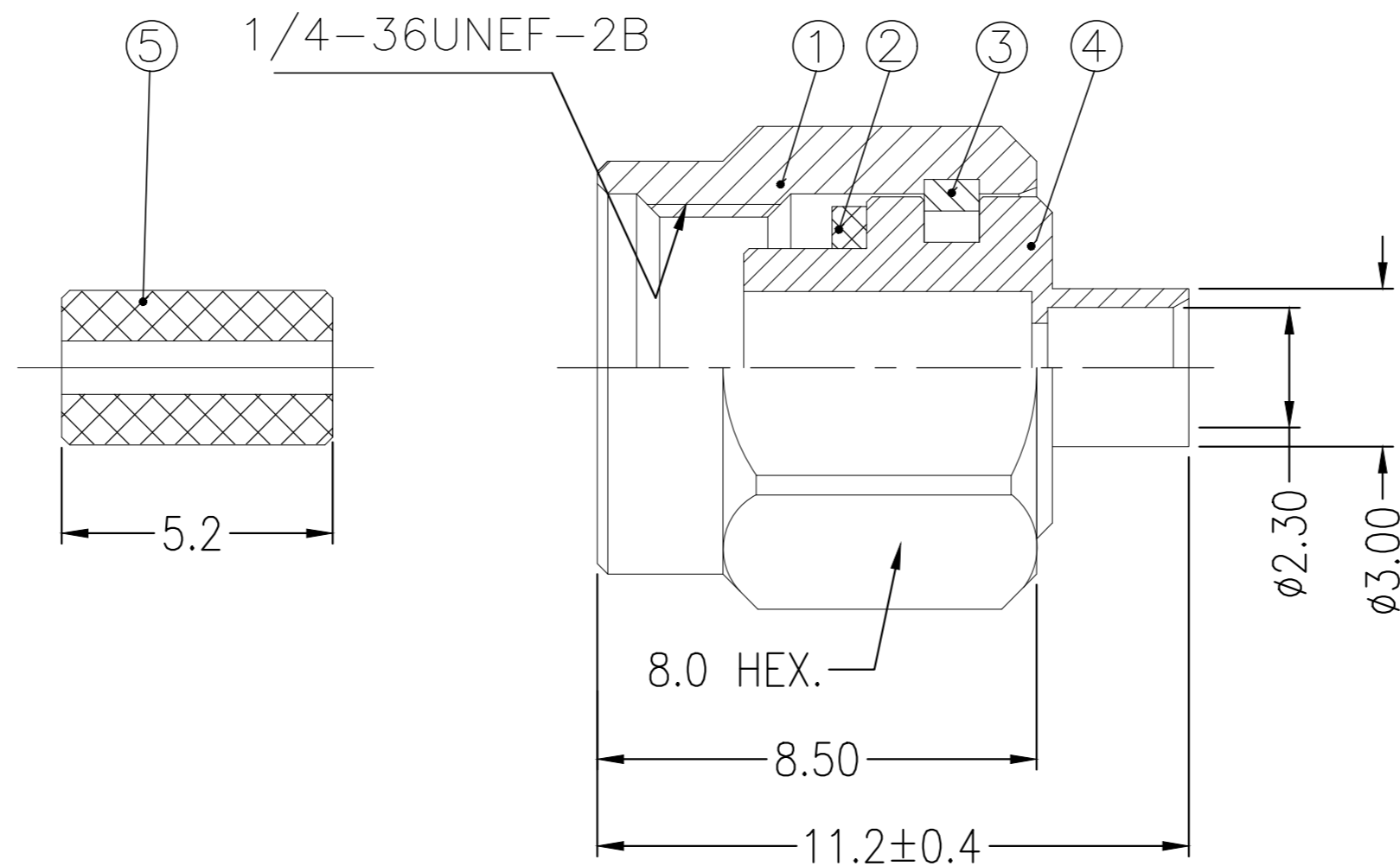

RECOMMENDED CABLE STRIPPING DIM'S

QTY	QTY	QTY	QTY	QTY	QTY	QTY	QTY	MATERIAL	DESCRIPTION	ITEM
1	1	1	1	1	1	1	1	BRASS	① CENTER CONTACT	6
1	1	1	1	1	1	1	1	PTFE	② INSULATOR	5
1	1	-	-	-	-	-	-	BRASS	④ BODY	4
-	-	1	1	-	-	-	-	STAINLESS STEEL	③ BODY	4
-	-	-	-	1	1	-	-	STAINLESS STEEL	⑤ BODY	4
1	1	1	1	1	1	1	1	STAINLESS STEEL	CIRCLIP	3
1	1	1	1	1	1	1	1	SILICON	GASKET	2
1	1	-	-	-	-	-	-	BRASS	⑥ SHELL	1
-	-	1	1	-	-	-	-	STAINLESS STEEL	④ SHELL	1
-	-	-	-	1	1	-	-	STAINLESS STEEL	⑤ SHELL	1
3--1	3--0	2--1	2--0	1--1	1--0			MATERIAL	DESCRIPTION	ITEM

ELECTRICAL	MECHANICAL	ENVIRONMENTAL
Impedance (Ohm) <u>50</u>	Interface Dimension MIL-STD-348B Fig. <u>310-1</u>	TEMPERATURE RANGE <u>-65°C TO + 165°C</u>
Frequency Range (GHz) <u>DC to 12.4GHz</u>	Recommended Coupling Torque <u>7 to 10 In-Lbs</u>	THERMAL SHOCK <u>MIL-STD-202, METH.107, COND.A</u>
Voltage Rating (Peak) <u>170 V RMS</u> @ Sea Level	Force to Engage and Disengage (In/lbs) <u>2.0 MAX</u>	CORROSION <u>MIL-STD-202, METH.101, COND.B</u>
Insulation Resistance (MIN.) <u>1000 M ohms</u>	Center Contact Captivation Axial (Lbs) <u>N/A</u> Radial (In/Oz) <u>N/A</u>	VIBRATION <u>MIL-STD-202, METH.204, COND.D</u>
Contact Resistance (Milliohms MAX) Center Contact <u>3.0</u> Outer Contact <u>2.0</u>	Cable Retention Axial (Lbs) <u>N/A</u>	SHOCK <u>MIL-STD-202, METH.213, COND.I</u>
Dielectric Withstand Voltage: <u>750 V RMS Max</u>	Mating cycles <u>500</u> cycles	MOISTURE RESISTANCE <u>MIL-STD-202, METH.106.</u>
Insertion Loss : <u>0.06*SQRT(F) dB</u>		ROHS <u>COMPLIANT</u>
VSWR: <u>1.05 + 0.05*SQRT(F) (GHz)</u>		
RF leakage: <u>N/A</u>		
3rd Intermodulation: <u>N/A</u>		

THIS DRAWING IS A CONTROLLED DOCUMENT.

DIMENSIONS: mm	TOLERANCES UNLESS OTHERWISE SPECIFIED:	DWN R.SMITH 28JAN04	TE Connectivity Ltd.		
	0 PLC ± -	CHK S.PARLOW 28JAN04	SMA STRAIGHT PLUG DIRECT SOLDER NON CAPTIVE CENTRE CONTACT RG405/U		
	1 PLC ± 0.2	APVD F.WHEELER-KING 28JAN04	NAME	SIZE	CAGE CODE
	2 PLC ± 0.1	PRODUCT SPEC	108-112003	DRAWING NO	RESTRICTED TO
	3 PLC ± 0.05	APPLICATION SPEC	408-4765	SCALE	SHEET
	4 PLC ± -		0.000000	8:1	1 of 1
	ANGLES ± 3		WEIGHT	REV	A2
MATERIAL SEE TABLE	FINISH -	CUSTOMER DRAWING			

单击下面可查看定价，库存，交付和生命周期等信息

[>>TE Connectivity\(泰科\)](#)