

THIS DRAWING IS UNPUBLISHED. RELEASED FOR PUBLICATION 20
COPYRIGHT 20 ALL RIGHTS RESERVED.

LOC	DIST	REVISIONS			
P	LTR	DESCRIPTION	DATE	DWN	APVD
CE	00	CI	REVISE PER ECO-11-005139	29APR2011	RK HMR

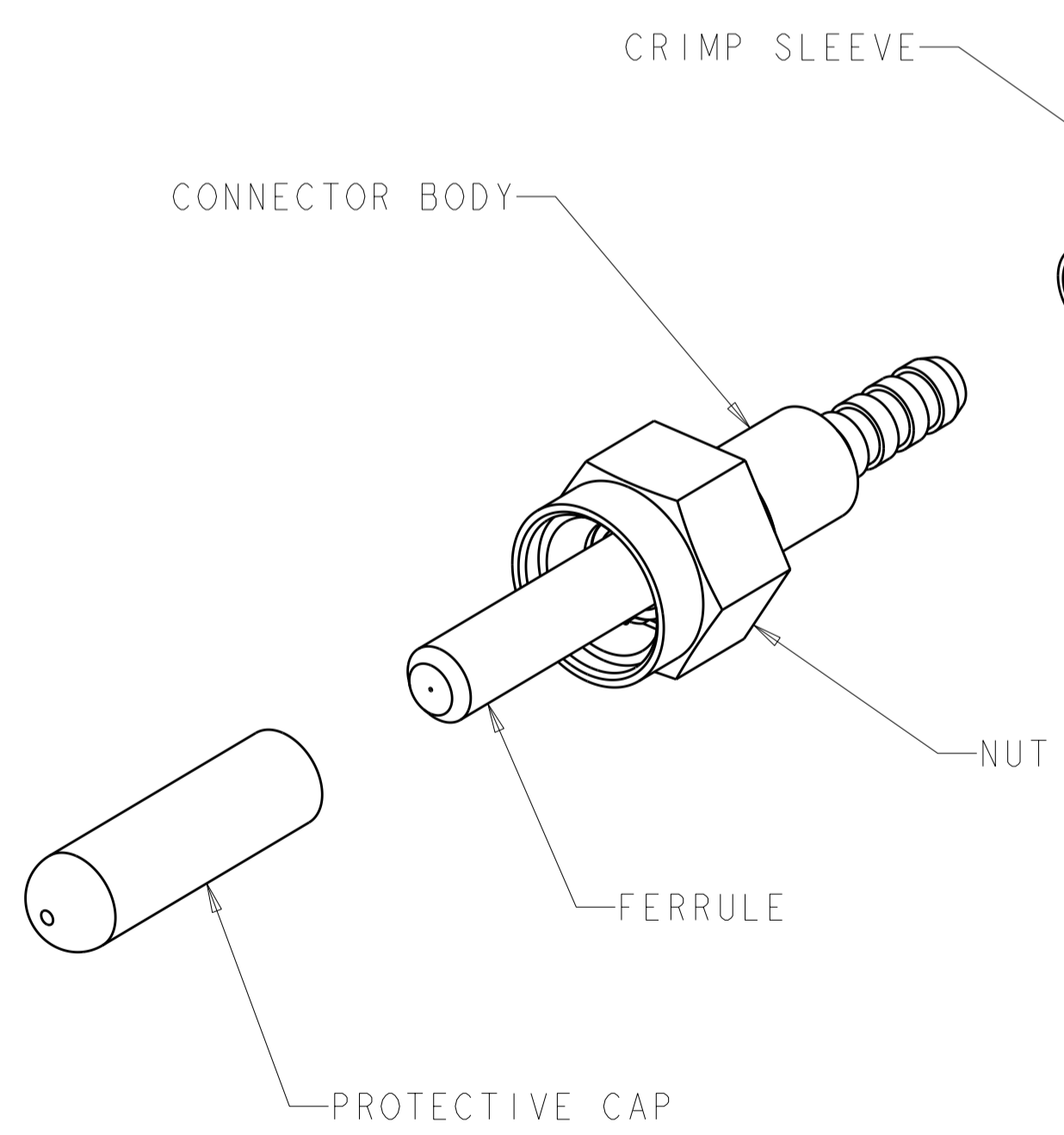
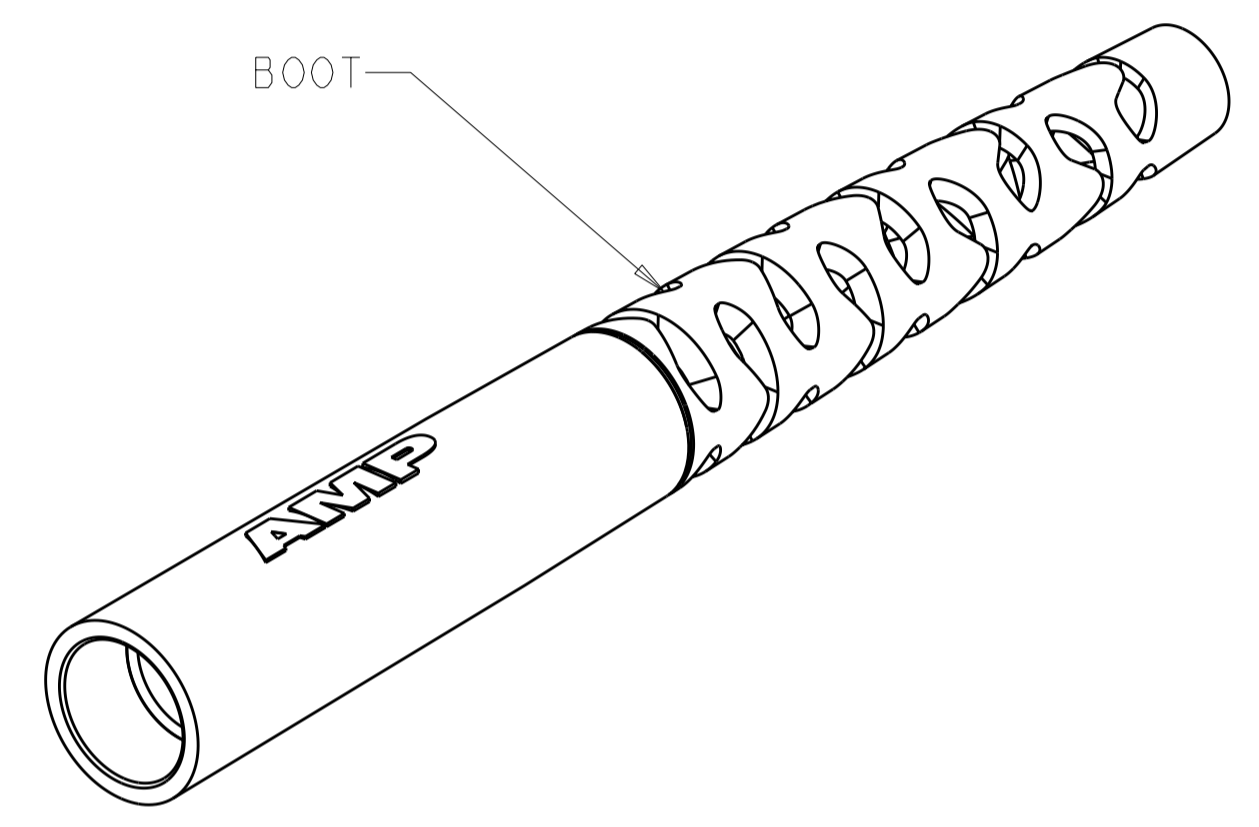
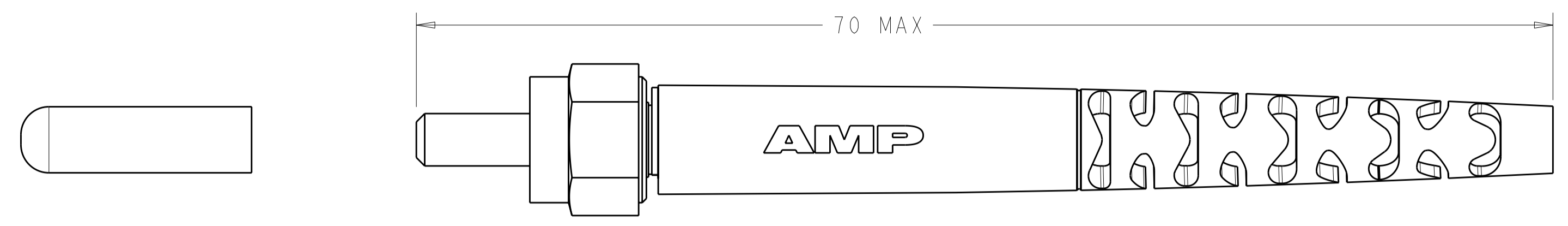

△ MATERIAL:
 CONNECTOR ASSEMBLY:
 FERRULE: STAINLESS STEEL
 REAR BODY: BRASS, NICKEL PLATED
 COUPLING NUT: BRASS, NICKEL PLATED
 CRIMP EYELET: BRASS, NICKEL PLATED
 BOOT: POLYOLEFIN ELASTOMER, COLOR: BLACK*
 PROTECTIVE CAP: VINYL, COLOR: RED
 *UL94 V-0 RATED AT QUALIFYING THICKNESS.

2. COUPLING NUT NORMAL TIGHTENING TORQUE RANGE IS 7.0 TO 10.0 in-lbf. DO NOT EXCEED 20 in-lbf.

③ CRIMP SLEEVE AND BOOT NOT SUPPLIED.

③	1.48mm	4-5504566-3
	635um	4-5504566-2
	.042 in	3-5504566-1
	.039 in	3-5504566-0
	641um	2-5504566-8
	336um	1-5504566-4
	231um	5504566-7
	140um	5504566-2
	125um	5504566-1
	FIBER HOLE SIZE	PART NUMBER

THIS DRAWING IS A CONTROLLED DOCUMENT.

DWN	B. BRIGGS	16 JUN 2005
CHK	L. SAUERWEIN	16 JUN 2005
APVD	S. BUCHTER	16 JUN 2005

STE TE Connectivity

NAME: CONNECTOR KIT, SMA 905, STAINLESS STEEL FRONT BODY, BRASS REAR BODY, 3.1mm CABLE

SIZE	CAGE CODE	DRAWING NO	RESTRICTED TO
A2	00779	C-5504566	-

CUSTOMER DRAWING SCALE 4:1 SHEET 1 OF 1 REV C1

单击下面可查看定价，库存，交付和生命周期等信息

[>>TE Connectivity\(泰科\)](#)