

THIS DRAWING IS UNPUBLISHED. RELEASED FOR PUBLICATION
 © COPYRIGHT - By - ALL RIGHTS RESERVED.

LOC	DIST	REVISIONS			
P	LTR	DESCRIPTION	DATE	DWN	APVD
AF	50				
	A4	REVISED PER ECR-18-003610	07MAY2018	BDA	SV

- 1 CONTINUOUS STRIP ON REELS WITH TERMINALS LOCATED ON 5.59±0.08 [.220±.003] CENTERS.
- 2 SLOT TERMINATES EITHER A SINGLE OR DOUBLE MAGNET WIRES OF THE SAME TYPE AND SIZE, COPPER RANGE: 0.29-0.40mm [#29-#26] AWG. ALUMINUM RANGE: 0.36-0.51mm [#27-#24] AWG (THE ALUMINUM RANGE ARE TENTATIVE VALUES AND TO BE VERIFIED BY TE)

IDENTIFICATION NUMBER 7 FOR MAGNET WIRE RANGE

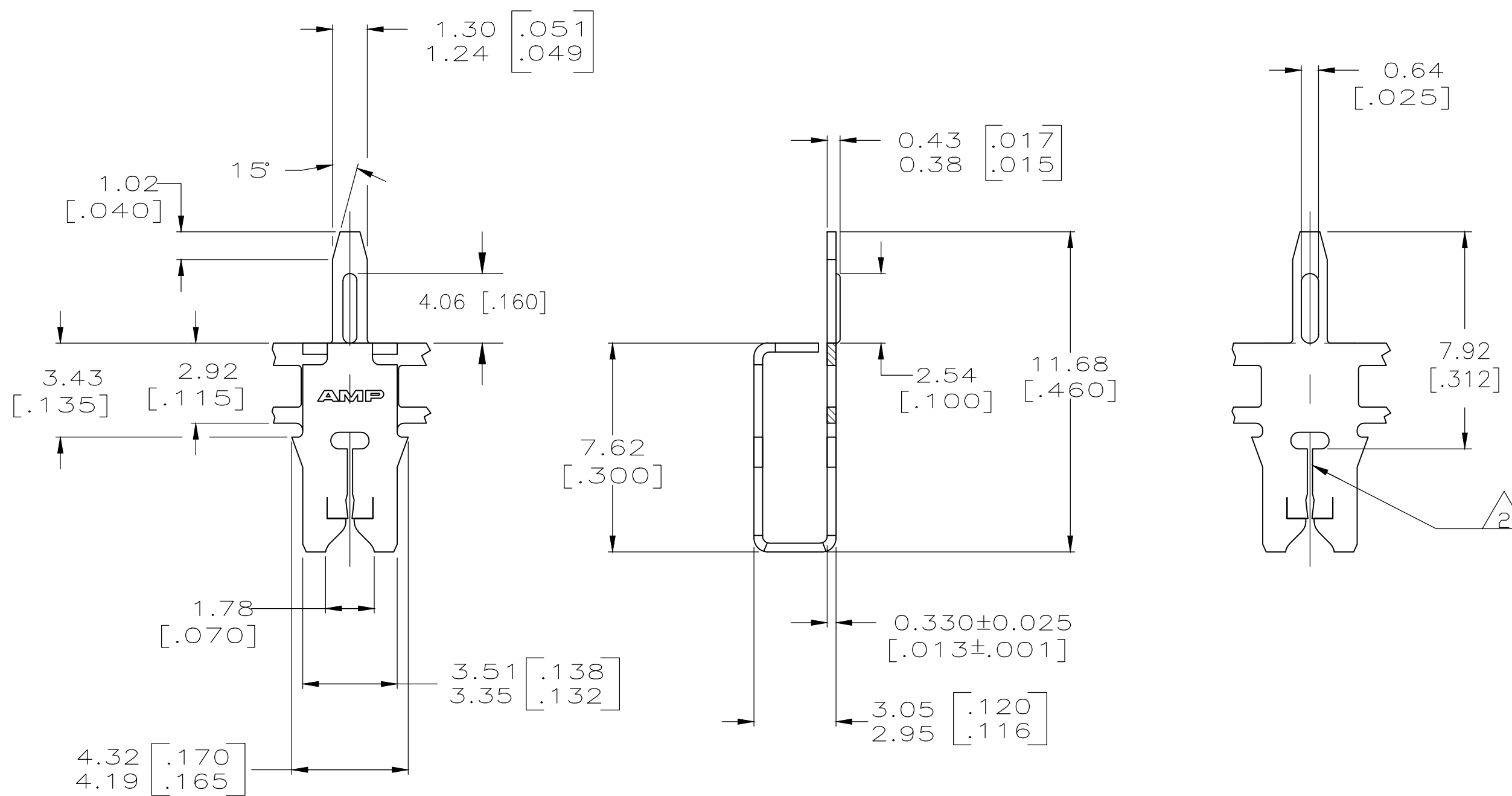
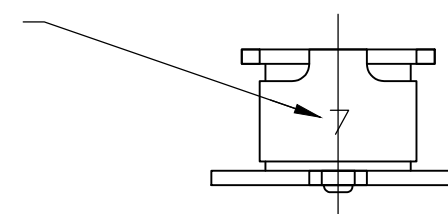

1742940-1
PART NUMBER

THIS DRAWING IS A CONTROLLED DOCUMENT.		DWN jr ruth 15NOV11		
DIMENSIONS: INCHES		CHK KURT RANDOLPH 15NOV11		
TOLERANCES UNLESS OTHERWISE SPECIFIED:		APVD KURT RANDOLPH 15NOV11	NAME POST, TERMINAL, MAG-MATE	
0 PLC ± - 1 PLC ± - 2 PLC ± 0.25 [.010] 3 PLC ± - 4 PLC ± - ANGLES ± 1°		PRODUCT SPEC 108-2012	SIZE A2	
MATERIAL BRASS		APPLICATION SPEC 114-2046	CAGE CODE 00779	DRAWING NO C=1742940
FINISH TIN PLATE		WEIGHT	RESTRICTED TO	SCALE 6:1
		CUSTOMER DRAWING	SHEET 1 of 1	REV A4

单击下面可查看定价，库存，交付和生命周期等信息

[>>TE Connectivity\(泰科\)](#)