

LOC	DIST	P	F	LTR	DESCRIPTION	DATE	APPROVED
G	14			C	REVISED & REDRAWN PER G-5803	6/12/92	DKS / AJK

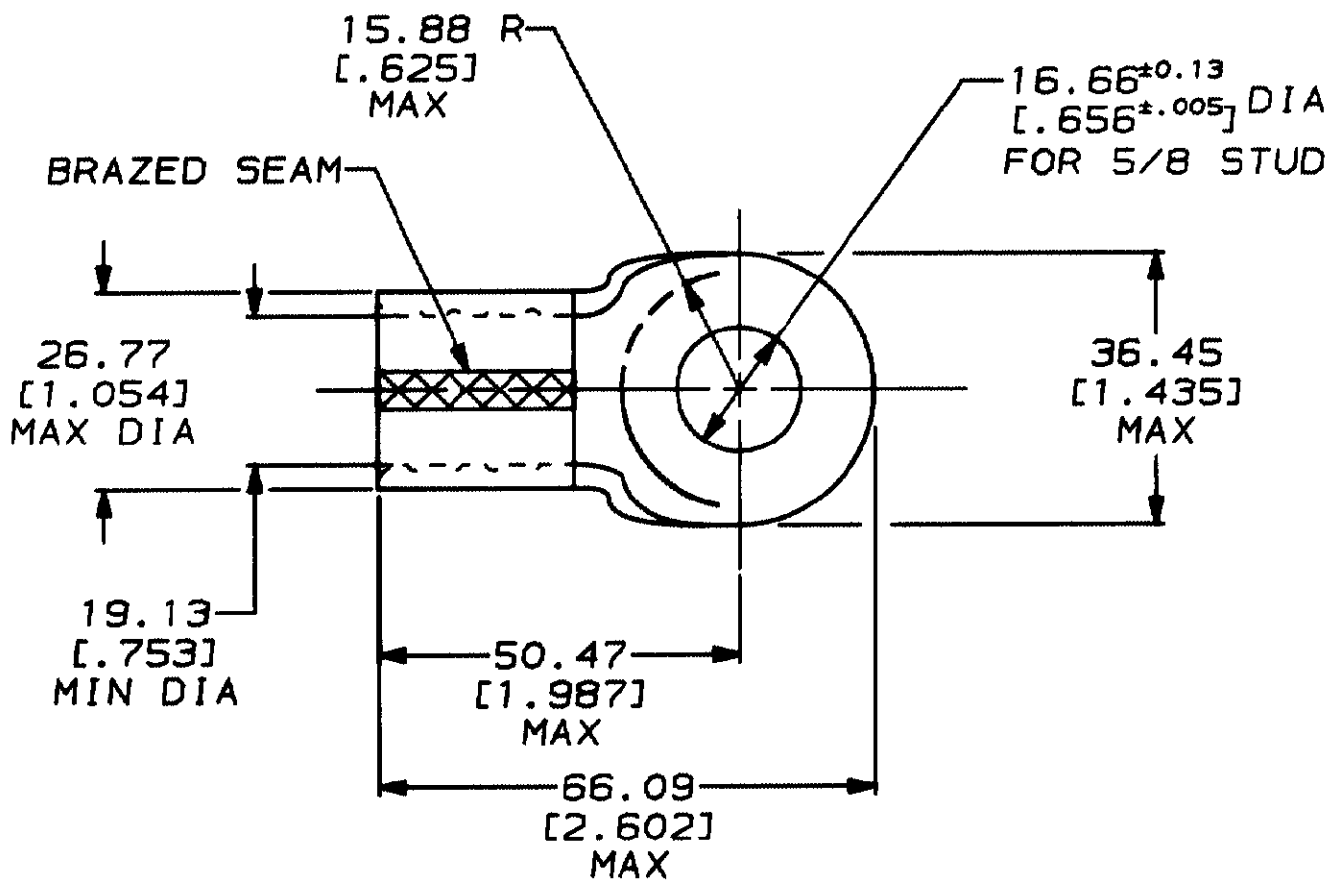

THIS DRAWING IS UNPUBLISHED. RELEASED FOR PUBLICATION BY AMP INCORPORATED. ALL INTERNATIONAL RIGHTS RESERVED. © COPYRIGHT 19

323050
PART NO

DO NOT SCALE PRINT. UNLESS SPECIFIED DIMENSIONS IN mm [IN] TOLERANCES ON: 2 PLC DEC ± 0.20(.008) 3 PLC DEC ± - ANGLES ± -	DR 6/12/92 DK SCHRUM	<b>AMP</b> AMP Incorporated Harrisburg, PA 17105-3608
	CHK 6/26/92 RD HEIN	
MATERIAL COPPER ASTM B-152 ANNEALED	APPD 6/26/92 AJ KAUFMAN	NAME TERMINAL, RING TONGUE, SOLISTRAND™ WIRE SIZE: 127.0-152.0mm <sup>2</sup> [250-300] MCM
	APPD 6/26/92 CR RHODS	
FINISH TIN PLATE 0.00254[.000100] MIN THK PER MIL-T-10727	PRODUCT SPEC -	SIZE <b>A</b>
	APPLICATION SPEC -	CAGE CODE 00779
WEIGHT -	DRAWING NO <b>C-323050</b>	SCALE 1:1
		SHEET 1 OF 1

单击下面可查看定价，库存，交付和生命周期等信息

[>>TE Connectivity\(泰科\)](#)