

DO NOT SCALE

DIMENSIONS IN mm

METRIC

THIRD ANGLE
PROJECTION

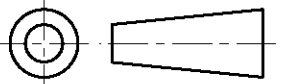

NOTES

- 1 FOR USE ON MINIATURE APPLICATORS (LEFT-RIGHT FEED) AND STANDARD APPLICATORS (RIGHT-LEFT FEED).
- 2 FOR USE ON MINIATURE APPLICATORS (AMP-O-MATOR APPLICATION). (LEFT-RIGHT FEED).
- 3 OBSOLETE PARTS: OBSOLETE CIS STREAMLINING PER D.RENAUD/D.SINISI

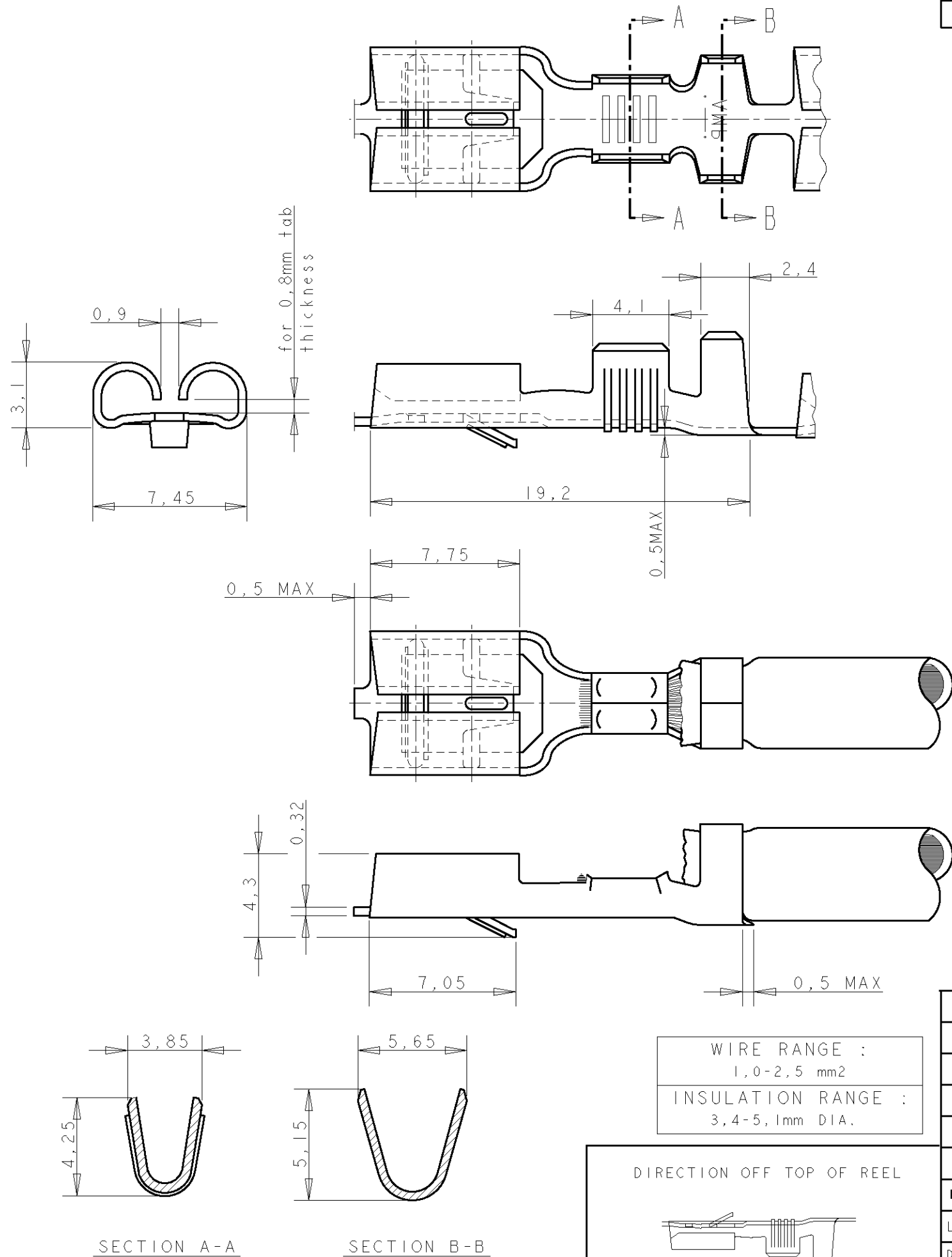

GENERAL TOLERANCES ±0.3

OBSOLETE 3	1	PRE-TINPLATED	PH.BRONZE	6-160448-8
	1	PRE-TINPLATED	BRASS	6-160448-7
	1 2	SILVERPLATED	BRASS	6-160448-6
	1	TINPLATED	BRASS	6-160448-5
	1	SILVERPLATED	PH.BRONZE	6-160448-3
	1	TINPLATED	PH.BRONZE	6-160448-2
	1	UNPLATED	PH.BRONZE	6-160448-1
	1	UNPLATED	BRASS	6-160448-0
	NOTES	FINISH	MATERIAL	PARTNUMBER

CUSTOMER DRAWING FOR REFERENCE ONLY WILL NOT BE UPDATED

THIS DRAWING IS UNPUBLISHED RELEASED FOR PUBLICATION



NAME .250 SRS FASTIN-ON RECEPTACLE.

K2	REVISED PER ECO-11-005140	RK	HMR	19APR11
LTR.	REVISION RECORD	DR.	CHK.	DATE
DR.:	J.v.LIEMPT.	CHK.:	A.BIJNEN.	APP.:
DATE:	23 MAR 1992	DATE:	-	DATE:

DWG.No.	C-160448	REV.LTR.	K2	SHEET	1 OF 1	A3
---------	----------	----------	----	-------	--------	----

单击下面可查看定价，库存，交付和生命周期等信息

[>>TE Connectivity\(泰科\)](#)