

THIS DRAWING IS UNPUBLISHED. RELEASED FOR PUBLICATION, 19 .
 © COPYRIGHT 19 BY AMP INCORPORATED. ALL INTERNATIONAL RIGHTS RESERVED.

MOD 03 LOC GP DIST 00

P		F		ZONE		LTR		DESCRIPTION	DATE	APPD
						B		REDRAWN	2-16-90	-
						C		REV PER 051A-0069-01	05/05/01	CR

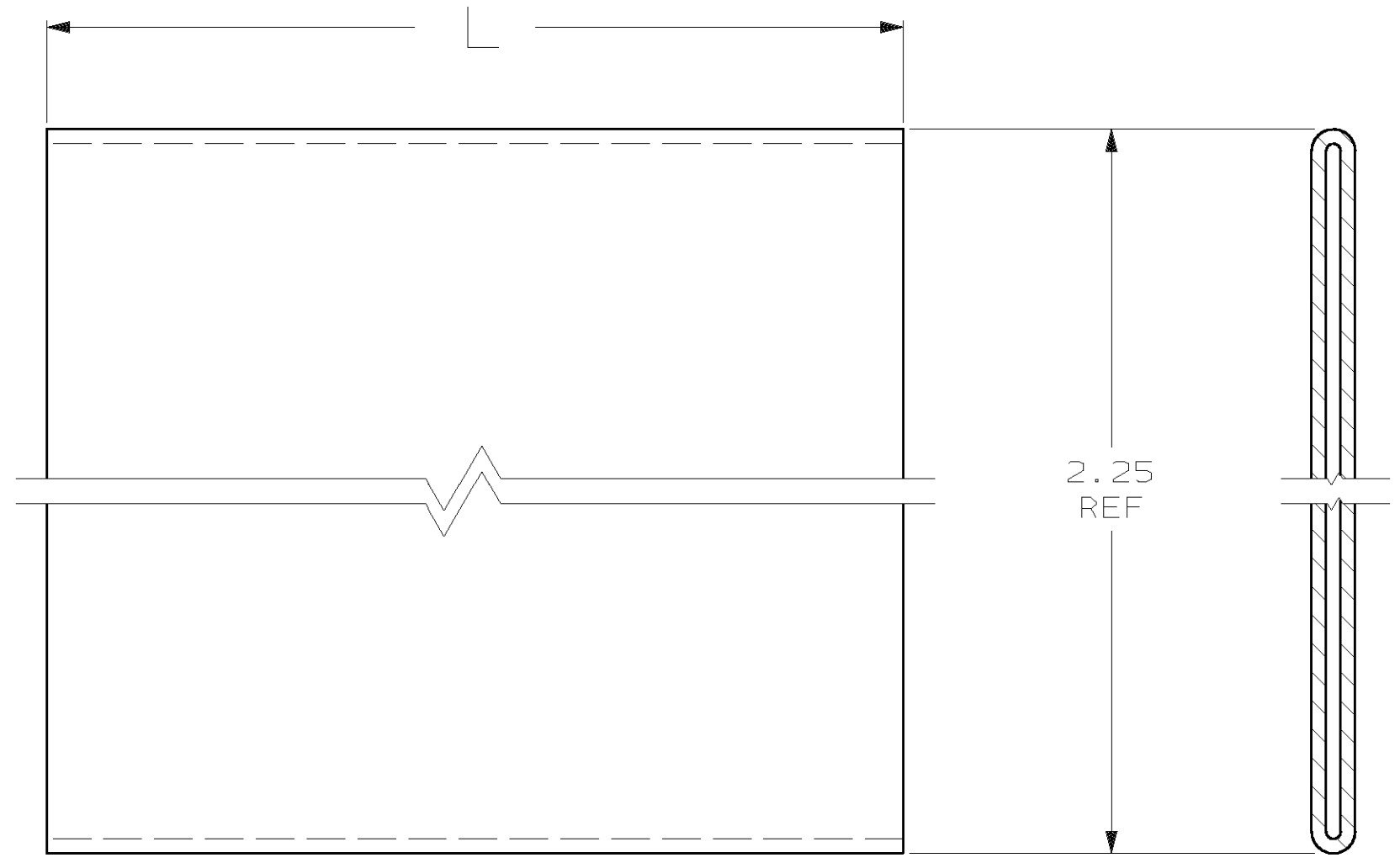

1.38±.12	30 POSN CONN	1-88450-2
2.80±.20	60 POSN CONN	1-88450-1
2.32±.18	50 POSN CONN	1-88450-0
1.82±.18	40 POSN CONN	88450-9
1.58±.12	34 POSN CONN	88450-8
1.18±.12	26 POSN CONN	88450-7
1.08±.12	24 POSN CONN	88450-6
.88±.12	20 POSN CONN	88450-5
.74±.06	16 POSN CONN	88450-4
.64±.06	14 POSN CONN	88450-3
.44±.06	10 POSN CONN	88450-2
120.00±2.00	-	88450-1

L	USED WITH	PART NUMBER

1 PVC LAY FLAT TUBING 94V-1 RATED.

DO NOT SCALE PRINT. UNLESS SPECIFIED DIMENSIONS IN INCHES. TOLERANCES ON: 2 PLC DEC ± - 3 PLC DEC ± - ANGLES ± -		DR 2-16-90 J GALLUCCI B6	AMP INCORPORATED Harrisburg, Pa. 17105	
MATERIAL	1	CHK -		
FINISH COLOR: NATURAL		APPD -	SIZE B	FSCM NO 00779
		PRODUCT SPEC -	DRAWING NO 88450	
		APPLICATION SPEC -	SCALE 10:1	SHEET 1 OF 1
		WEIGHT -	PART NO	

单击下面可查看定价，库存，交付和生命周期等信息

[>>TE Connectivity\(泰科\)](#)