

CUSTOMER MODIFIED PART

322A112-3-G01

a. Part as supplied

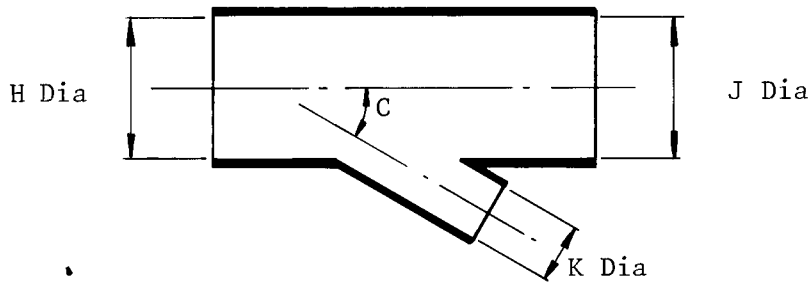

b. Part after unrestricted recovery

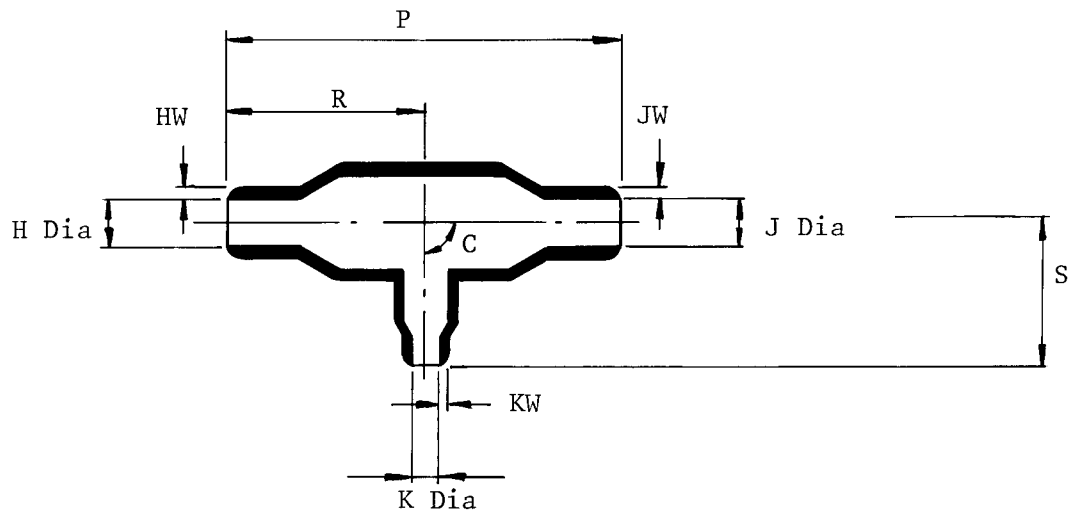

DIMENSIONS (IN MILLIMETRES)

Part Number	H & J		K		P	R	S	HW	JW	KW	C	
	Min a	Max b	Min a	Max b	+10% -b	+10% -b	+10% -b	+20% -b	+20% -b	+20% -b	+10° -a	+ 5° -b
322A112 -3-G01	18	5,8	8,0	3,0	52	26	19	1,5	1,5	1,0	20	90

Issued by

*J. Heurich*

Issue 1

Date MAY 1978

Approved by

*S. D. Smyth*

## Ordering Information

202A163-\*G13/\*\*-0

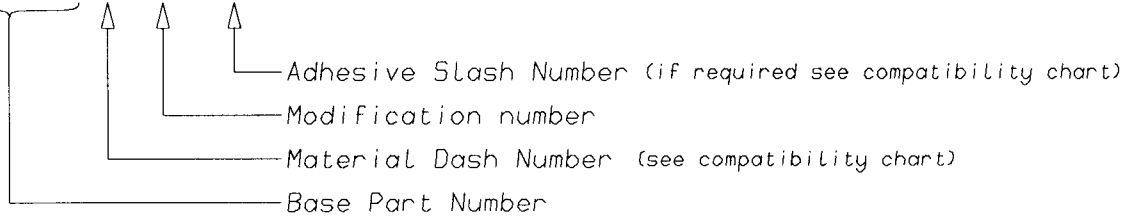

## COMPATIBILITY CHART

MATERIAL DASH NUMBER	MATERIAL DESCRIPTION	COATING SLASH NUMBER
-3	POLYOLEFIN, SEMI-RIGID	/42, /86
-4	POLYOLEFIN, FLEXIBLE	/42, /86
-25	ELASTOMER, FLUID RESISTANT	/86, /225

AS SUPPLIED DIMENSIONS ARE FOR UNCOATED PARTS,  
WHEN COATING IS ADDED, ENTRY DIAMETERS WILL REDUCE BY 1.5mm MAX.

Raychem  
 Electronics OEM Division Europe  
 Swindon, Wiltshire, England.  
 Telephone: (01793) 528171 Fax: 573923

单击下面可查看定价，库存，交付和生命周期等信息

[>>TE Connectivity\(泰科\)](#)