

DRAWING MADE IN THIRD ANGLE PROJECTION

© COPYRIGHT 1960 BY AMP INCORPORATED, HARRISBURG, PA.
ALL INTERNATIONAL RIGHTS RESERVED. AMP INCORPORATED PRODUCTS
COVERED BY U.S. AND FOREIGN PATENTS AND/OR PATENTS PENDING.

| | | | |
|-----|---------------------------|-----------|-------|
| AC | OBS -2 PER AD1831 | 3-22-88 | UB |
| AD | REV PER 0010-1582-95 | 1-30-97 | PB/RR |
| AE | REV PER EC 0320-344-97 | 24 Nov 97 | NJS |
| AE1 | REVISED PER ECO-09-026346 | 25NOV09 | AEG |

| REVISIONS | | | | | | | | | |
|-----------|-----|------|-----|---------------------------|-----------|----------|--|--|--|
| | | | | | | | | | |
| | | ZONE | LTR | DESCRIPTION | DATE | APPROVED | | | |
| ✓ | W | | | REDRAWN PER ECN 3834 m.s. | 6-12-73 | | | | |
| ✓ | Y | | | REVISED | 4501 m.s. | 7-28-75 | | | |
| ✓ | Y1 | | | ADDED -9 | 6507 m.s. | 3-80 | | | |
| ✓ | Z | | | REVISED PLATING | 7665 12. | 11-13-81 | | | |
| ✓ | AA | | | REVISED | 7818 m.s. | 2-82 | | | |
| ✓ | AA1 | | | OBS -7-B & -9 AD1112 | 2-11-86 | SP | | | |
| ✓ | AB | | | REV PER AD1327 | 7-23-86 | EP/RR | | | |

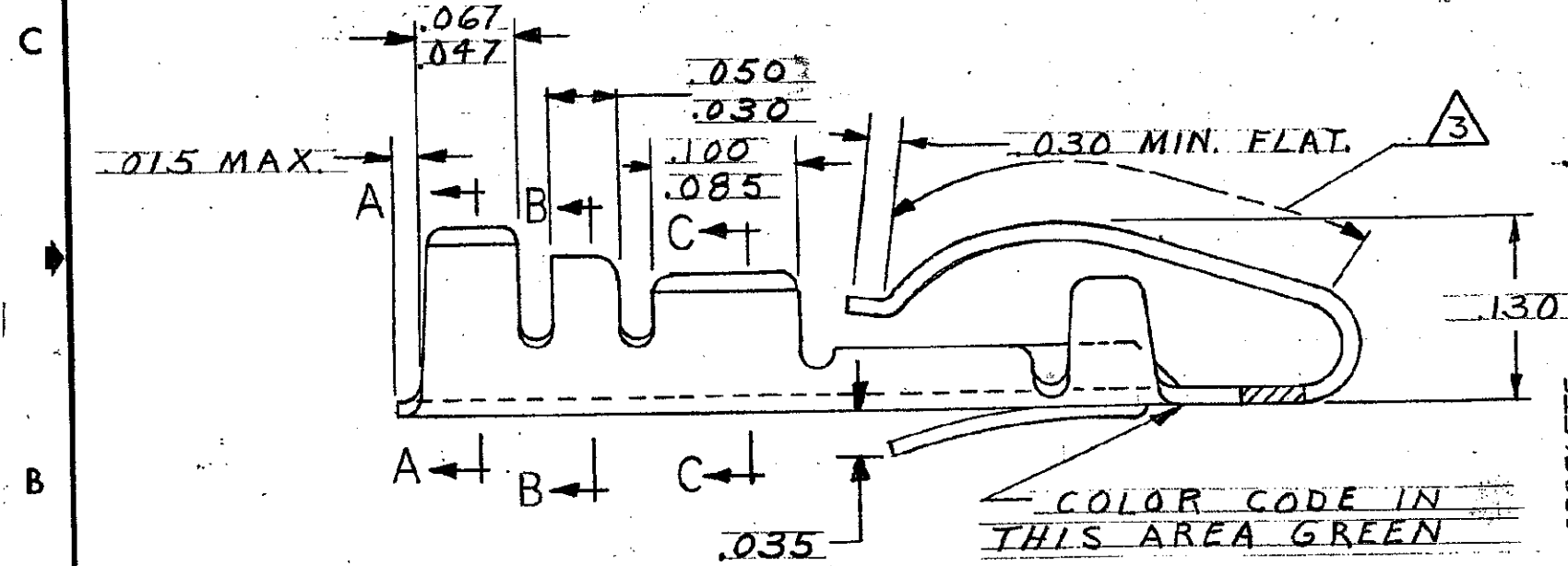
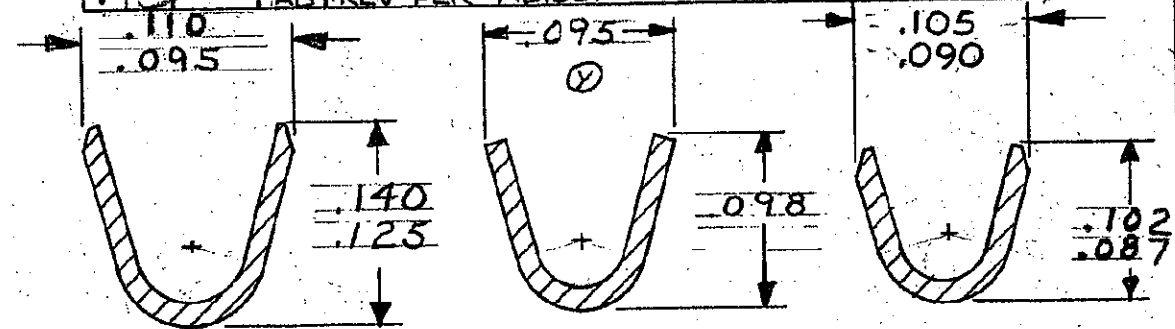
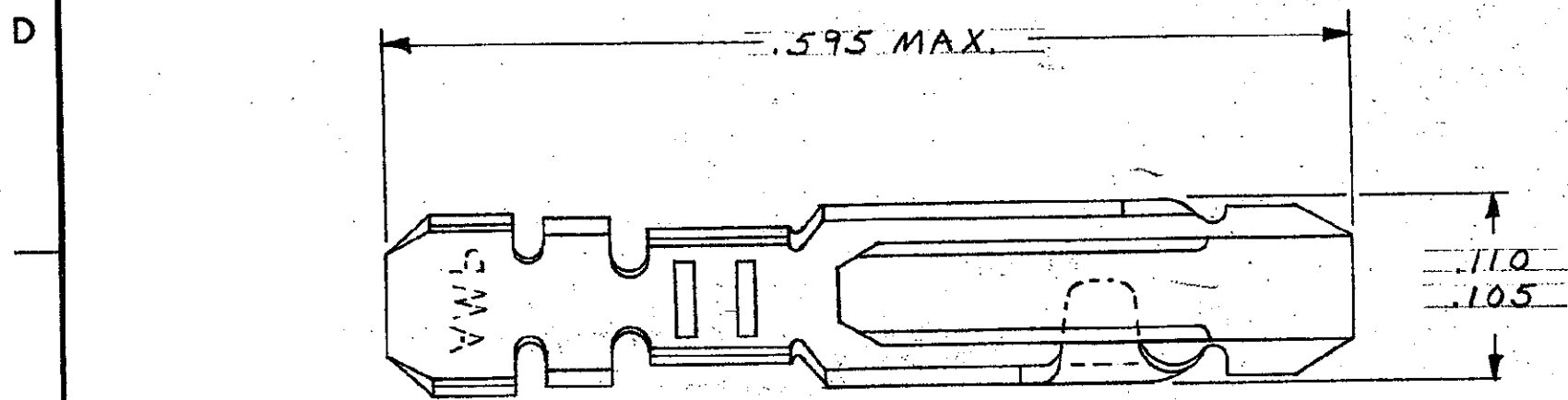

SECT. A-A INSULATION RANGE .055 - .080
SECT. B-B WIRE RANGE #22 - #18
SECT. C-C WIRE RANGE #22 - #18

| OBSELETE | PART NO. | FINISH |
|----------|----------|--|
| △ | 42840-9 | |
| | 42840-8 | .000030 GOLD IN CONTACT AREA ONLY OVER .000030 NICKEL ALL OVER. |
| | 42840-7 | .000006 GOLD OVER NICKEL |
| △ | 42840-6 | .000015 GOLD OVER .000050 NICKEL |
| | 42840-3 | .00003 GOLD OVER NICKEL |
| | 42840-2 | TIN |

COLOR CODE IN THIS AREA GREEN

- △ 1 PHOS. BRONZE, .010 COMM.
- △ 2 .120 MAX. SUM OF INSULATION DIAMETERS.
- △ 3 .000015 GOLD OVER .000050 NICKEL IN CONTACT AREA, REMAINDER OF CONTACT NICKEL PLATED.

△ 4 OBSOLETE PARTS: OBSOLETE CIS STREAMLINING PER D.RENAUD/D.SINISI

| | | | | |
|--|--|-------------------------------------|-----------------------------|-----------------|
| CODE IDENT | DWG SIZE | PART NO OR IDENTIFYING NO | NOMENCLATURE OR DESCRIPTION | ITEM NO |
| REVISION OF EACH ASSY NO (WHEN BLANK, USE DWG REVISION) | | | | |
| QTY REQD PER ASSY | | PARTS LIST | | |
| UNLESS OTHERWISE SPECIFIED DIMENSIONS ARE IN INCHES. TOLERANCES ON: DECIMALS ± .005 ANGLES ± | CONTRACT NO DR <i>M. Smich</i> 6-12-73 CHK <i>M. J. Lee</i> 6-14-73 APPD <i>D. J. ...</i> 6-15-73 APPD <i>R. ...</i> 6-15-73 | AMP INCORPORATED Harrisburg, Pa. | | |
| MATERIAL △ | NAME AMP LEAF CONTACT LOOSE PIECE | SIZE B | CODE IDENT NO 00779 | NUMBER 42840 |
| FINISH | OTHER APPD | SCALE NTS | SHEET 1 OF 1 | |

CUSTOMER DRAWING

单击下面可查看定价，库存，交付和生命周期等信息

[>>TE Connectivity\(泰科\)](#)