

DO NOT SCALE

DIMENSIONS IN MM.

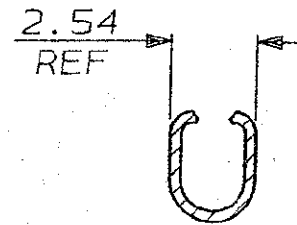

SECTION X-X

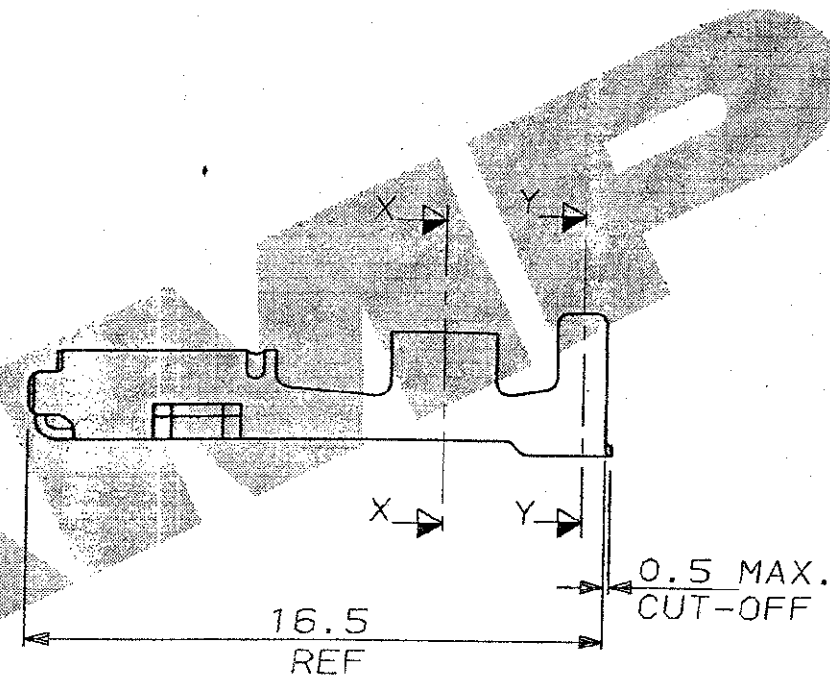
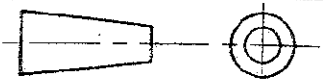

SECTION Y-Y

WIRE RANGE: 0.75 TO 2.00 mm²

INSULATION RANGE: 1.65 TO 2.70 mm DIA.

THIN WALLED CABLE TO BE USED

PRODUCT SPEC. 108-3069

APPLICATION SPEC. 114-3040

H/TOOL PN.525317-2 (FOR 0.75-1.0mm² WIRES).

H/TOOL PN.525317-4 (FOR 1.5-2.0mm² WIRES).

SEALED APPLICATIONS ONLY.

| | | | | | |
|------------------------------------|--|---|--|---|--|
| PRE-TINNED BRASS | | MADE FROM STRIP PN.345806-1 | | 345150-1 | |
| FINISH | | MATERIAL | | PART NUMBER | |
| CUSTOMER DWG FOR REFERENCE ONLY | | © COPYRIGHT 1991 BY AMP OF GREAT BRITAIN LTD. ALL INTERNATIONAL RIGHTS RESERVED. ALL PRODUCTS MAY BE COVERED BY BRITISH AND FOREIGN PATENTS AND/OR PATENTS PENDING. | | RELEASED FOR PUBLICATION 02 JUL 1991 | |
| - | | TOLERANCES UNLESS OTHERWISE STATED : | | DR. R.J.S. 2.7.91 | |
| - | | DEC ± 0.5 | | CH. M.McG. APP. J.P. | |
| - | | ANGLES ± 1° | | AMP of Great Britain Ltd. | |
| - | | NAME | | TERMINAL HOUSE STANMORE MIDD. | |
| A E500-0041-01 | | 14.02.91 | | LOOSE PIECE .070" RECEPTACLE ECONOSEAL 3 L.C. (SEALED) | |
| 1 PRELIM. ISSUE | | 2.7.91 | | SCALE LOC SIZE DWG.No. | |
| REV APPROVED | | ECN DATE | | 5/1 E A3 C345150 | |
| | | | | REV SHEET A 1/1 | |

单击下面可查看定价，库存，交付和生命周期等信息

[>>TE Connectivity\(泰科\)](#)