

THIS DRAWING IS UNPUBLISHED. RELEASED FOR PUBLICATION - N/A .  
 © COPYRIGHT N/A By - ALL RIGHTS RESERVED.

LOC	DIST	REVISIONS					
		P	LTR	DESCRIPTION	DATE	DWN	APVD
DF	S0	E		REV PER ECO-12-007863	26APR12	PY	DE

- ① CAVITY LETTERS MARKED PER MIL-STD-130 WITH WHITE INK.
- ② AMP INFORMATION MARKED PER MIL-STD-130.
- ③ PIGTAILS ARE SOLDERED DIPPED.
- ④ INSULATION CUT, BUT NOT REMOVED.

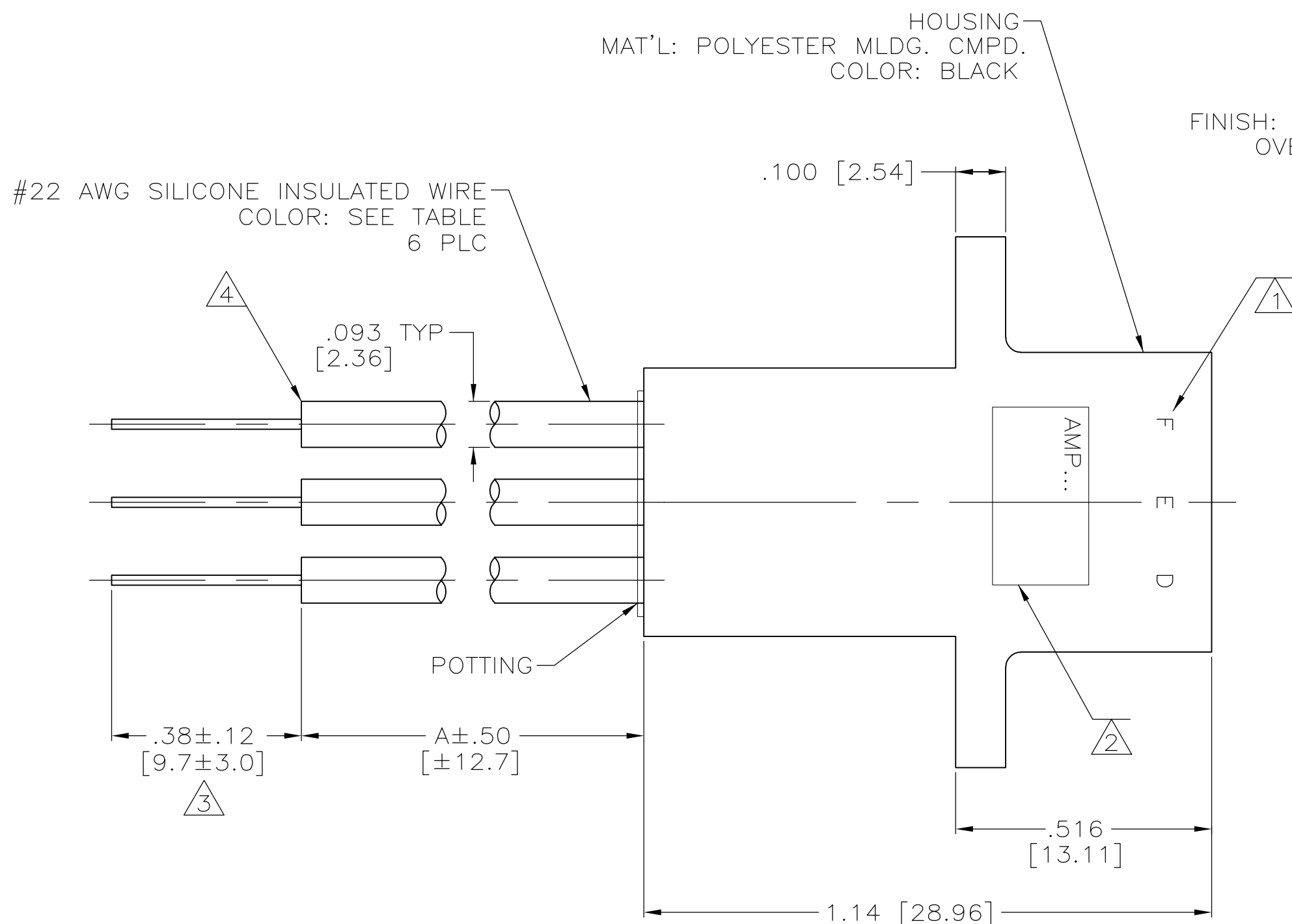

SOCKET CONTACT (QTY 6)  
 MAT'L: LEADED COPPER  
 FINISH: GOLD PLATED PER ASTM-B-488  
 OVER NICKEL PER AMS-QQ-N-290

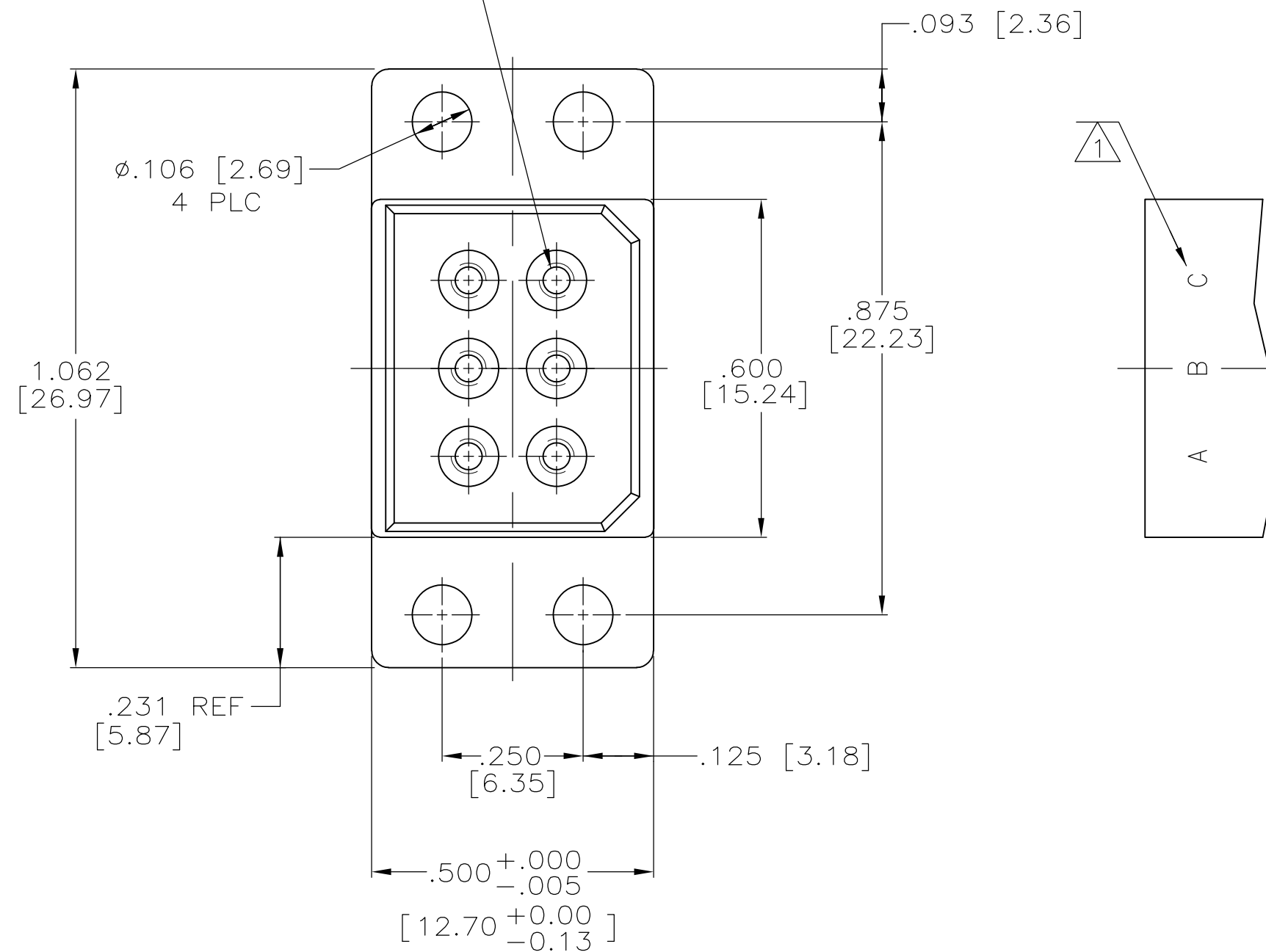

A	BROWN
B	RED
C	GREEN
D	BLUE
E	BLACK
F	WHITE

SCHEMATIC

	④	12.00 [304.8]	5-867473-1
OBSOLETE	③	36.00 [914.4]	867473-3
OBSOLETE	③	24.00 [609.6]	867473-2
	③	12.00 [304.8]	867473-1
REMARKS	"A" DIM		PART NO.

THIS DRAWING IS A CONTROLLED DOCUMENT.		DWN	C.C.THOMAS	31-MAY-00	 TE Connectivity
DIMENSIONS: INCHES [mm]		CHK	D.EABY	31-MAY-00	
TOLERANCES UNLESS OTHERWISE SPECIFIED:		APVD	D.EABY	31-MAY-00	
0 PLC ± - 1 PLC ± - 2 PLC ± .03 [0.8] 3 PLC ± .015 [0.38] 4 PLC ± - ANGLES ± - FINISH SEE TABLE		PRODUCT SPEC	NAME		
MATERIAL SEE TABLE		APPLICATION SPEC	RCPT ASSY 6 POSN WITH FLYING LEADS LGH		RESTRICTED TO
		WEIGHT	-	SIZE	A2
		CUSTOMER DRAWING	SCALE	4:1	SHEET
				00779	1 of 1
				867473	REV
					E

单击下面可查看定价，库存，交付和生命周期等信息

[>>TE Connectivity\(泰科\)](#)