

REVISIONS					
P.	LTN	DESCRIPTION	DATE	DMN	APVD
A18	ECR-16-006173		04MAY2016	MB	JK
A19	ECR-16-009404		22SEP2016	MB	JK
A20	ECR-17-005648		21OCT2017	MB	PSI
A21	ECR-18-014391		24SEP2018	SCK	RP

CONTACTS FOR FLR-CABLE
 Kontakte fuer FLR-Leitung

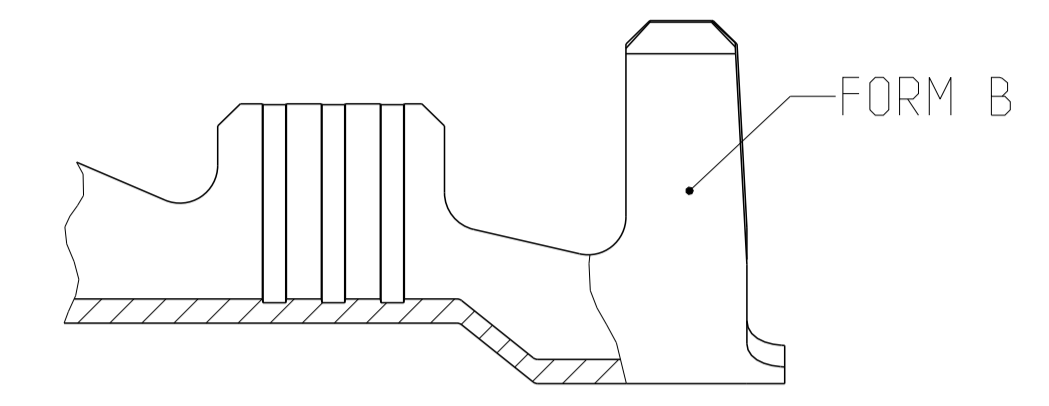

DESIGN 963898 / 963900 / 963904
 Ausfuehrung 963898 / 963900 / 963904

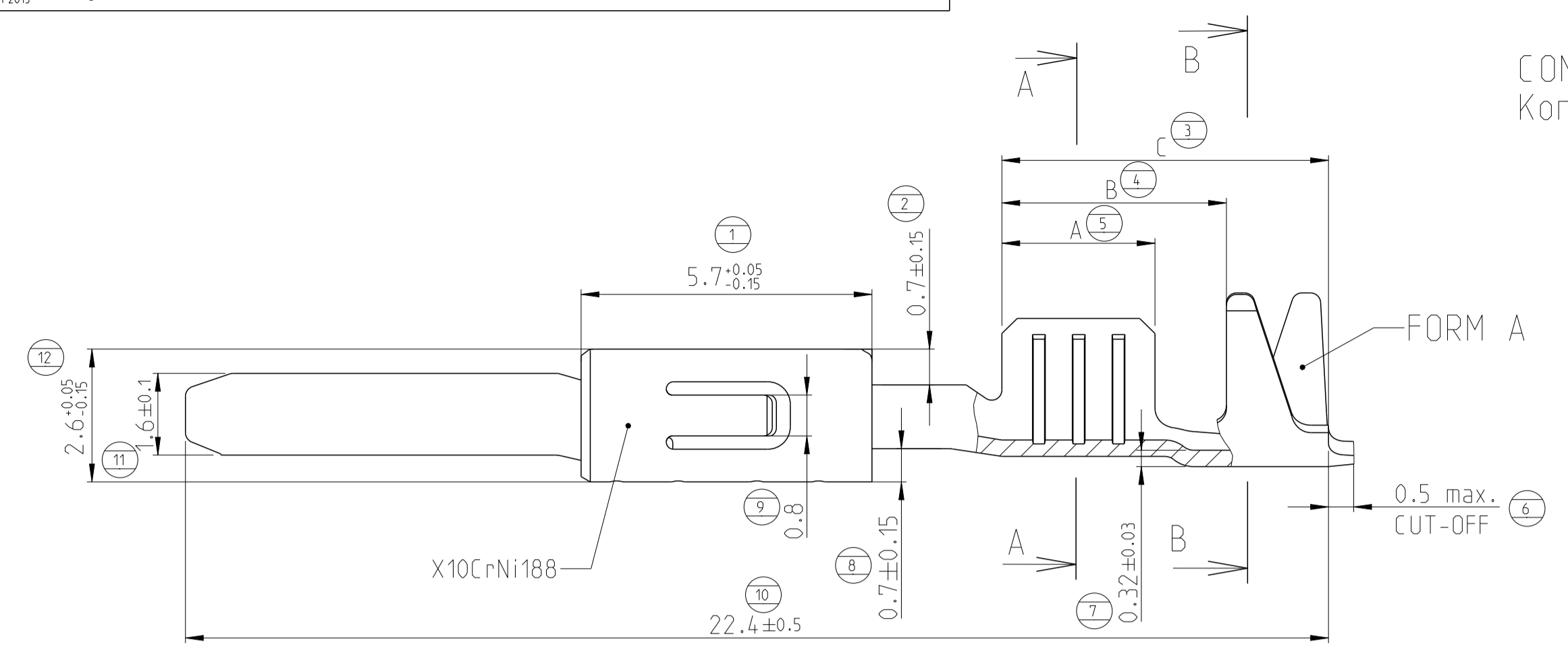
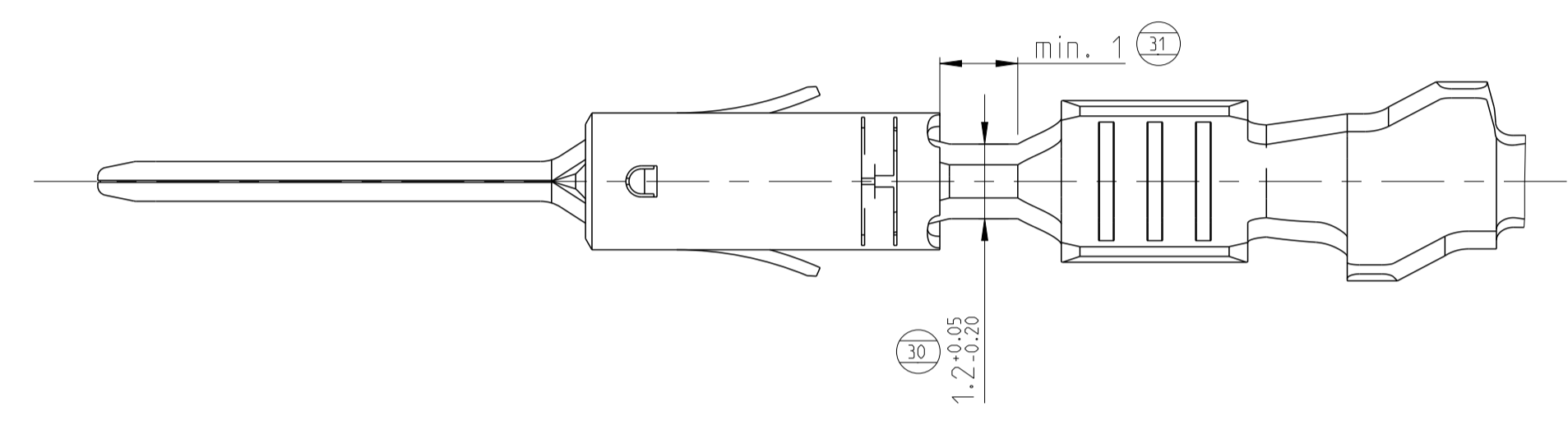
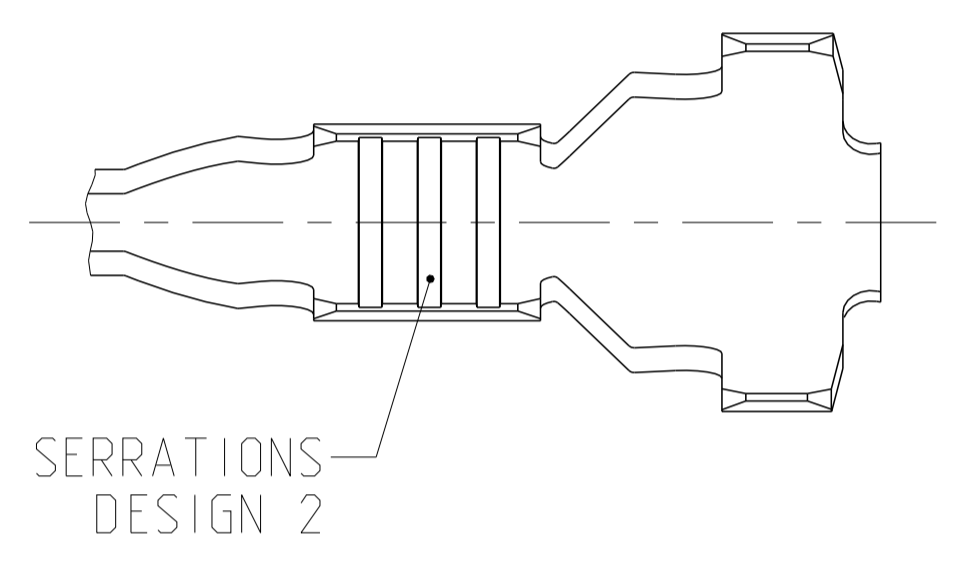
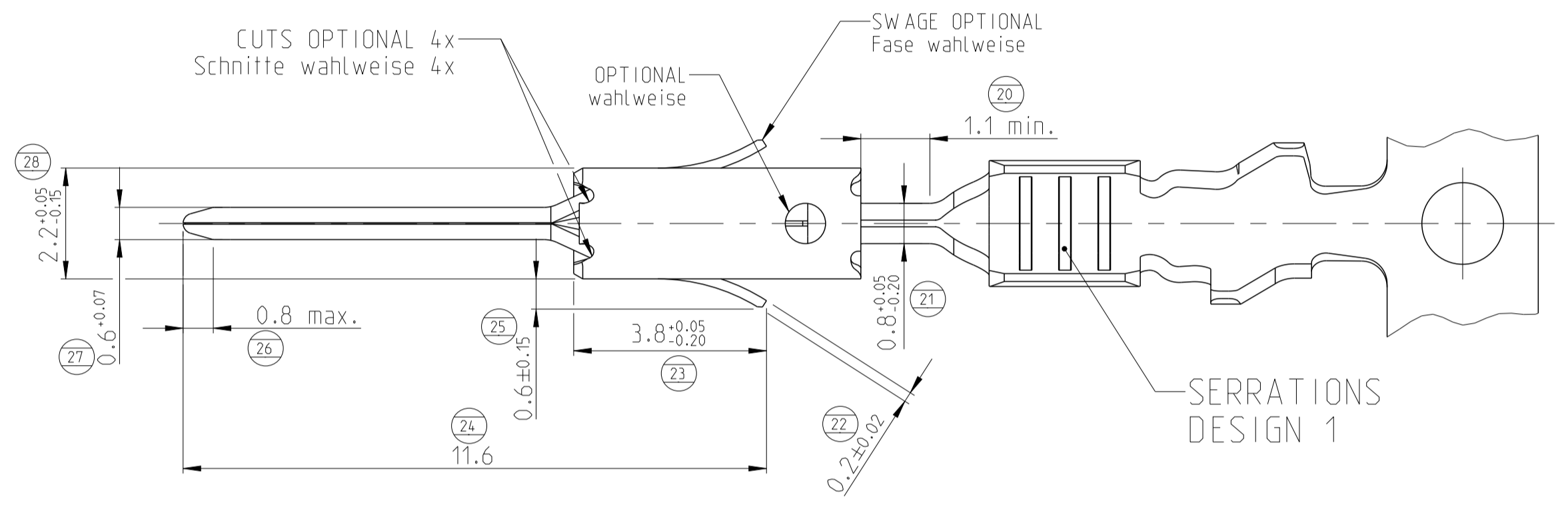
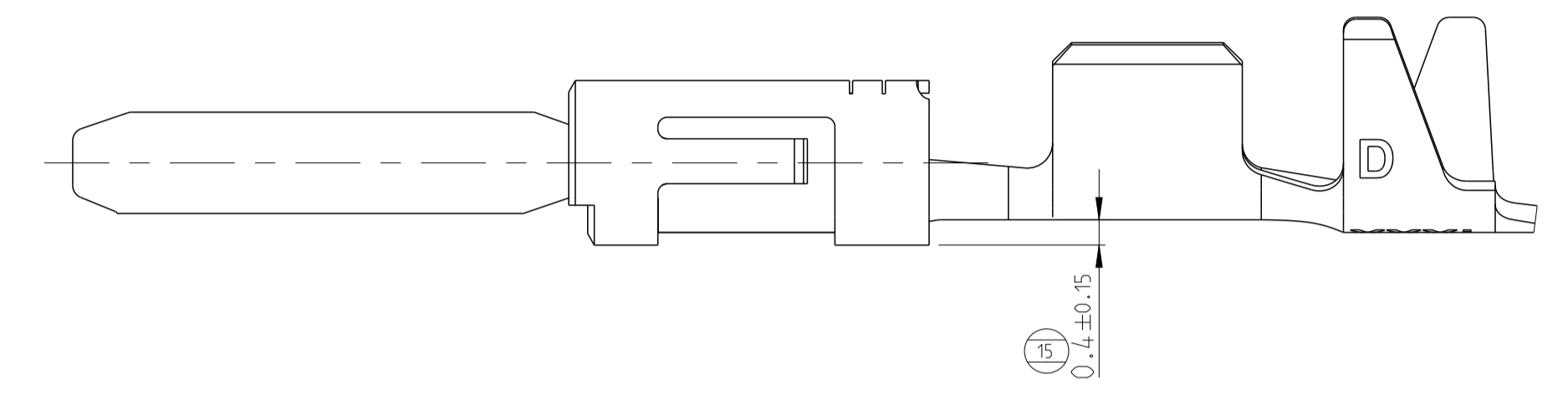

CONTACTS FOR SINGLE WIRE SEALING SYSTEM:
 FLR- AND FLK-CABLE
 Kontakte fuer Einzeldichtung-System:
 FLR- und FLK-Leitung

DIMENSIONS SEE FIGURE CONTACTS FOR FLR-CABLE
 Masse siehe Darstellung der Kontakte fuer FLR-Leitung

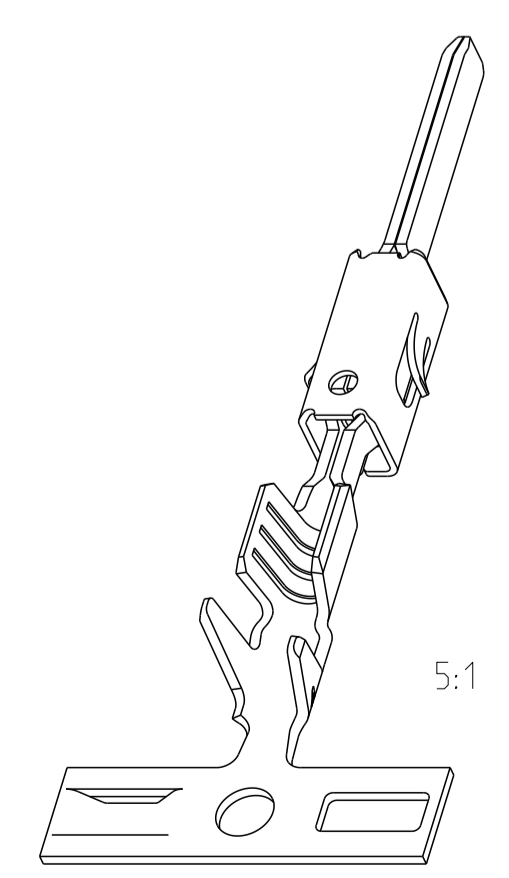
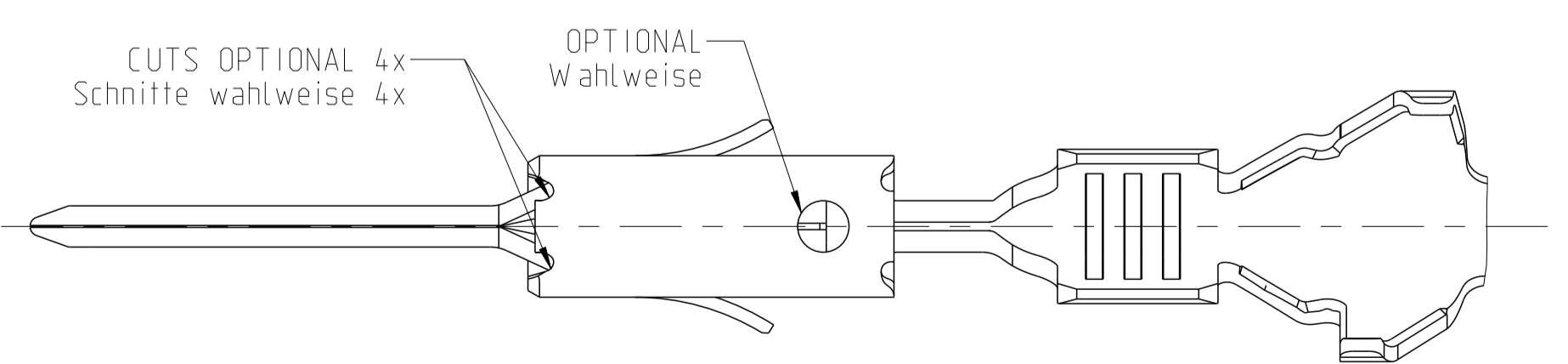
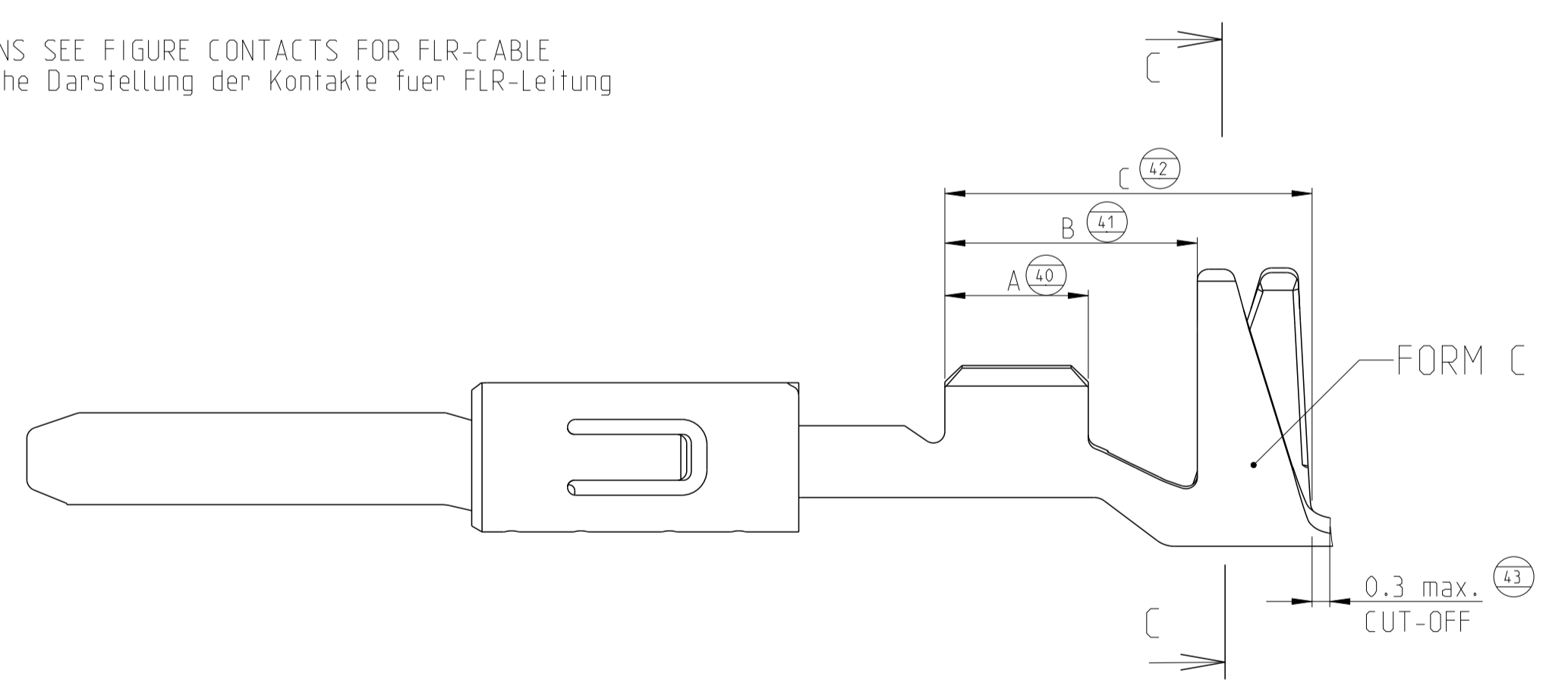

DESIGN 963902
 Ausfuehrung 963902

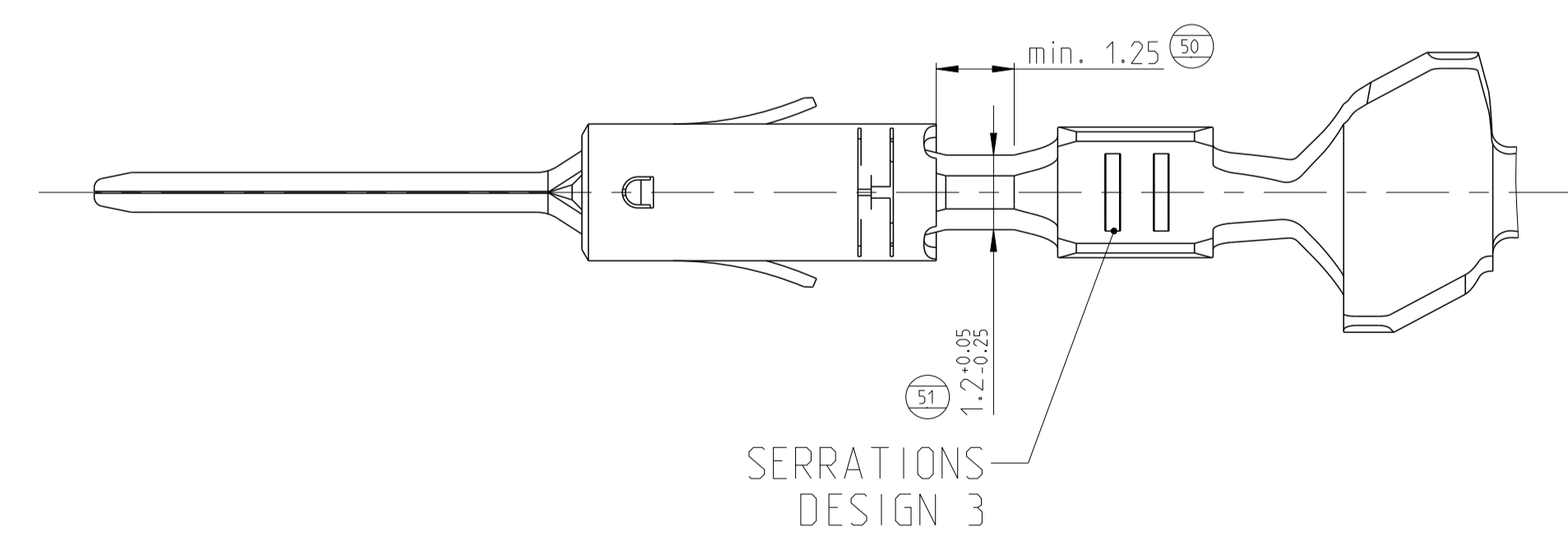
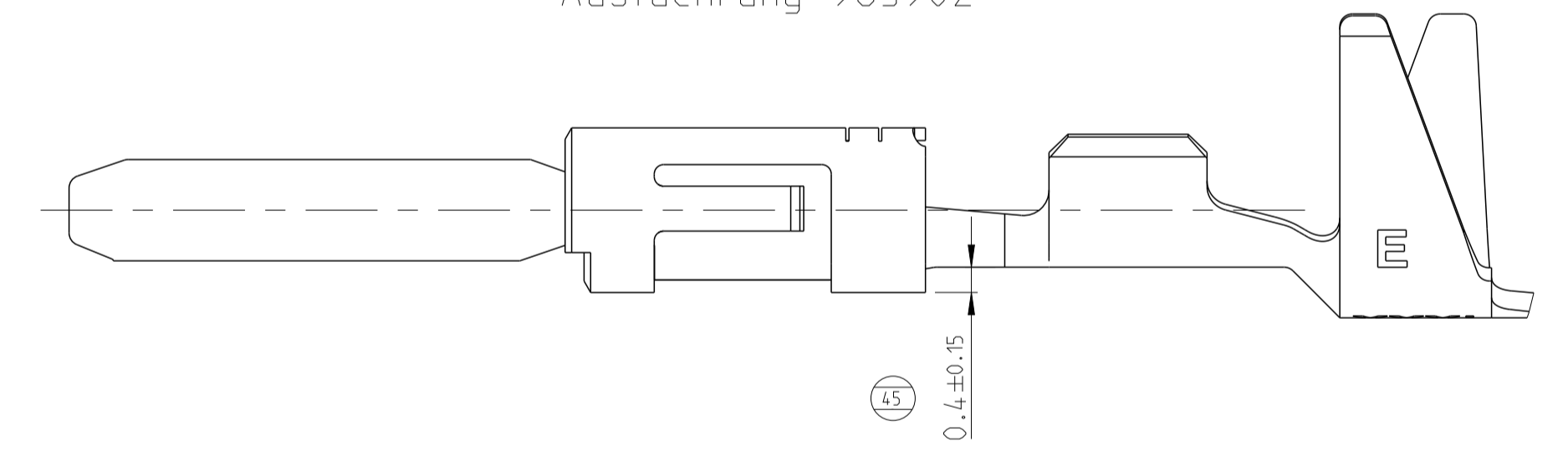

SERRATIONS DESIGN 3

THIS DRAWING IS A CONTROLLED DOCUMENT.		DMN T. Bensch 11JUN1997	TE Connectivity NAME PRODUCT GROUP DRAWING TAB 1.6 x 0.6 Flachstecker 1.6 x 0.6
DIMENSIONS: mm		CHK U. Muenk 11JUN1997	
TOLERANCES UNLESS OTHERWISE SPECIFIED: mm		APVD M. Bleicher 02MAR2011	SIZE CAGE CODE DRAWING NO
1-PLC ±0.2 2-PLC ±0.2 3-PLC ±0.2 ANGLES ±0.2		PRODUCT SPEC 108-18331	RESTRICTED TO
MATERIAL SEE TABLE sheet 2 siehe Tabelle		FINISH SEE TABLE sheet 2 siehe Tabelle	WEIGHT -
CUSTOMER DRAWING		SCALE 10:1	SHEET 1 OF 2

THIS DRAWING IS UNPUBLISHED. RELEASED FOR PUBLICATION 2011
 ALL RIGHTS RESERVED.
 COPYRIGHT 2011

REVISIONS				
P. LTR.	DESCRIPTION	DATE	DWN.	APVD.
-	SEE SHEET 1	-	-	-

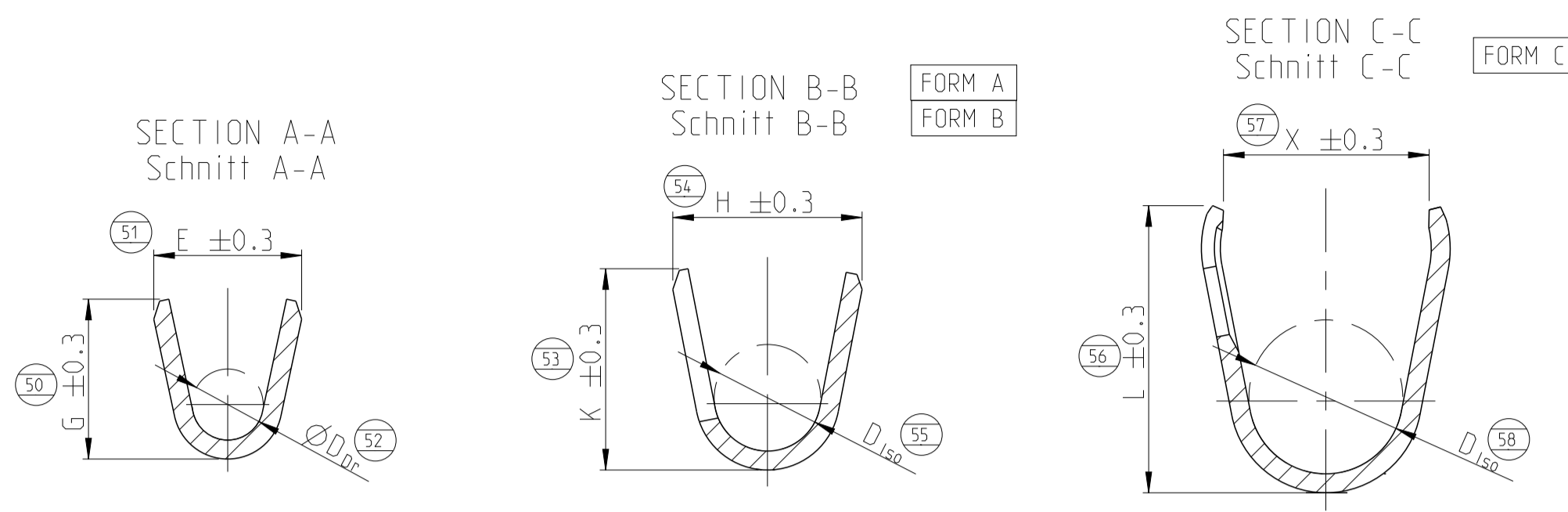

- 1 CONTACT AREA SELECTIVE GOLD 0.8µm MIN. OVER NICKEL. WIRE CRIMP AREA ELECTRO TIN PLATED 1µm MIN. OVER NICKEL. Kontaktzone selectiv vergoldet 0.8µm min. ueber Ni. Drahtcrimpbereich gal. verzinkt 1µm min. ueber Ni
- 2 FOR DOUBLE- AND SINGLE TERMINATION fuer Doppel- und Einzelanschlaege
- 3 SINGE WIRE SEAL TO BE SELECTED ACCORDING TO INSULATION-DIA ACCODING TO APPLICATION SPECIFICATION 114-18082 Auswahl der Eubzeldichtung entsprechend dem Isolationsdurchmesser nach Verarbeitungsspezifikation 114-18082
- 4 TIN PLATED vorverzinkt
- 5 CONTACT AREA SELECTIVE SILVER 3µm MIN. OVER NICKEL. WIRE CRIMP AREA ELECTRO TIN PLATED 1.5µm MIN. OVER NICKEL. Kontaktzone selectiv versilbert 3µm min. ueber Ni. Drahtcrimpbereich gal. verzinkt 1.5µm min. ueber Ni
- 6 DIFFERENT TOOL DETAILS FUNCTION AND HANDLING WITH ALL DETAILS CONTINUOUSLY SUPPLY AFTER AVAILABILITY Verschiedene Werkzeugausfuehrungen Funktion und Handhabung bei allen Ausfuehrungen gleich Lieferung nach Verfuegbarkeit

SEE / siehe SECTION A-A Schnitt A-A			SEE / siehe SECTION B-B / C-C Schnitt B-B / C-C																	
1703278-5	A	1	CuSn4	△5	1.5	1.95 - 2.4	E = 2.8 G = 3.0 D _{Dr} = 1.4	C	L = 4.9 D _{ISO} = 2.9	169400-0 539635-1	-	3.0	4.4	6.4	3.6					
1703278-2	A	1	CuFe2	△4																
2-964269-2	A	1	CuFe2	△5	0.5 - 1.0	1.4 - 2.1	E = 2.5 G = 2.7 D _{Dr} = 1.2	C	L = 4.8 D _{ISO} = 2.7							539612-1 539663-2	3.0	4.4	6.4	3.3
964269-5	A	1	CuSn4	△5																
964269-3	E	1	CuSn4	△1	0.5 - 1.0	1.4 - 2.1	E = 2.6 G = 2.8 D _{Dr} = 1.2	A	H = 4.5 K = 4.8 D _{ISO} = 2.7							539651-2	3.0	4.6	7.0	-
964269-2	D	1	CuFe2	△4																
963904-3	G	1	CuSn4	△1	0.35	1.15 - 1.6	E = 2.4 G = 2.3 D _{Dr} = 1.0	C	L = 4.8 D _{ISO} = 2.6							539663-2	2.5	4.4	6.4	3.3
963904-2	F	1	CuFe2	△4																
963904-1	F	1	CuSn4	△4	0.2 - 0.5	1.15 - 1.6	E = 2.1 G = 2.1 D _{Dr} = 0.8	C	X = 4.3 L = 4.8 D _{ISO} = 2.6							539612-1 539663-2	2.5	4.4	6.4	3.3
2141884-5	A	2	CuSn4	△5																
2141884-3	B	2	CuSn4	△1	0.2 - 0.5	1.15 - 1.6	E = 2.1 G = 2.1 D _{Dr} = 0.8	A	H = 4.5 K = 4.8 D _{ISO} = 2.7							539651-2	2.5	4.6	7.0	-
2-2141884-2	A	2	CuFe2	△5																
2141884-2	A	2	CuFe2	△4	0.2 - 0.5	1.15 - 1.6	E = 2.1 G = 2.1 D _{Dr} = 0.8	A	H = 4.5 K = 4.8 D _{ISO} = 2.7							539651-2	2.5	4.6	7.0	-
969028-5	A	3	CuSn4	△5																
969028-3	E	3	CuSn4	△1	0.2 - 0.5	1.15 - 1.6	E = 2.1 G = 2.1 D _{Dr} = 0.8	A	H = 4.5 K = 4.8 D _{ISO} = 2.7							539651-2	2.5	4.6	7.0	-
969028-2	D	3	CuFe2	△4																
963902-3	E	3	CuSn4	△1	0.2 - 0.5	1.15 - 1.6	E = 2.1 G = 2.1 D _{Dr} = 0.8	A	H = 4.5 K = 4.8 D _{ISO} = 2.7	539651-2	2.5	4.6	7.0	-						
963902-2	D	3	CuFe2	△4																
963902-1	D	3	CuSn4	△4	1.5	2.2 - 2.4	E = 2.8 G = 3.0 D _{Dr} = 1.4	A	H = 3.5 K = 3.9 D _{ISO} = 1.9	169400-0 539635-1	-	3.0	4.4	6.4	-					
1241846-5	A	1	CuSn4	△5																
1241846-3	B	1	CuSn4	△1	0.5 - 1.0	1.4 - 2.1	E = 2.5 G = 2.8 D _{Dr} = 1.2	B	H = 3.7 K = 3.9 D _{ISO} = 1.8							-	3.0	4.6	6.2	-
1241846-2	A	1	CuFe2	△4																
1241846-1	A	1	CuSn4	△4	0.5 - 1.0	1.4 - 2.1	E = 2.5 G = 2.7 D _{Dr} = 1.2	A	H = 3.2 K = 3.4 D _{ISO} = 1.8							539612-1 539663-2	3.0	4.4	6.4	-
969079-3	C	1	CuSn4	△1																
969079-2	B	1	CuFe2	△4	0.5 - 1.0	1.4 - 2.1	E = 2.5 G = 2.8 D _{Dr} = 1.2	B	H = 3.7 K = 3.9 D _{ISO} = 1.8							-	3.0	4.6	6.2	-
964267-4	A	1	CuSn4	△5																
964267-3	D	1	CuSn4	△1	0.5 - 1.0	1.4 - 2.1	E = 2.5 G = 2.7 D _{Dr} = 1.2	A	H = 3.2 K = 3.4 D _{ISO} = 1.8							539612-1 539663-2	3.0	4.4	6.4	-
964267-2	C	1	CuFe2	△4																
964267-1	C	1	CuSn4	△4	0.5 - 1.0	1.4 - 2.1	E = 2.6 G = 2.8 D _{Dr} = 1.2	A	H = 3.2 K = 3.4 D _{ISO} = 1.8							539651-2	3.0	4.6	7.0	-
963900-4	E	1	CuSn4	△1																
963900-3	E	1	CuSn4	△1	0.2 - 0.5	1.15 - 1.6	E = 2.1 G = 2.1 D _{Dr} = 0.8	A	H = 2.9 K = 2.9 D _{ISO} = 1.4							539651-2	2.5	4.6	7.0	-
963900-2	D	1	CuFe2	△4																
963900-1	D	1	CuSn4	△4	0.2 - 0.5	1.15 - 1.6	E = 2.1 G = 2.1 D _{Dr} = 0.8	A	H = 2.9 K = 2.9 D _{ISO} = 1.4							539651-2	2.5	4.6	7.0	-
963898-3	E	3	CuSn4	△1																
963898-2	D	3	CuFe2	△4	0.2 - 0.5	1.15 - 1.6	E = 2.1 G = 2.1 D _{Dr} = 0.8	A	H = 2.9 K = 2.9 D _{ISO} = 1.4	539651-2	2.5	4.6	7.0	-						
963898-1	D	3	CuSn4	△4																
2141882-3	B	2	CuSn4	△1	0.2 - 0.35	1.15 - 1.6	E = 2.4 G = 2.3 D _{Dr} = 1.0	A	H = 2.9 K = 2.9 D _{ISO} = 1.4	539633-2	2.5	4.4	6.4	-						
2141882-2	A	2	CuFe2	△4																
964265-5	A	3	CuSn4	△5	0.2 - 0.35	1.15 - 1.6	E = 2.1 G = 2.1 D _{Dr} = 0.8	A	H = 2.9 K = 2.9 D _{ISO} = 1.4	539612-1 539663-2	2.5	4.4	6.4	-						
964265-3	D	3	CuSn4	△1																
964265-2	C	3	CuFe2	△4																

SEE APPLICATION SPECIFICATION 114-18082 siehe Verarbeitungsspezifikation 114-18082

THIS DRAWING IS A CONTROLLED DOCUMENT.		OWN: T. Bertsch CHK: U. Muenk APVD: M. Bleicher	11JUN1997 11JUN1997 02MAR2011	STE TE Connectivity	NAME: PRODUCT GROUP DRAWING TAB 1.6 x 0.6 TYPE A Flachsstecker 1.6 x 0.6 Typ A	SIZE: A1 CAGE CODE: 00779 DRAWING NO: 114-18082 REVISION: A21	RESTRICTED TO:
DIMENSIONS: mm	TOLERANCES UNLESS OTHERWISE SPECIFIED: ±0.2	MATERIAL: SEE TABLE sheet 2 siehe Tabelle	FINISH: SEE TABLE sheet 2 siehe Tabelle				

单击下面可查看定价，库存，交付和生命周期等信息

[>>TE Connectivity\(泰科\)](#)