

.XXX = in
XX.X = mm

REVISIONS			
REV	DESCRIPTION	DATE	APPROVED
02 ₂	REVISED PER ECN96-0171-2	06/28/96	<i>PCH</i>
B	PER EC 0U20-0262-01	18DEC01	<i>C. Hoang</i>

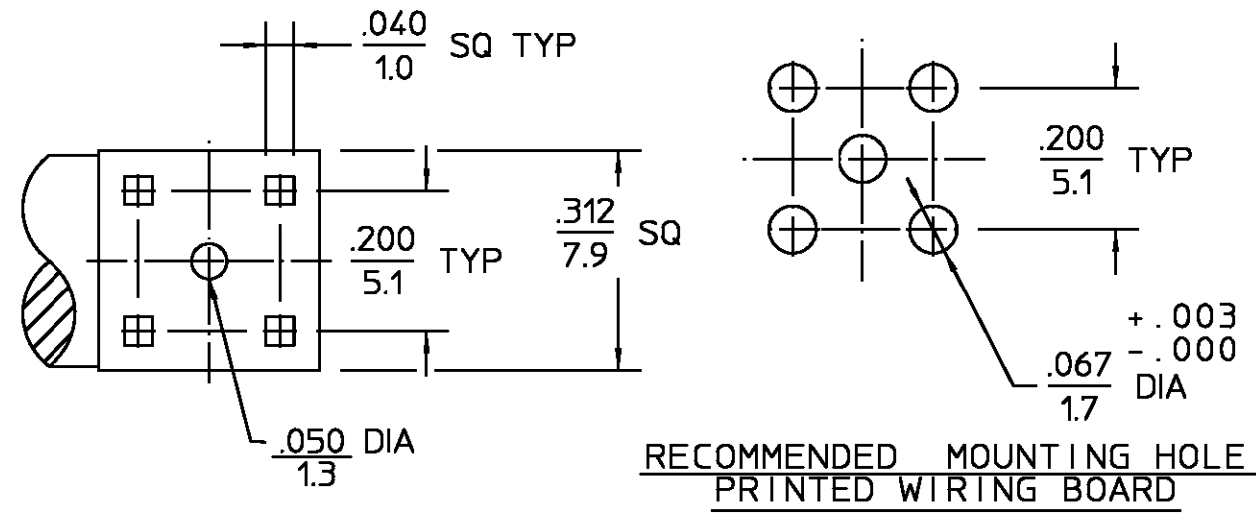

ELECTRICAL	MECHANICAL	ENVIRONMENTAL
Nominal Impedance (Ohms) <u>50</u>	Mating Characteristics: Insertion (MAX Lbs) <u>N/A</u> Withdrawal (MIN Oz) <u>N/A</u> Force to Engage (In-Lbs MAX) <u>3.0</u> & Disengage (In-Lbs MAX) <u>15</u> Center Contact Captivation Axial (Lbs) <u>6.0</u> Radial (in-oz) <u>4.0</u>	Temperature Rating <u>-40° to +105°C</u>
Frequency Range (GHz) DC to <u>6</u>		Vibration MIL-STD-1344, Method 2005, Condition V-F
Return Loss <u>20.0 dB Min</u>		Shock MIL-STD-1344, Method 2004 Condition A
Insertion Loss (dB MAX) <u>N/A</u>		Thermal Shock MIL-STD-1344 Method 1003, Condition A
RF Leakage (dB MIN) (Interface Only, Fully Mated) <u>-[60-f(GHz)]</u>		Moisture Resistance MIL-STD-1344 Method 1002 Cond B Type I
Corona, 70,000 Ft (VRMS MIN) <u>190</u>		Corrosion - MIL-STD-1344, Method 1001, 48 Hrs
Dielectric Withstanding Voltage (VRMS MIN) @ Sea Level <u>500</u>		
Contact Resistance (Milliohms MAX) Center Contact <u>2.0</u> Outer Contact <u>5.0</u>		
RF High Potential @ Sea Level (VRMS MIN @ 5 MHz) <u>500</u>		
LR.(Megohms MIN) <u>10000</u>		

COMPONENT	MATERIAL	FINISH
HOUSING CAP MOUNTING NUT LOCKWASHER	BRASS PER ASTM-B-16 HALF HARD	GOLD PLATE PER MIL-G 45204 OVER NICKEL PLATE
DIELECTRIC	TFE FLUOROCARBON PER ASTM-D-1457	N/A
CENTER CONTACT	BRASS PER ASTM-B-16 HALF HARD	GOLD PLATE PER MIL-G-45204 OVER COPPER PLATE PER MIL-C-14550
'O' - RING	FLOUROSILICONE PER MIL -R-25988, CL 1, TYPE 1	N/A

UNLESS OTHERWISE SPECIFIED DIMENSIONS ARE IN INCHES TOLERANCE ON

FRAC.	DEC.	ANGLES
± 1/64	±.005	± °

These drawings and specifications are the property of M/A-COM Incorporated and shall not be reproduced or copied or used in whole or in part as the basis for the manufacture or sale of item(s) without written permission.

DRAWN BY *PCH* DATE 4/8/96
CHECKED BY
APPD BY

USE ASS'Y PROCEDURE
NO. AP. N/A

AMP Incorporated
140 Fourth Avenue
Waltham, MA 02451-7599

TITLE OSP RIGHT ANGLE PLUG PCB MOUNT

SIZE B	CODE IDENT NO. 26805	4465-5001-94	REV 02 ₂
SCALE 8 : 1	N/A	SHEET 1 OF 1	

CUSTOMER DRAWING

AMP PART # 1059350-1
SHEET 1 OF 1 REV B

单击下面可查看定价，库存，交付和生命周期等信息

[>>TE Connectivity\(泰科\)](#)