

THIS DRAWING IS UNPUBLISHED. RELEASED FOR PUBLICATION
 BY AMP INCORPORATED. ALL RIGHTS RESERVED.

LOC		DIST		REVISIONS			
P	LTR	DESCRIPTION	DATE	DWN	APVD		
	C	REV; EC 0210-0674-95	10-25-95	LM/UTA			
	D	REV PER EC 0320-68-97	06 MAR 97	MB	MM		
	E	REV PER EC 061C-95-98	14 JUL 98	CO	MC		

- ① ALL DIMENSIONS SHOWN ARE MAXIMUM UNLESS OTHERWISE SPECIFIED.
- ② MATERIAL: 2.54μm [0.000100] MINIMUM TIN PLATED COPPER ALLOY 0.74-0.79 [0.030±.001] THICK.
- 3. WIRE BARREL ACCEPTS ONE 14, 16 OR 18 AWG STRANDED COPPER WIRE.
- ④ CONTACTS ON REEL SHALL BE CRIMPED USING APPLICATOR TOOL PN 567403.
- ⑤ LOOSE PIECE CONTACTS SHALL BE CRIMPED USING TOOLS AND DIE SETS LISTED BELOW.
 HAND TOOL: AMP PART NO. 69710
 PNEUMATIC TOOL: AMP PART NO. 69365
 DIE SET 14 AWG: AMP PART NO. 58492-1
 DIE SET 16-18 AWG: AMP PART NO. 58493-1

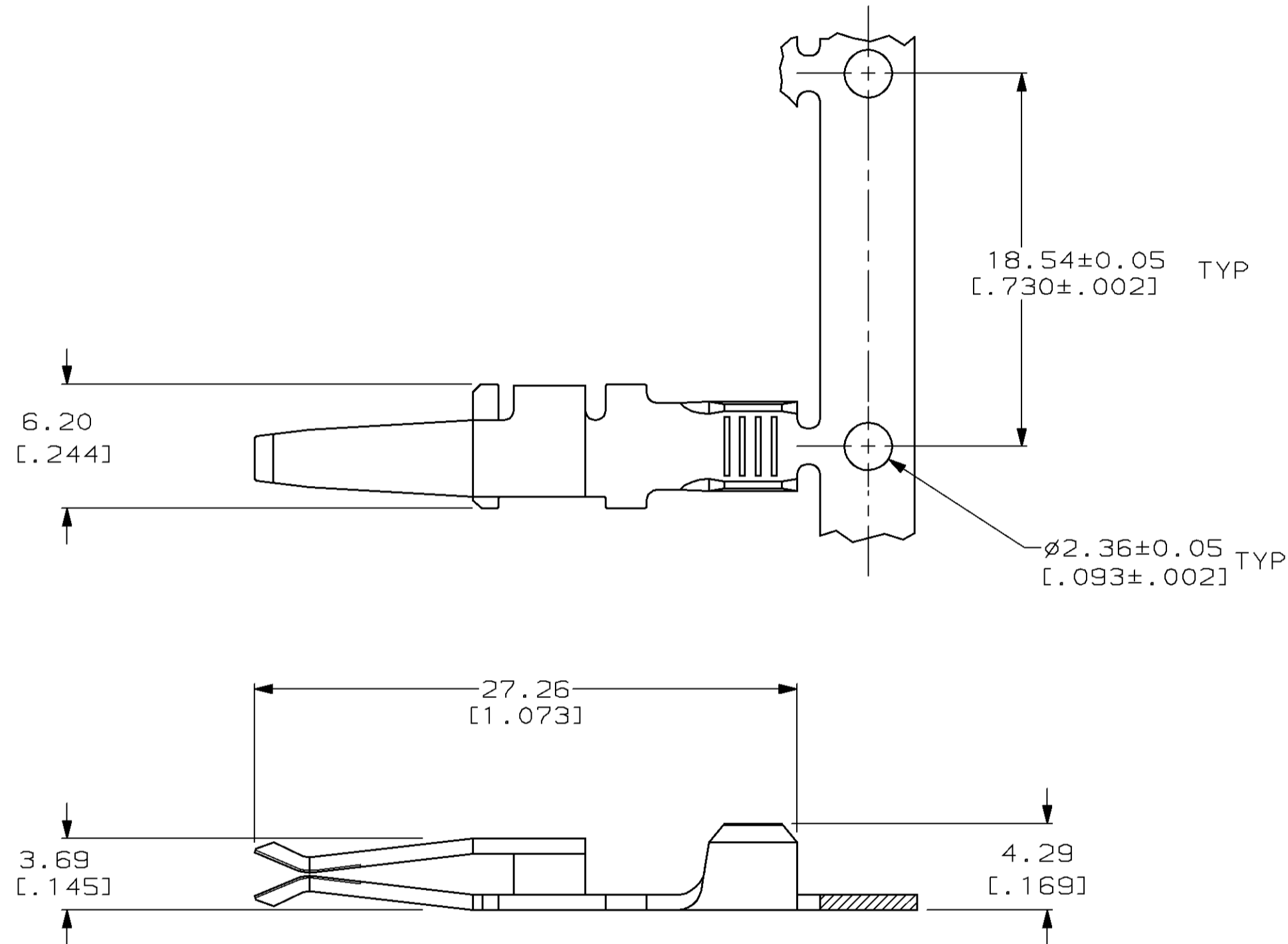

DESCRIPTION	PART NO
REEL ④	556883-2
LOOSE PIECE ⑤	556883-1

<small>THIS DRAWING IS A CONTROLLED DOCUMENT FOR AMP INCORPORATED. IT IS SUBJECT TO CHANGE AND THE CONTROLLING ENGINEERING ORGANIZATION SHOULD BE CONTACTED FOR THE LATEST REVISION.</small>		DWN D. STRAUSSER 5-29-91	AMP AMP Incorporated Harrisburg, PA 17105-3608	
DIMENSIONS: mm [INCHES]		CHK B. FOX 8-23-91	NAME CONTACT, DUAL BEAM, 14-18 AWG, WTB, AMPINNERGY™	
TOLERANCES UNLESS OTHERWISE SPECIFIED: 0 PLC ± 1 PLC ± ① 2 PLC ± 3 PLC ± 4 PLC ± ANGLES ± FINISH ②		APVD M. MILLER 8-26-91	PRODUCT SPEC 108-1349	DRAWING NO C-556883
MATERIAL ②		APPLICATION SPEC 114-6044	SIZE A2	CAGE CODE 00779
		WEIGHT -	SCALE 4:1	SHEET 1 OF 1
		CUSTOMER DRAWING	REV E	

556883

0

A

单击下面可查看定价，库存，交付和生命周期等信息

[>>TE Connectivity\(泰科\)](#)