

REVISIONS			
LTR	DESCRIPTION	DATE	APPROVED
C	REVISED PER ECN T-013336	890928	J.BLAIR
D	REVISED PER DCR# T-22996	6/11/99	M.HIGGY

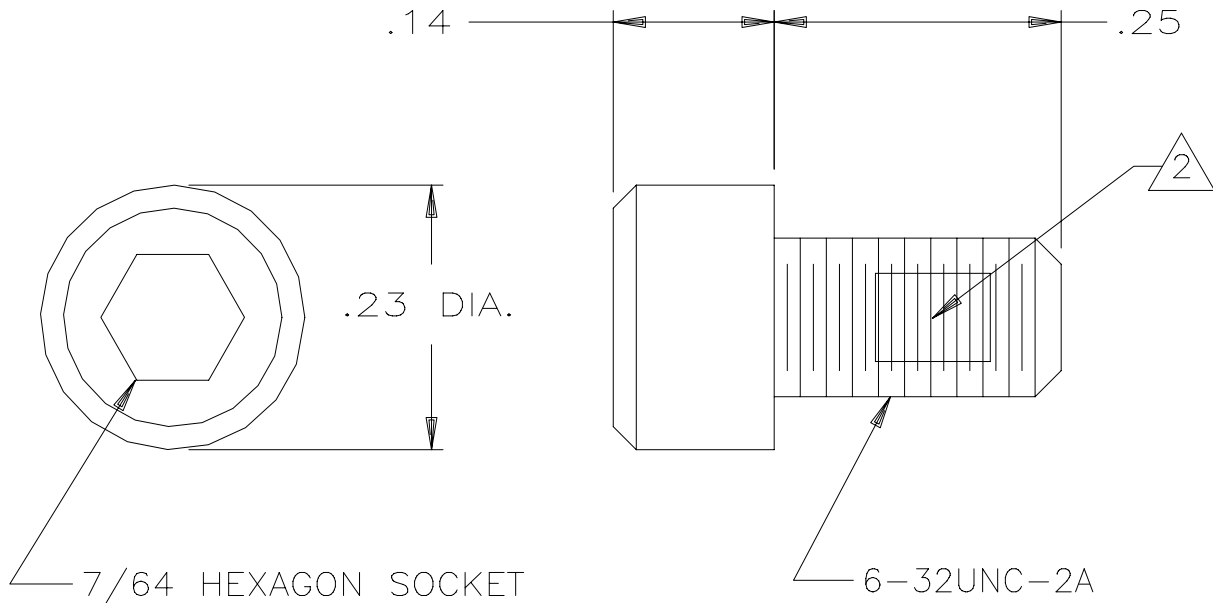

NOTES:

- PART USED WITH MTC RECEPTACLE ASSEMBLIES.
- SCREW PROVIDED WITH LOCKING ELEMENT IN ACCORDANCE WITH MIL-F-18240, CONFIGURATION B.
- WEIGHT: .0021 Lbs. [.93 gr.] MAXIMUM.
- MATERIAL: STAINLESS STEEL PER QQ-S-763
FINISH: PASSIVATED PER QQ-P-35

**If this document is printed it becomes uncontrolled.
Check with the web for latest revision.**

SPECIFICATION CONTROL DRAWING

UNLESS OTHERWISE SPECIFIED DIMENSIONS ARE IN INCHES. METRIC DIMENSIONS ARE IN BRACKETS.	DRAWN	V.D.T.	8-19-76	<i>Raychem</i>	RAYCHEM CORPORATION 300 CONSTITUTION DRIVE MENLO PARK, CALIFORNIA 94025				
	CHECKED	DCT	9-2-76		TITLE	MTC ADAPTOR SCREW			
	APPROVED	RAS	9-3-76						
	APPROVED	P.M.N.	9-3-76						
DECIMALS .XXX ± .005 { .XX ± .01 {	mm } mm }	CAD NAME		T22996.DWG		SIZE	CODE IDENT. NO.	DWG. NO.	REV
ANGLES .X ±		THIRD ANGLE PROJECTION				A	06090	D-659-0044	D
WEIGHT 3 lbs { g }				DO NOT SCALE THIS DRAWING			SHEET 1 OF 1		

单击下面可查看定价，库存，交付和生命周期等信息

[>>TE Connectivity\(泰科\)](#)