

LOC		DIST		REVISIONS			
F	LTR	DESCRIPTION	DATE	DMN	APVD		
F		REVISED PER ECO-08-028426	14NOV08	HMR	GS		

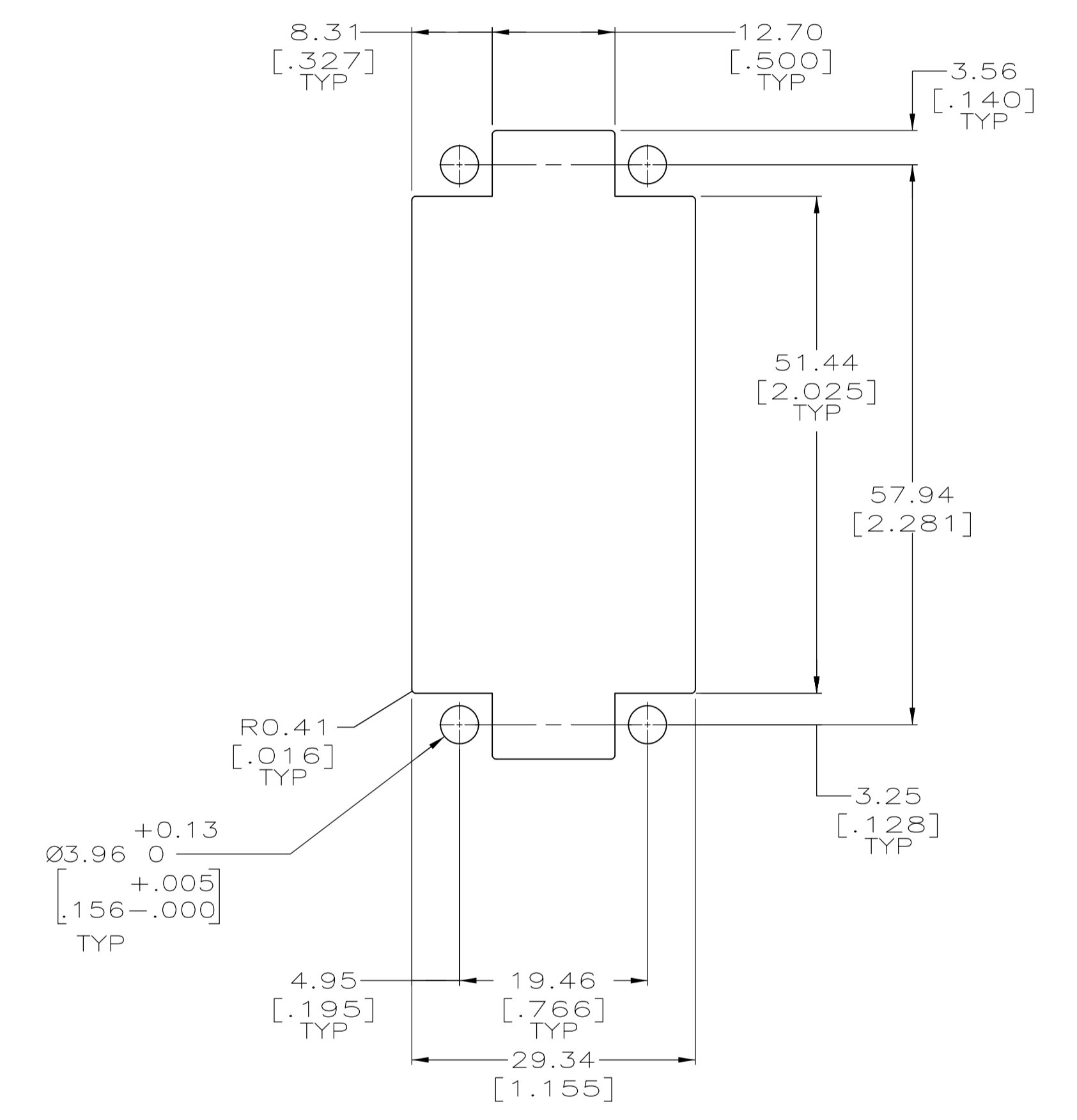
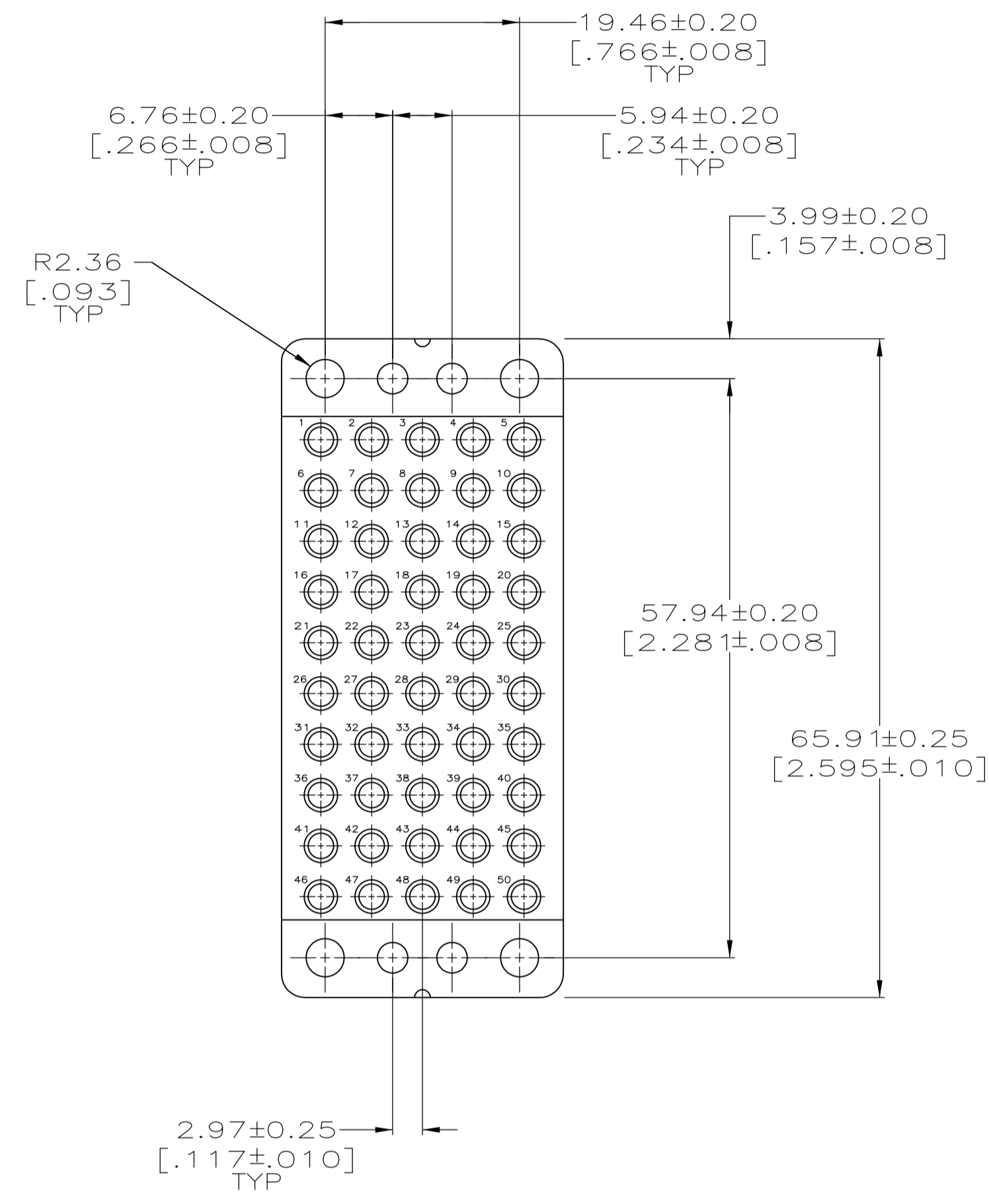
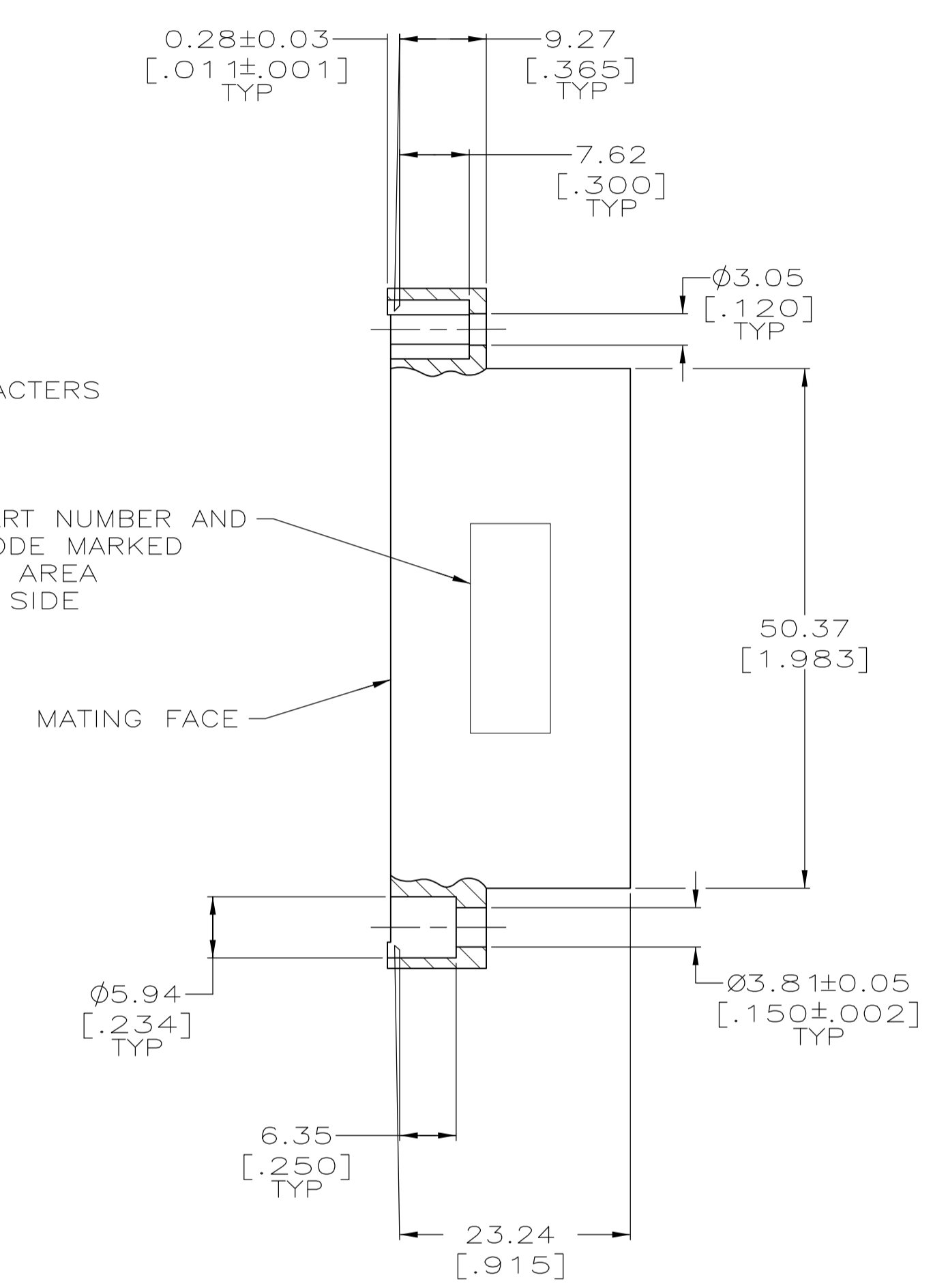
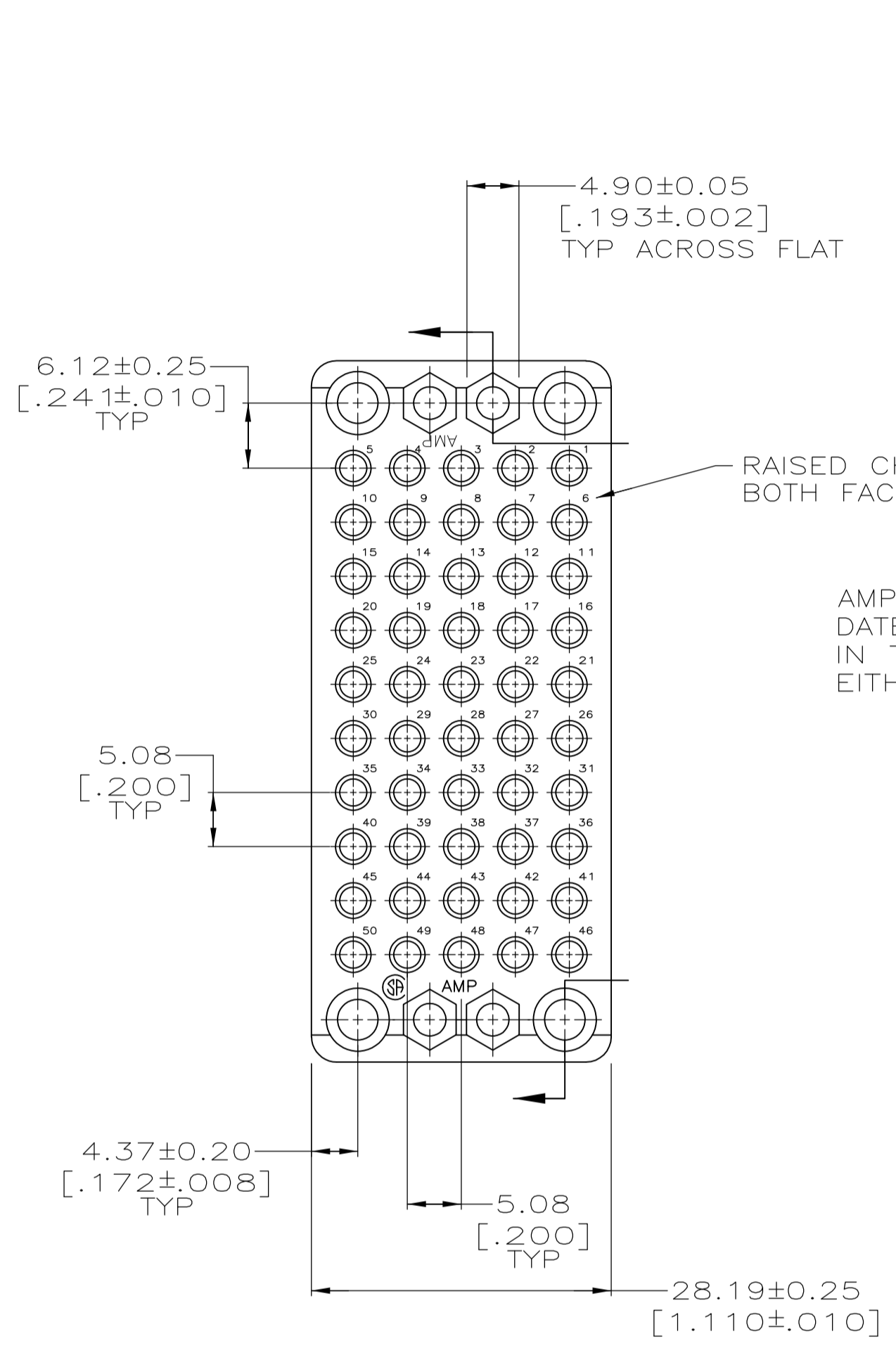

RECOMMENDED PANEL CUTOUT

1 ACCOMODATES TYPE II OR III+ #16 PIN CONTACTS OR TYPE II OR III+ #16 SOCKETS.

205058-2
PART NUMBER

THIS DRAWING IS A CONTROLLED DOCUMENT.		DMN C. OBERMAN 15 OCT 97	Tyco Electronics Corporation Harrisburg, PA 17105-3608	
DIMENSIONS: mm [INCHES]		CHK R. STONE 23 OCT 97	APVD G. STEINHAUER 13 JAN 98	
TOLERANCES UNLESS OTHERWISE SPECIFIED:		NAME HOUSING, PLUG, 50 POSITION, M SERIES		
0. PLC	± -	PRODUCT SPEC		
1. PLC	± -	APPLICATION SPEC		
2. PLC	± 0.13 [.005]	SIZE A1		
3. PLC	± -	CAGE CODE 00779		
4. PLC	± -	DRAWING NO. 205058		
ANGLES	± -	RESTRICTED TO		
MATERIAL PHENOLIC, BLACK PER MIL-M-14 TYPE C.F.C.	FINISH -	WEIGHT -	CUSTOMER DRAWING	
		SCALE 2:1	SHEET 1 of 1	REV F

单击下面可查看定价，库存，交付和生命周期等信息

[>>TE Connectivity\(泰科\)](#)