

S

DRAWING MADE IN AMERICAN PROJECTION

4

3

858856

2

1

© 1968 BY AMP INCORPORATED. ALL RIGHTS RESERVED. AMP PRODUCTS COVERED BY PATENTS AND/OR PATENTS PENDING.

THIS PRODUCT DESIGNED AND BUILT BY AMP INCORPORATED. NO LICENSE TO USE THAT DESIGN IN MANUFACTURE, OR TO USE ANY ISSUED OR PENDING PATENTS WHICH ARE INVOLVED, IS IMPLIED.

REVISIONS				
ZONE	LTR	DESCRIPTION	DATE	APPROVED
	A	REVISED NOTE 1	LAB 10-17-73	JPA
	B	REVISED PER ECN 4349	D.S. 5-21-74	M.G.
	C	ADDED REF. TO .69, 1.19, 1.91, 1.2 & .89	XA 12-1-77	M.G.
	D	REV PER ECN 5-3960	4/20/87	R.S.
	E	OBS-2 ECN OF 0376	2-89	T.W.

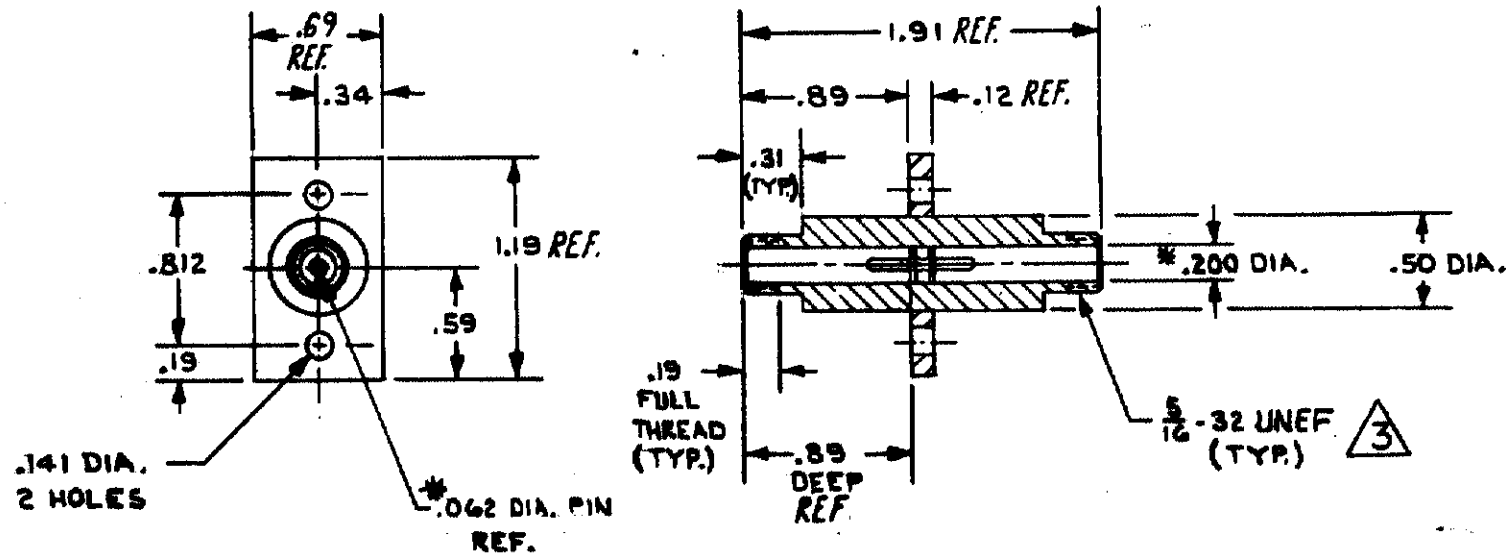

- RECEPTACLE TO MATE WITH AMP LGH- $\frac{1}{2}$ L LEAD ASSEMBLY, AVAILABLE SEPARATELY.
- DIA'S. MARKED WITH ASTERISK * TO BE CONCENTRIC WITHIN .015 T.I.R.
- PER FEDERAL STANDARD H-28 3 WIRE METHOD. DIMENSION OVER WIRES TO BE: .307-.310.

OBS	858856-2	RECEPTACLE (PIN GOLD PLATED)
	858856-1	RECEPTACLE (PIN TIN PLATED)

QTY REQD	QTY REQD	ITEM NO.	DWG SIZE	PART OR IDENTIFYING NO.	NOMENCLATURE OR DESCRIPTION
----------	----------	----------	----------	-------------------------	-----------------------------

				UNLESS OTHERWISE SPECIFIED: DIMENSIONS ARE IN INCHES TOLERANCES .00 = ±.02 ANGLES .000 = ±.005	CONTRACT NO. DR 10Echall 2-6-68	AMP INCORPORATED CAPITRON DIVISION ELIZABETHTOWN, PENNSYLVANIA	
				MATERIAL: EPIALL 1904	CHK		NAME LGH- $\frac{1}{2}$ L RECEPTACLE, FEED THRU FOR BULKHEAD APPLICATIONS
				FINISH: NATURAL	APPD	SIZE B	
					APPD	CODE IDENT NO. 89110	
					DSGN APPD JW Law 2-6-68	NUMBER 858856	
					OTHER APPD	SCALE N.T.S. WT	
NEXT ASSY	FINAL ASSY	NEXT ASSY	USED ON				SHEET 1 of 1
QTY REQD	APPLICATION						

PRINT DIST 102 OF 150

DATE

单击下面可查看定价，库存，交付和生命周期等信息

[>>TE Connectivity\(泰科\)](#)