

THIS DRAWING IS UNPUBLISHED. RELEASED FOR PUBLICATION
 © COPYRIGHT - By - ALL RIGHTS RESERVED.

REVISIONS					
P	LTR	DESCRIPTION	DATE	DWN	APVD
	C1	REVISED PER ECR-17-008430	12JUN2017	RS	SZ

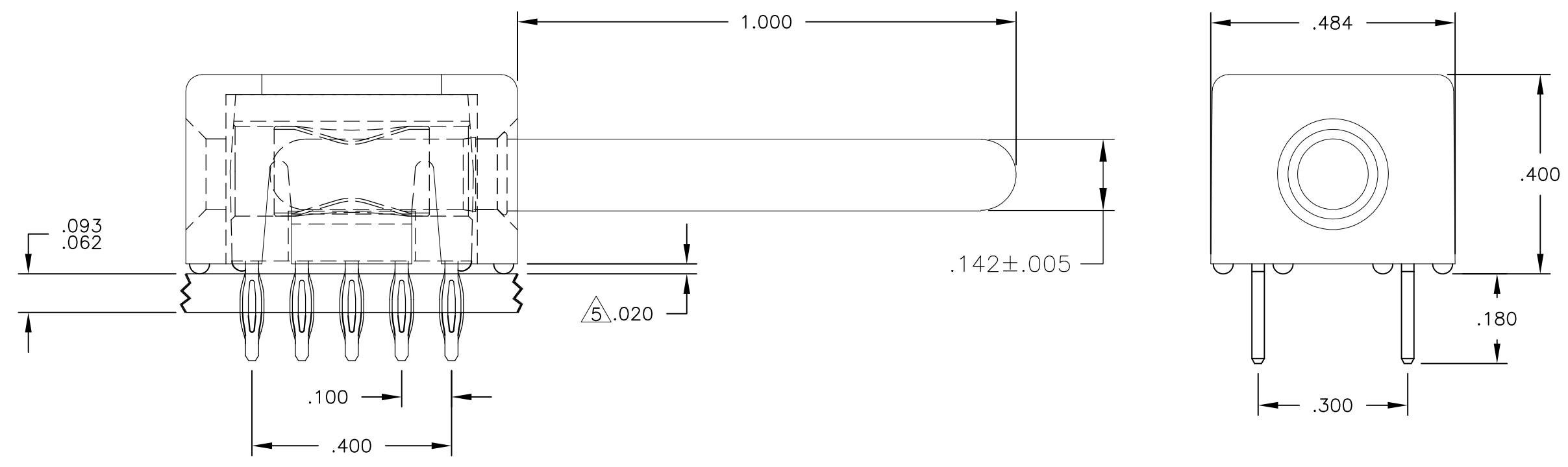

5 A FIVE-POUND (5lb) FORCES REQUIRED TO CORRECTLY SEAT THE CONNECTOR WITH PLATED THRU HOLES LESS THAN Ø.040 INCH.

4. FINISHES:
- CROWN: GOLD PLATED, .000030 MIN THICK OVER NICKEL PLATED, .000040 MIN THICK.
 - INSERT: SILVER PLATED, .000200 MIN THICK, OVER NICKEL PLATED, .000040 MIN THICK.
 - COMPLIANT TAIL: SILVER PLATED, .000200 MIN THICK, OVER NICKEL PLATED, .000040 MIN THICK.
 - CONTACT: SILVER PLATED, .000200 MIN THICK, OVER NICKEL PLATED, .000040 MIN THICK.

3. MATERIAL:
- INSULATOR - POLYESTER, GLASS FILLED, UL 94 V-0
 - MODULE - METAL CASTING
 - CROWN - BECU
 - PIN CONTACT - BRASS
 - COMPLIANT PIN - PHOSPHOR BRONZE

2. ITEMS PROVIDED TO THIS SPECIFICATION SHALL BE IDENTIFIED ON CONTAINER WITH THE FOLLOWING INFORMATION PART NUMBER AND DATE CODE OF MANUFACTURE.

1. PART NUMBER CHANGES AND/OR DESIGN CHANGES AFFECTING ITEM INTERCHANGEABILITY REQUIRE PRIOR TE APPROVAL AND AUTHORIZATION BY REVISION TO THIS DRAWING.

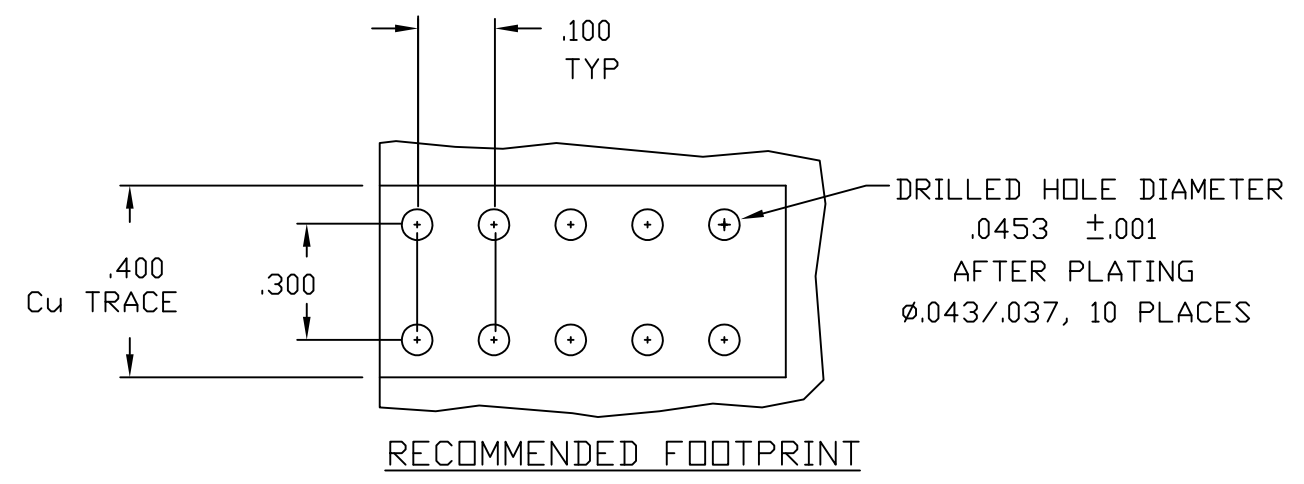

6643444-1
PART NUMBER

THIS DRAWING IS A CONTROLLED DOCUMENT.		DWN 12JAN2011 LOVATO/GRZYBOWSKI	TE Connectivity		
DIMENSIONS: INCHES		CHK - ORRIS			
TOLERANCES UNLESS OTHERWISE SPECIFIED:		APVD 12JAN2011 CHAU/ORRIS	ICCON, PIN, PARALLEL, COMPLIANT TAIL NON LOCKING, 10 PIN FOOT PRINT		
0 PLC ± - 1 PLC ± - 2 PLC ± - 3 PLC ± .020 4 PLC ± - ANGLES ± .5		PRODUCT SPEC 108-128033	RESTRICTED TO		
MATERIAL		APPLICATION SPEC 114-13298	SIZE	CAGE CODE	DRAWING NO
FINISH		WEIGHT 0	A3	00779	C-6643444
CUSTOMER DRAWING			SCALE	SHEET	REV
			4:1	1 OF 1	C1

单击下面可查看定价，库存，交付和生命周期等信息

[>>TE Connectivity\(泰科\)](#)