

4

3

2

© COPYRIGHT 19 BY TE INCORPORATED. ALL RIGHTS RESERVED.

LOC		REVISIONS			
F	LTR	DESCRIPTION	DATE	DWN	APVD
	K1	NOTE ON SUITABLE TERMINALS ADDED	03MAR2011	PKS	MP

SECTION B-B

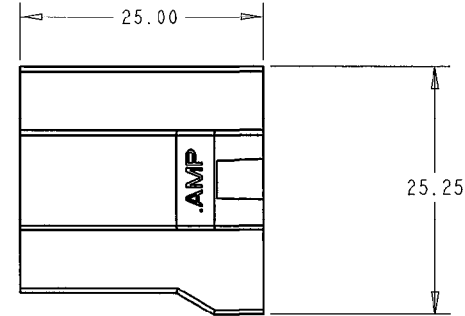
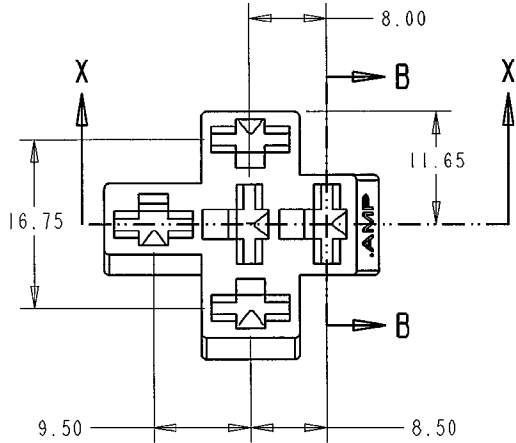
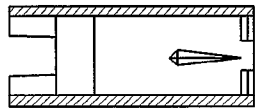

SECTION X-X

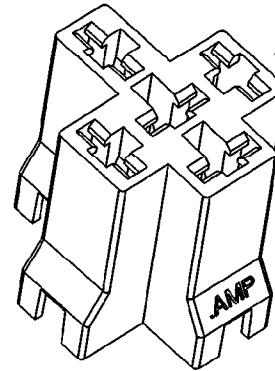
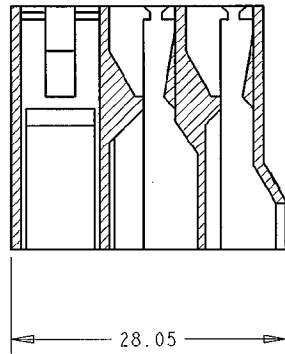

NOTE:

- SUITABLE FOR LATCHED .250 SRS FASTEN-ON RECEPTACLES SIMILAR TO PN 60295

PART NUMBER	MATERIAL	FINISH
154746-4	NYLON 6.6	RED
154746-3	NYLON 6.6	BLUE
154746-2	NYLON 6.6	BLACK
154746-1	NYLON 6.6	NATURAL

THIS DRAWING IS A CONTROLLED DOCUMENT FOR TE INCORPORATED. IT IS SUBJECT TO CHANGE AND THE CONTROLLING ENGINEERING ORGANIZATION SHOULD BE CONTACTED FOR THE LATEST REVISION.		DWN P. BATES 24/3/98	Tyco Electronics Tyco Electronics GB Ltd, Stanmore, Middlesex, HA7 4RS.	
DIMENSIONS IN m.m	TOLERANCES UNLESS OTHERWISE SPECIFIED:	CHK M. HARRIS 24/3/98	NAME RELAY BASE MOULDING	
THIRD ANGLE PROJECTION	LINEAR: - ±0.5 ANGULAR: - ±1°	APVD J. AMBROSE 25/3/98	SIZE A3	
		PRODUCT SPEC N/A	CAGE CODE 00779	
MATERIAL SEE TABLE	FINISH SEE TABLE	APPLICATION SPEC N/A	DRAWING NO C-154746	SCALE
		WEIGHT -	SHEET 1 OF 1	REV K1
		CUSTOMER DRAWING		

单击下面可查看定价，库存，交付和生命周期等信息

[>>TE Connectivity\(泰科\)](#)