

THIS DRAWING IS UNPUBLISHED. RELEASED FOR PUBLICATION
 © COPYRIGHT BY TYCO ELECTRONICS CORPORATION. ALL RIGHTS RESERVED.

| LOC | DIST | REVISIONS | | | | | |
|-----|------|-----------|-----|---------------------------|---------|-----|------|
| | | P | LTR | DESCRIPTION | DATE | DWN | APVD |
| AF | 50 | 0 | | TRANSFERED TO TYCO FORMAT | 28MAR03 | MF | EH |

- 1 CRIMPBAND MATERIAL PROVIDED IN CONTINUOUS STRIP.
- 2 REFERENCE DESCRIPTIVE PART NUMBER L076/0928R20TB.
- 3 BLANK LENGTH DETERMINED BY 076/092 TOOLSET.

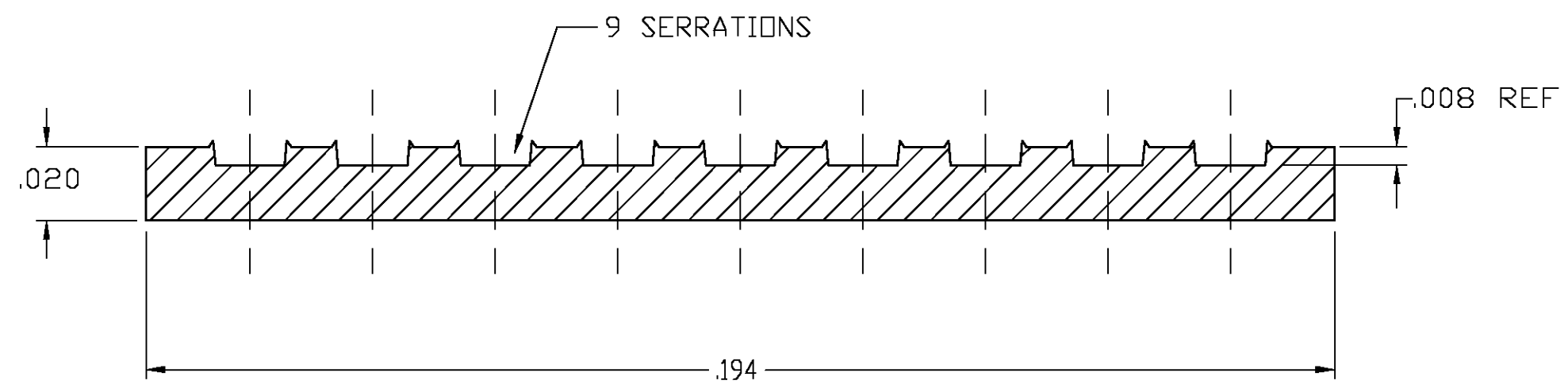
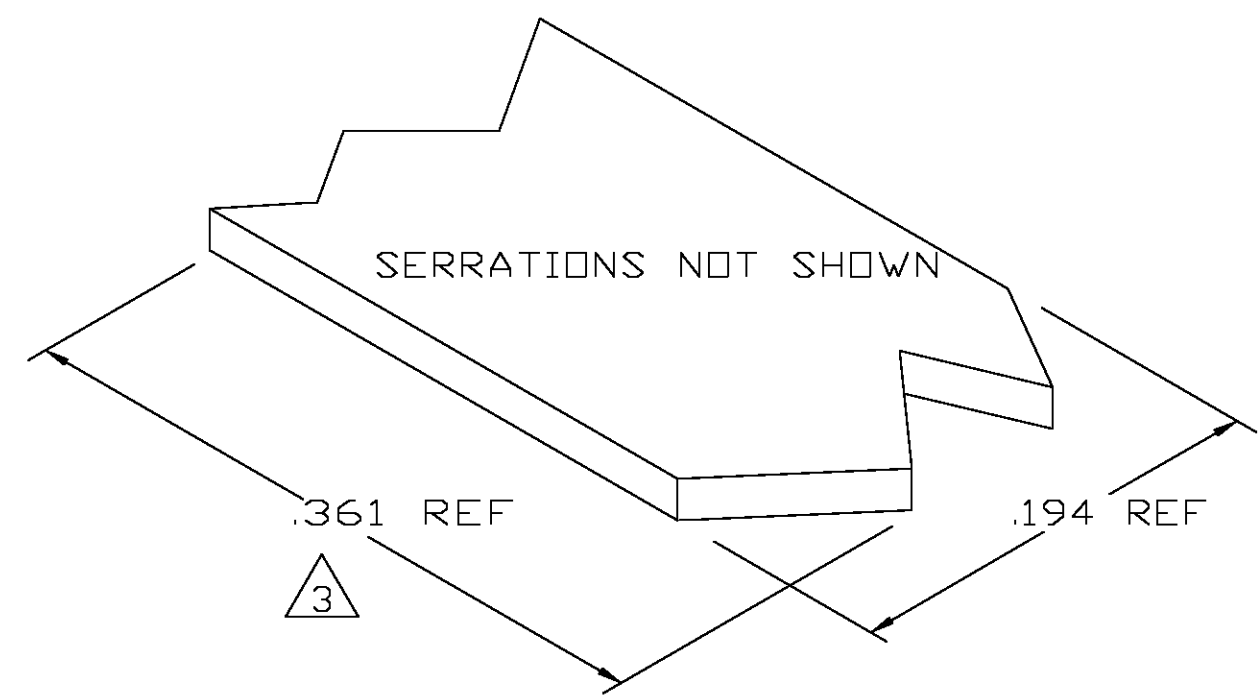

TYP. CROSS SECTION

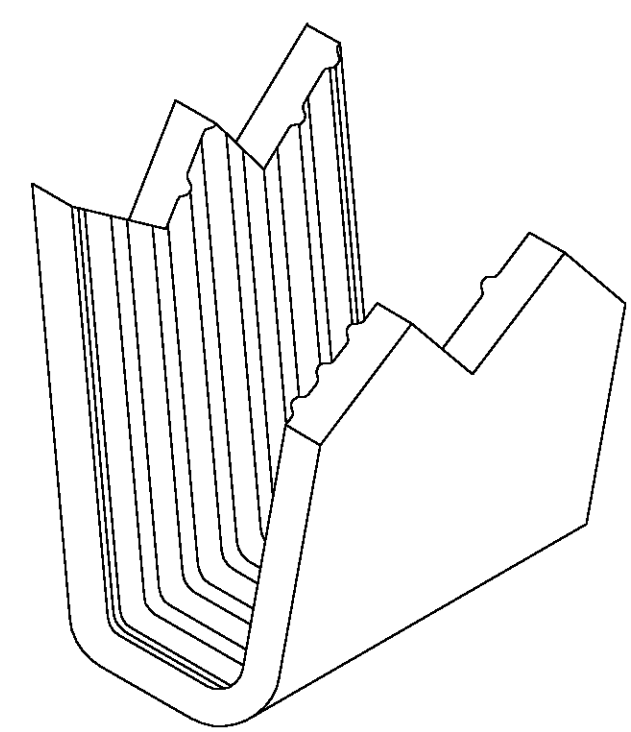

PARTIAL FORMED VIEW (REF)
FORMED BY APPLICATION TOOLING

1601639-1
PART NUMBER

| | | | | |
|--|--|--------------------------------------|---|--|
| THIS DRAWING IS A CONTROLLED DOCUMENT. | | DWN MICHAEL S. FEHER 28MAR2003 | Tyco Electronics Corporation Harrisburg, PA 17105-3608 | |
| DIMENSIONS: INCHES | | CHK EDWARD HOWARD 28MAR2003 | NAME - | |
| TOLERANCES UNLESS OTHERWISE SPECIFIED: | | APVD EDWARD HOWARD 28MAR2003 | PRODUCT SPEC - | |
| 0 PLC ± - | | APPLICATION SPEC - | | |
| 1 PLC ± - | | SIZE A2 | | |
| 2 PLC ± - | | CAGE CODE 00779 | | |
| 3 PLC ± .005 | | DRAWING NO C=1601639 | | |
| 4 PLC ± - | | RESTRICTED TO - | | |
| ANGLES ± - | | SCALE 1:1 | | |
| FINISH TIN | | SHEET 1 OF 1 | | |
| MATERIAL UNS C26000 BRASS | | REV 0 | | |
| CUSTOMER DRAWING | | | | |

单击下面可查看定价，库存，交付和生命周期等信息

[>>TE Connectivity\(泰科\)](#)