

LOC	DIST	REV	DATE	BY	APPV
-	-	U	6-13-13	CT	DM

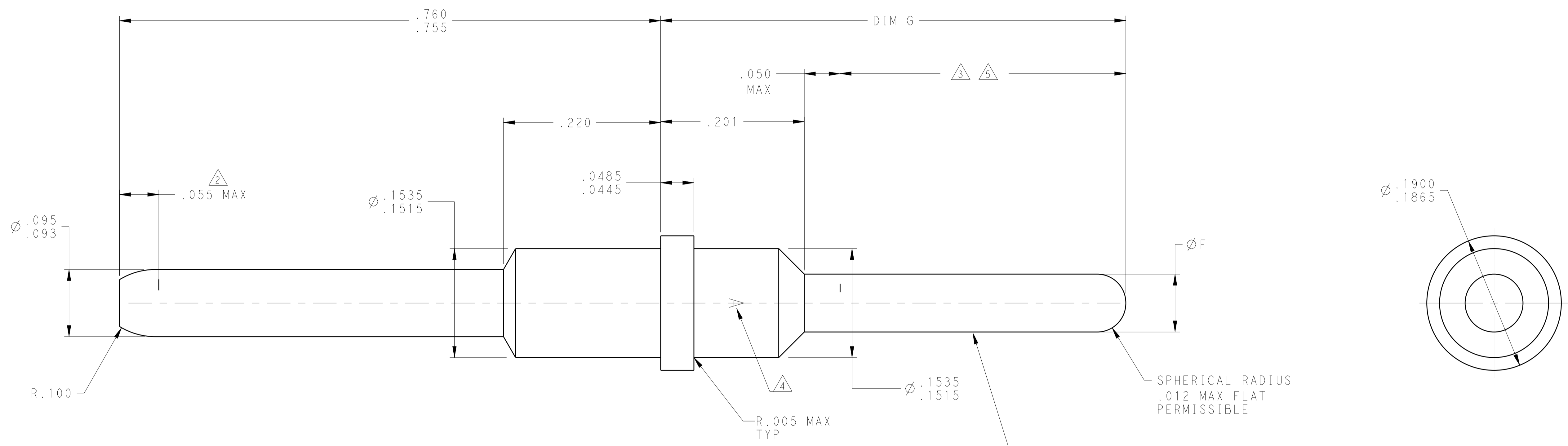

MAT'L: COPPER ALLOY PER ASTM-B-301  
 FINISH: GOLD PLATED .000050 MIN THK  
 PER ASTM-B-488 OVER NICKEL PLATE  
 .000050 MIN THK PER AMS-QQ-N-290

REMARKS	DIM G	DIM F	PART NUMBER
--	.776	.079-.083	3-448140-0
3	.617±.010	.087 MAX	2-448140-7
--	.576	.079-.083	2-448140-6
3 5	.617	.087 MAX	2-448140-3
--	.606	.079-.083	2-448140-2
3	.651	.087 MAX	1-448140-9
--	.505	.079-.083	1-448140-8
--	.617	.079-.083	1-448140-5
--	.404	.079-.083	1-448140-2
3	.536	.087 MAX	448140-9
--	.415	.079-.083	448140-8
--	.651	.079-.083	448140-6
--	.536	.079-.083	448140-3
--	.536	.079-.083	448140-2

- 2 COLOR CODE: AS SHOWN IN APPROXIMATE LOCATION SHOWN. THE YELLOW BAND SHALL BE APPROXIMATELY TWICE THE WIDTH OF THE ORANGE BAND.
- 3 ELECTRICAL ENGAGEMENT POINT.
- 4 THIS AREA SOLDER DIPPED.
- 5 MANUFACTURERS LOGO; LACATION & ORIENTATION OPTIONAL.
- 6 SOLDER IS RoHS-COMPLIANT Sn.

THIS DRAWING IS A CONTROLLED DOCUMENT.

DWN: C.C. THOMAS 27OCT2009  
 CHK: K. THACKSTON 27OCT2009  
 APVD: K. THACKSTON 27OCT2009

STC TE Connectivity

NAME: POSTED PIN CONTACT, SIZE 12, ARINC 600

SIZE: A1 CAGE CODE: 448140 DRAWING NO: 100779

SCALE: 12:1 SHEET 1 OF 1 REV U

单击下面可查看定价，库存，交付和生命周期等信息

[>>TE Connectivity\(泰科\)](#)