

REVISIONS					
#	LTR	DESCRIPTION	DATE	DMN	APVD
E		REVISED PER ECO-18-008015	24MAY2018	AP	DG

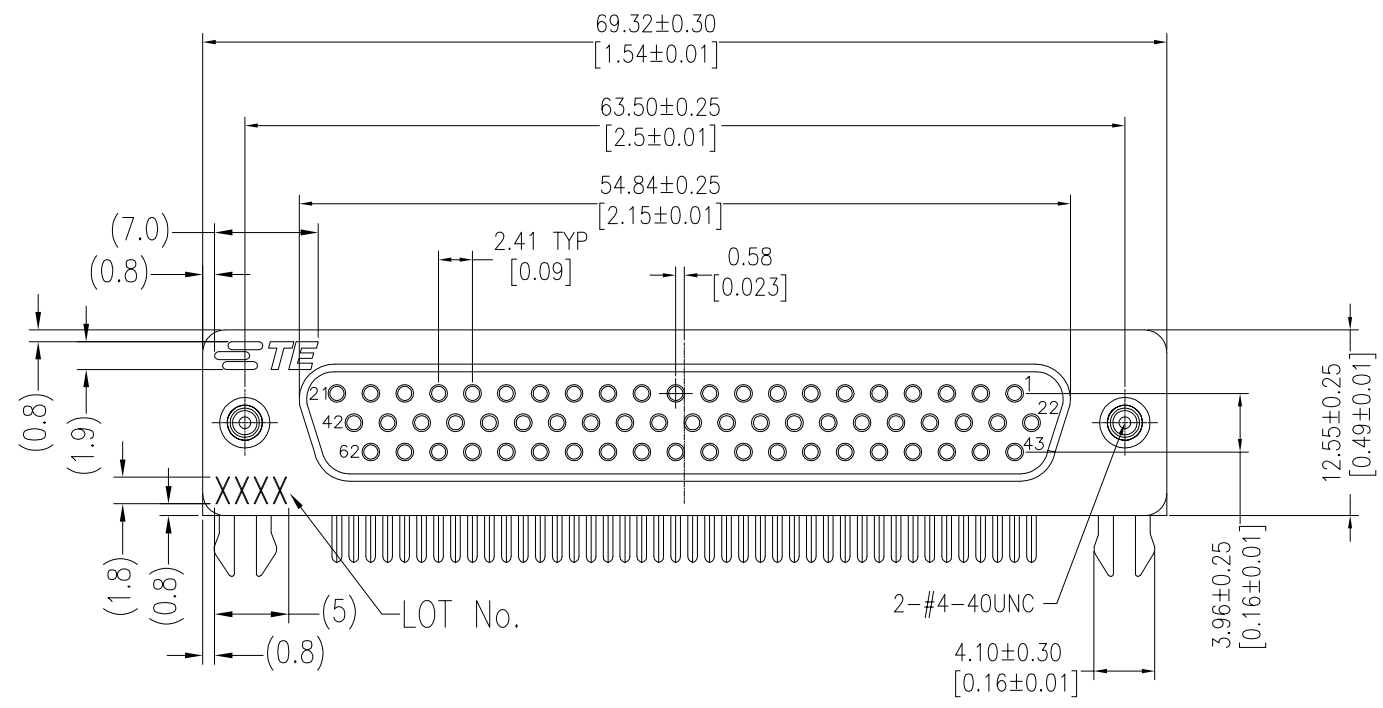

Recommended P.C.B Layout(Top Side)
 (PCB BOARD TOLERANCE±0.05)

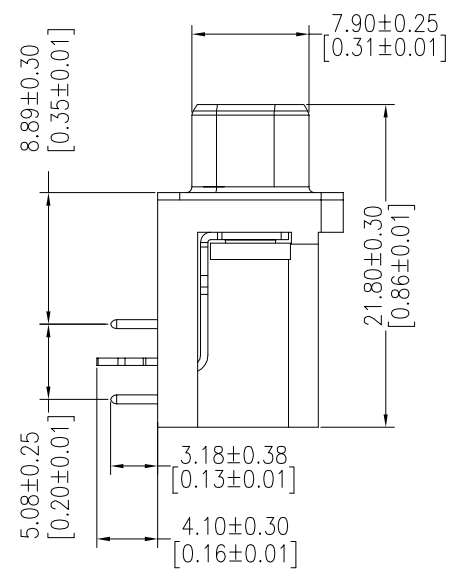
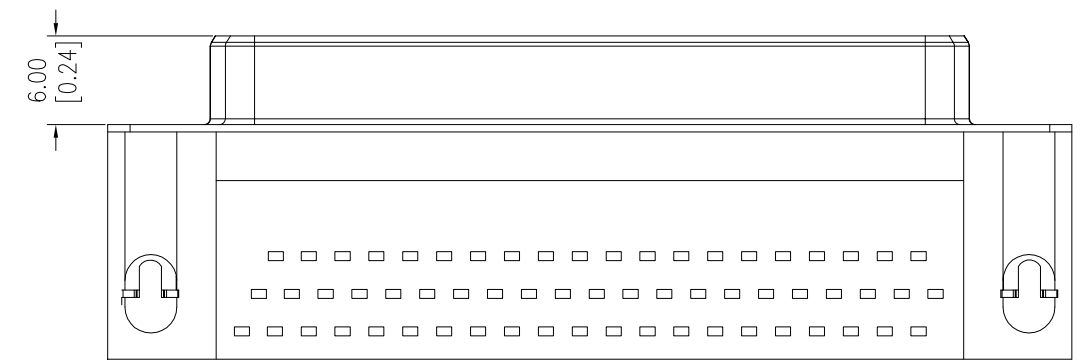
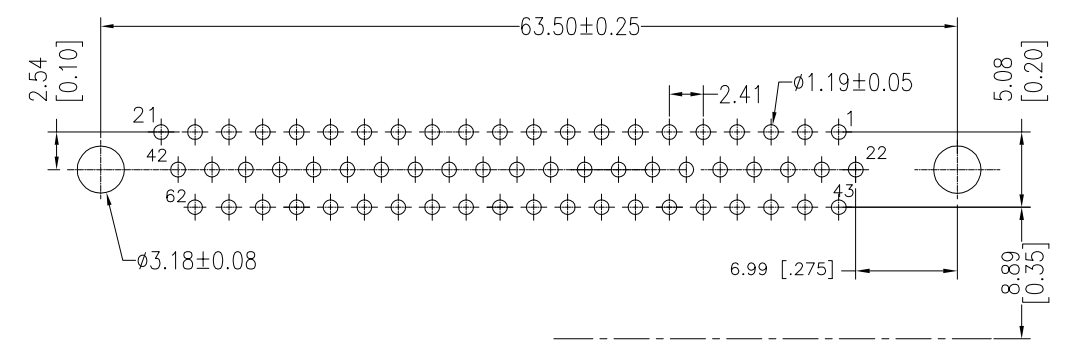

NOTES:
 Insulator:PBT+G.F UL94V-0 BLACK
 Contact:PHOSPHOR BRONZE
 " GOLD PLATING ON CONTACT AREA
 100u" MATTE TIN PLATING ON SOLDEXTAIL
 50u" NICKEL UNDERPLATED OVERALL
 Holddown:Brass,100u" TIN OVER 50u" NICKEL
 Sheel:Cold Roller Steel,Ni Plated
 Rivetlock:Brass,Nickel Plated
 LOT NUMBER "XXXX"
 └ Stands For Calendar Year
 └ Stands For Week Number

THREADED	30μAu	2311771-1
TYPE	Contact Area	P/N
	Plating	

THIS DRAWING IS A CONTROLLED DOCUMENT.		DMN AJITH PAI 11MAR2017	TE Connectivity	
DIMENSIONS: mm [INCHES]		CHK DANIEL GORENC 11MAR2017	NAME DANIEL GORENC	
TOLERANCES UNLESS OTHERWISE SPECIFIED:		APVD DANIEL GORENC 11MAR2017	PRODUCT SPEC AMPLIMITE RECEPTACLE, HD22, RIGHT ANGLE, 62P	
0 PLC ± -	1 PLC ± -	PRODUCT SPEC 108-130023	APPLICATION SPEC	
2 PLC ± 0.25	3 PLC ± -	SIZE A1	CAGE CODE 00779	DRAWING NO 2311771
4 PLC ± -	ANGLES ± -	WEIGHT	SCALE 1:1	SHEET 1 OF 1
MATERIAL		CUSTOMER DRAWING		RESTRICTED TO -

单击下面可查看定价，库存，交付和生命周期等信息

[>>TE Connectivity\(泰科\)](#)