

- 1 MATERIAL: CONNECTOR-NYLON UL94V-2 (RED).
CONTACTS-0.30 [.012] THICK COPPER ALLOY
BRIGHT TIN-LEAD 0.00203 [.000080] MINIMUM
THICK FOR CONTACTS 641534-2 THRU 641534-8,
MATTE WHISKER MITIGATED TIN PLATE 0.00203 [.000080]
MINIMUM THICK OVER NICKEL UNDERPLATE FOR CONTACTS
3-641534-2 THRU 3-641534-8.
- 2 CONTACTS ACCEPT 22 AWG WIRE WITH 1.52 [.060] MAXIMUM INSULATION DIAMETER.
- 3 CONTACTS MUST ACCEPT 0.36-0.51 [.014-.020] SQUARE OR ROUND POST AND REMAINED LOCKED IN POSITION.
- 4 IDENTIFICATION NUMBER FOR LAST CIRCUIT MAY NOT APPEAR ON ALL ASSEMBLIES.
- 5 DIMENSIONS IN BRACKETS ARE IN INCHES.
- 6 HOUSING FEATURES ARE: CLOSED END WITH LOCKING RAMP & LED CONTACT.
- 7 OBSOLETE PARTS: OBSOLETE CIS STREAMLINING PER D.RENAUD/D.SINISI
- 8 OBSOLETE PARTS

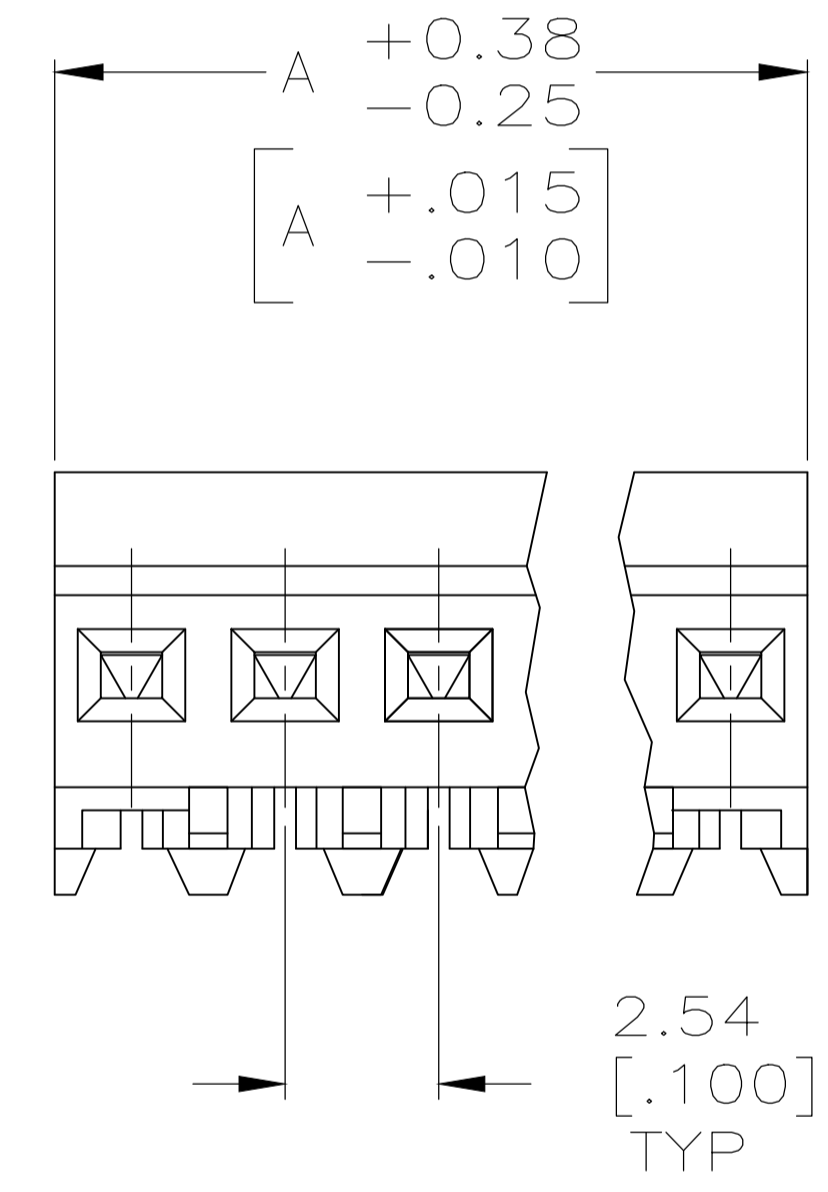
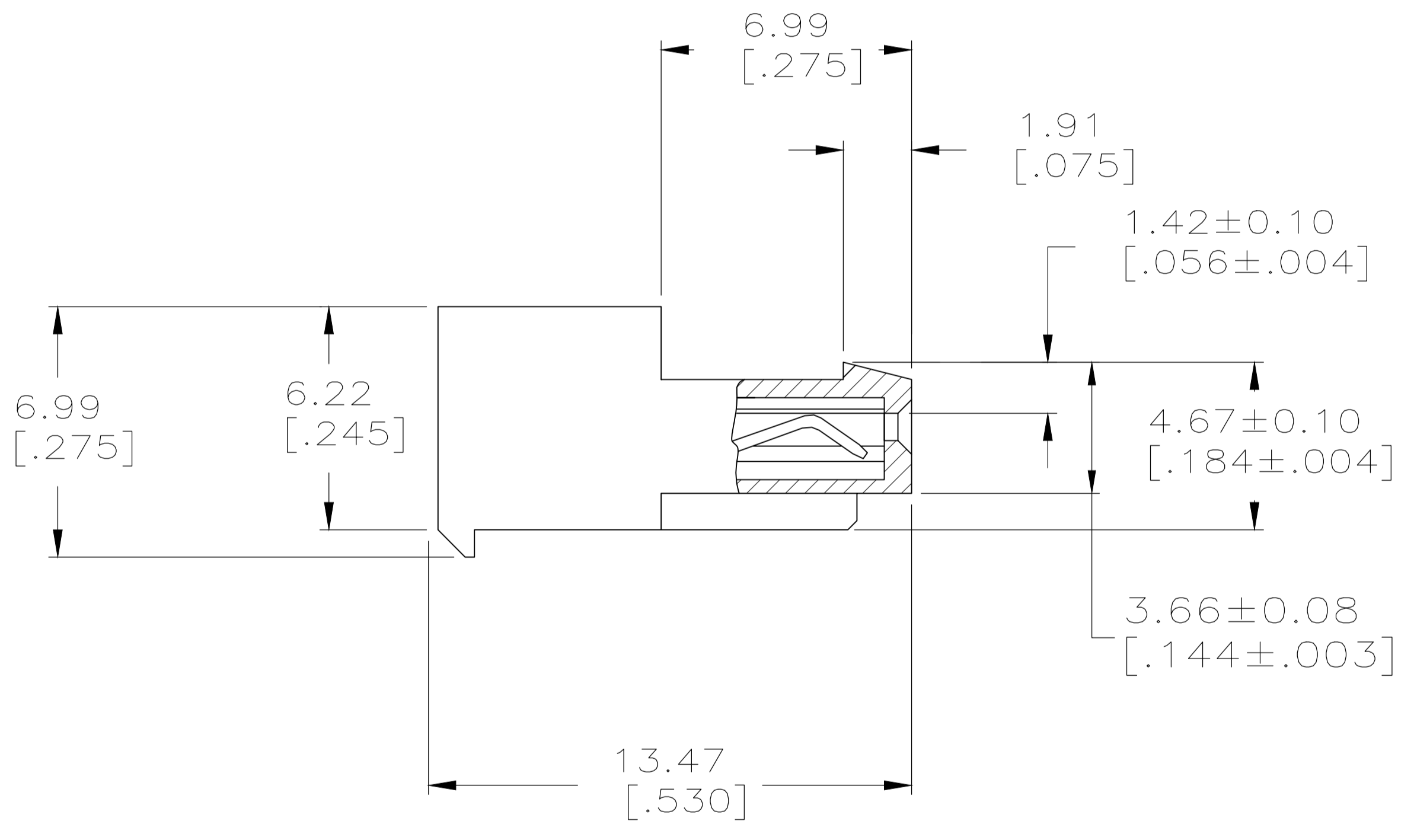

LEAD FREE	20.32 [.800]	8	3-641534-8
	10.16 [.400]	4	3-641534-4
	7.62 [.300]	3	3-641534-3
	5.08 [.200]	2	3-641534-2
	DIM A	NO.OF POSN	ASSEMBLY

CONTAINS LEAD	20.32 [.800]	8	3-641534-8
	10.16 [.400]	4	3-641534-4
	7.62 [.300]	3	3-641534-3
	5.08 [.200]	2	3-641534-2
	DIM A	NO.OF POSN	ASSEMBLY

8 SUPERSEDED
7 SUPERSEDED
8 SUPERSEDED
OBSOLETE

THIS DRAWING IS A CONTROLLED DOCUMENT.

DIMENSIONS: mm [INCHES]	TOLERANCES UNLESS OTHERWISE SPECIFIED:	DIN S. HOOVER 10-DEC-2004	TE Connectivity
0 PLC ±	±	CJK D. ROSSI 10-DEC-2004	NAME
1 PLC ±	±	APVD D. ROSSI 10-DEC-2004	MTA-100 CONNECTOR ASSEMBLY, 22 AWG, FOR .014 TO .020 POST, SPECIAL
2 PLC ±	± 0.13 [.005]	PRODUCT SPEC	108-1050
3 PLC ±	±	APPLICATION SPEC	114-1019
4 PLC ±	±	SIZE	A1
ANGLES ±	±	WEIGHT	00779 641534
MATERIAL	FINISH	CUSTOMER DRAWING	SCALE 8:1 SHEET 1 OF 1 REV H

单击下面可查看定价，库存，交付和生命周期等信息

[>>TE Connectivity\(泰科\)](#)