

THIS DRAWING IS UNPUBLISHED. RELEASED FOR PUBLICATION
 © COPYRIGHT - TE Connectivity Ltd. ALL RIGHTS RESERVED.

REVISIONS					
P	LTR	DESCRIPTION	DATE	DWN	APVD
B2		REVISED PER ECR-18-014750	24SEP2018	BDA	DS

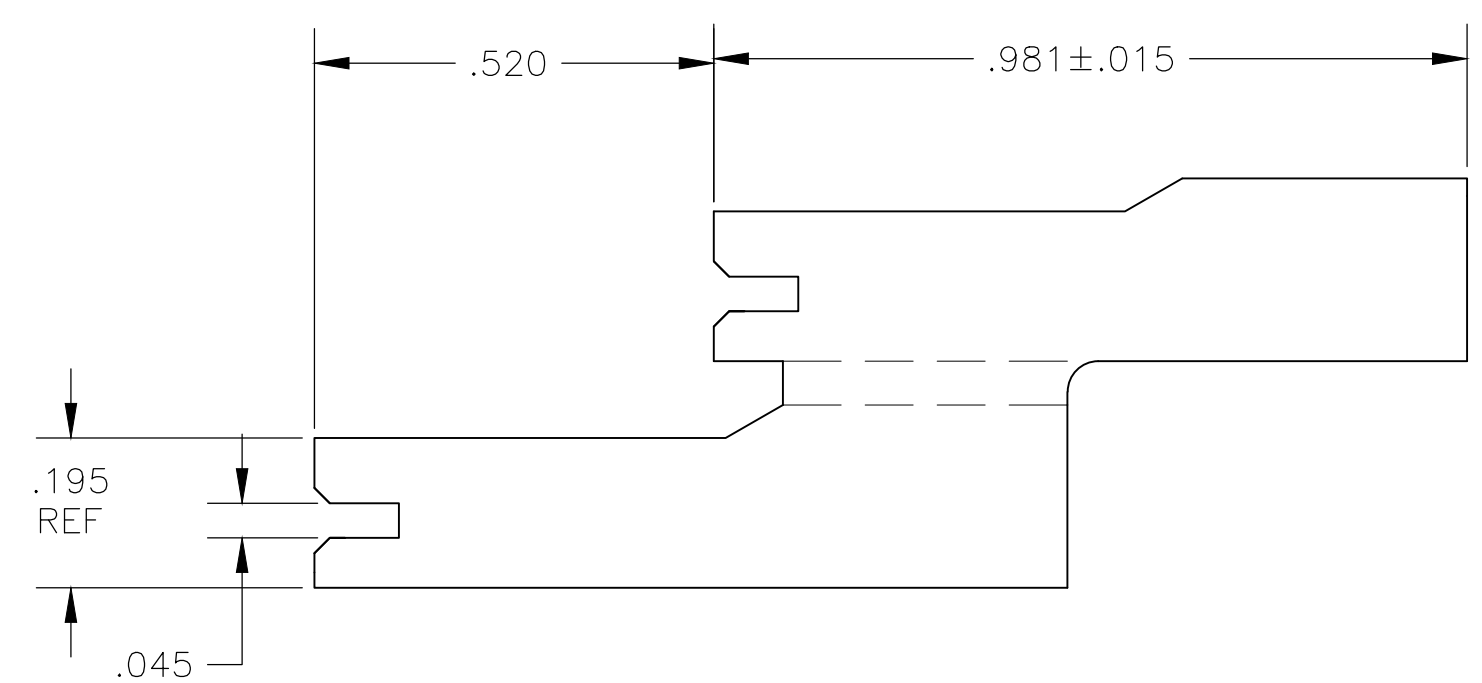

- 1 HOUSING ACCEPTS .250 MARK III POSITIVE-LOCK RECEPTACLES 63993-X, 63854-X, AND 1217092-X.
- 2 REFERENCE 63854 RECEPTACLE CUSTOMER DRAWING FOR RECOMMENDED INDIVIDUAL TAB DIMENSIONING.

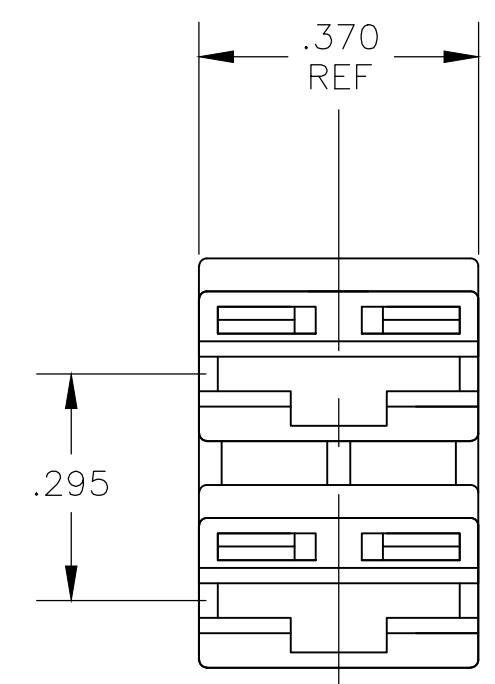
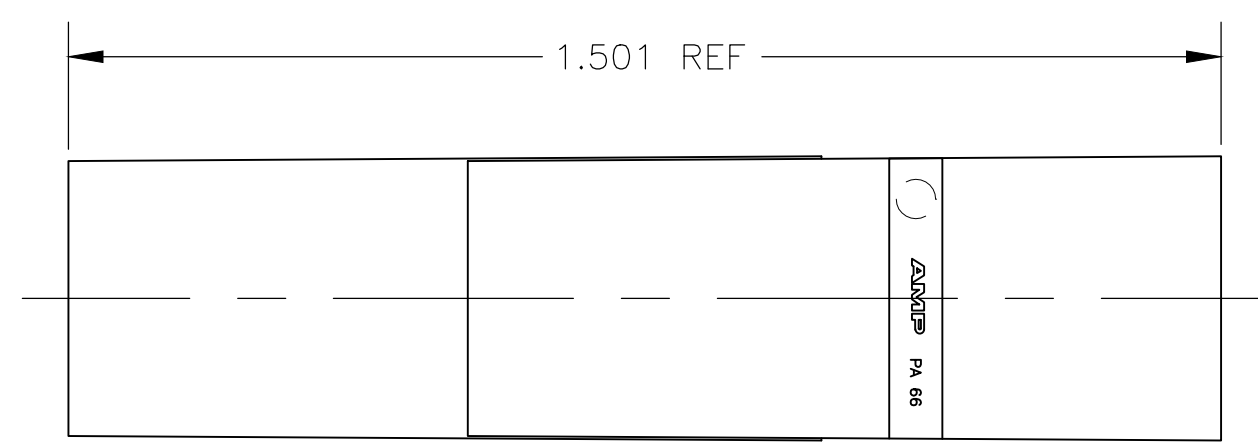
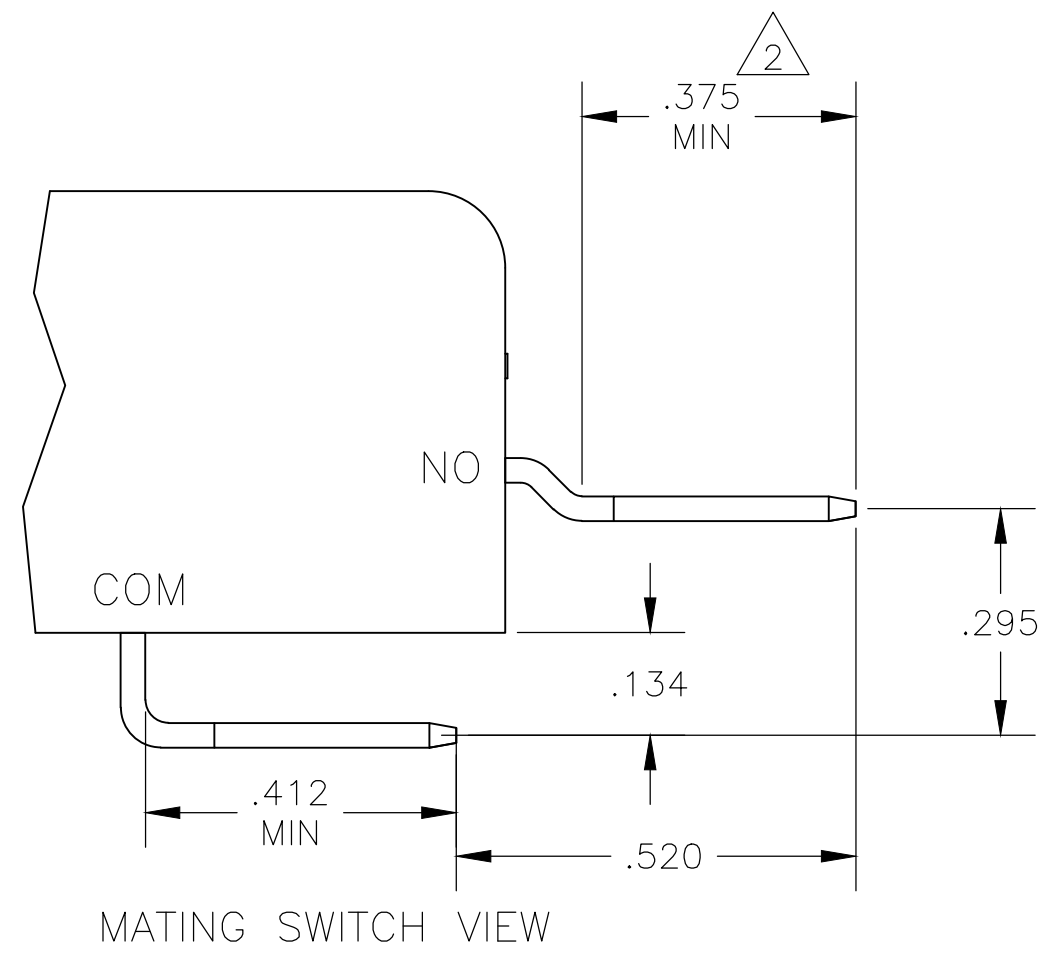
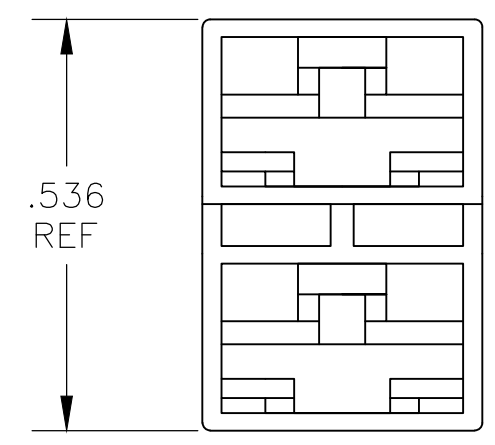

NYLON, V0 NATURAL	521955-2
6/6 NYLON, V2 NATURAL	521955-1
MATERIAL	PART NO

THIS DRAWING IS A CONTROLLED DOCUMENT.		DWN jr ruth 01SEPT06	TE Connectivity Ltd.	
DIMENSIONS: INCHES		CHK ED HOWARD 01SEPT06		
TOLERANCES UNLESS OTHERWISE SPECIFIED:		APVD ED HOWARD 01SEPT06	NAME HOUSING, RECEPTACLE, POSITIVE-LOCK, MKIII, .250 SERIES	
0 PLC ± - 1 PLC ± - 2 PLC ± - 3 PLC ± .010 4 PLC ± - ANGLES ± 5°		PRODUCT SPEC -	SIZE A2	CAGE CODE 00779
MATERIAL -		FINISH -	DRAWING NO C=521955	RESTRICTED TO -
CUSTOMER DRAWING			SCALE 4:1	SHEET 1 OF 1
			REV B2	

单击下面可查看定价，库存，交付和生命周期等信息

[>>TE Connectivity\(泰科\)](#)