

LOC	DIST	REVISIONS			
P	LTN	DESCRIPTION	DATE	DWN	APVD
I		PRELIMINARY	19SEP2012	DZ	JY

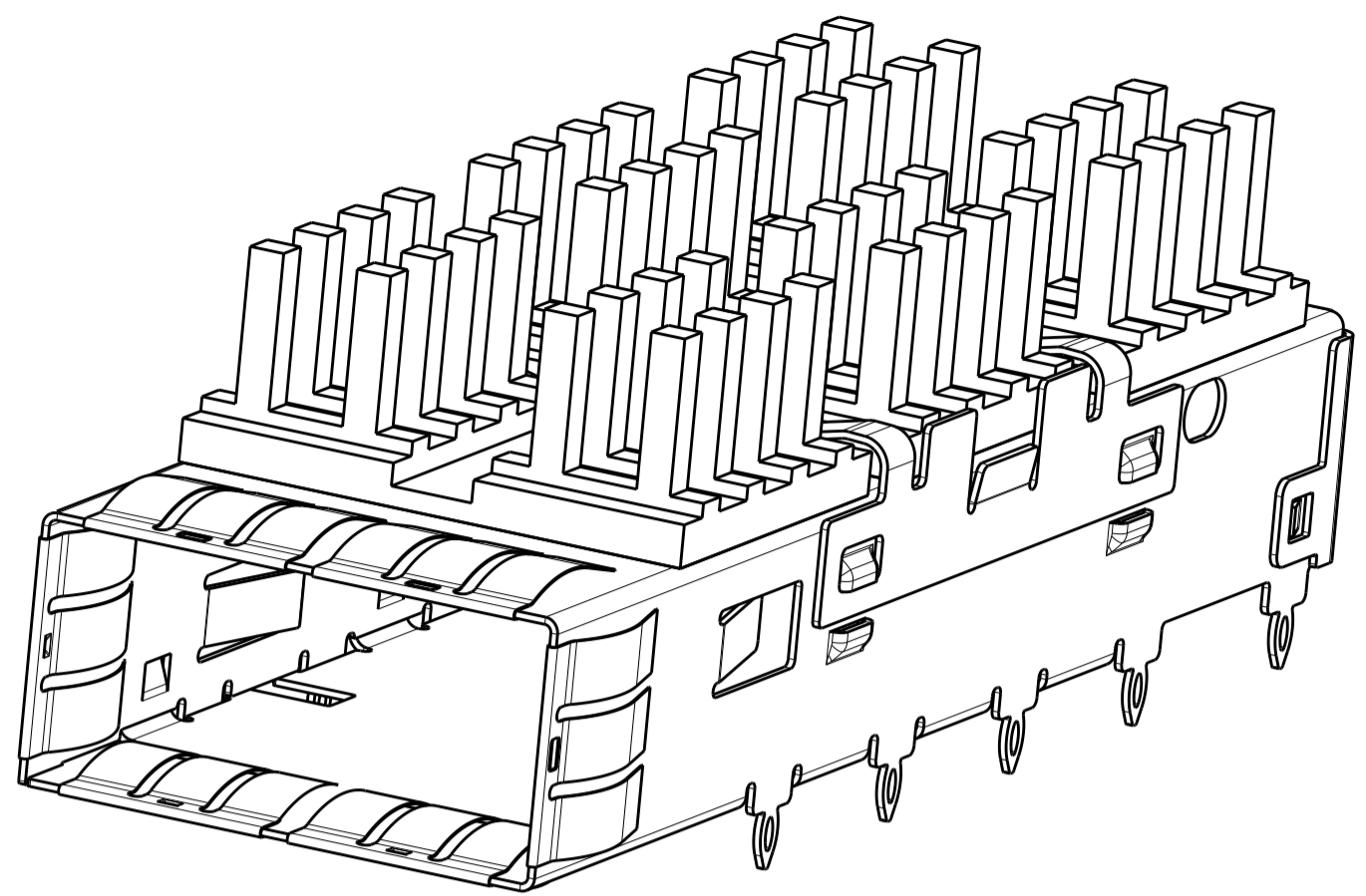

SCALE 4:1

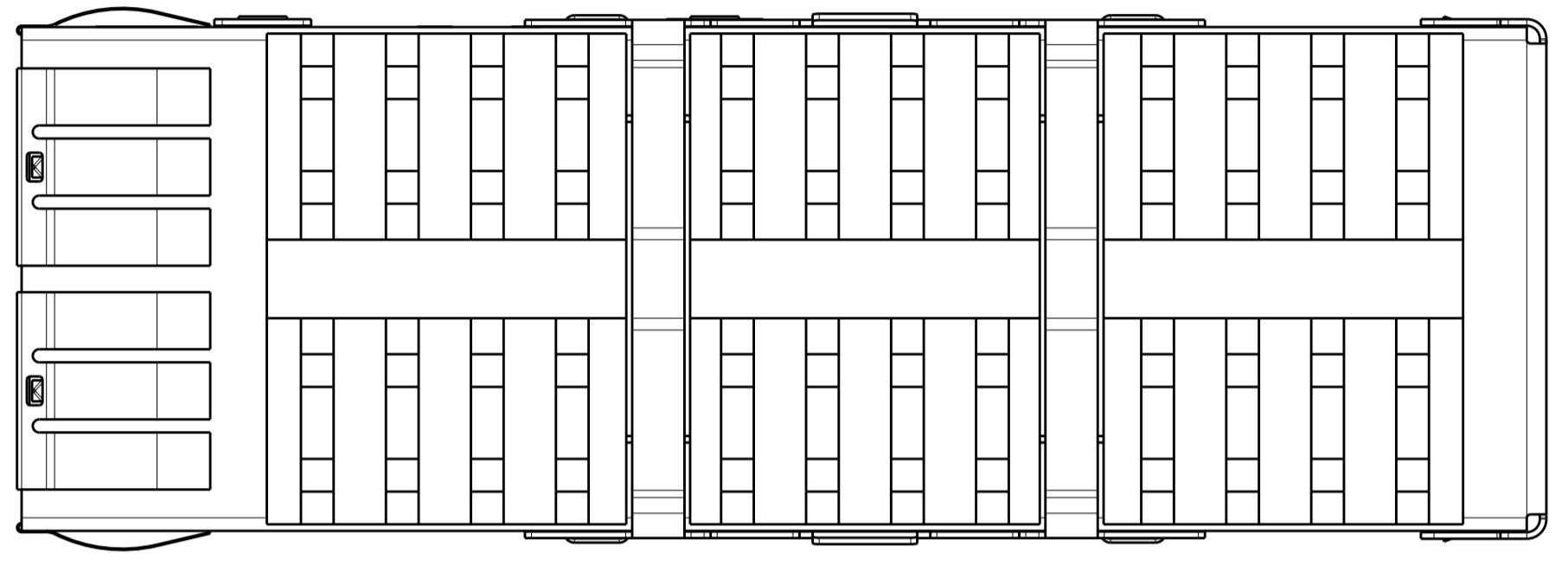

- 1. CAGE MATERIAL: NICKEL SILVER, 0.25 THICK
 HEAT SINK MATERIAL: ALUMINUM
 HEAT SINK CLIP MATERIAL: STAINLESS STEEL
 EMI SPRINGS MATERIAL: COPPER ALLOY
- 2. MINIMUM PITCH DIMENSION.
- 3. MATES WITH QSFP MSA COMPATIBLE TRANSCEIVER.
- 4. REFERENCE APPLICATION SPEC 114-13217 FOR RECOMMENDED DRILL HOLE DIAMETER AND PLATING THICKNESS.
- 5. DATUMS AND BASIC DIMENSIONS ESTABLISHED BY CUSTOMER.
- 6. MINIMUM PC BOARD THICKNESS:
 SINGLE SIDED = 1.45mm (shown, pg. 4)
 DOUBLE SIDED = 2.2mm
- 7. HEATSINK AND CLIP SHIPPED ASSEMBLED TO CAGE ASSEMBLY. CAGE ASSEMBLY MAY BE PRESSED INTO THE PCB AS SHIPPED.
- 8. DATUM -A- IS TOP SURFACE OF HOST BOARD.
- 9. SURFACE TRACES PERMITTED WITHIN THIS AREA EXCEPT WHERE CAGE STANDOFFS, SHOWN IN DETAIL J, CONTACT PC BOARD.
- 10. DIMENSION APPLIES WITH MODULE INSTALLED IN THE CAGE.
- 11. DATE CODE MARKED ON TOP OF CAGE AND CONCEALED BY HEAT SINK APPLIES TO CAGE ASSEMBLY ONLY.
- 12. SPRING FINISH: 0.8um MIN TIN OVER 0.8um MIN NICKEL. NON-PLATED EDGES PERMISSIBLE.
 HEAT SINK FINISH: 0.076 um MIN NICKEL.

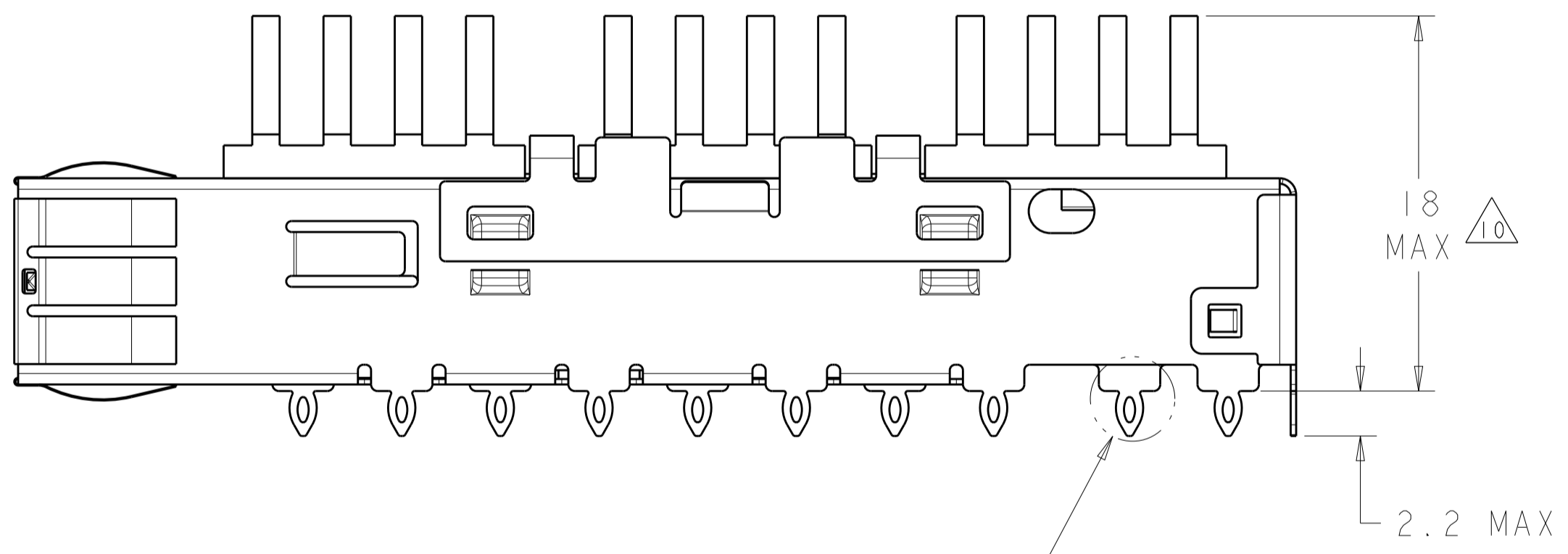
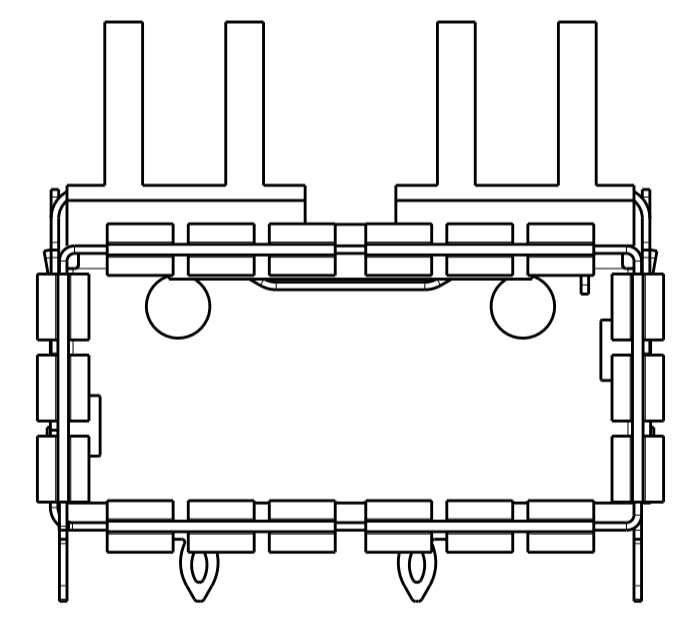

SEE DETAIL J

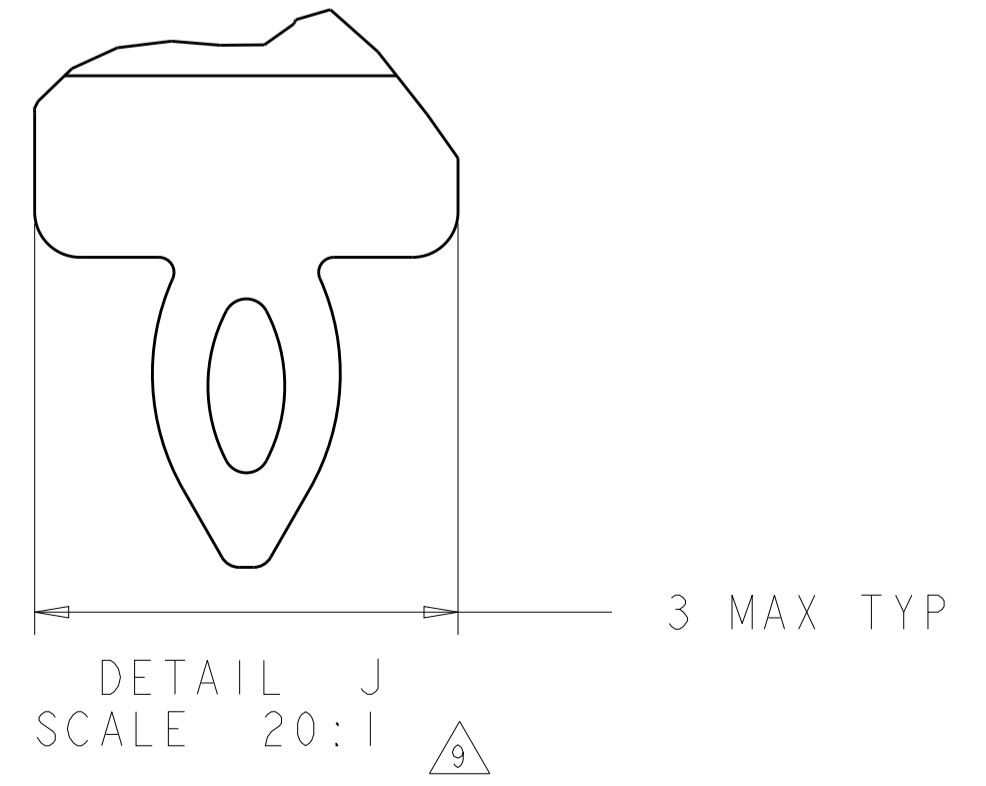
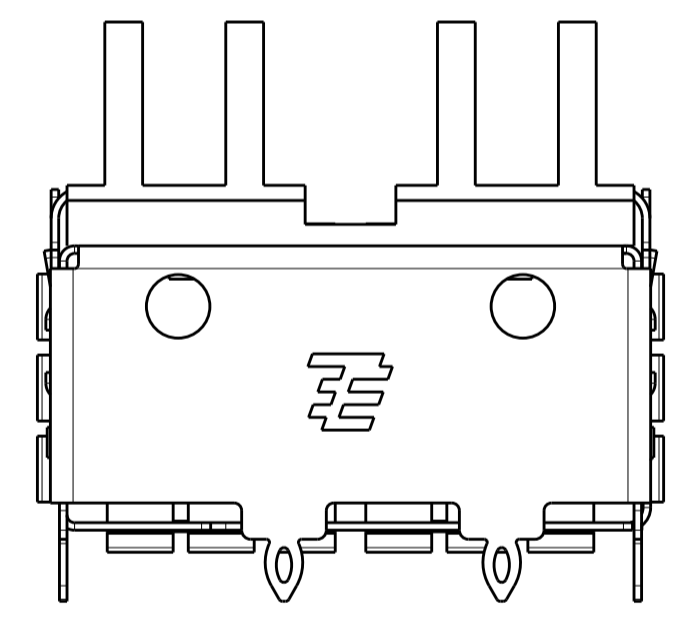

DETAIL J
SCALE 20:1

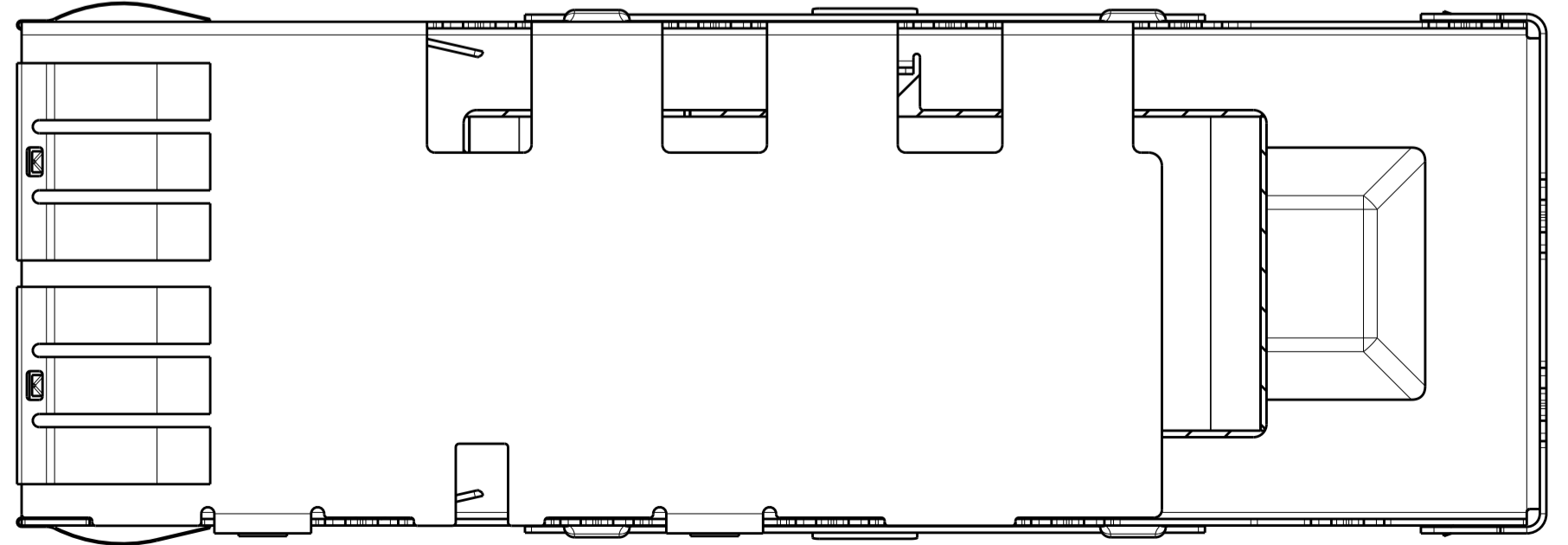

THIS PRINT IS
PRELIMINARY
 UNQUALIFIED PRODUCT
 CONTACT PRODUCT ENGINEERING
 BEFORE USING THIS PRINT

THIS DRAWING IS A CONTROLLED DOCUMENT.		DWN: D. ZHU 19SEP2012	TE Connectivity NAME: CAGE ASSEMBLY, THRU BEZEL, QSFP WITH HEAT SINK PRODUCT SPEC: 108-2286 APPLICATION SPEC: 114-13217 SIZE: CAGE CODE DRAWING NO: A100779 WEIGHT: C=2170450 Customer Drawing	PART NUMBER
DIMENSIONS:		CHK: J. YANG 19SEP2012		2170450-1
TOLERANCES UNLESS OTHERWISE SPECIFIED:		APVD: A. CAL 19SEP2012		
mm 0 PLC ± 1 PLC ±0.25 2 PLC ±0.13 3 PLC ± 4 PLC ± ANGLES ± FINISH:				RESTRICTED TO
MATERIAL: A			SCALE 2:1	SHEET 1 OF 4

LOC	DIST	REVISIONS					
GP	00	P	LTN	DESCRIPTION	DATE	DWN	APVD
		-		SEE SHEET 1		-	-

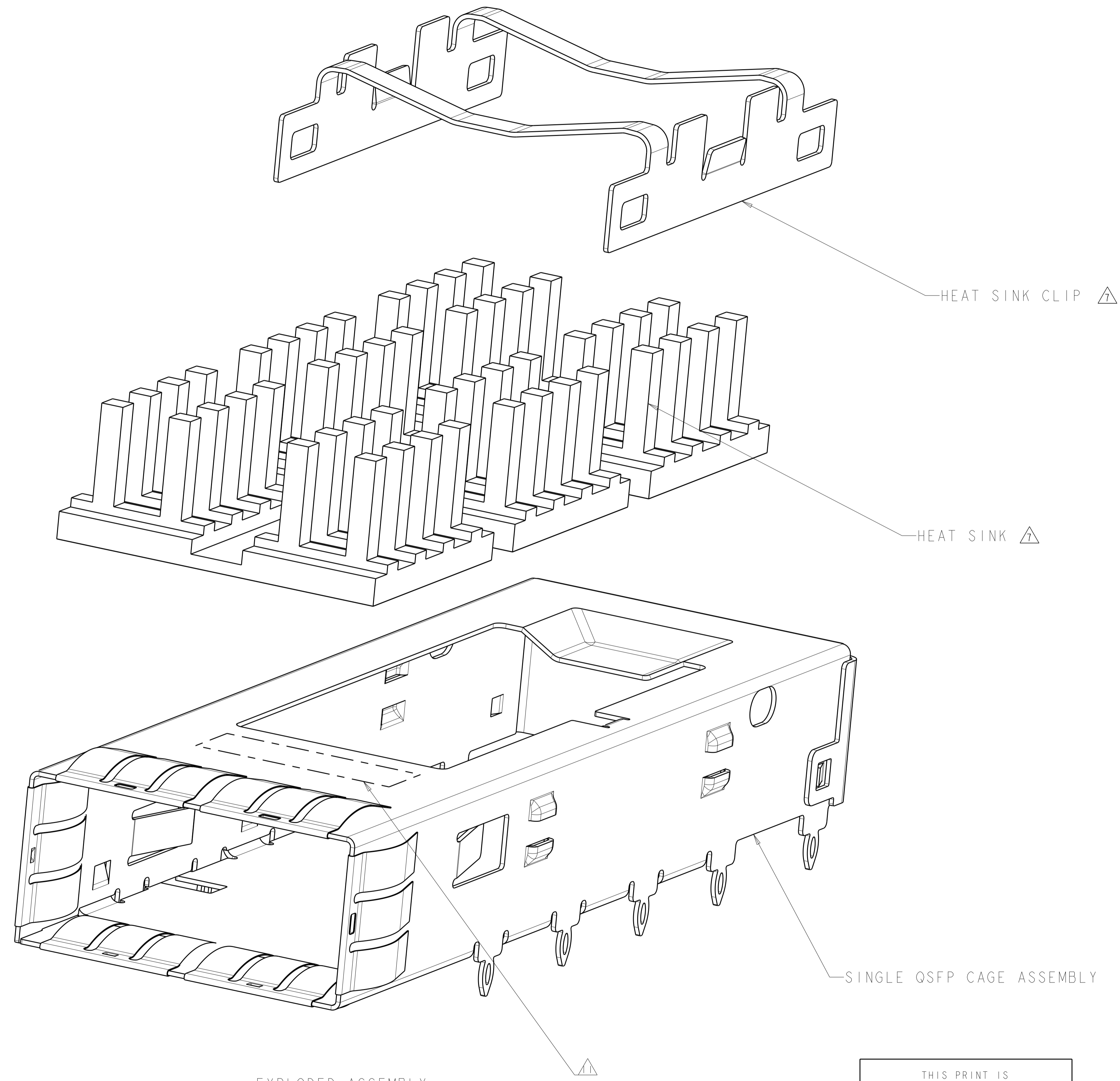

EXPLODED ASSEMBLY
 SCALE 8:1

THIS PRINT IS
PRELIMINARY
 UNQUALIFIED PRODUCT
 CONTACT PRODUCT ENGINEERING
 BEFORE USING THIS PRINT

THIS DRAWING IS A CONTROLLED DOCUMENT.		DWN D. ZHU	19SEP2012	TE Connectivity NAME CAGE ASSEMBLY, THRU BEZEL , QSFP WITH HEAT SINK PRODUCT SPEC 108-2286 APPLICATION SPEC 114-13217 WEIGHT - Customer Drawing	RESTRICTED TO		
DIMENSIONS:		CHK J. YANG	19SEP2012		SIZE	CAGE CODE	DRAWING NO
mm		APVD A. CAI	19SEP2012		A1	00779	C=2170450
0 PLC ± 1 PLC ±0.25 2 PLC ±0.13 3 PLC ± 4 PLC ± ANGLES ± FINISH ±					SCALE	SHEET	OF
MATERIAL				2:1	2	4	REV
							1

LOC	DIST	REVISIONS			
P	LTN	DESCRIPTION	DATE	DMN	APVD
GP	00	SEE SHEET 1	-	-	-

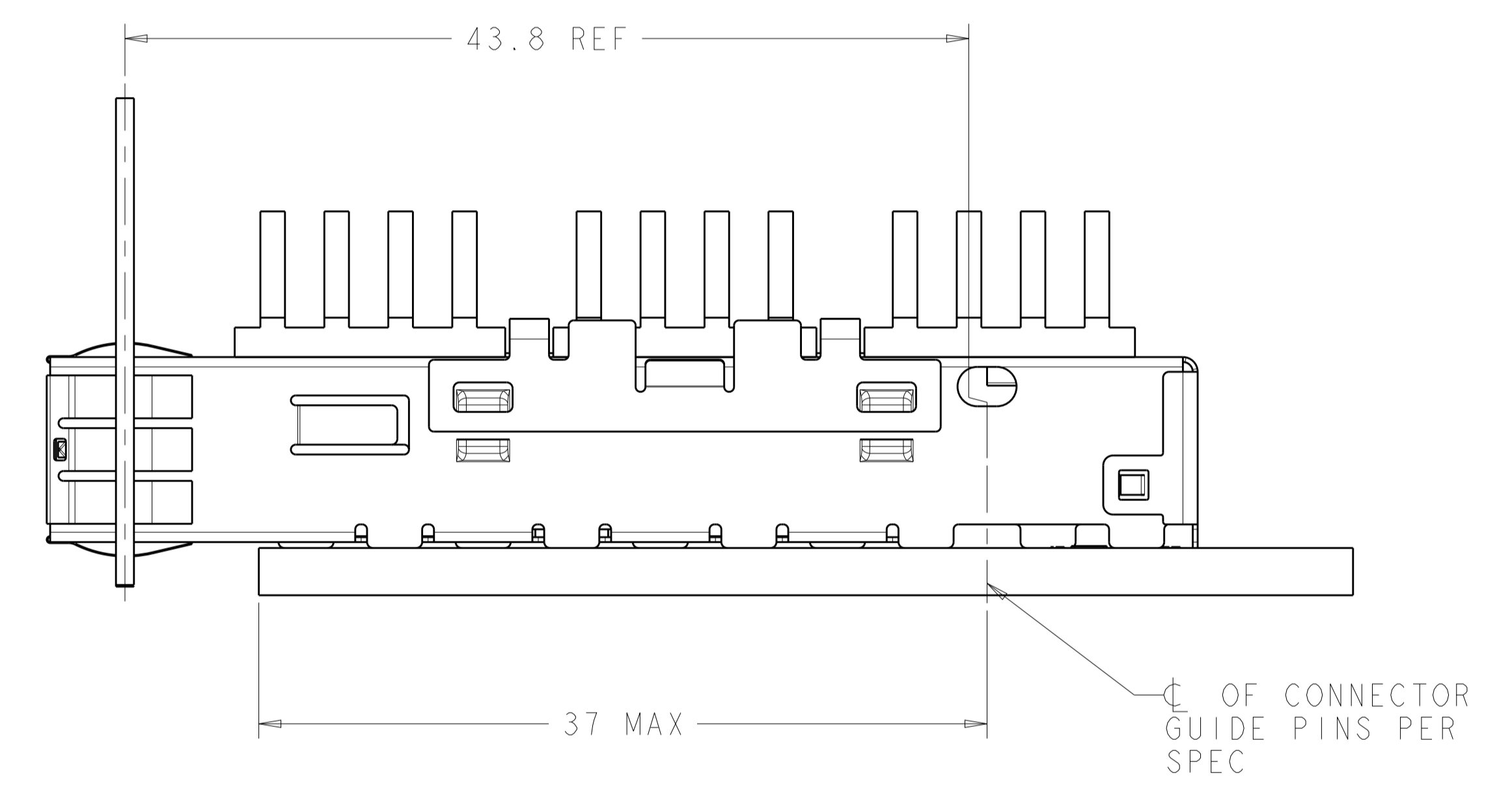
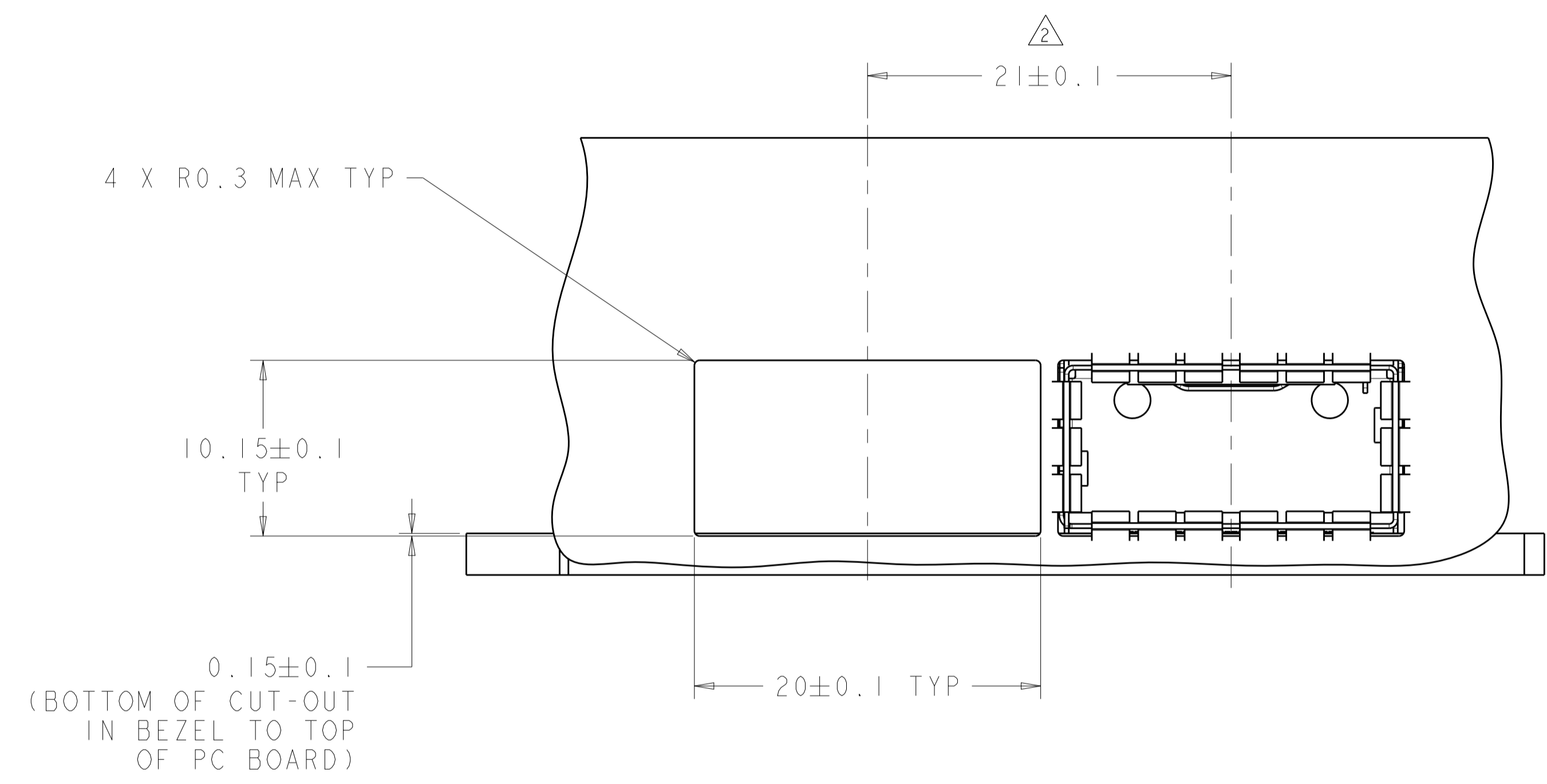

THIS PRINT IS
PRELIMINARY
 UNQUALIFIED PRODUCT
 CONTACT PRODUCT ENGINEERING
 BEFORE USING THIS PRINT

THIS DRAWING IS A CONTROLLED DOCUMENT.		DMN D. ZHU 19SEP2012	TE Connectivity
DIMENSIONS:		CHK J. YANG 19SEP2012	NAME CAGE ASSEMBLY, THRU BEZEL, QSPF WITH HEAT SINK
TOLERANCES UNLESS OTHERWISE SPECIFIED:		APVD A. CAI 19SEP2012	
mm	0 PLC ±	PRODUCT SPEC	SIZE A100779C=2170450
	1 PLC ±0.25	108-2286	
	2 PLC ±0.13	APPLICATION SPEC	RESTRICTED TO
	3 PLC ±	114-13217	
	4 PLC ±	WEIGHT	SCALE 2:1 SHEET 3 OF 4 REV 1
MATERIAL	FINISH	Customer Drawing	

LOC	DIST	REV	DATE	BY	APPD
GP	00				

REVISIONS			
NO.	DESCRIPTION	DATE	BY
1	SEE SHEET 1		

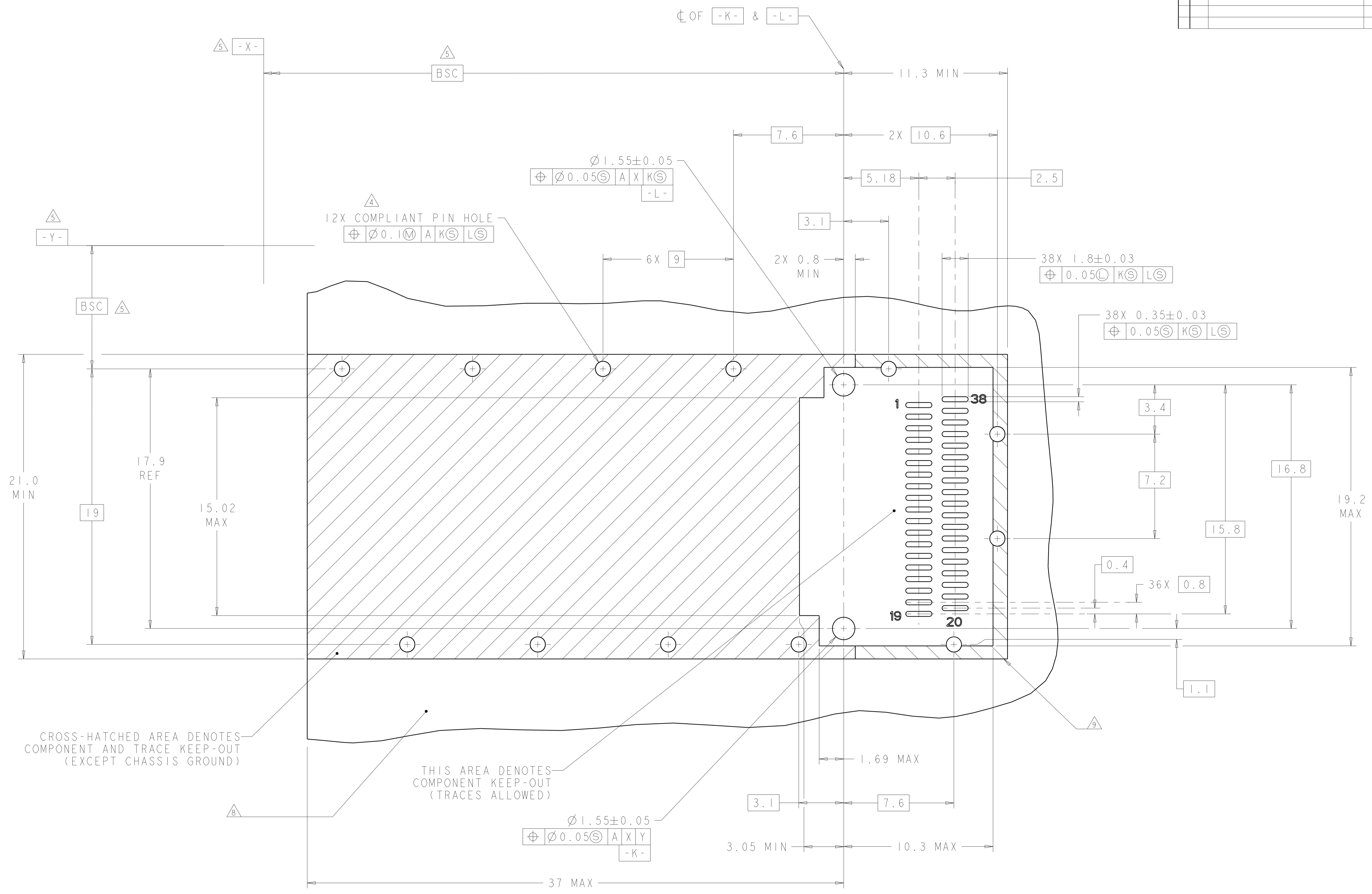

CROSS-HATCHED AREA DENOTES COMPONENT AND TRACE KEEP-OUT (EXCEPT CHASSIS GROUND)

THIS AREA DENOTES COMPONENT KEEP-OUT (TRACES ALLOWED)

RECOMMENDED PCB LAYOUT
 SCALE 8:1

THIS PRINT IS
PRELIMINARY
 UNQUALIFIED PRODUCT
 CONTACT PRODUCT ENGINEERING
 BEFORE USING THIS PRINT

THIS DRAWING IS A CONTROLLED DOCUMENT.		OWN: D. ZHU 19SEP2012	TE Connectivity NAME: CAGE ASSEMBLY, THRU BEZEL, QSPF WITH HEAT SINK PRODUCT SPEC: 108-2286 APPLICATION SPEC: 114-13217 WEIGHT: - Customer Drawing
DIMENSIONS: mm		CHK: J. YANG 19SEP2012	
TOLERANCES UNLESS OTHERWISE SPECIFIED:		APPD: A. CAI 19SEP2012	
0 PLC ±0.25 1 PLC ±0.13 2 PLC ±0.13 3 PLC ±0.13 4 PLC ±0.13 ANGLES ±0.13		SIZE: A1 CAGE CODE: 00779 DRAWING NO: 2170450 RESTRICTED TO: -	
MATERIAL: -		FINISH: -	SCALE: 2:1 SHEET 4 OF 4 REV 1

单击下面可查看定价，库存，交付和生命周期等信息

[>>TE Connectivity\(泰科\)](#)