

a) Part as supplied

202D9\*\*-\*\*-G11

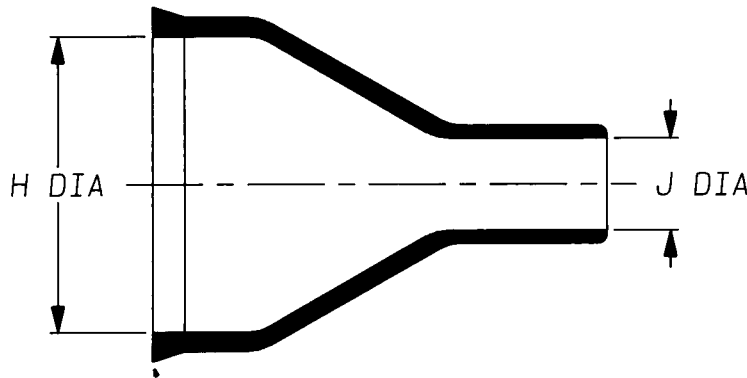

b) Part after unrestricted recovery

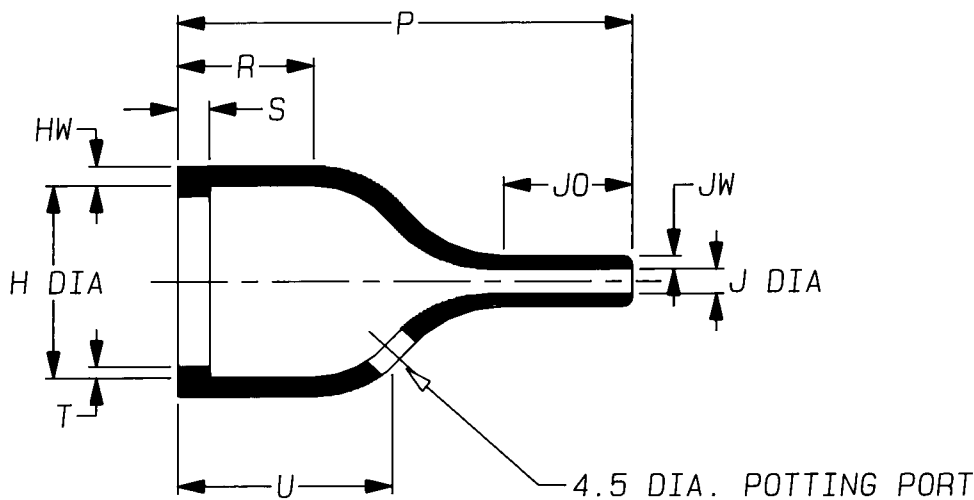

**DIMENSIONS (in millimetres)**

Part No.	H		J		P	R	S	T	U	JO	HW	JW
	Min	Max	Min	Max	±10%	Ref	Ref	Ref	±10%	±10%	±20%	±20%
	a	b	a	b	b	b	b	b	b	b	b	b
202D921	19	13.0	6	2.1	42	12	3.0	1.0	18	20	1.5	1.1
202D932	26	19.1	8	2.6	49	12	3.0	1.0	20	20	1.8	1.1
202D953	34	26.0	10	3.1	50	12	3.0	1.0	23	17	1.8	1.1
202D963	44	34.1	11	3.6	62	12	3.0	1.7	25	20	1.8	1.1
					#					#		

THIS IS A TRIMMED VARIANT WITH POTTING PORT  
MODIFIED DIMENSIONS ARE SHOWN THUS: - #

Copyright (!)

Urheberrechte

The copyright in this drawing is the property of Raychem Ltd. The drawing is issued on condition that it is not copied, reproduced or disclosed to a third party, either in whole or in part without the prior written consent of Raychem Ltd.

Drawn A.LILLEY. Checked *[Signature]* Issue 1 Date May 1994

Conforms to ISO Recommendations  
3rd Angle Projection  
Not to Scale

Approval  
Design

MKTG.

G.C. *[Signature]*

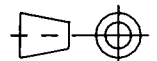

*[Signature]*

Iss.	Date	E.C.R. No.	Details of Change

### COMPATIBILITY CHART

MATERIAL DASH NUMBER	MATERIAL DESCRIPTION	COATING SLASH NUMBER
-3	POLYOLEFIN, SEMI-RIGID	/42, /86
-4	POLYOLEFIN, FLEXIBLE	/42, /86
-25	ELASTOMER, FLUID RESISTANT	/86, /225

AS SUPPLIED DIMENSIONS ARE FOR UNCOATED PARTS,  
WHEN COATING IS ADDED, ENTRY DIAMETERS WILL REDUCE BY 1.5mm MAX.

Raychem  
 Thermofit Division Europe,  
 Swindon, Wiltshire, England.  
 Telephone: (0793) 528171 Fax: 573923

单击下面可查看定价，库存，交付和生命周期等信息

[>>TE Connectivity\(泰科\)](#)