

THIS DRAWING IS UNPUBLISHED. RELEASED FOR PUBLICATION ,19 .
 © COPYRIGHT 19 BY AMP INCORPORATED. ALL INTERNATIONAL RIGHTS RESERVED.

LOC	DIST	P	F	ZONE	LTR	DESCRIPTION	DATE	APPD
G	14				A	REL PER 063A-0221-02	02MAY02	JR/TM

AMP
WIRE RANGE
 22-16 AWG
 SOLID OR STRANDED

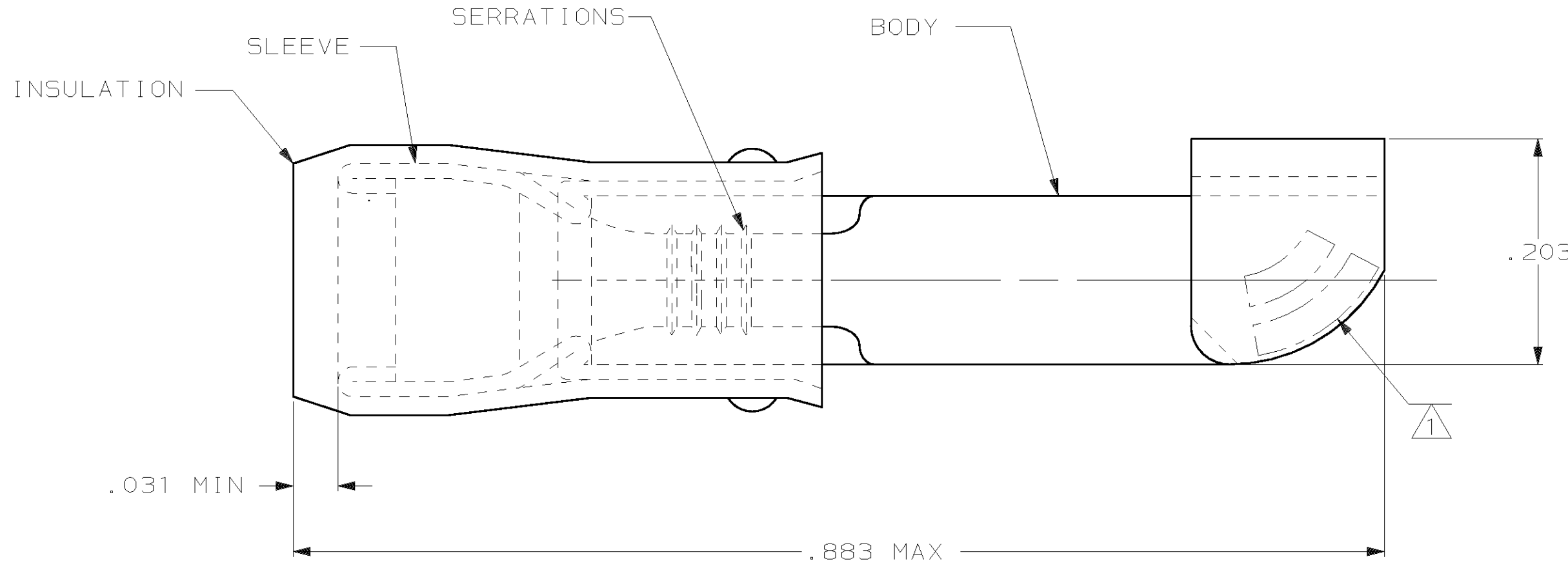

- ① MARKED "AMP 22-18*" FOR MILITARY COMMERCIAL RANGE IS 22-16
- ② DESIGNED FOR WIRE INSULATION DIA .080-.125
- ③ TONGUE MATERIAL THK .033 MAX.
- ④ PREPRODUCTION - FASR REQ

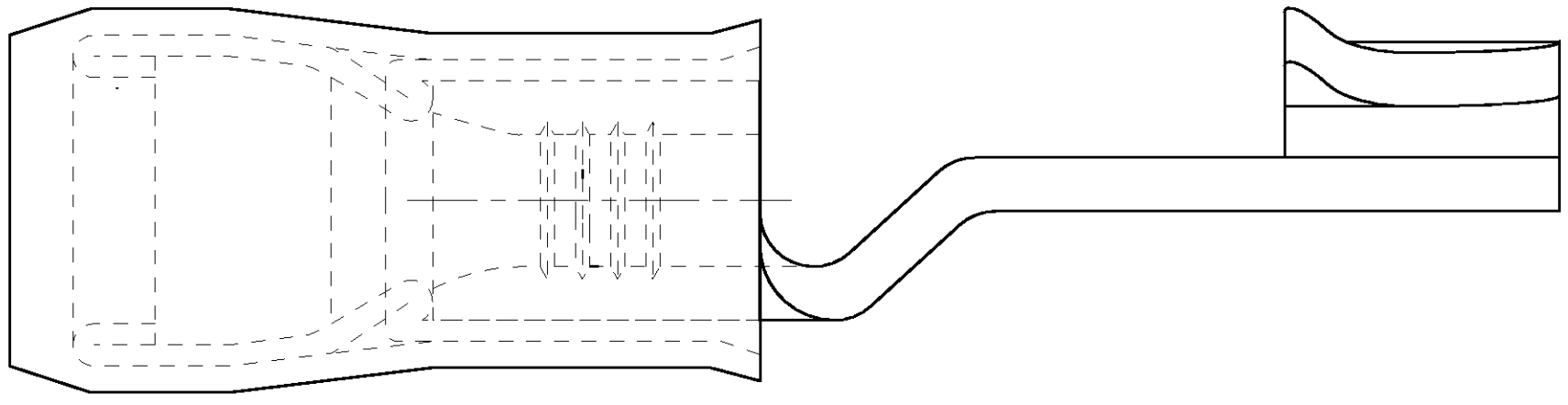

④ 696451-1
 PART NO

AMP INCORPORATED
CUSTOMER SERVICE SYSTEMS

MAX RECOMMENDED OPERATING TEMPERATURE:
 105°C [221°F]

DO NOT SCALE PRINT. UNLESS SPECIFIED DIMENSIONS IN mm [INCHES] TOLERANCES ON :
 2 PLC DEC ± -
 3 PLC DEC ± .008
 ANGLES ± -

DR 04APR02 JR RUTH
 CHK 04APR02 T MICHIELLUTI

AMP AMP Incorporated
 Harrisburg, PA 17105-3608

FOR ADDITIONAL PRODUCT INFORMATION OR COPIES OF DRAWINGS AND TECHNICAL DOCUMENTS

PRODUCT INFORMATION CENTER
 1-800-522-6752

VOLTAGE RATING:
 300V MAX

MATERIAL
 COPPER ASTM B-152
 SLEEVE, RED NYLON

APPD 04APR02 T MICHIELLUTI
 APPD 04APR02 T MICHIELLUTI
 PRODUCT SPEC -

NAME
 TERMINAL, PIDG™, KNIFE DISCONNECT,
 WIRE SIZE: 22-16 AWG

FOR APPLICATION TOOLING INFORMATION

TOOLING ASSISTANCE CENTER
 1-800-722-1111

WIRE CROSS SECTIONAL AREA RANGE:
 0.26-1.65mm² [509-3,260] CIR MILS
 SOLID OR STRANDED

FINISH
 NICKEL PL PER
 ASTM B162

APPLICATION SPEC -
 WEIGHT -

SIZE CAGE CODE DRAWING NO
 C 00779 C=696451
 SCALE 10:1 SHEET 1 OF 1

THIS DRAWING IS A CONTROLLED DOCUMENT FOR AMP INCORPORATED. IT IS SUBJECT TO CHANGE AND THE CONTROLLING ENGINEERING ORGANIZATION SHOULD BE CONTACTED FOR THE LATEST REVISION.

单击下面可查看定价，库存，交付和生命周期等信息

[>>TE Connectivity\(泰科\)](#)