

DRAWING MADE IN THIRD ANGLE PROJECTION

LOC	DIST	P	F	LTR	DESCRIPTION	DATE	APPROVED
AJ	16						
		✓	✓	O	-	-	-
		✓	✓	A	CHG DASH NO. 5	11/6/90	KH
		✓	✓	B	REV NOTES & TABLE	11/30/90	KH
					PR 90-3348-147		

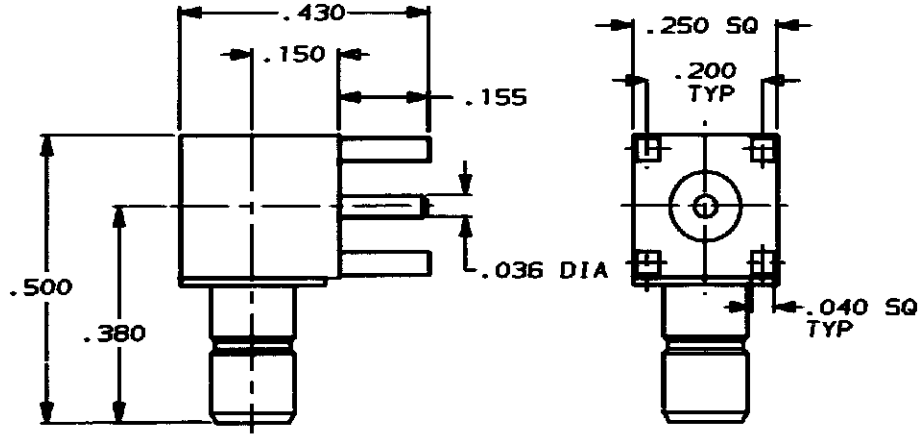

- MATERIALS:  
 BODY...BRASS PER QQ-B-626  
 CENTER CONTACT...  
 BERYLLIUM COPPER PER  
 QQ-C-530  
 DIELECTRIC...TFE PER  
 ASTM-D-1710

2 FINISH:  
 BODY, AND CENTER  
 CONTACT...GOLD PER  
 MIL-G-45204

3 FINISH:  
 BODY...NICKEL PER QQ-N-290  
 CENTER CONTACT...  
 GOLD PER MIL-G-45204

3	413996-4
2	413996-2
NOTES	PART NO

THIS DRAWING IS UNPUBLISHED. RELEASED FOR PUBLICATION BY AMP INCORPORATED. ALL INTERNATIONAL RIGHTS RESERVED. COPYRIGHT 19

DO NOT SCALE PRINT.  
 UNLESS SPECIFIED  
 DIMENSIONS IN INCHES  
 TOLERANCES ON:  
 2 PLC DEC ± .01  
 3 PLC DEC ± .005  
 ANGLES ± 1°

DR	<i>J. McLeod</i>	10/25/90
CHK	J. McLEOD	11/6/90
APPD	J. McLEOD	11/6/90
APPD	K. HEILIG	11/30/90
MATERIAL	PRODUCT SPEC	-
FINISH	APPLICATION SPEC	-
WEIGHT	-	-

**AMP** AMP Incorporated  
 Harrisburg, PA 17105-3608

NAME  
**JACK RCPT, MALE, RTANG, SMB/PCB**

MATERIAL  
 SEE NOTES

FINISH  
 SEE NOTES

SIZE	CAGE CODE	DRAWING NO
A	00779	413996
SCALE	NTS	SHEET 1 OF 1

AMP 1-69-32 REV 11-89

CUSTOMER DRAWING

单击下面可查看定价，库存，交付和生命周期等信息

[>>TE Connectivity\(泰科\)](#)