

THIS DRAWING IS UNPUBLISHED. RELEASED FOR PUBLICATION
 © COPYRIGHT - By - ALL RIGHTS RESERVED.

| LOC | | DIST | | REVISIONS | | | |
|-----|-----|-------------|--|---------------|-----------|------|-----|
| P | LTR | DESCRIPTION | | DATE | DWN | APVD | |
| CM | 53 | C | | ECO-13-000901 | 08MAR2013 | MGT | R.P |

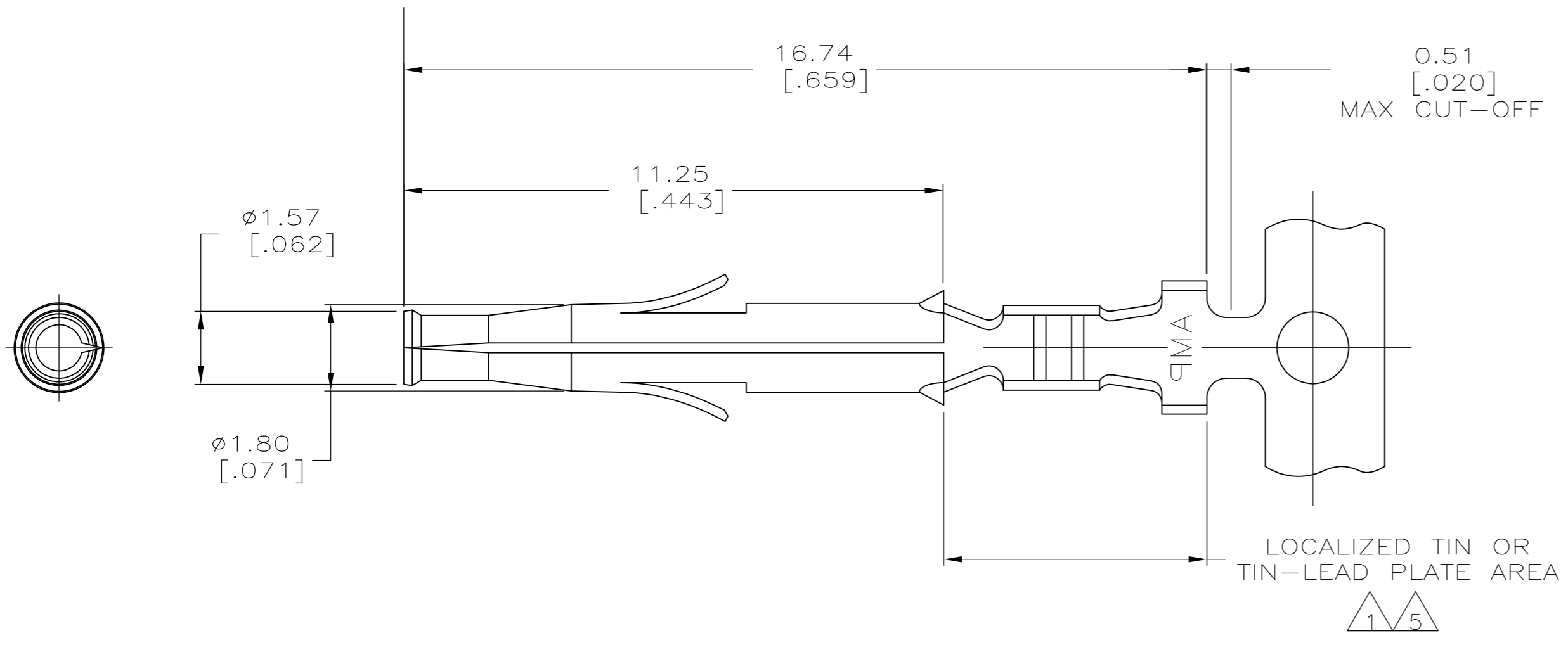

- 1. 0.00076 [.000030] MIN GOLD IN LOCALIZED GOLD PLATE AREA AND 0.00254 [.000100] MIN BRIGHT TIN-LEAD IN LOCALIZED TIN-LEAD PLATE AREA OVER 0.0013 [.000050] MIN NICKEL.
- 2. DIMENSIONS IN BRACKETS ARE IN INCHES.
- 3. INSULATION RANGE :1.50-2.40[.060-.094] DIA.
- 4. WIRE RANGE: 0.3 - 0.9mm² (22-18 AWG).
- 5. 0.00076 [.000030] MIN GOLD IN LOCALIZED GOLD PLATE AREA AND 0.00254 [.000100] MIN MATTE TIN IN LOCALIZED TIN PLATE AREA OVER 0.0013 [.000050] MIN NICKEL.

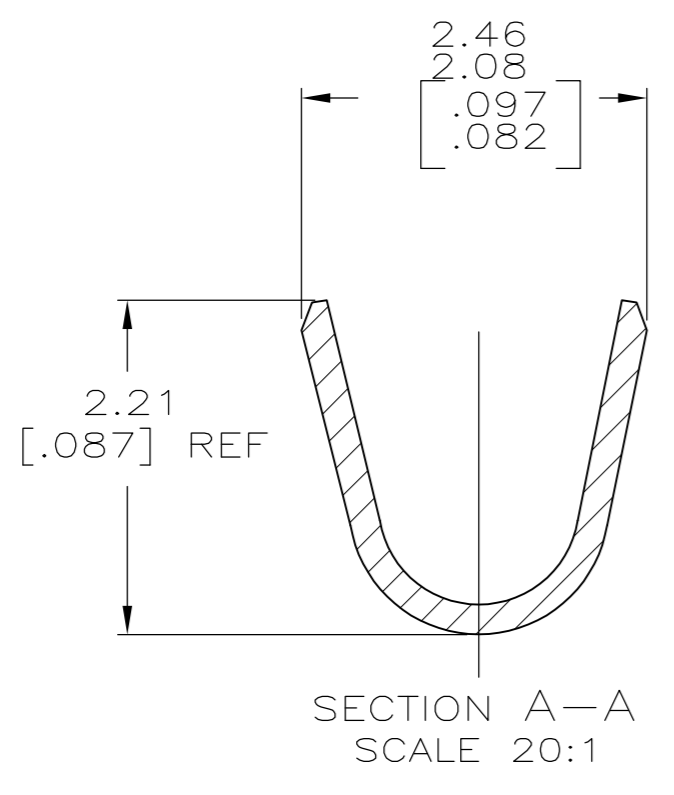
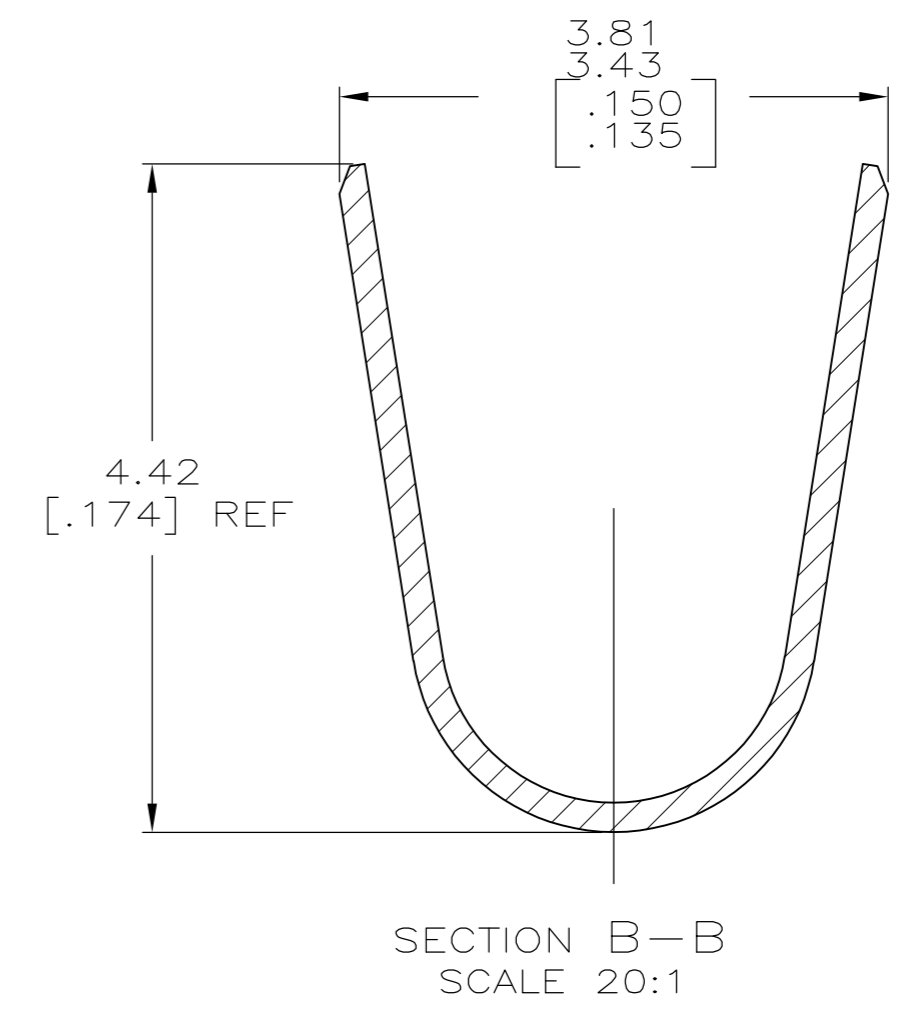
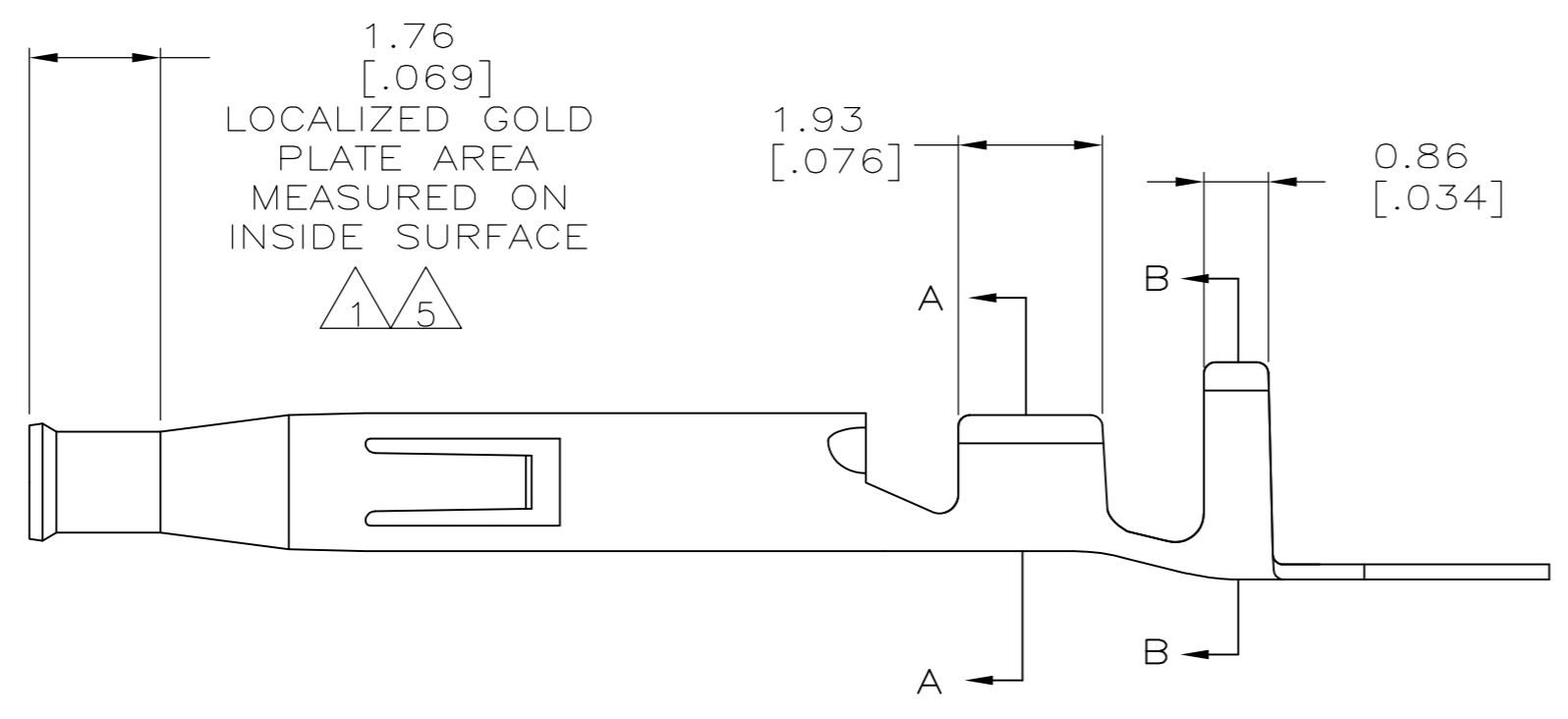

| | | |
|---------|-------------------|-------------|
| 5 | 0.20 [.008] BRASS | 1-794137-0 |
| 1 | 0.20 [.008] BRASS | 794137-3 |
| PRE-TIN | 0.20 [.008] BRASS | 794137-1 |
| FINISH | MATERIAL | PART NUMBER |

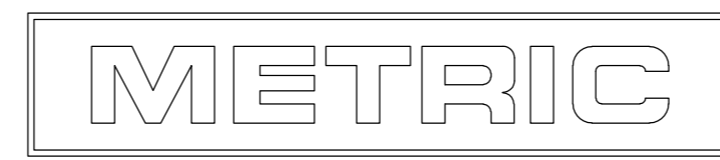

| | | | | | | | | |
|--|-----------|------------------|-----------|---------|------------------|---------------------------------------|-----------|------------|
| THIS DRAWING IS A CONTROLLED DOCUMENT. | | DWN | R.VESTAL | 17OCT96 | | TE Connectivity | | |
| DIMENSIONS: mm [INCHES] | | CHK | R.SWING | 17OCT96 | | NAME | | |
| TOLERANCES UNLESS OTHERWISE SPECIFIED: | | APVD | R.ORSTAD | 17OCT96 | | SOCKET, MINI UNIVERSAL MATE-N-LOK(TM) | | |
| 0 PLC ± - | | PRODUCT SPEC | | | | SIZE | CAGE CODE | DRAWING NO |
| 1 PLC ± - | | APPLICATION SPEC | | | A2 | 00779 | C=794137 | - |
| 2 PLC ± - | | | | | SCALE | | SHEET | REV |
| 3 PLC ± 0.15[.006] | | | | | 10:1 | | 1 of 1 | C |
| 4 PLC ± - | | | | | CUSTOMER DRAWING | | | |
| ANGLES ± 1° | | | | | | | | |
| MATERIAL | SEE TABLE | FINISH | SEE TABLE | WEIGHT | | | | |

单击下面可查看定价，库存，交付和生命周期等信息

[>>TE Connectivity\(泰科\)](#)