

THIS DRAWING IS UNPUBLISHED. RELEASED FOR PUBLICATION
 © COPYRIGHT - By - ALL RIGHTS RESERVED.

REVISIONS					
P	LTR	DESCRIPTION	DATE	DWN	APVD
	AK	REVISED PER ECR-19-015400	14OCT2019	PC	SE

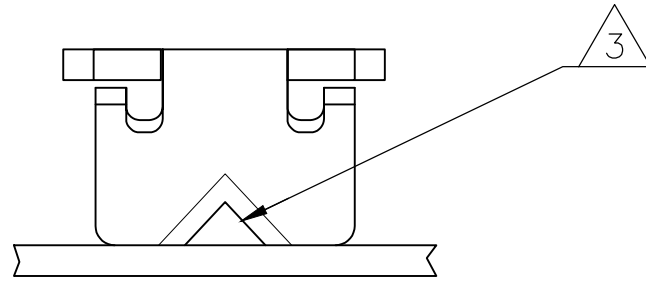

- 1 CONTINUOUS STRIP ON REELS WITH TERMINALS LOCATED ON 5.59±0.08 [.220±.003] CENTERS.
- 2 SLOT ACCEPTS EITHER A SINGLE OR DOUBLE MAGNET WIRE OF THE SAME SIZE AND TYPE.
COPPER RANGE 0.36-0.57mm [#27-#23 AWG].
ALUMINUM RANGE 0.51-0.64mm [#24-#22 AWG].
ALUMINUM WIRE RANGE IS APPLICABLE FOR POST TIN PLATED PART NUMBERS ONLY
- 3 POKE-IN ACCEPTS A 0.50-0.90mm? [#20-#18] AWG SOLID OR FUSED STRANDED LEAD WIRE.
- 4 SPECIAL REEL QUANTITY - SPAIN PRODUCTION ONLY.
- 5 PRELIMINARY - NOT FOR PRODUCTION.
- 6 NON-US PRODUCTION ONLY.
- 7 PREPRODUCTION - FASR REQUIRED

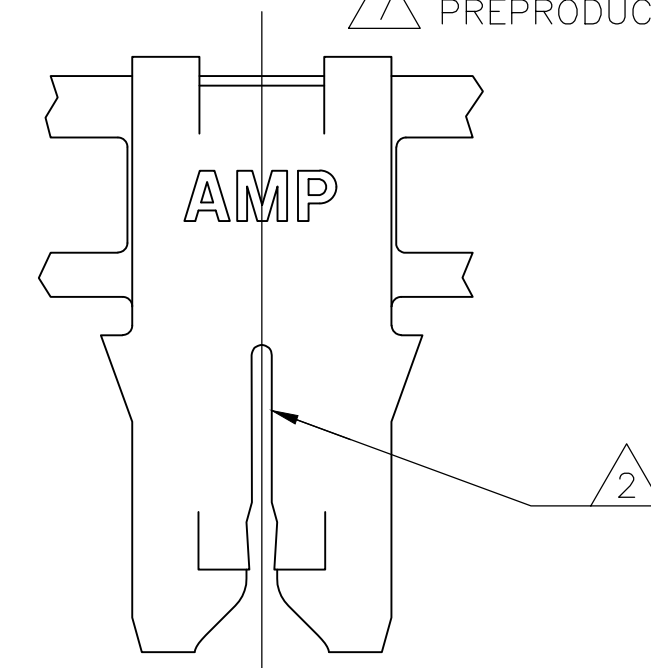
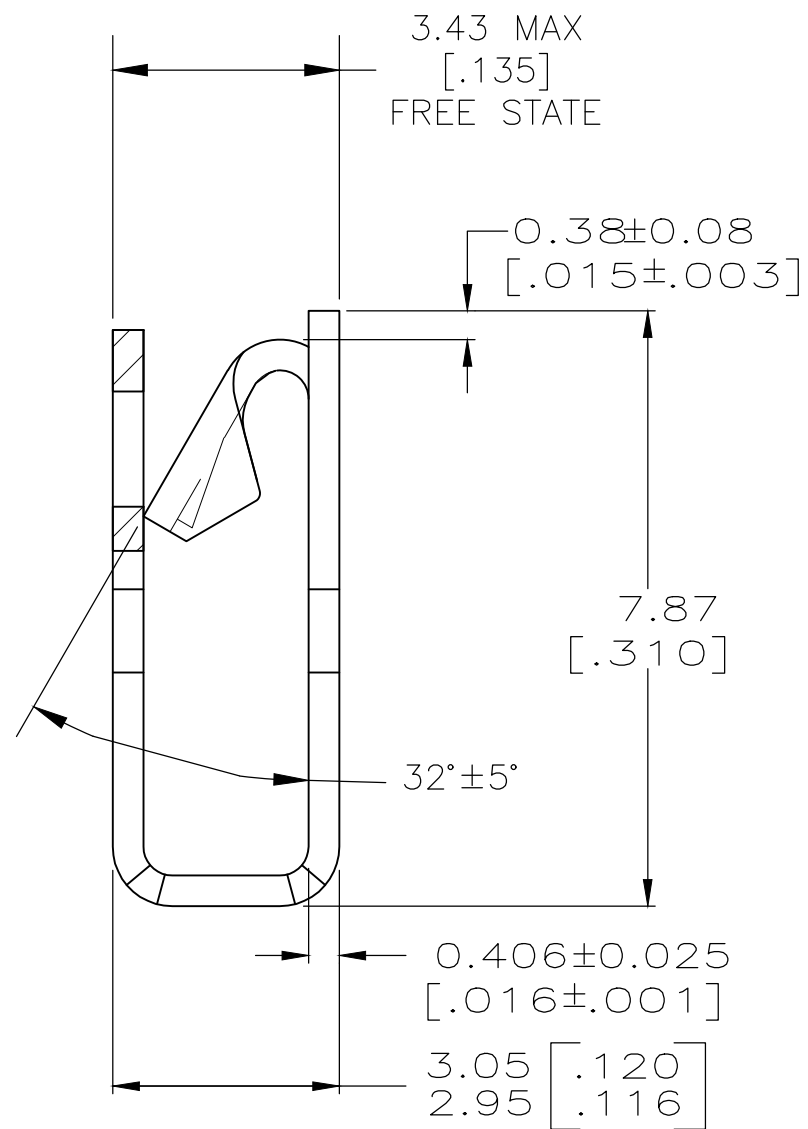
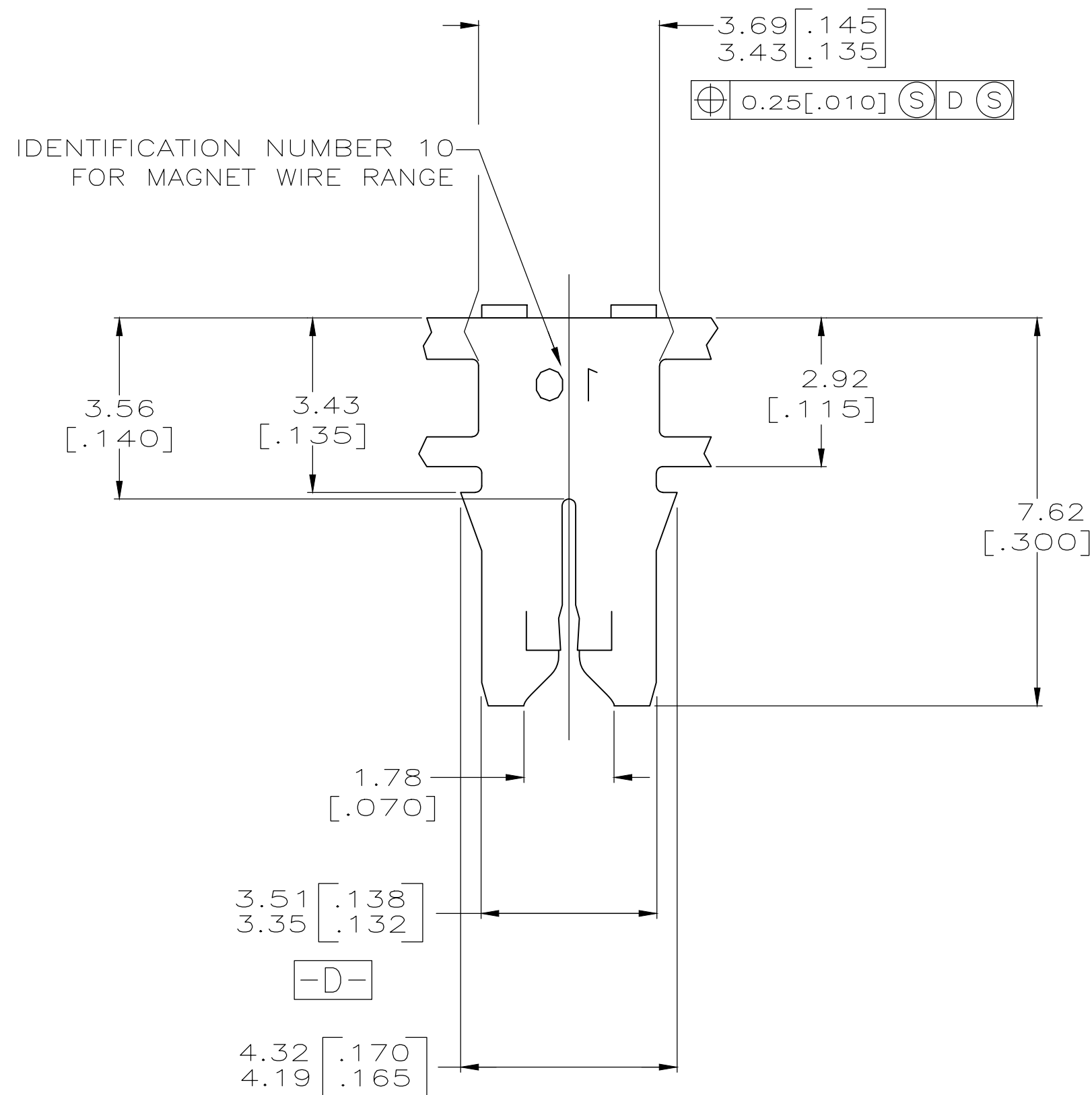

	STANDARD	PAPER SPLICE	WITH PAPER	TIN PLATED	BRASS	1-62935-2
	STANDARD	PAPER SPLICE	WITHOUT PAPER	TIN PLATED	CuNiSi	62935-9
	STANDARD	PAPER SPLICE	WITHOUT PAPER	TIN PLATED	BRASS	62935-8
	STANDARD	SPLICE FREE	WITH PAPER	TIN PLATED	BRASS	62935-7
	REVERSE	PAPER SPLICE	WITHOUT PAPER	TIN PLATED	BRASS	62935-6
OBSOLETE	STANDARD	WELD SPLICE	WITHOUT PAPER	TIN PLATED	BRASS	62935-5
OBSOLETE	STANDARD	SPLICE FREE	PLASTIC REEL W/O PAPER	TIN PLATED	BRASS	62935-4
	STANDARD	PAPER SPLICE	WITH PAPER	TIN PLATED	BRASS	62935-3
	STANDARD	PAPER SPLICE	PLASTIC REEL W/ PAPER	NONE	BRASS	62935-2
	STANDARD	PAPER SPLICE	WITHOUT PAPER	TIN PLATED	BRASS	62935-1
	REELING DIRECTION	SPLICE	REELING	FINISH	MATERIAL	PART NUMBER

THIS DRAWING IS A CONTROLLED DOCUMENT.

DWN: MICHAEL S. FEHER 15MAR2004
 CHK: KURT A. RANDOLPH 15MAR2004
 APVD: KURT A. RANDOLPH 15MAR2004

TE Connectivity

NAME: KURT A. RANDOLPH
 PRODUCT SPEC: 108-2012
 APPLICATION SPEC: 114-2046

SIZE: A2 CAGE CODE: 00779 DRAWING NO: C-62935 RESTRICTED TO: -

MATERIAL: SEE TABLE FINISH: SEE TABLE WEIGHT: 0 SCALE: 10:1 SHEET: 1 OF 1 REV: AK

CUSTOMER DRAWING

单击下面可查看定价，库存，交付和生命周期等信息

[>>TE Connectivity\(泰科\)](#)