

THIS DRAWING IS UNPUBLISHED. RELEASED FOR PUBLICATION  
 © COPYRIGHT - TE Connectivity Ltd. ALL RIGHTS RESERVED.

REVISIONS				
P	LTR	DESCRIPTION	DATE	APVD
A		INITIAL RELEASE	27AUG2018	Z.W S.M

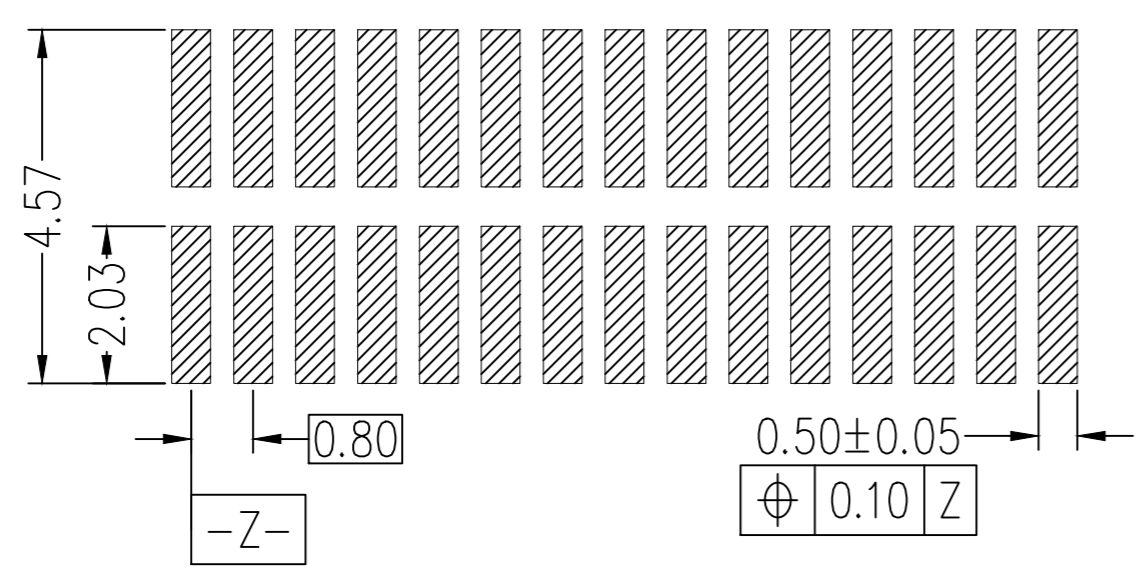
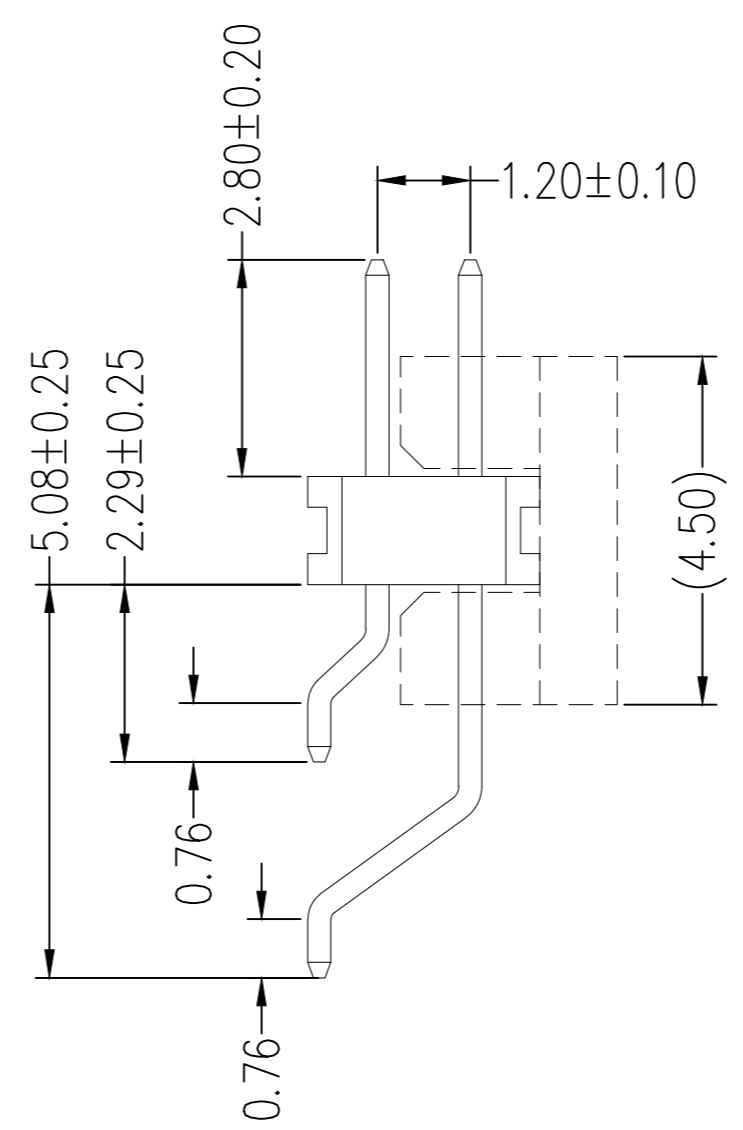
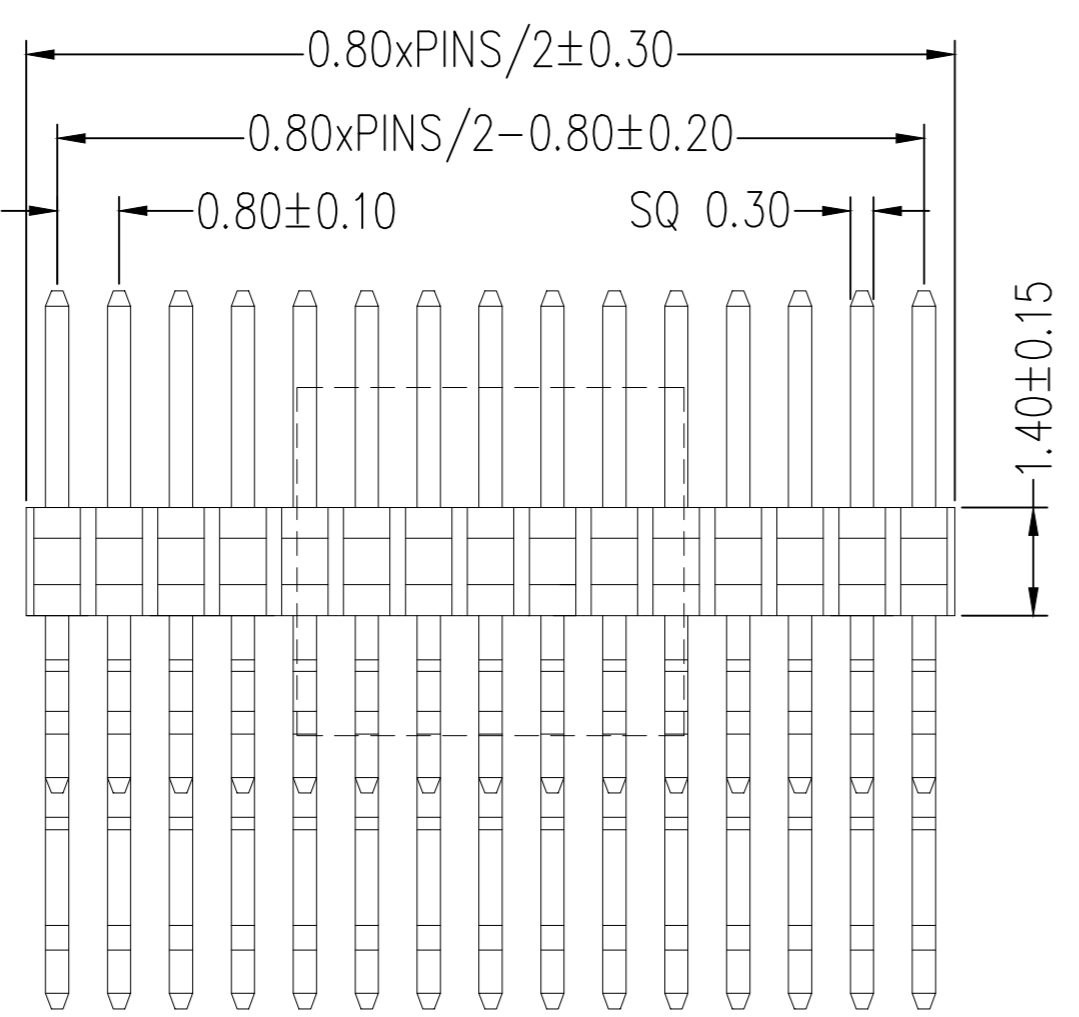
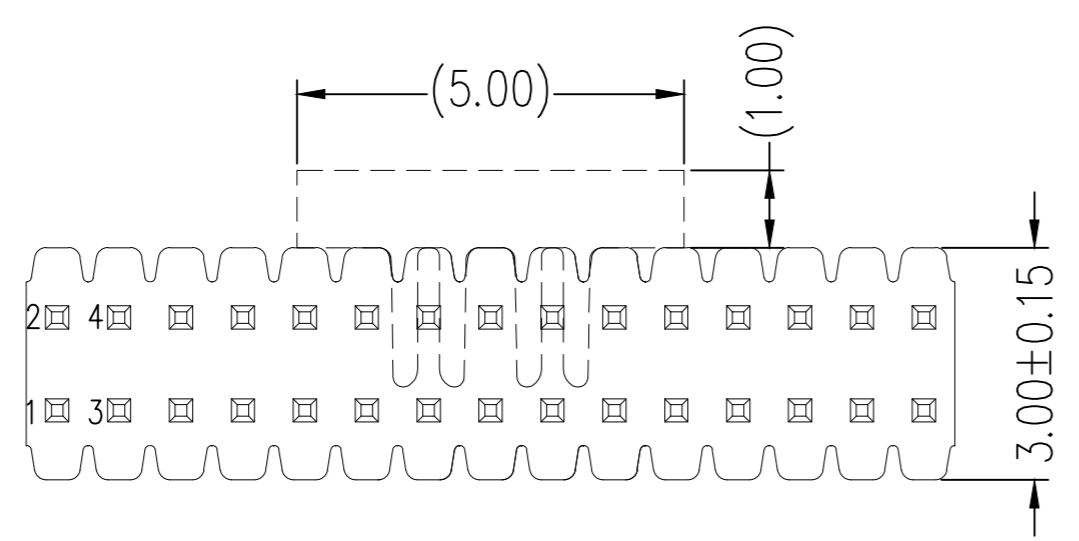

RECOMMENDED P.C.B LAYOUT  
(COMPONENT SIDE)

NOTES:  
 1,Current Rating: 0.75AMP  
 2,Contact Resistance: 30mΩ Max  
 3,Withstand Voltage: 500V AC/DC  
 4,Insulation Resistance: 1000MΩ Min  
 5,Operation Temperature: -40°C to +105°C  
 6,Contact Material: Copper alloy  
 7,Contact Plating: Gold over nickel  
 8,Insulator Material:  
 High Temperature Plastic, UL94V-0, BK  
 Recommended soldering process:  
 IR Soldering,Peak temperature: 260°C,5s

REEL	100	TBD
REEL	12	1-2271988-2
REEL	6	2271988-6
PACKING	PINS	PN

PRODUCT FAMILY TABLE

THIS DRAWING IS A CONTROLLED DOCUMENT.		DWN	ZHANG WEI	27AUG2018	 TE Connectivity Ltd.			
DIMENSIONS:		CHK	GEORGE FU	27AUG2018				
mm		APVD	SHI MING	27AUG2018				
TOLERANCES UNLESS OTHERWISE SPECIFIED:		PRODUCT SPEC						
0 PLC	± -	APPLICATION SPEC			NAME	PIN HEADER,0.8MM PITCH,SMT TYPE DUAL ROW		
1 PLC	± 0.25				SIZE	CAGE CODE	DRAWING NO	RESTRICTED TO
2 PLC	± 0.25				A2	00779	C=2271988	-
3 PLC	± -				CUSTOMER DRAWING		SCALE	1:1
4 PLC	± -						SHEET	1 of 1
ANGLES	± -						REV	A
MATERIAL		FINISH						

单击下面可查看定价，库存，交付和生命周期等信息

[>>TE Connectivity\(泰科\)](#)