

THIS DRAWING IS UNPUBLISHED. RELEASED FOR PUBLICATION 20  
 © COPYRIGHT 20 BY - ALL RIGHTS RESERVED.

**CONFIDENTIAL**

REVISIONS				
P	LTR	DESCRIPTION	DATE	APVD
AA		RELEASED PER CRN24071	21APR2016	LS KA
AB		RELEASED PER CRN24444	10FEB2017	DCB KA
AC		RELEASED PER CRN25370	04FEB2019	LS RM

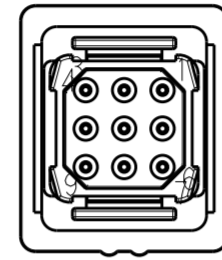
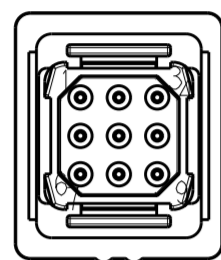
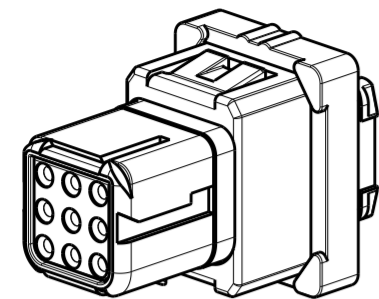

SOCKET/FEMALE CONTACT CAVITY IDENTIFICATION ON REAR

PIN/MALE CONTACT CAVITY IDENTIFICATION ON REAR

KEYWAY TABLE	
ORIENTATION	COLOR
N	BLACK
A	DARK RED
B	DARK BLUE
C	DARK GREEN
D	YELLOW

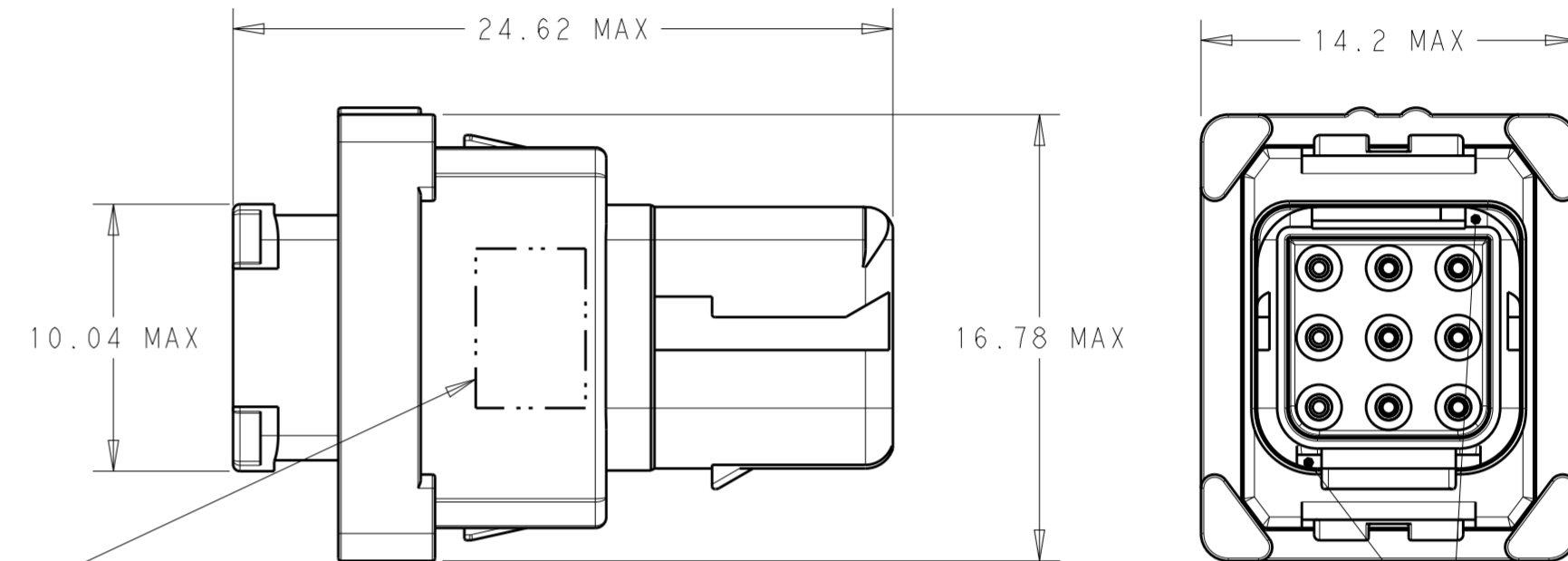

1 MARKED WITH DEUTSCH PART NO, DEUTSCH (HASTINGS) CAGE CODE AND DATE CODE ON EITHER SIDE.

PART NUMBER EXAMPLE: D369 - A 9 9 - N S 1

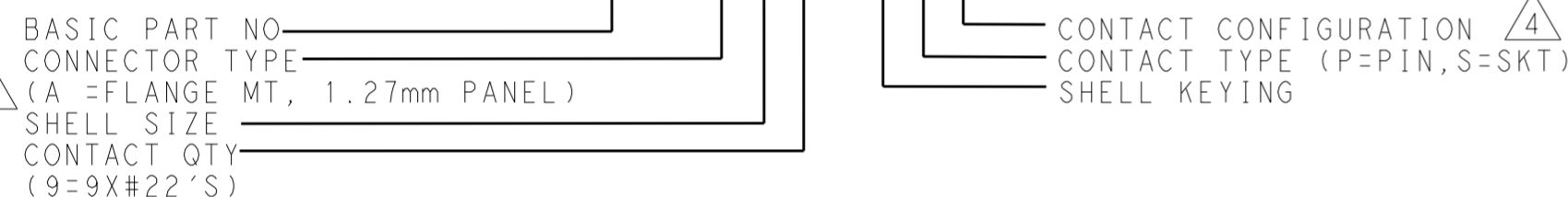

2. PERFORMANCE:  
 TEMPERATURE RANGE: -55°C TO +175°C. INSULATION RESISTANCE: ≥5000MΩ.  
 DIELECTRIC WITHSTAND: 1500VRMS, <2mA. SEALING: 15KM(50000FT) ALTITUDE/IP67  
 DURABILITY: 500 MATING CYCLES MIN. FLUID RESISTANCE: I.A.W. EN2591-315.  
 FLAMMABILITY, SMOKE AND TOXICITY: I.A.W. FAR 25.853 APPENDIX F.

3. INSERTION/EXTRACTION TOOL (M81969/14-01 OR EQUIVALENT) SUPPLIED SEPARATELY.

CONTACT CONFIGURATION	CONTACT DESCRIPTION	CONTACT P/N (OR EQUIVALENT)		CRIMP POSITIONER		CRIMP TOOL	WIRE ACCOMMODATION	CURRENT RATING
		PIN	SOCKET	PIN	SOCKET			
0		NO CONTACTS SUPPLIED						
1	CRIMP, COPPER WIRE	38941-22	38946-22	M22520/2-09	M22520/2-06	M22520/2-01	22-28 AWG	5A (22 AWG)
2	CRIMP, ALUMINUM WIRE	200-1042-22	200-1142-22	KAL2		ALNP 22-A	22 AWG	5A
3	CRIMP, COPPER WIRE (ENLARGED WIRE)	182-0860-22	182-0862-22	M22520/2-09	M22520/2-06	M22520/2-01	20-24 AWG	5A (20 AWG)

5. MATERIALS:  
 SEALS & PANEL GASKET: SILICONE/FLUOROSILICONE BLEND RUBBER PER AMS-R-25988 TYPE II, CLASS I, GRADE 40.  
 BODY/INSERT COMPONENTS: POLYETHERIMIDE, 10% GLASS FILLED PER ASTM D 5205 OR POLYETHERETHERKETONE 450G.

6 MAXIMUM WEIGHT (WITHOUT CONTACTS): 2.4g (SKT INSERT), 2.2g (PIN INSERT).

7 RECOMMENDED PANEL THICKNESS LISTED IN TABLE BELOW FOR REFERENCE ONLY. REFER TO INSTRUCTION SHEET 408-32194 FOR RECOMMENDED PANEL CUT-OUT DIMENSIONS.

GASKET CONFIGURATION	NUMBER OF MARKS	RECOMMENED PANEL THICKNESS	GASKET PART NUMBER
A*	2	1.27	612154-9-A
B	3	1.60	612154-9-B
C*	4	2.03	612154-9-C

\* - NOT TOOLED, CONSULT TE.

8. FILLER PLUGS AVAILABLE FOR CONTACT CAVITIES.  
 TE PART NUMBER: 600300-22  
 MIL-SPEC: MS27488-22-2

1

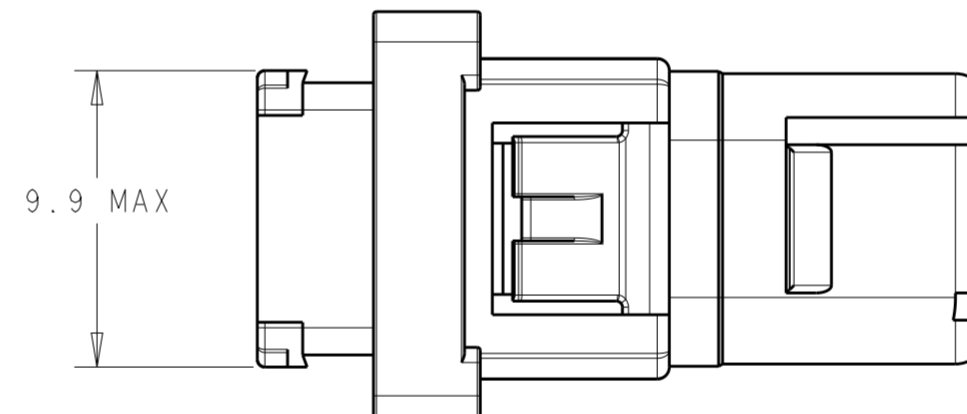

ORIENTATION KEYS ("N" SHOWN)

ACCESSORY OR BOOT MOUNTING FEATURE

SHELL COLOR IS KEYING DEPENDENT (SEE TABLE)

GASKET IDENTIFICATION MARKS ("A" SHOWN)

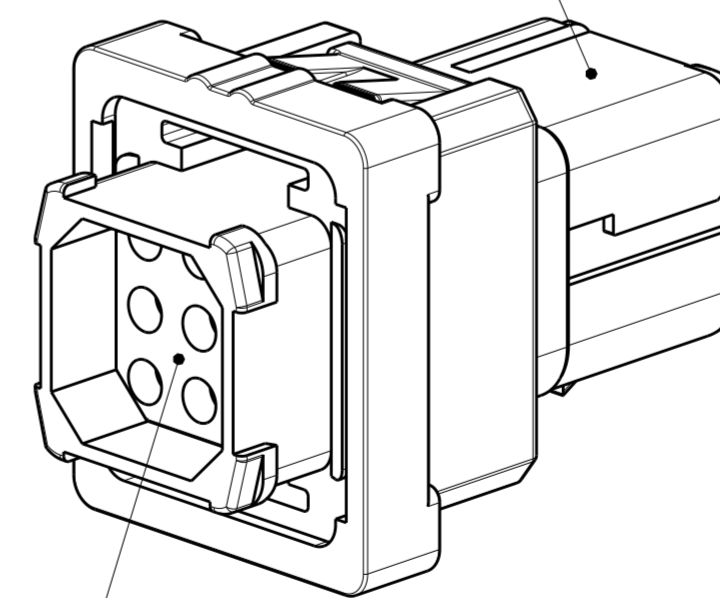

REAR WIRE SEAL

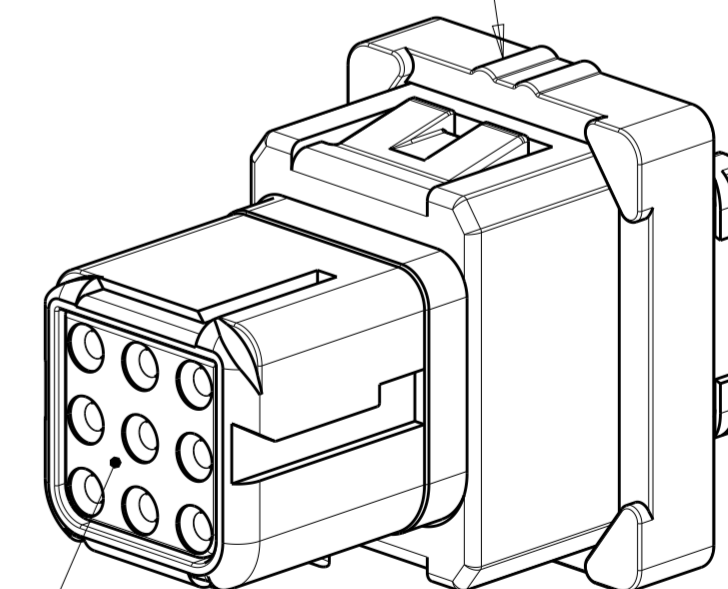

INSERT (SOCKET TYPE "S" SHOWN)

THIS DRAWING IS A CONTROLLED DOCUMENT.		DWN	L. SIPE	30DEC2014	 TE Connectivity	NAME		D369 PANEL MOUNT RECEPTACLE, SHELL SIZE 9, 9 WAY	
DIMENSIONS:		CHK	K. ANNIS	30DEC2014		PRODUCT SPEC		-	
mm		APVD	K. ANNIS	30DEC2014		APPLICATION SPEC		-	
TOLERANCES UNLESS OTHERWISE SPECIFIED:		MATERIAL		WEIGHT		SCALE		SHEET	
0 PLC	±	-		6		4:1		1 OF 1	
1 PLC	±	-		-		-		REV AC	
2 PLC	±	-		-		-		-	
3 PLC	±	-		-		-		-	
4 PLC	±	-		-		-		-	
ANGLES	±	-		-		-		-	
FINISH	-	-		-		-		-	

单击下面可查看定价，库存，交付和生命周期等信息

[>>TE Connectivity\(泰科\)](#)