

BRS 325
2 à 61 positions

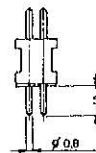
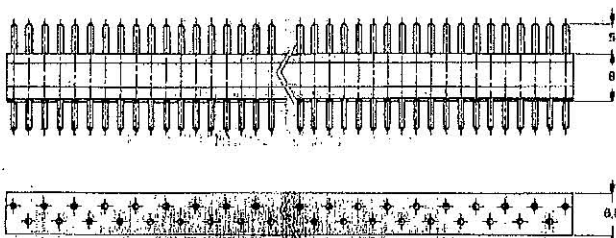
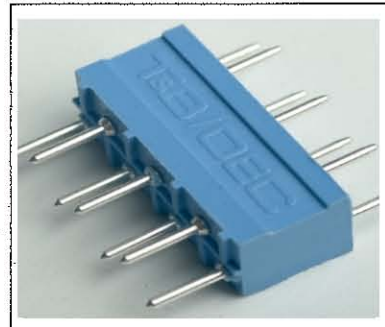
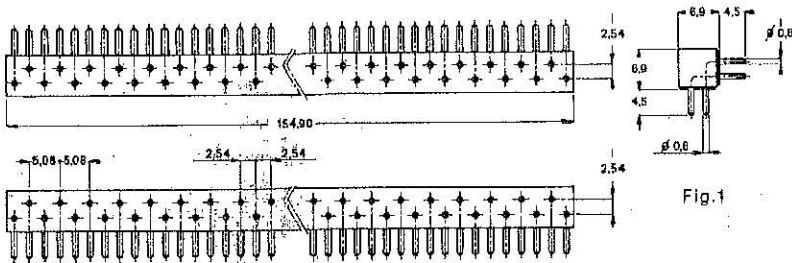

Fig.2

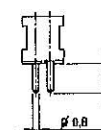
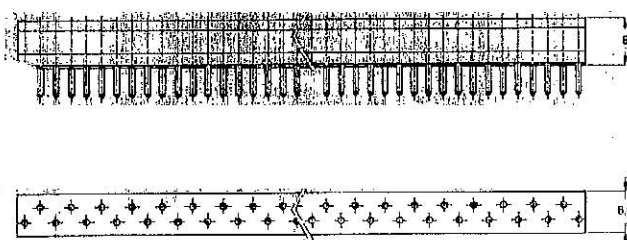

Fig.3

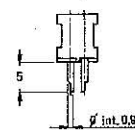
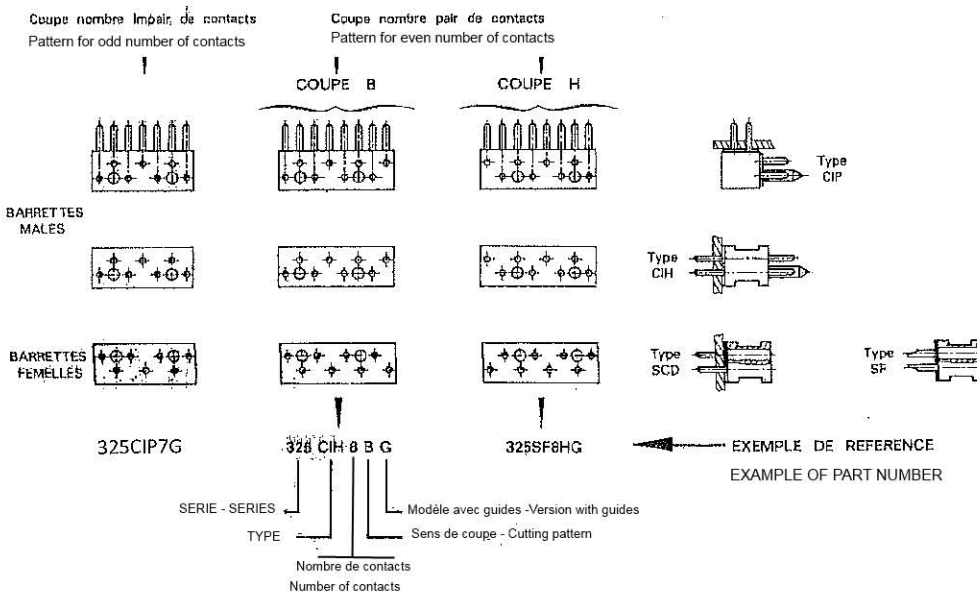

Fig.4

Référence	BRS325CIP61	BRS325CIH61	BRS325SCD61	BRS325SF61
Figure	1	2	3	4



单击下面可查看定价，库存，交付和生命周期等信息

[>>TE Connectivity\(泰科\)](#)