

REVISIONS					
P	LTN	DESCRIPTION	DATE	DWN	APVD
A11		REVISED PER ECO-10-020914	22NOV2010	DLD	DCM
A12		REVISED PER ECO-20-012415	10SEP2020	AP	CM

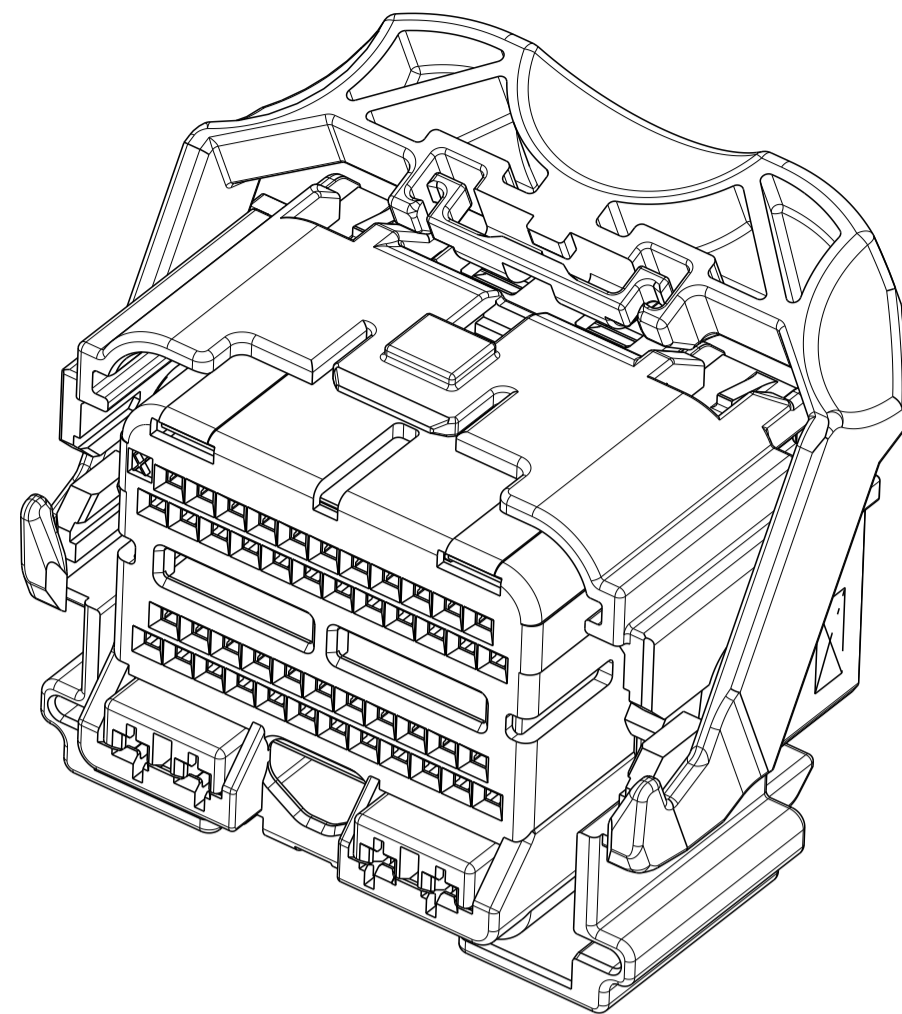

PART NUMBER:
1438693-1
SHOWN WITH SPACER
IN SEATED POSITION
SCALE 2:1

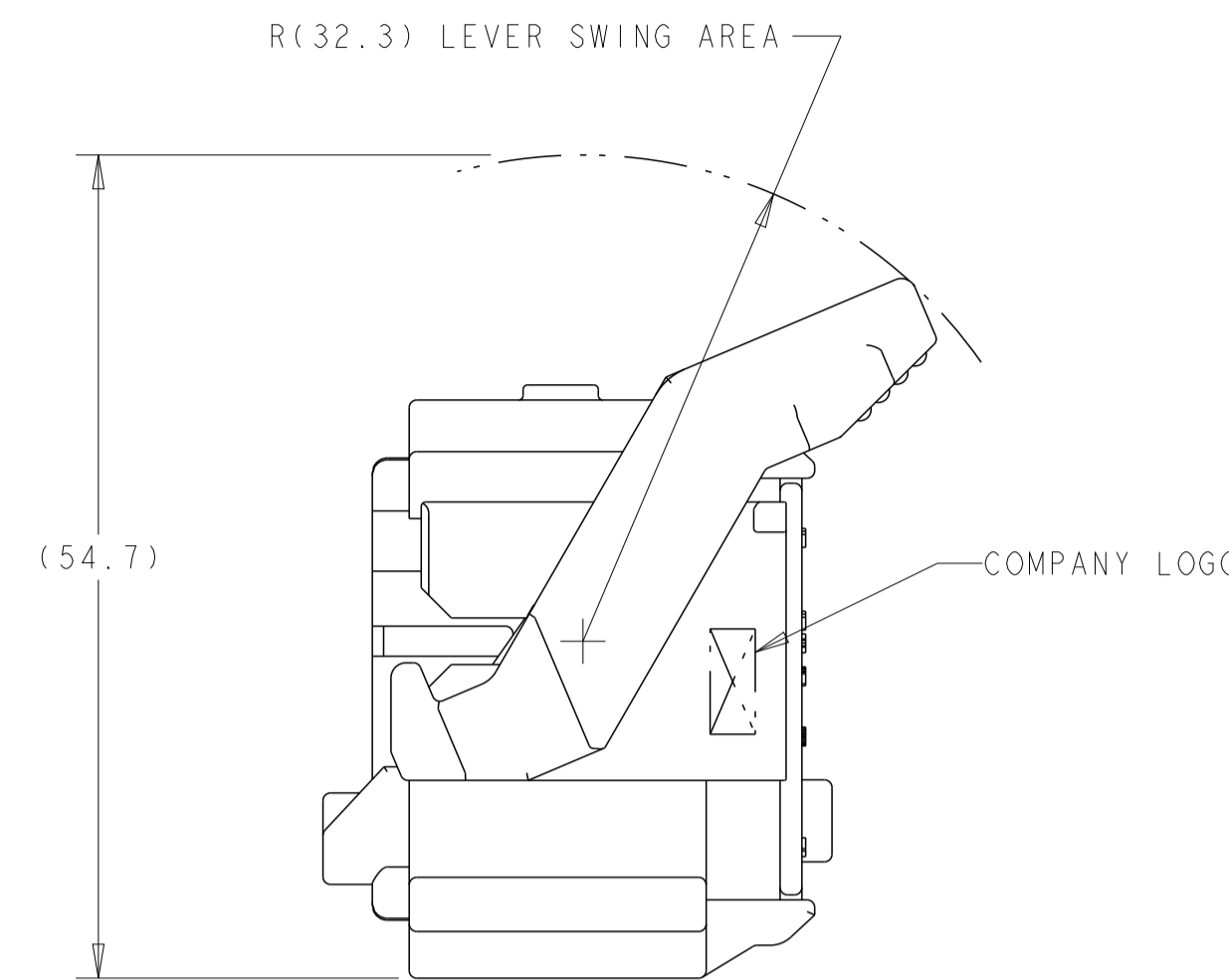
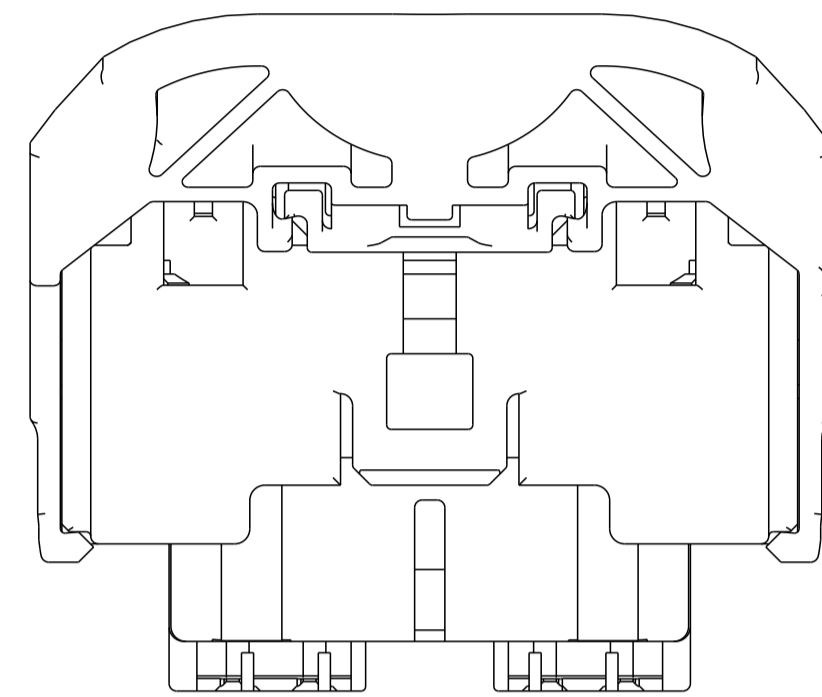

SHOWN WITH SPACER IN SEATED POSITION

PRINT TYCO ELECTRONICS PART NUMBER AND TRACEABILITY (YY : 2 DIGIT YEAR, JJJ = JULIAN DATE, HH = 2 DIGIT MILITARY HOUR CODE) IN THE LOCATION AT ASSEMBLY.

OPTIONAL WIRE SHIELD PART NUMBERS (SOLD SEPARATELY) 1438126, 1438180, 1488373, AND 1488572. CONTACT TYCO ELECTRONICS ENGINEER FOR MINIMUM FEED THRU CONDITION.

3. APPLICABLE TERMINAL PART NUMBERS (SOLD SEPARATELY)
FOR TIN APPLICATIONS: 1393367 AND 1393366.
FOR GOLD APPLICATIONS: 1393365 AND 1393364
FOR TERMINATION AND REELING OPTIONS SEE DRAWINGS 1393367, 1393366, 1393365, AND 1393364.

4. APPLICABLE MOLEX (1.5) POWER TERMINAL PART NUMBERS:
33012-0002 TIN 0.50-1.50mm²

5. CAM LEVER AND SPACER ARE SHIPPED IN THEIR PRE-ASSEMBLED POSITIONS.

OBsolete PART

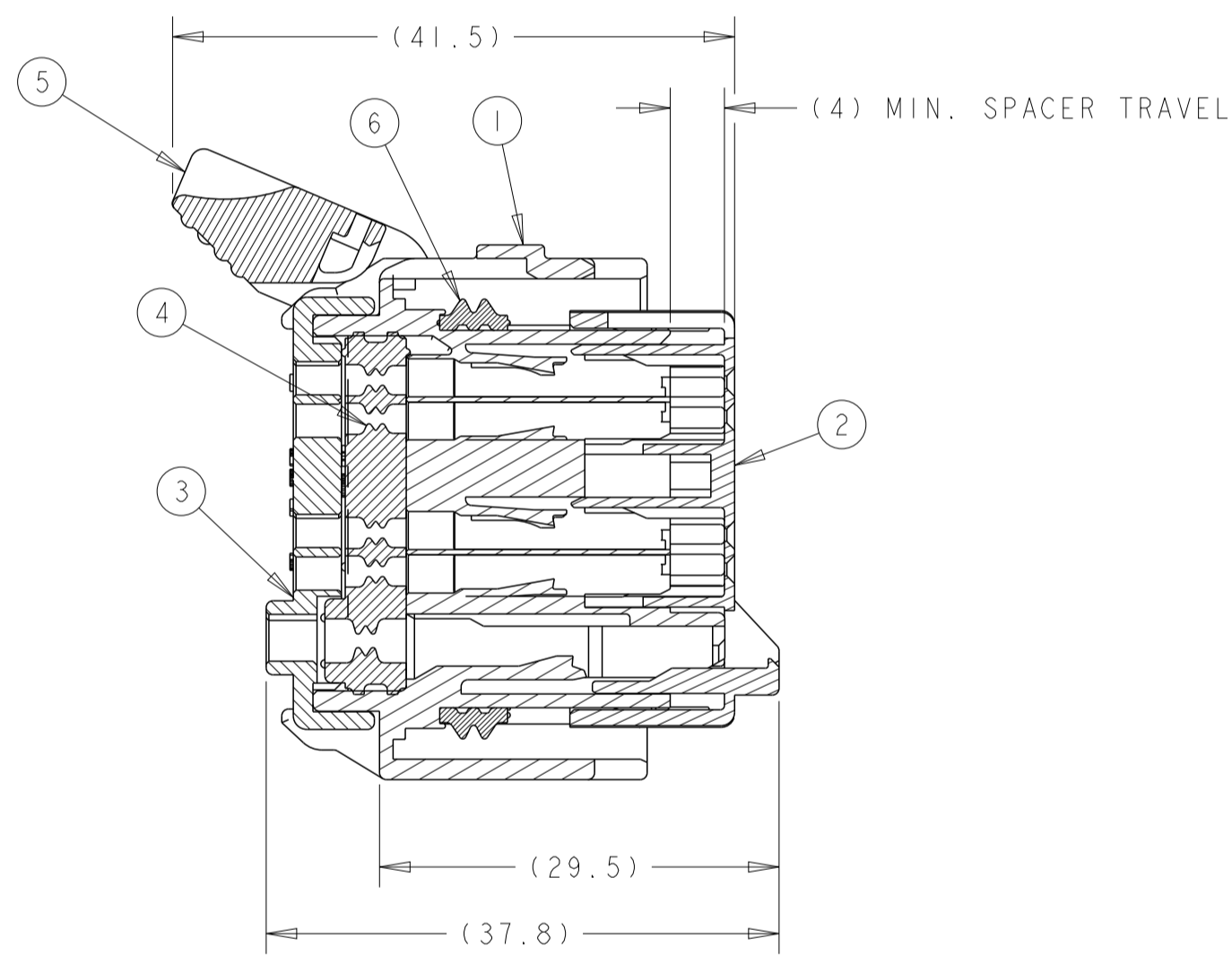

SECTION A-A
SPACER AND LEVER IN
PRE-SEATED POSITION
(DELIVERY CONDITION)

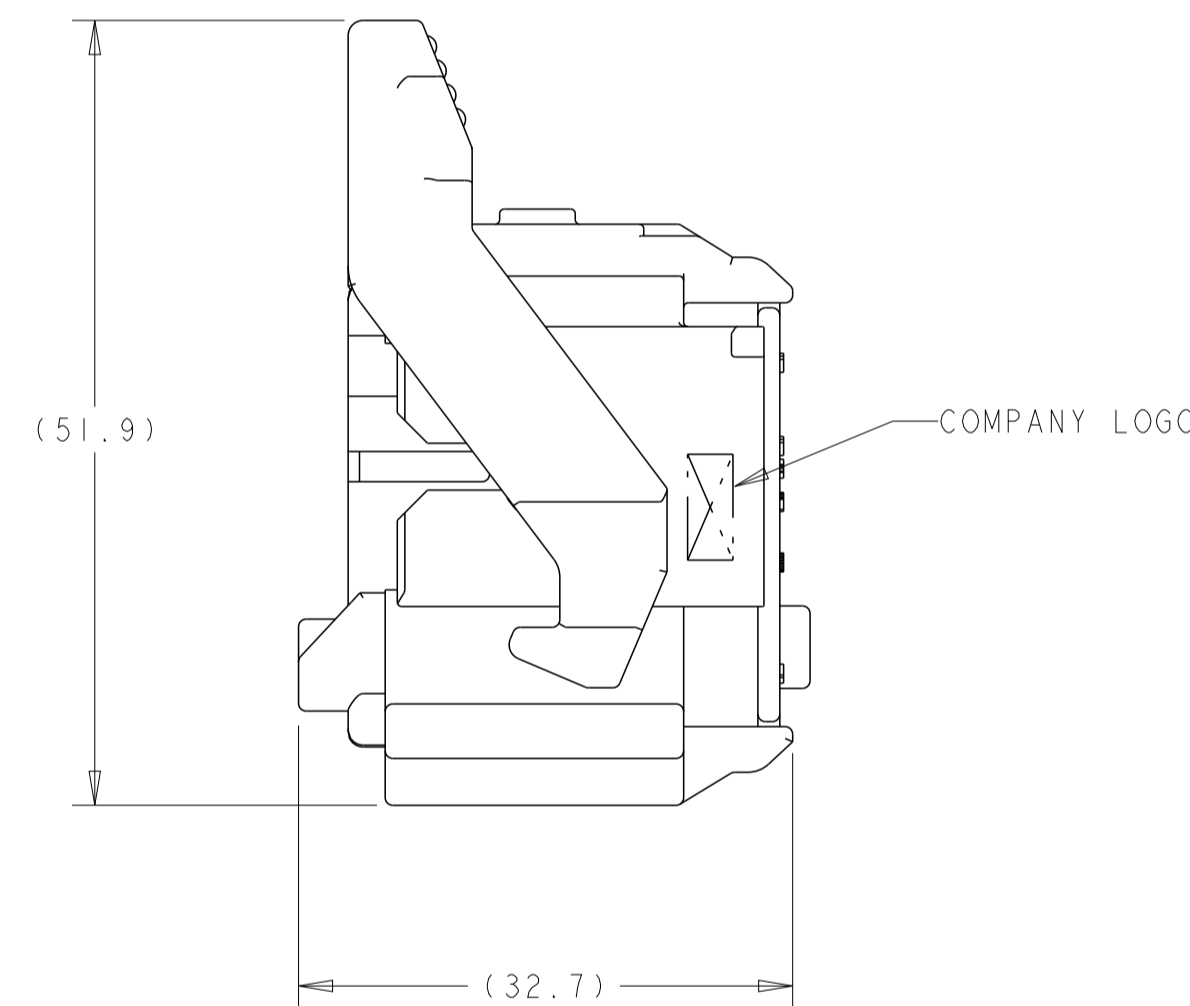
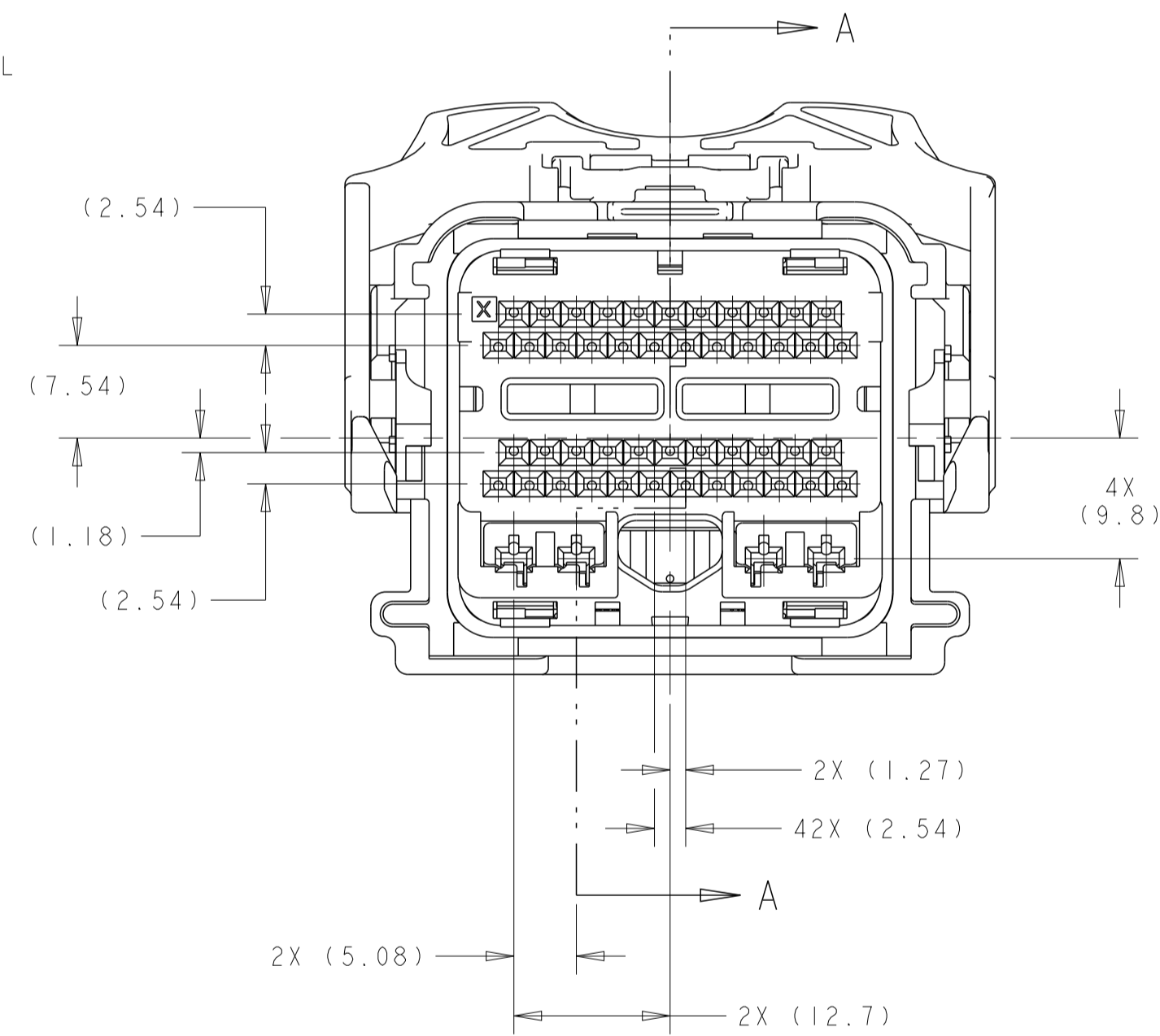

SHOWN WITH CAM
LEVER AND SPACER
IN LOADED POSITION

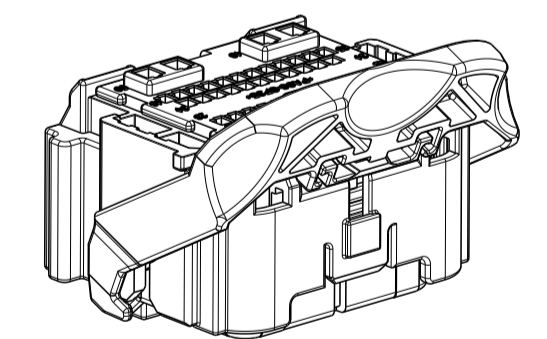
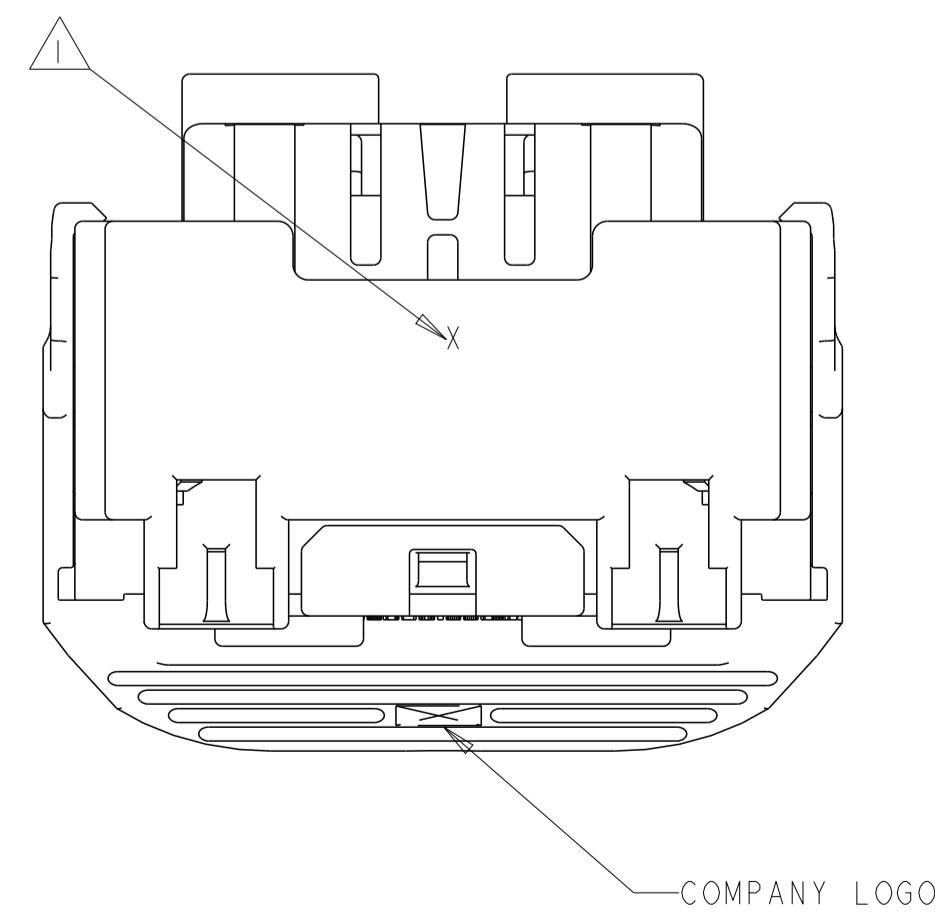

SCALE 1:1

PART COLOR	DESCRIPTION	ITEM NO.
GREEN	PERIMETER SEAL	6
GRAY	LEVER	5
BROWN	GROMMET SEAL	4
BLACK	COVER	3
NATURAL	SPACER	2
BLACK	HARNESS, KEY "C"	1

THIS DRAWING IS A CONTROLLED DOCUMENT.		DWN B. CRISAMORE 21 JUL 2004	NAME PCM 50-WAY HARNESS ASSEMBLY KEY C
DIMENSIONS:		CHK M. HITCHCOCK 21 JUL 2004	RESTRICTED TO
mm	TOLERANCES UNLESS OTHERWISE SPECIFIED:	APVD C. MARTIN 21 JUL 2004	SIZE A100779C=1438693
	0 PLC ±0.3	PRODUCT SPEC	SCALE 2:1
	2 PLC ±0.10	APPLICATION SPEC	SHEET 1 OF 4
	3 PLC ±0.10	WEIGHT	REV A12
	4 PLC ±0.10	CUSTOMER DRAWING	
MATERIAL	FINISH		

APPLICABLE HEADER INTERFACE SPECIFICATION SHOWN WITHOUT KEYING OPTIONS

REVISIONS				
REV	DATE	DESCRIPTION	APPV	CHK
-	-	SEE SHEET 1	-	-

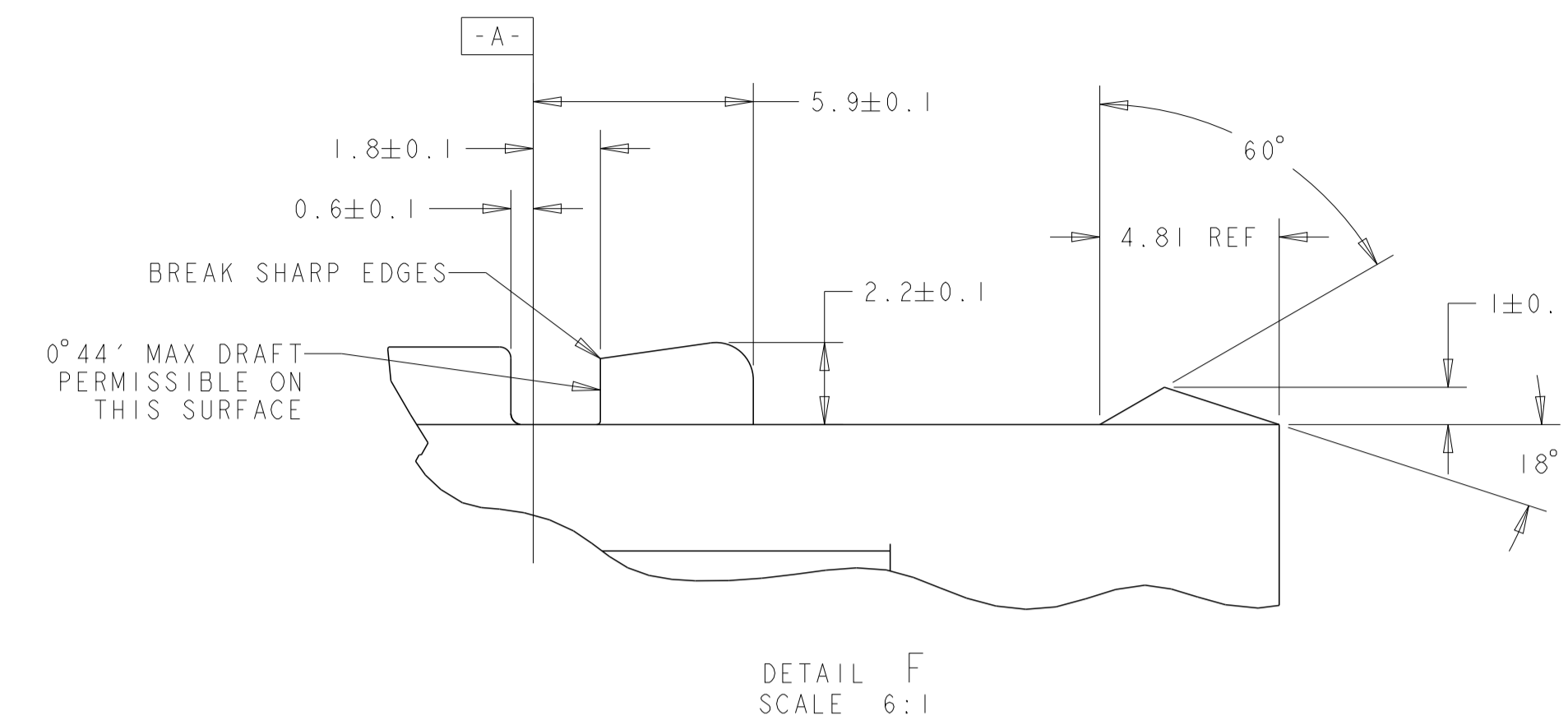

DETAIL F
SCALE 6:1

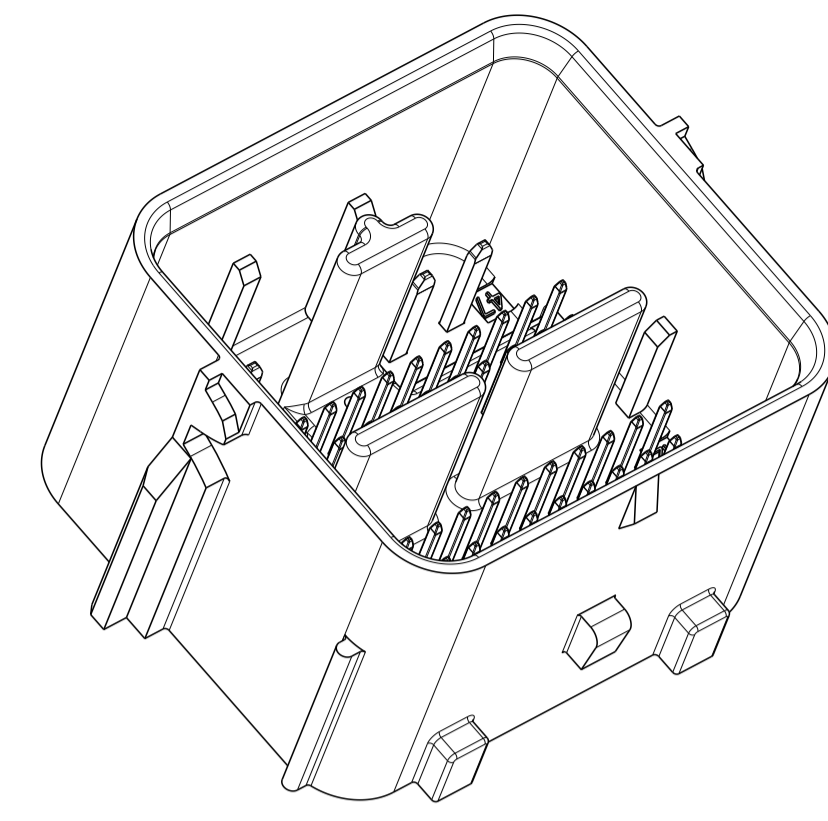
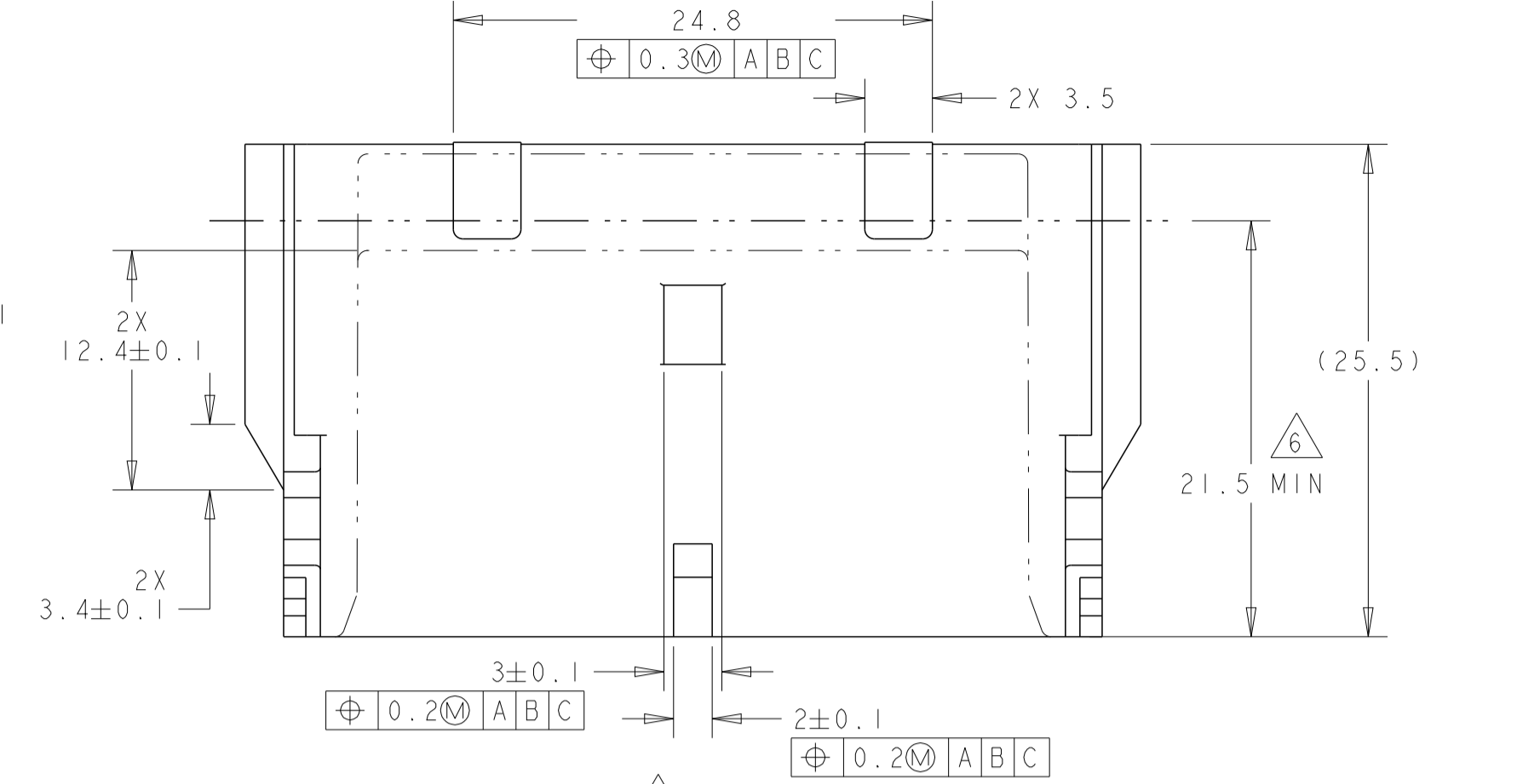

SCALE 2:1

- NOTES: UNLESS OTHERWISE SPECIFIED
1. GENERAL TOLERANCE:
±0.3 ALL ONE PLACE DIMENSIONS
±0.10 ALL TWO PLACE DIMENSIONS
±1°00' ALL ANGULAR DIMENSIONS
 2. DRAFT ANGLE PERMISSIBLE ONLY WITHIN DRAWING TOLERANCE.
 3. SEALING SURFACE, NO WITNESS LINES OR DAMAGE PERMITTED.
 4. ALL UNMARKED RADIII TO BE 0.5 MAX., UNLESS OTHERWISE SPECIFIED.
 5. VENT HOLE SIZE AND LOCATION IS OPTIONAL.
 6. THIS AREA TO REMAIN CLEAR FOR THE HARNESS ASSEMBLY.
 7. TERMINAL POSITION IDENTIFICATION.

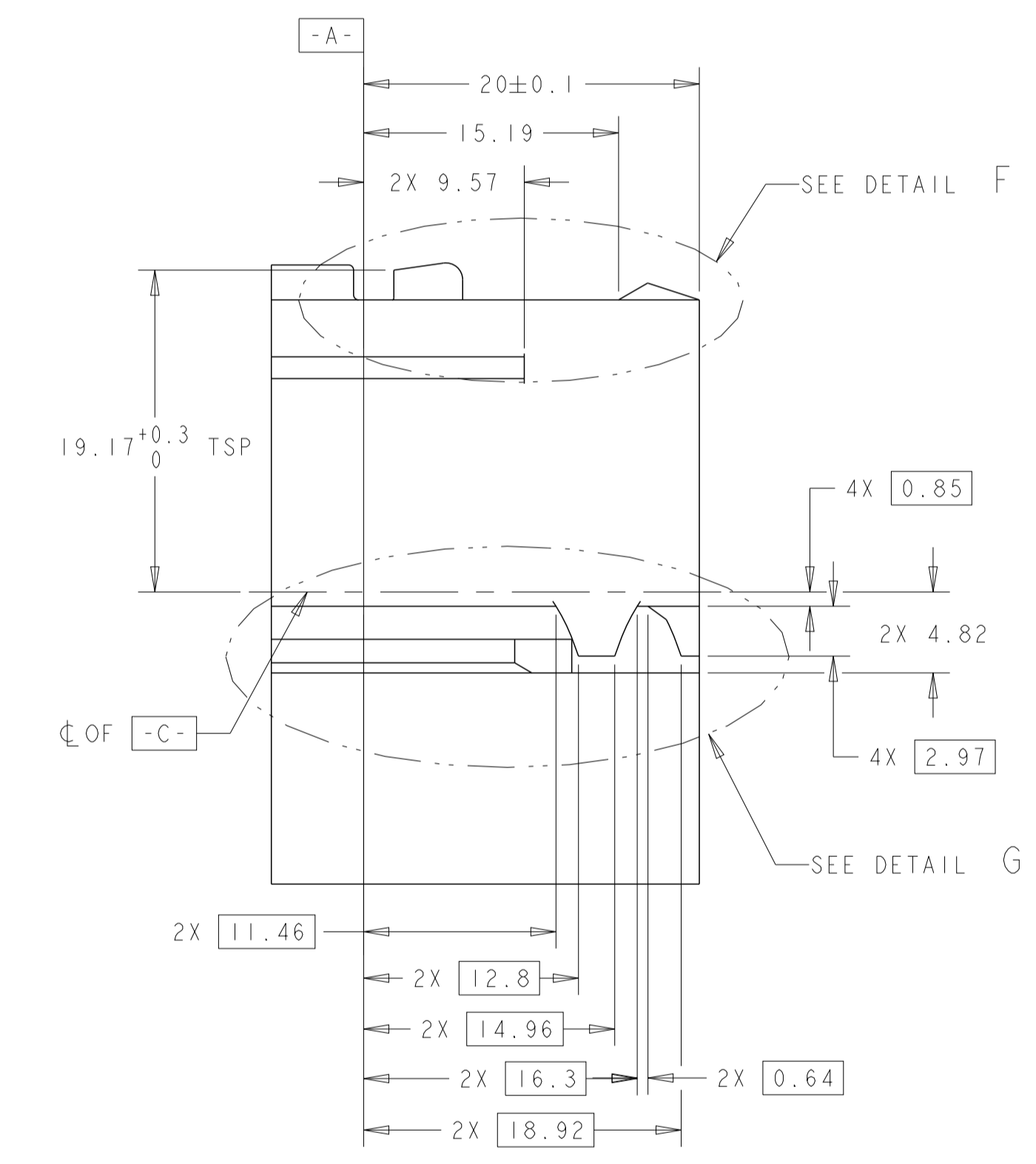

DETAIL G
SCALE 6:1
2 PLC

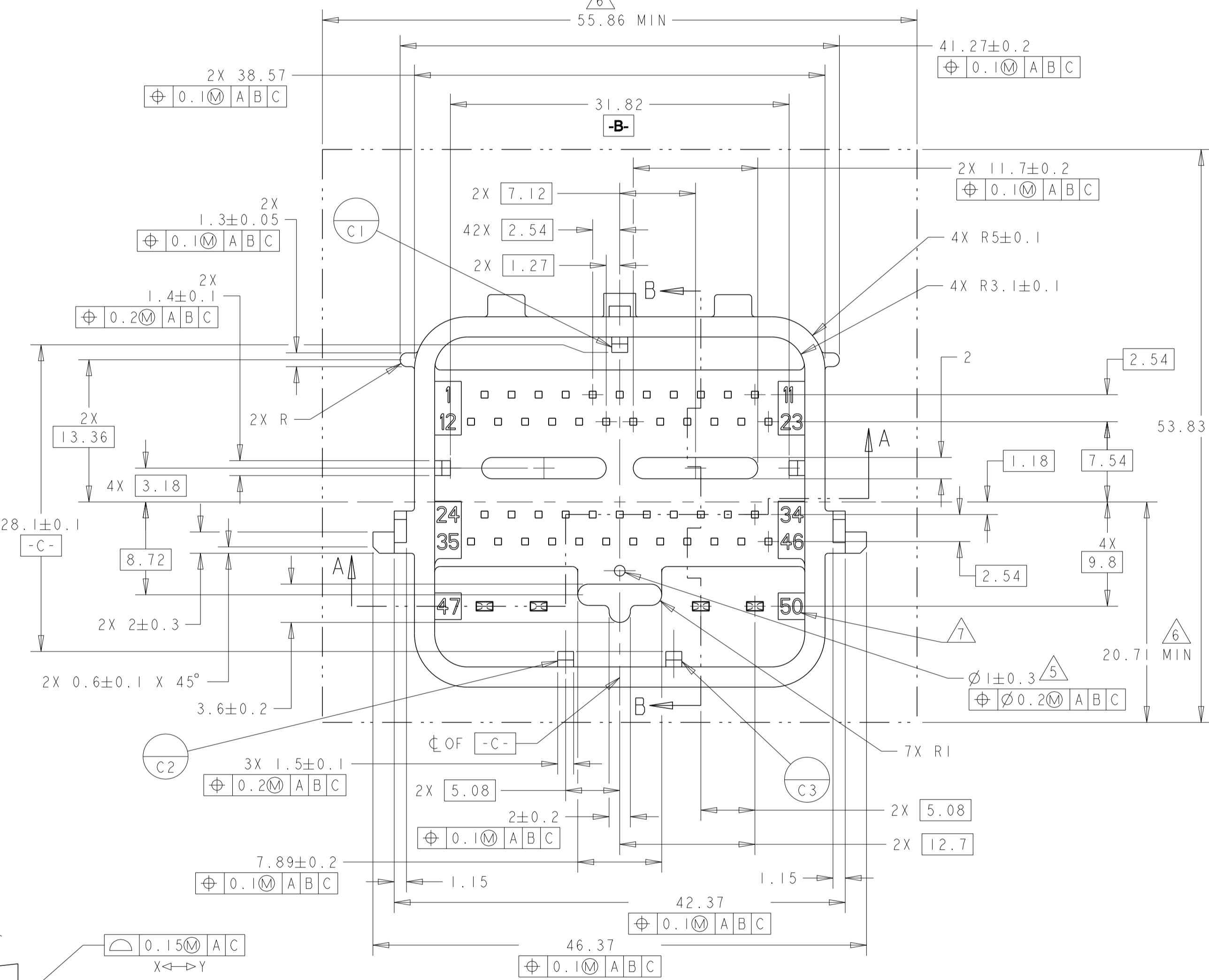

SECTION A-A

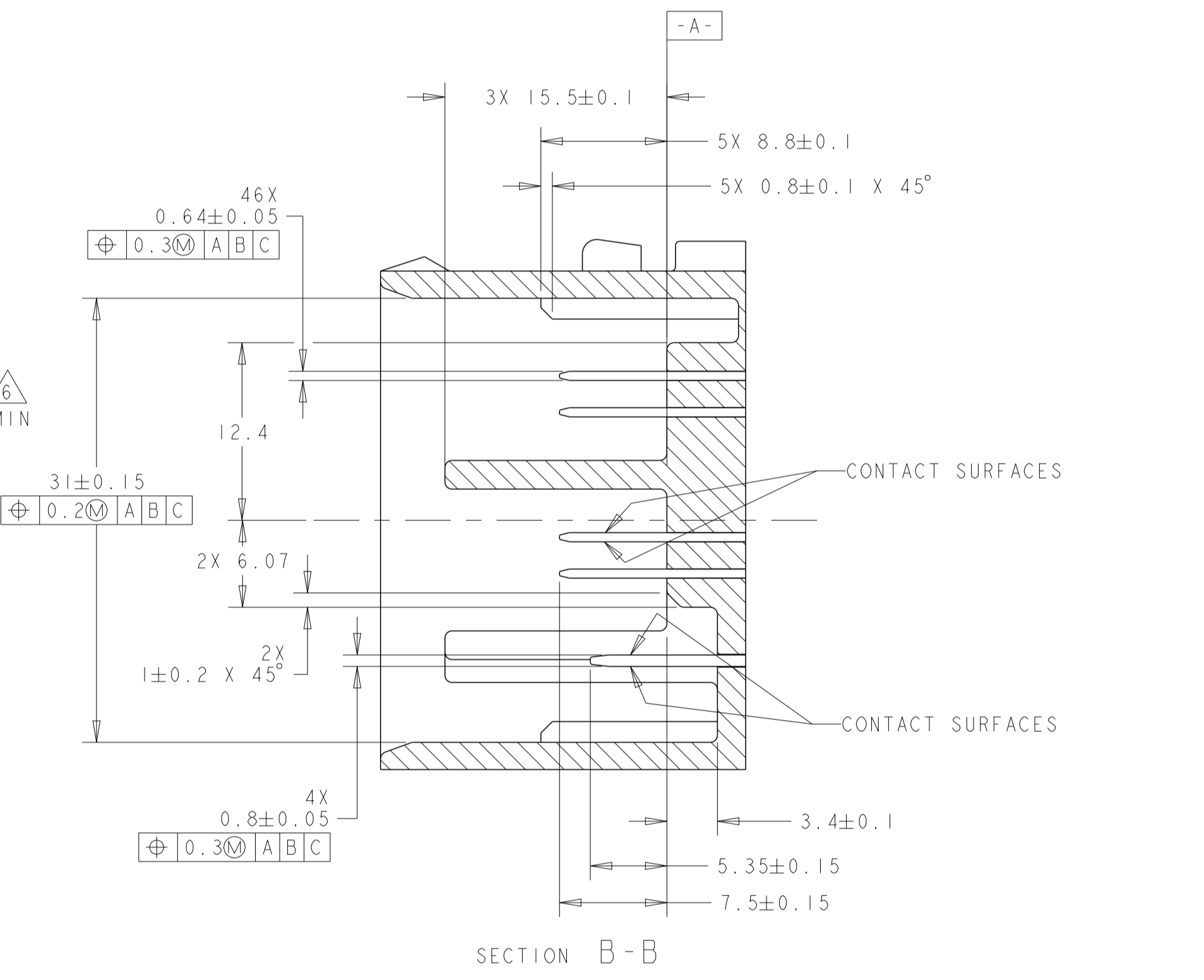

SECTION B-B

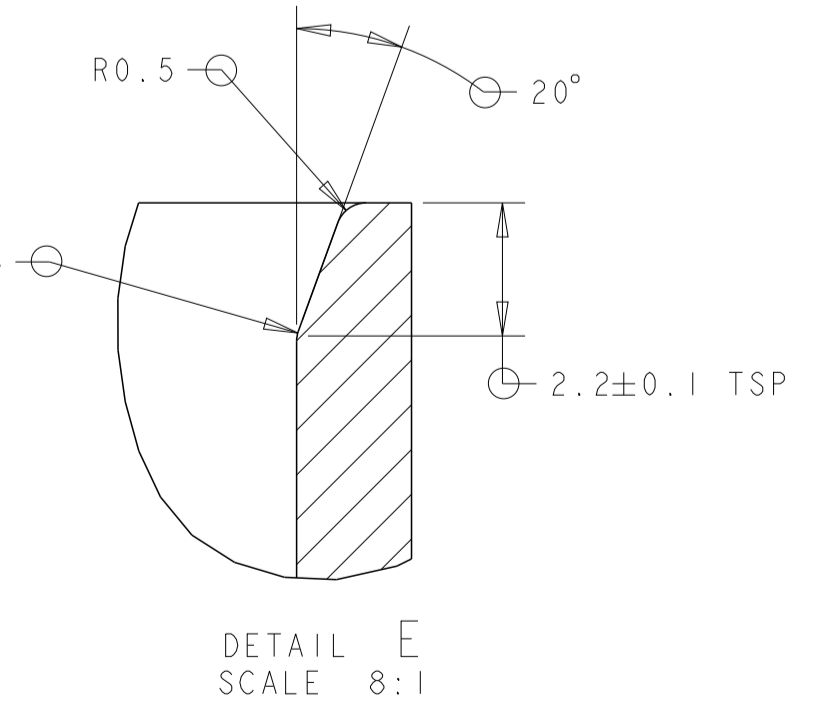

DETAIL E
SCALE 8:1

THIS DRAWING IS A CONTROLLED DOCUMENT.		OWN: B. CRISAMORE 21 JUL 2004	 TE Connectivity
		CHK: M. HITCHCOCK 21 JUL 2004	
		APPV: C. MARTIN 21 JUL 2004	
DIMENSIONS:		TOLERANCES UNLESS OTHERWISE SPECIFIED:	NAME: PCM
mm		0 PLC ±	PRODUCT SPEC
∅		1 PLC ±0.3	APPLICATION SPEC
H		2 PLC ±0.10	SIZE: CAGE CODE: DRAWING NO:
L		3 PLC ±	RESTRICTED TO:
S		4 PLC ±	A100779C=1438693
T		ANGLES ±	SCALE 2:1 SHEET 2 OF 4 REV 12
MATERIAL:		FINISH:	CUSTOMER DRAWING

REVISIONS				
P	LTN	DESCRIPTION	DATE	APVD
-		SEE SHEET 1	-	-

KEYING OPTION C			48	47	46	45	44	43					39	38	37	36	35			33	32	31	30	29			26					22	21	20	19	18					14	13	12			10	9			6	5			1	4-1438693-6		
			48	47	46	45	44	43					39	38	37	36	35			33	32	31	30	29			26					22	21	20	19	18					14	13	12			9	7	6	5			1	4-1438693-5				
			48	47	46	45	44	43	42	41			39	38	37	36	35			33	32	31	30	29			26					22	21	20	19	18					14	13	12			10	9	8	6	5	4			1	4-1438693-4		
			48	47	46	45	44	43	42	41			39	38	37	36	35			33	32	31	30	29			26					22	21	20	19	18					14	13	12			9	8	7	6	5	4			1	4-1438693-3		
			48	47	46	45	44	43	42	41			39	38	37	36	35			33	32	31	30	29	28			26					22	21	20	19	18					14	13	12			9	8	7	6	5	4	3			1	4-1438693-2
			48	47	46	45	44	43	42	41			39	38	37	36	35			33	32	31	30	29			26					22	21	20	19	18					14	13	12			9	8	7	6	5	4	3			1	4-1438693-1	
		49	48	47	46	45	44	43	42	41			39	38	37	36	35			33	32	31	30	29			26					22	21	20	19	18					14	13	12			10	9	8	6	5	4	3			1	4-1438693-0	
		49	48	47	46	45	44	43	42	41			39	38	37	36	35			33	32	31	30	29	28			26					22	21	20	19	18					14	13	12			10	9	8	6	5	4	3			1	3-1438693-9
			48	47	46	45	44	43	42			39	38	37	36	35			33	32			29	28			26					22	21	20	19	18					14	13	12			10	9	8	7	5	4	3			1	3-1438693-8	
			48	47	46	45	44	43	42			39	38	37	36	35			33	32			29	28			26	25	24	23	22	21	20	19	18					14	13	12			9	8	7	5	4	3			1	3-1438693-7			
CAVITIES WITH A NUMERIC SYMBOL INDICATES CLOSED TERMINAL LOCATIONS			48	47	46	45	44	43	42			39	38	37	36	35			33	32			29	28			26	25	24	23	22	21	20	19	18					14	13	12			9	8	7	5	4	3			1	3-1438693-6			
			48	47	46	45	44	43	42	41			39	38	37	36	35			33	32	31	30	29	28			26	25	24	23	22	21	20	19	18					14	13	12			10	9	8	7	5	4	3			1	3-1438693-5	
BLANK CAVITIES INDICATES OPEN TERMINAL HOLE LOCATIONS			48		46	45	44		42		40	39	38	37	36	35	34	33	32	31	30	29	28	27	26	25	24	23		21	20	19	18			15	14			11		9	7	6	5	4	3			1	3-1438693-4						
		48			45	44	43	42	41			39	38	37	36	35			33	32	31	30	29	28			26	25	24	23	22	21	20	19	18					14	13	12			10	9	8		5	4	3			1	3-1438693-3		
TERMINAL HOLE POSITION	50	49	48	47	46	45	44	43	42	41	40	39	38	37	36	35	34	33	32	31	30	29	28	27	26	25	24	23	22	21	20	19	18	17	16	15	14	13	12	11	10	9	8	7	6	5	4	3	2	1		ASSEMBLY PART NUMBER					

PIN-OUT CHART

THIS DRAWING IS A CONTROLLED DOCUMENT.		DWN B. CRISAMORE 21 JUL 2004 CHK M. HITCHCOCK 21 JUL 2004 APVD C. MARTIN 21 JUL 2004	
DIMENSIONS: mm 	TOLERANCES UNLESS OTHERWISE SPECIFIED: 0 PLC ±0.3 1 PLC ±0.3 2 PLC ±0.10 3 PLC ±0.10 4 PLC ±0.10 ANGLES ±1° FINISH	NAME PCM PRODUCT SPEC 50-WAY HARNESS ASSEMBLY APPLICATION SPEC KEY C	SIZE A1 CAGE CODE 00779 DRAWING NO. 1438693
MATERIAL		WEIGHT	SCALE 2:1
CUSTOMER DRAWING		SHEET 4 OF 4	REV A12

单击下面可查看定价，库存，交付和生命周期等信息

[>>TE Connectivity\(泰科\)](#)