

THIS DRAWING IS UNPUBLISHED. RELEASED FOR PUBLICATION
 © COPYRIGHT 2017 TE Connectivity ALL RIGHTS RESERVED.

REVISIONS					
P	LTR	DESCRIPTION	DATE	DWN	APVD
A		RELEASE TO PRODUCTION	02APR2020	AY	PS
A1		34 POSITION ADDED	11MAR2021	AY	PS

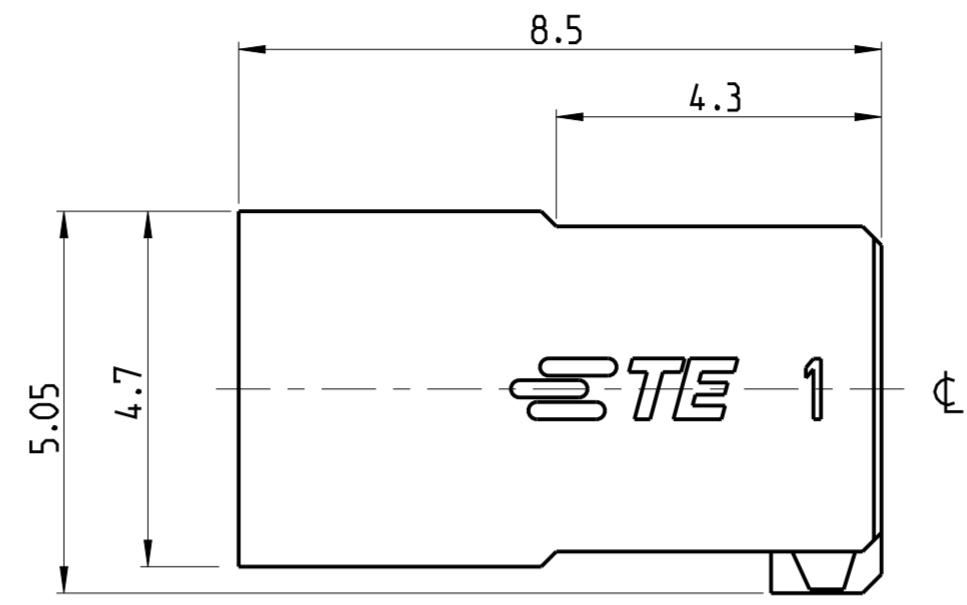
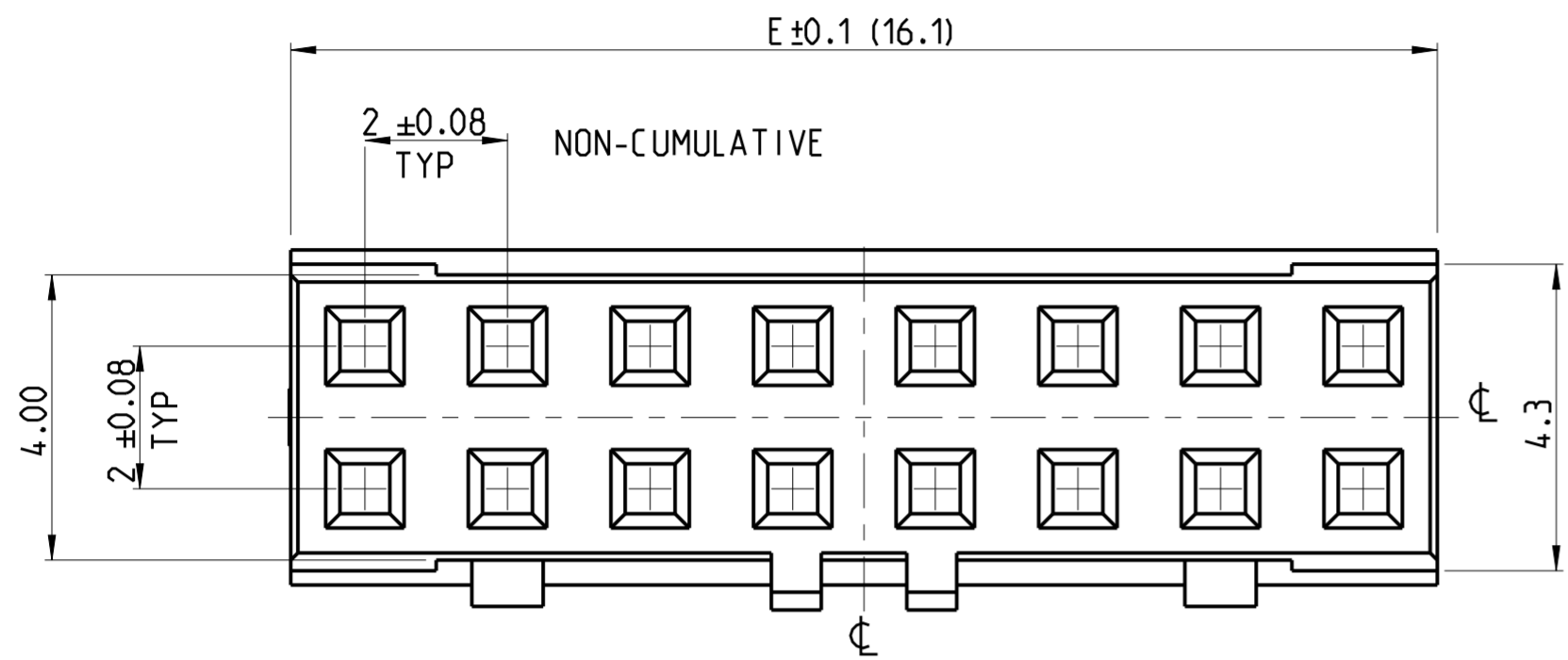

NOTES:

- MATERIAL:
LCP BLACK, UL94 V0
- N = NUMBER OF POSITION PER HOUSING.
- HOUSING TO BE USED WITH CRIMP CONTACTS
2316113 (AWG 28-24/0.08-0.22 mm²) AND
2316114 (AWG 30-28/0.05-0.08 mm²)
- PACKAGING : BULK BOX

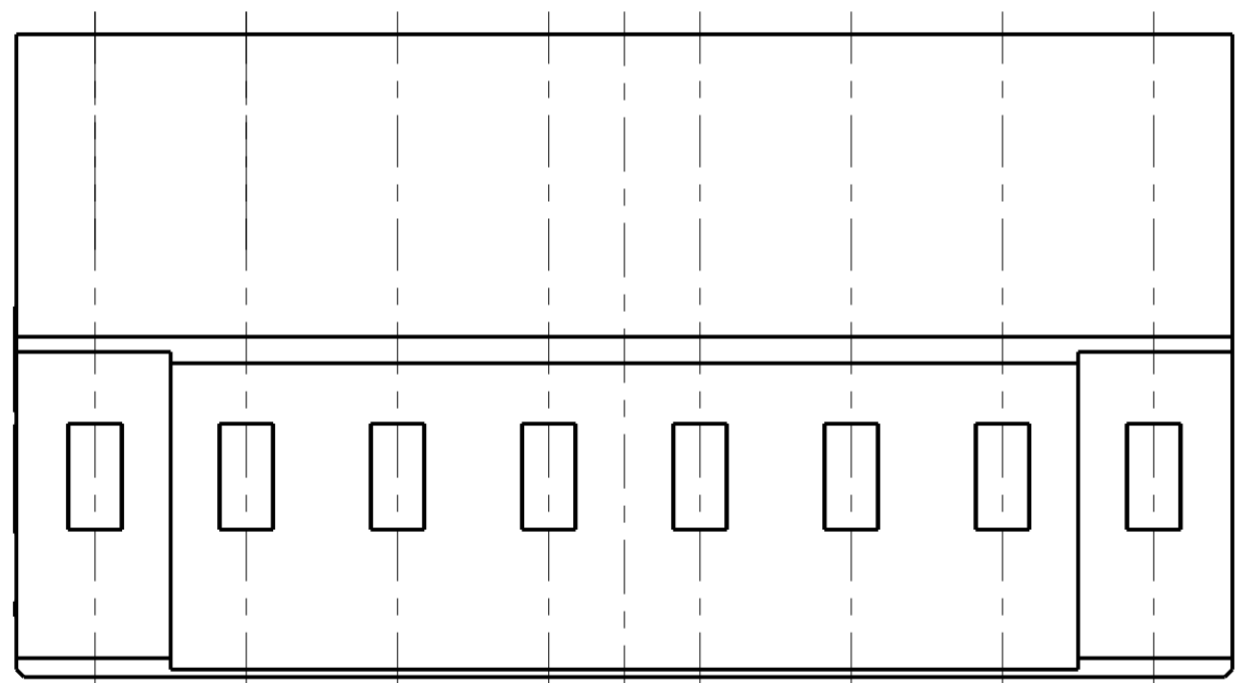

DUAL ROW HOUSING
 POLARIZED W/ LOCKING RAMP.
 1- -6 AS SHOWN

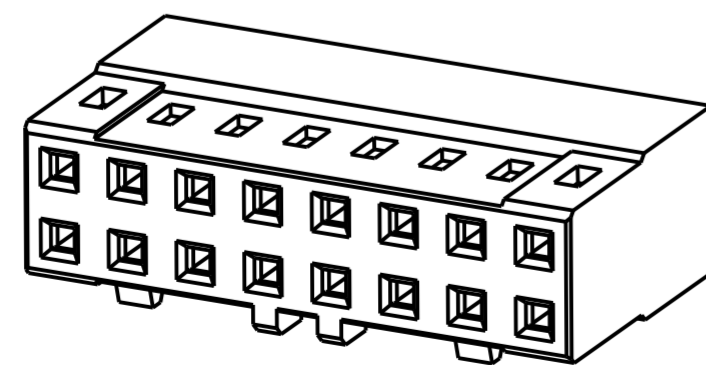

SCALE 5:1

CENTER LINE FOR ODD AND EVEN
 POSITION HOUSINGS

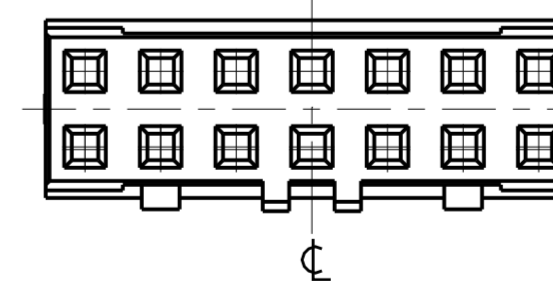
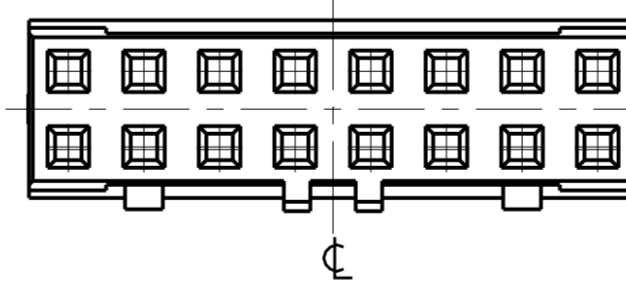

SCALE 5:1

BOX PACKAGING		
5-2316109-0	50.1	50
4-2316109-4	44.1	44
4-2316109-0	40.1	40
3-2316109-4	34.1	34
3-2316109-2	32.1	32
3-2316109-0	30.1	30
2-2316109-8	28.1	28
2-2316109-6	26.1	26
2-2316109-4	24.1	24
2-2316109-2	22.1	22
2-2316109-0	20.1	20
1-2316109-8	18.1	18
1-2316109-6	16.1	16
1-2316109-4	14.1	14
PART NO.	DIM "E"	N

THIS DRAWING IS A CONTROLLED DOCUMENT.

DIMENSIONS: mm	TOLERANCES UNLESS OTHERWISE SPECIFIED:
0 PLC	±
1 PLC	±0.15
2 PLC	±0.10
3 PLC	±
4 PLC	±
ANGLES	±2°
FINISH	-
MATERIAL	SEE NOTE 1

DWN	06SEP2016
CHK	06SEP2016
APVD	06SEP2016
PRODUCT SPEC	108-64040-1
APPLICATION SPEC	114-32173
WEIGHT	-
CUSTOMER DRAWING	

		TE Connectivity	
NAME AMPMODU 2mm RECEPTACLE, w/B HOUSING, CRIMP, DR. W/ LOCK RAMP			
SIZE	CAGE CODE	DRAWING NO	RESTRICTED TO
A2	00779	C-2316109	-
SCALE 10:1		SHEET 1 OF 1	REV A1

单击下面可查看定价，库存，交付和生命周期等信息

[>>TE Connectivity\(泰科\)](#)