

THIS DRAWING IS UNPUBLISHED. RELEASED FOR PUBLICATION BY TYCO ELECTRONICS CORPORATION. ALL RIGHTS RESERVED.

LOC	DIST	REVISONS	DATE	UN	APPD
CM	O	DESCRIPTION	21JUN07	KW	DB
FP	LINK	ECC-07-012881			
R					

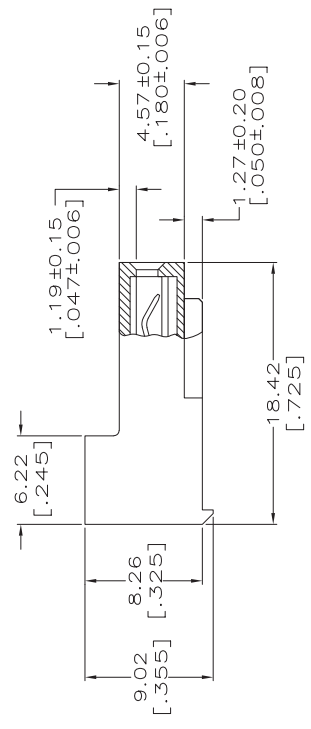
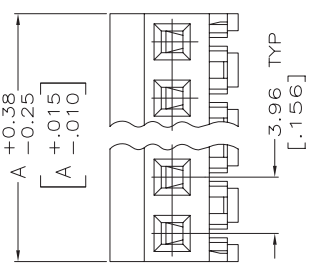
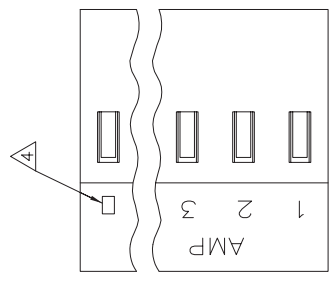

2. CONTACTS ACCEPT 22 AWG WIRE WITH 2.41[0.095] MAX INSULATION DIAMETER.
3. CONTACTS MUST ACCEPT 1.14±0.03[0.045±0.01] SQUARE POST AND REMAIN LOCKED IN POSITION.
4. IDENTIFICATION NUMBER FOR LAST CIRCUIT MAY NOT APPEAR ON ALL ASSEMBLIES.
5. DIMENSIONS IN BRACKETS ARE IN INCHES.
6. HOUSING FEATURES ARE: CLOSED END WITHOUT LOCKING RAMP.

7. CONTACTS ACCEPT 22 AWG WIRE WITH 2.41[0.095] MAX INSULATION DIAMETER.
8. CONTACTS MUST ACCEPT 1.14±0.03[0.045±0.01] SQUARE POST AND REMAIN LOCKED IN POSITION.
9. IDENTIFICATION NUMBER FOR LAST CIRCUIT MAY NOT APPEAR ON ALL ASSEMBLIES.
10. DIMENSIONS IN BRACKETS ARE IN INCHES.
11. HOUSING FEATURES ARE: CLOSED END WITHOUT LOCKING RAMP.

NO.	REV.	DESCRIPTION	DATE	UN	APPD
95.10	3.744		5-641155-4		
91.14	3.588		5-641155-3		
87.17	3.432		5-641155-2		
83.21	3.276		5-641155-1		
79.25	3.120		5-641155-0		
75.29	2.964		4-641155-9		
71.32	2.808		4-641155-8		
67.36	2.652		4-641155-7		
63.40	2.496		4-641155-6		
59.44	2.340		4-641155-5		
55.47	2.184		4-641155-4		
51.51	2.028		4-641155-3		
47.55	1.872		4-641155-2		
43.59	1.716		4-641155-1		
39.62	1.560		4-641155-0		
35.66	1.404		3-641155-9		
31.70	1.248		3-641155-8		
27.74	1.092		3-641155-7		
23.77	0.936		3-641155-6		
19.81	0.780		3-641155-5		
15.85	0.624		3-641155-4		
11.89	0.468		3-641155-3		
7.92	0.312		3-641155-2		
95.10	3.744		2-641155-4		
91.14	3.588		2-641155-3		
87.17	3.432		2-641155-2		
83.21	3.276		2-641155-1		
79.25	3.120		2-641155-0		
75.29	2.964		1-641155-9		
71.32	2.808		1-641155-8		
67.36	2.652		1-641155-7		
63.40	2.496		1-641155-6		
59.44	2.340		1-641155-5		
55.47	2.184		1-641155-4		
51.51	2.028		1-641155-3		
47.55	1.872		1-641155-2		
43.59	1.716		1-641155-1		
39.62	1.560		1-641155-0		
35.66	1.404		641155-9		
31.70	1.248		641155-8		
27.74	1.092		641155-7		
23.77	0.936		641155-6		
19.81	0.780		641155-5		
15.85	0.624		641155-4		
11.89	0.468		641155-3		
7.92	0.312		641155-2		

THIS DRAWING IS A CONTROLLED DOCUMENT.	REV	DATE	BY
	B. LEWIS	2-12-91	
	OK	2-12-91	
	SWING		
	APPRO		
	NAME		
	PRODUCT SPEC		
	APPLICATION SPEC	108-1051	
	APPLICATION SPEC	114-1020	
	WEIGHT		
	FINISH		
	MATERIAL		
	CONTRACT FINISH	DIM A	
	NO. OF CIRCUITS		
	PART NO.		
	TYCO ELECTRONICS		
	TYCO ELECTRONICS CORPORATION		
	HARRISBURG, PA 17105-3608		
	MTA-156 CONNECTOR ASSEMBLY,		
	22 AWG, STANDARD		
	SIZE		
	DATE CODE		
	DRAWING NO		
	RESTRICTED TO		
	AZ 00779	641155	
	SCALE	4:1	
	SHEET	1 OF 1	
	REV		



单击下面可查看定价，库存，交付和生命周期等信息

[>>TE Connectivity\(泰科\)](#)