

Thermofit<sup>®</sup> Molded Parts  
 Specification Control Drawing  
 Limited Distribution

Part Number : 101A073-X-04  
 Description : Cap, Round End

NOTES

- All dimensions are in  $\frac{\text{inches}}{[\text{millimeters}]}$
- Dimensions appearing in table are as follows:
  - a - As Supplied
  - b - After Unrestricted Recovery
- Coating is optional. As supplied dimensions appearing in table are for uncoated parts. When coating is added, entry diameters will be reduced by .06 max.
- Recovered parts may have angularity of 30° - 45°.

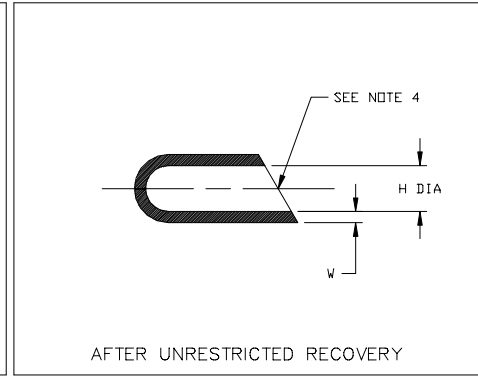
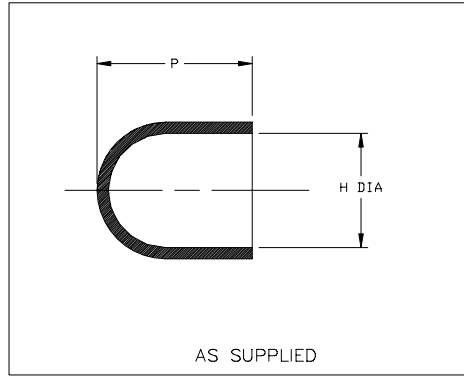

| PART NUMBER  | H              |               | P              | W             |
|--------------|----------------|---------------|----------------|---------------|
|              | Min            | Max           | ±10%           | ±20%          |
|              | a              | b             | a              | b             |
| 101A073-X-04 | 1.55<br>[39,4] | .71<br>[18,0] | 2.30<br>[58,4] | .10<br>[25,4] |

**Raychem**

RAYCHEM CORPORATION  
 300 CONSTITUTION DRIVE  
 MENLO PARK, CALIFORNIA 94025

Revision : A  
 Date : 10/16/96

Part Number : 101A073-X-04  
 Description : Cap, Round End

Thermofit<sup>®</sup> Molded Parts  
 Specification Control Drawing  
 Limited Distribution

Part Number : 101A073-X-04  
 Description : Cap, Round End

| MATERIAL DASH NO. | MATERIAL DESCRIPTION   | RT SPEC | COATING SLASH NO. | COATING S NO. | COATING DESCRIPTION |
|-------------------|------------------------|---------|-------------------|---------------|---------------------|
| -3                | Polyolefin, Semi-Rigid | RT-301  |                   |               |                     |
|                   |                        |         |                   |               |                     |
|                   |                        |         |                   |               |                     |
|                   |                        |         |                   |               |                     |
|                   |                        |         |                   |               |                     |

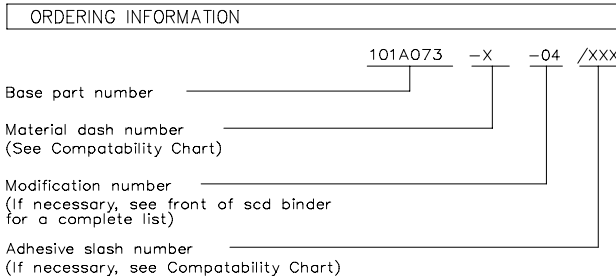

THIS DRAWING IS SUBJECT TO CHANGE WITHOUT NOTICE; CONSULT YOUR  
 NEAREST FIELD REPRESENTATIVE FOR CURRENT REVISION

**Raychem**

RAYCHEM CORPORATION  
 300 CONSTITUTION DRIVE  
 MENLO PARK, CALIFORNIA 94025

Revision : A  
 Date : 10/16/96

Part Number : 101A073-X-04  
 Description : Cap, Round End

CAD FILE MP96579

单击下面可查看定价，库存，交付和生命周期等信息

[>>TE Connectivity\(泰科\)](#)