

THIS DRAWING IS UNPUBLISHED. RELEASED FOR PUBLICATION MAR, 2011.
 © COPYRIGHT 2011 By Tyco Electronics Japan G.K. ALL RIGHTS RESERVED.

LOC	DIST	REVISONS		
J	-	P	LTR	DESCRIPTION
		C	REVISED	DATE DWN APVD
				08DEC2014 J.W C.W

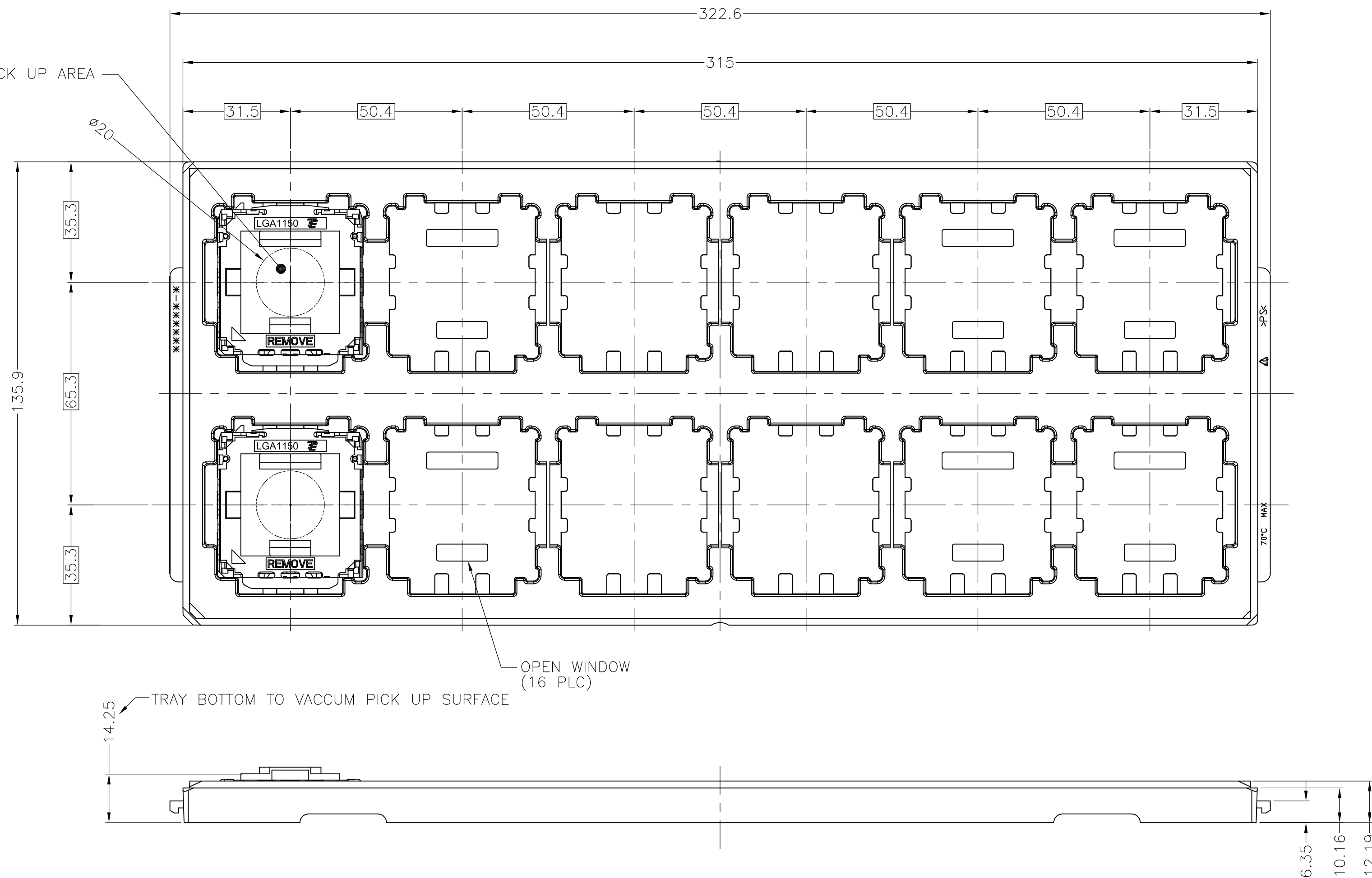

- NOTES:
- MATERIAL
 - HOUSING : HIGH TEMP, THERMO-PLASTIC, UL94V-0, BLACK
 - CONTACT : COPPER ALLOY
FINISH : Au PL. AT CONTACT AREA ON OVERALL OVER Ni UNDER PL. 0.00127 MIN.
 - SOLDER BALL : Sn/Ag/Cu
 - CAP : HIGH TEMP. THERMO-PLASTIC, UL94V-0, BLACK
 - INDICATED DATE CODE ON THE HSG

2134928-1,-2,-3: AS SHOWN

2134928-3	0.76 um MIN Au PL
2134928-2	0.10 um MIN Au PL
2134928-1	0.38 um MIN Au PL
PART NUMBER	DESCRIPTION

THIS DRAWING IS A CONTROLLED DOCUMENT.		DWN	RICK.ZHAO	04JUL2013		TE Connectivity		
DIMENSIONS: 单位: 毫米 mm		CHK	H.TAGUCHI	04JUL2013		NAME SOCKET ASSY LGA1150	RESTRICTED TO	
TOLERANCES UNLESS OTHERWISE SPECIFIED: 一般公差		APVD	T.NAKASHIMA	07JUL2013			SIZE	CAGE CODE
0-PLC ± ±0.5 1-PLC ± ±0.5 2-PLC ± ±3° 3-PLC ± ± 4-PLC ± ± ANGLES ± ±		PRODUCT SPEC	108-78586		A2	00779	C=2134928	
MATERIAL 材料		APPLICATION SPEC	114-5444		WEIGHT	9.8g		
FINISH 仕上		CUSTOMER DRAWING		SCALE	1:1		SHEET	1 of 6
				REV	C			

THIS DRAWING IS UNPUBLISHED. RELEASED FOR PUBLICATION MAR , 2011.
 © COPYRIGHT 2011 By Tyco Electronics Japan G.K. ALL RIGHTS RESERVED.

LOC	DIST	REVISIONS					
J	-	P	LTR	DESCRIPTION	DATE	DWN	APVD
		-	-	SEE SHEET 1	-	-	-

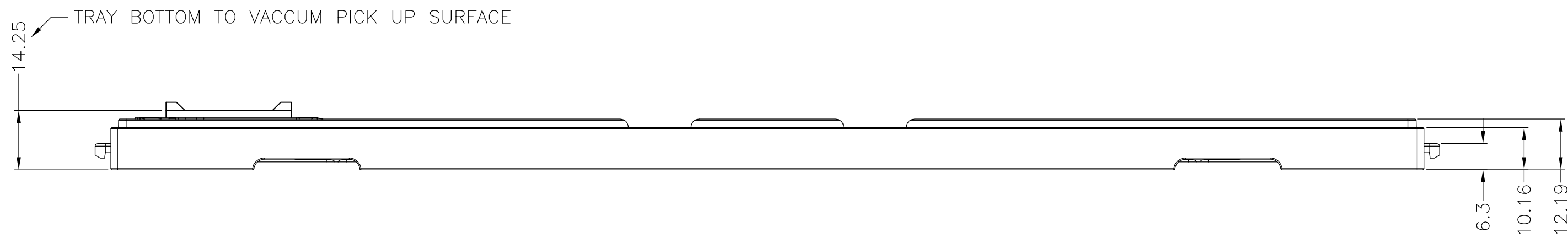
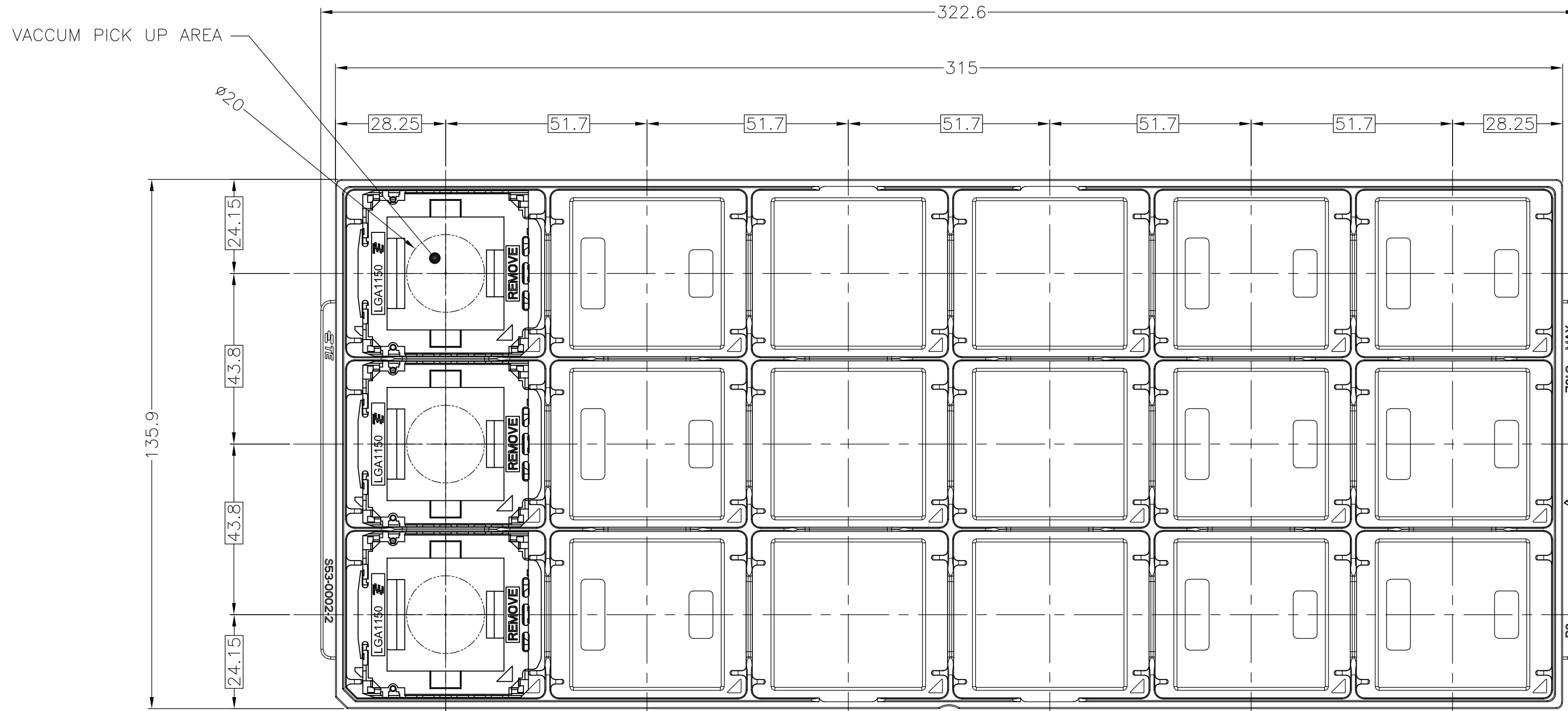

1-2134928-3	0.76 um MIN Au PL
1-2134928-2	0.10 um MIN Au PL
1-2134928-1	0.38 um MIN Au PL
PART NUMBER	DESCRIPTION

1-2134928-1,-2,-3: AS SHOWN

THIS DRAWING IS A CONTROLLED DOCUMENT.		DWN	TE Connectivity	
DIMENSIONS: 单位: 毫米 mm		CHK	NAME 名称	
TOLERANCES UNLESS OTHERWISE SPECIFIED: 一般公差		APVD	SOCKET ASSY LGA1150	
0 PLG ± ±0.5 1 PLG ± ±0.5 2 PLG ± ±3° 3 PLG ± ±0.5 4 PLG ± ±0.5 ANGLES ± ±0.5 FINISH 仕上		PRODUCT SPEC 製品規格	SIZE A2	CAGE CODE 00779
MATERIAL 材料		APPLICATION SPEC 取付適用規格	DRAWING NO 番号 C=2134928	RESTRICTED TO -
		WEIGHT -	SCALE 尺度 1:1	SHEET 2 of 6
		CUSTOMER DRAWING	REV C	

2134928

THIS DRAWING IS UNPUBLISHED. RELEASED FOR PUBLICATION
 © COPYRIGHT - By Tyco Electronics Japan G.K. ALL RIGHTS RESERVED.

LOC		DIST		REVISIONS			
P	LTR	DESCRIPTION		DATE	DWN	APVD	
-	-	SEE SHEET 1		-	-	-	

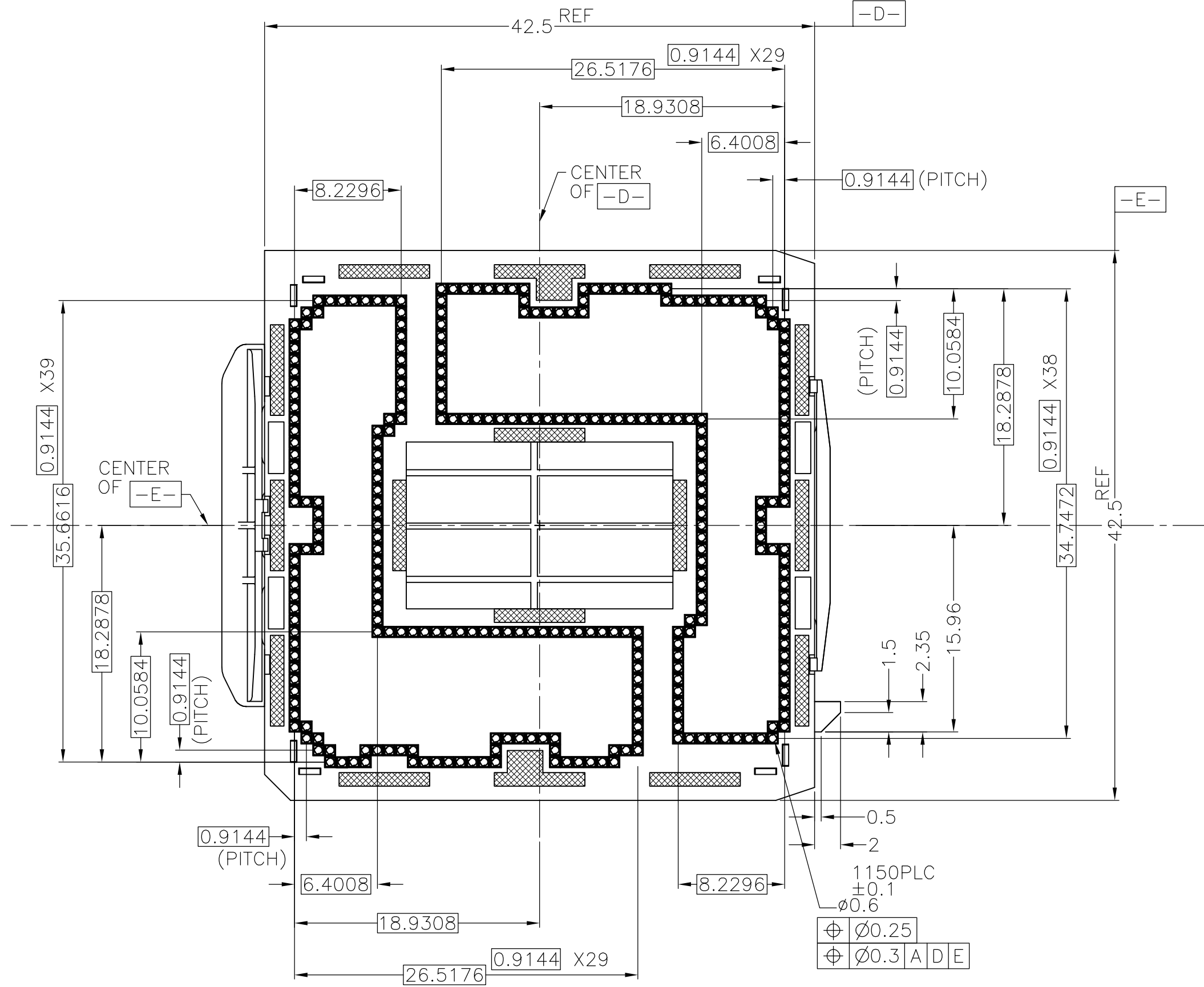
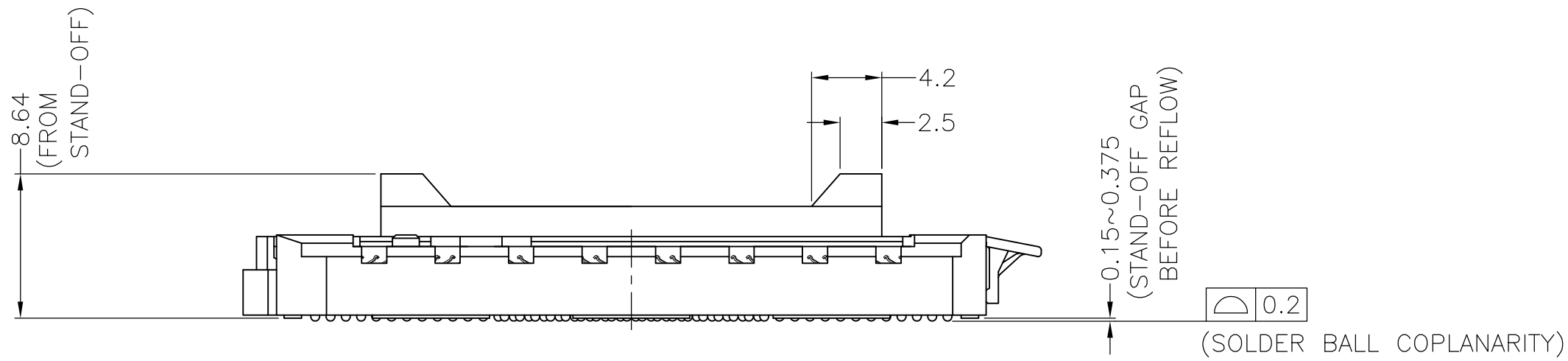
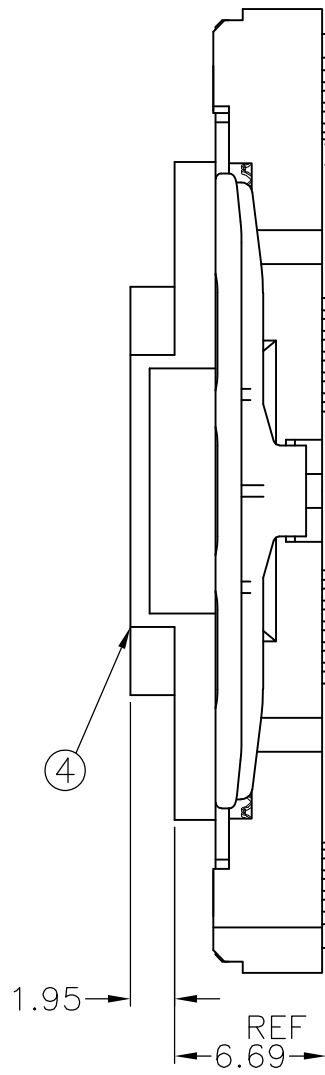
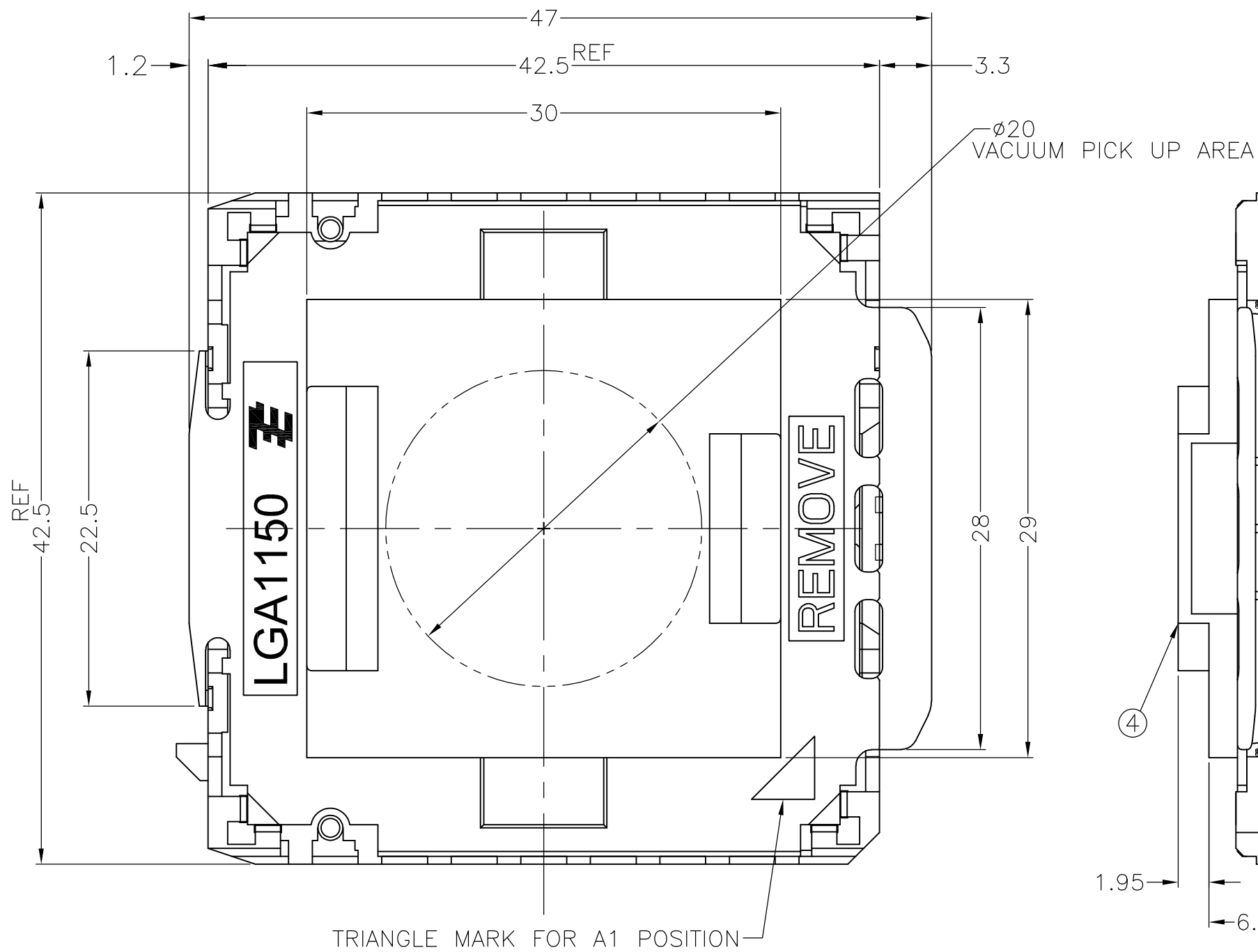
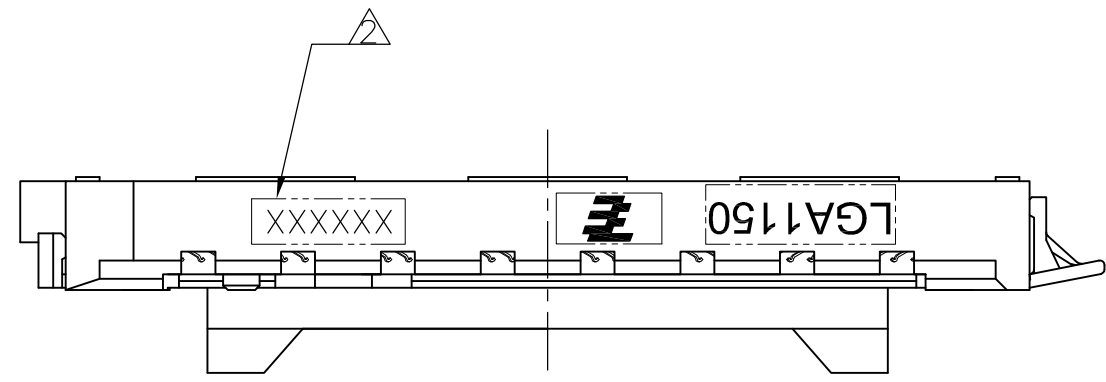

2134928-*, 1-2134928-*: AS SHOWN

THIS DRAWING IS A CONTROLLED DOCUMENT.		DWN	TE Connectivity	
DIMENSIONS: 单位: 毫米 mm		CHK	SOCKET ASSY LGA1150	
TOLERANCES UNLESS OTHERWISE SPECIFIED: 一般公差		APVD	SIZE	RESTRICTED TO
φ PLG ± ±0.3		PRODUCT SPEC	A2	-
+ PLG ± ±0.3		APPLICATION SPEC	CAGE CODE	CAGE CODE
- PLG ± ±0.3		取付適用規格	00779	00779
FINISH 仕上		WEIGHT	DRAWING NO	REV
			C=2134928	C
		CUSTOMER DRAWING	SCALE	SHEET
			NTS	3 OF 6

THIS DRAWING IS UNPUBLISHED. RELEASED FOR PUBLICATION
 © COPYRIGHT - By Tyco Electronics Japan G.K. ALL RIGHTS RESERVED.

LOC		DIST		REVISONS			DATE	DWN	APVD
		P	LTR	我輩 DESCRIPTION					
		SEE SHEET 1							

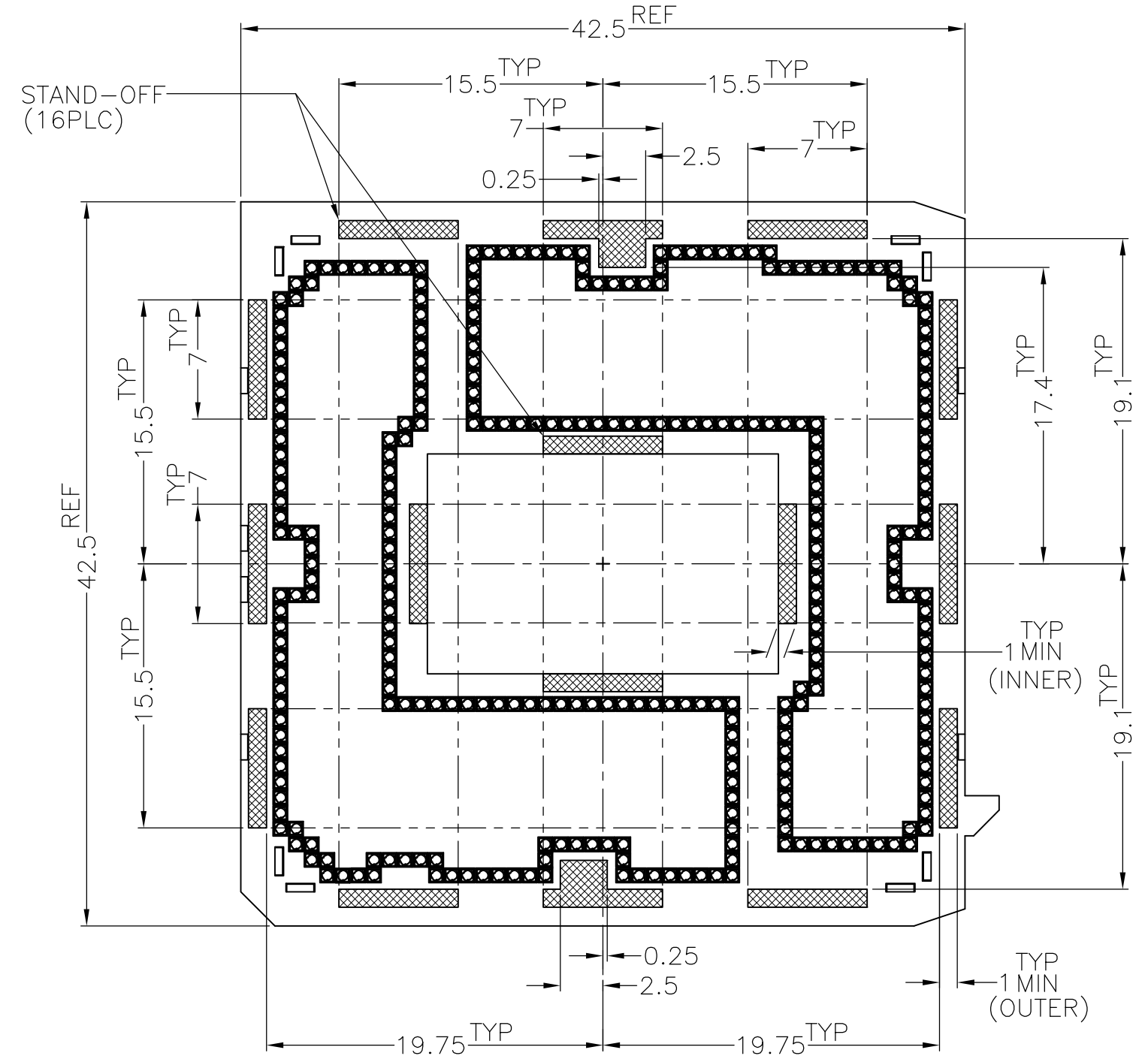
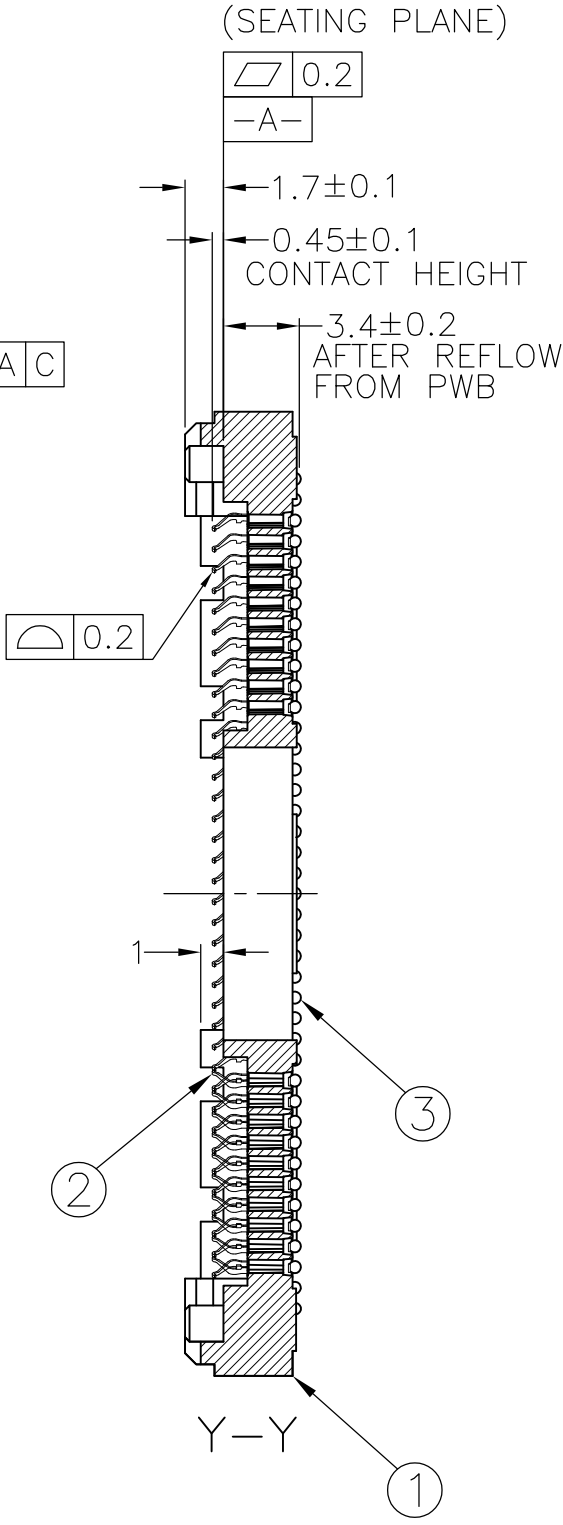
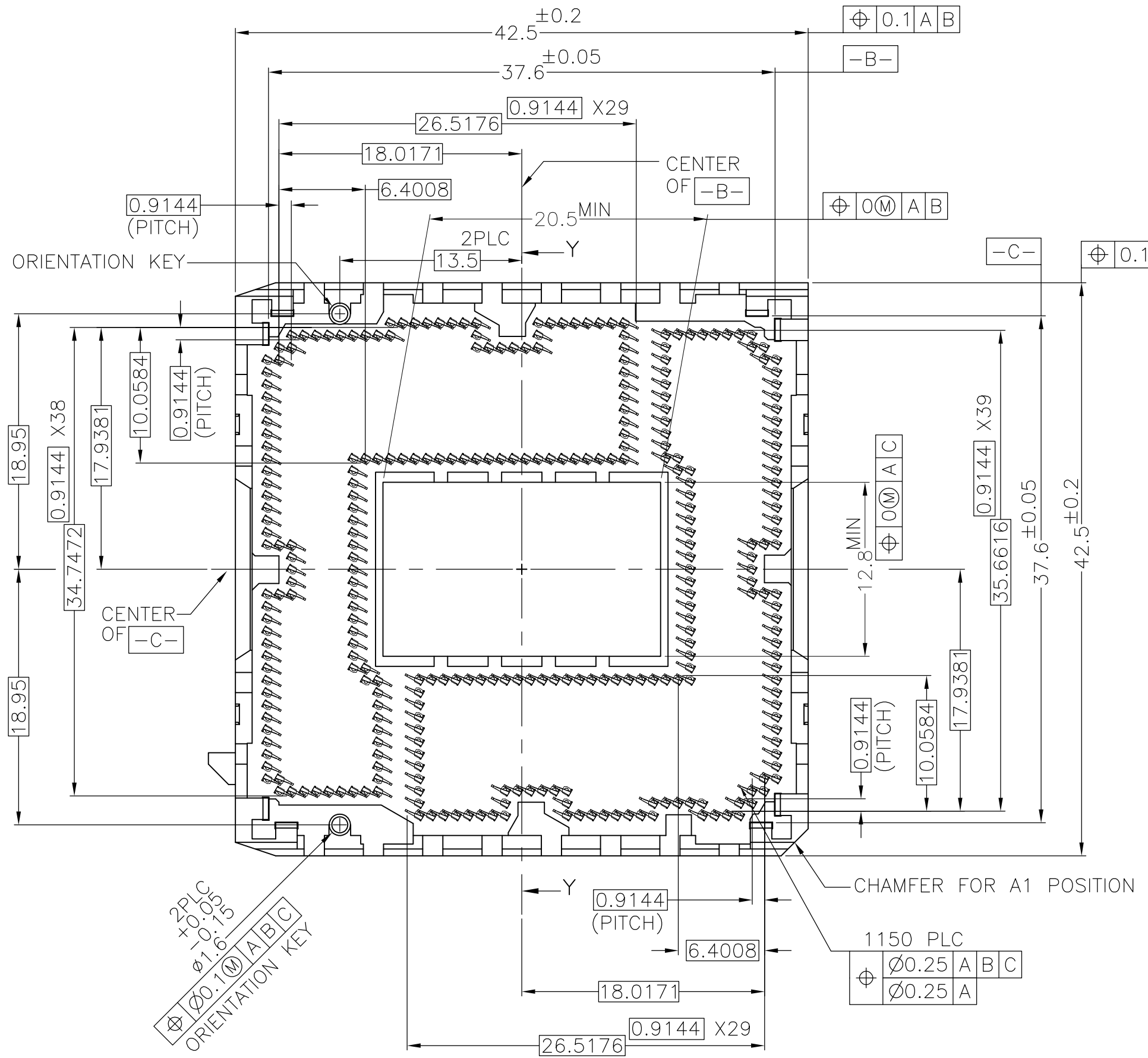

2134928-*, 1-2134928-*: AS SHOWN

THIS DRAWING IS A CONTROLLED DOCUMENT.		DWN	 TE Connectivity	
DIMENSIONS: 单位: 毫米 mm		CHK		
TOLERANCES UNLESS OTHERWISE SPECIFIED: 一般公差		APVD	NAME 名称	
Ø PLG ± ±0.3 1 PLG ± ±3 2 PLG ± ±3 3 PLG ± ±3 4 PLG ± ±3 ANGLES ± ±		PRODUCT SPEC 製品規格	SOCKET ASSY LGA1150	
MATERIAL 材料		APPLICATION SPEC 取付適用規格	SIZE A2	CAGE CODE 00779
FINISH 仕上		WEIGHT -	DRAWING NO 番号 C=2134928	RESTRICTED TO -
		CUSTOMER DRAWING	SCALE 尺度 NTS	SHEET 4 OF 6
			REV C	

THIS DRAWING IS UNPUBLISHED. RELEASED FOR PUBLICATION
 © COPYRIGHT - By Tyco Electronics Japan G.K. ALL RIGHTS RESERVED.

LOC	DIST	REVISIONS				
		P	LTR	DATE	DWN	APVD
-	-	-	-	-	-	-
SEE SHEET 1				-	-	-

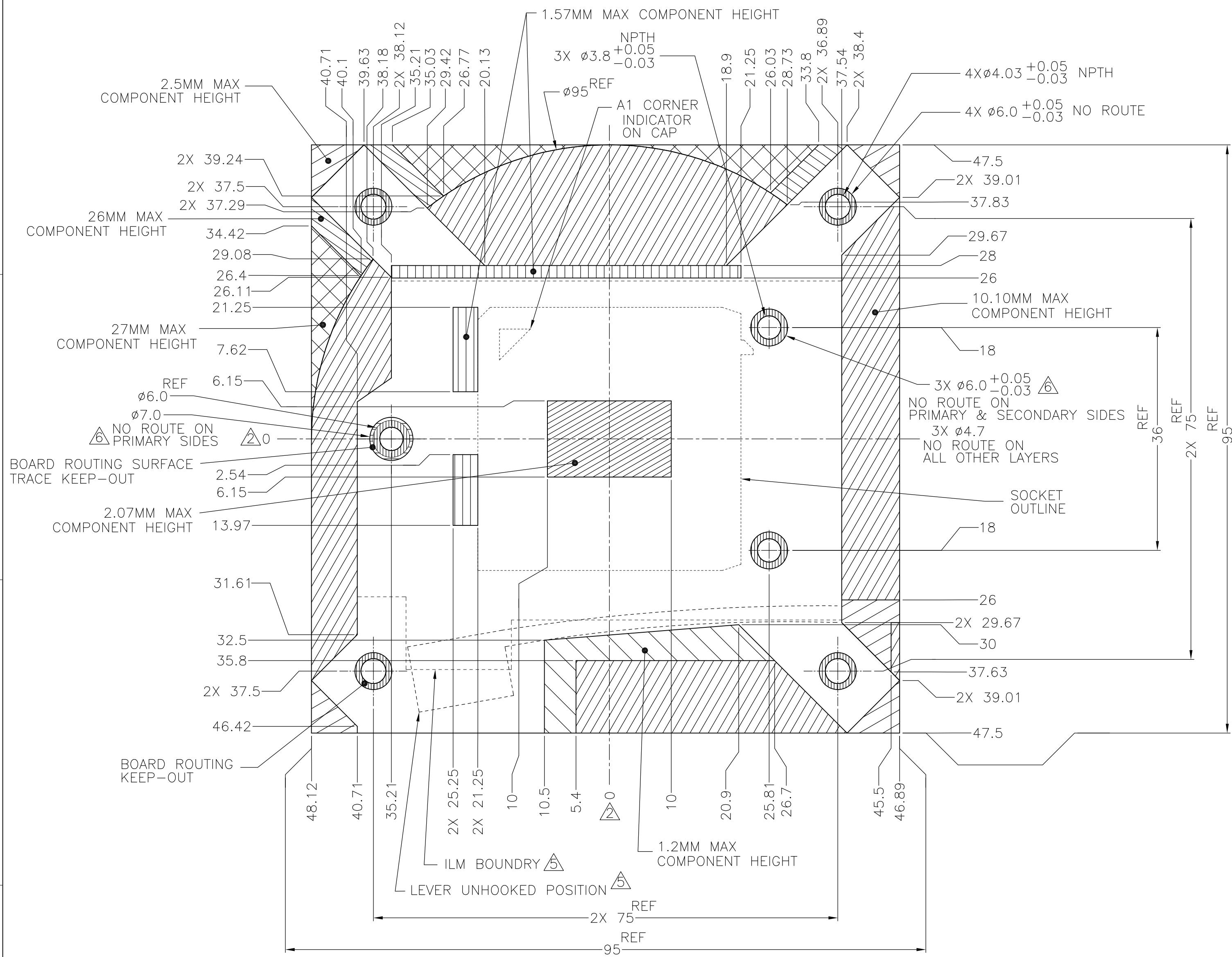

- NOTES (APPLIED TO SHEET 5 OF 5):
1. DIMENSIONS ARE IN MILLIMETERS
 2. Δ GEOMETRIC CENTER OF SOCKET HOUSING CAVITY
 3. BOARD COMPONENT KEEP-INS AND MECHANICAL COMPONENT KEEP-OUTS TO BE UTILIZED WITH SUFFICIENT ALLOWANCES FOR PLACEMENT AND SIZE TOLERANCES, ASSEMBLY PROCESS ACCESS, AND DYNAMIC EXCURSIONS.
 4. ASSUME SYMMETRY FOR UNDIMENSIONED CORNERS AND EDGES.
 5. Δ FOR UNDEFINED DIMENSIONS, REFER TO THERMAL AND MECHANICAL DESIGN GUIDELINE PROVIDED BY INTEL CORPORATION.
 6. Δ COPPER PAD ON PRIMARY SIDE, NON-GROUNDED. COPPER PAD CAN INSET A MAXIMUM OF 0.127MM FROM THE NO ROUTE EDGE
 7. Δ COMBINED COMPONENT AND SOLDER PASTE HEIGHT INCLUDING TOLERANCES AFTER REFLOW.

COMPONENT KEEP-INS AND MECHANICAL COMPONENT KEEP-OUTS

FOR REFERENCE ONLY, PLEASE REFER TO THE THERMAL AND MECHANICAL DESIGN GUIDELINES(TMDG) PROVIDED BY INTEL CORPORATION

LEGEND	
	SOCKET/THERMAL/MECHANICAL COMPONENT KEEP-INS
	10.10MM MAX COMPONENT HEIGHT Δ
	1.57MM MAX COMPONENT HEIGHT Δ
	1.2MM MAX COMPONENT HEIGHT Δ
	BOARD ROUTING KEEP-OUT
	27MM MAX COMPONENT HEIGHT Δ
	BOARD ROUTING SURFACE TRACE KEEP-OUT Δ
	2.07MM MAX COMPONENT HEIGHT Δ
	2.5MM MAX COMPONENT HEIGHT Δ
	26MM MAX COMPONENT HEIGHT Δ

THIS DRAWING IS A CONTROLLED DOCUMENT.		DWN	TE Connectivity													
DIMENSIONS: 单位: 毫米 mm		CHK	NAME 名称													
TOLERANCES UNLESS OTHERWISE SPECIFIED: 一般公差		APVD	SOCKET ASSY LGA1150													
<table border="0"> <tr><td>Ø PLG</td><td>±</td></tr> <tr><td>1 PLG</td><td>±</td></tr> <tr><td>2 PLG</td><td>±</td></tr> <tr><td>3 PLG</td><td>±</td></tr> <tr><td>4 PLG</td><td>±</td></tr> <tr><td>ANGLES</td><td>±</td></tr> </table>		Ø PLG	±	1 PLG	±	2 PLG	±	3 PLG	±	4 PLG	±	ANGLES	±	PRODUCT SPEC 製品規格	SIZE A2	CAGE CODE 00779
Ø PLG	±															
1 PLG	±															
2 PLG	±															
3 PLG	±															
4 PLG	±															
ANGLES	±															
MATERIAL 材料		APPLICATION SPEC 取付適用規格	DRAWING NO 番号 C=2134928	RESTRICTED TO												
FINISH 仕上		WEIGHT -	SCALE 尺度 NTS	SHEET 6 OF 6												
		CUSTOMER DRAWING	REV C													

单击下面可查看定价，库存，交付和生命周期等信息

[>>TE Connectivity\(泰科\)](#)