

| REVISIONS |           |     |       |                           |
|-----------|-----------|-----|-------|---------------------------|
| REV       | DATE      | BY  | APP'D | DESCRIPTION               |
| A1        | 22DEC2017 | J.Z | D.Z   | REVISED PER ECO-17-018762 |

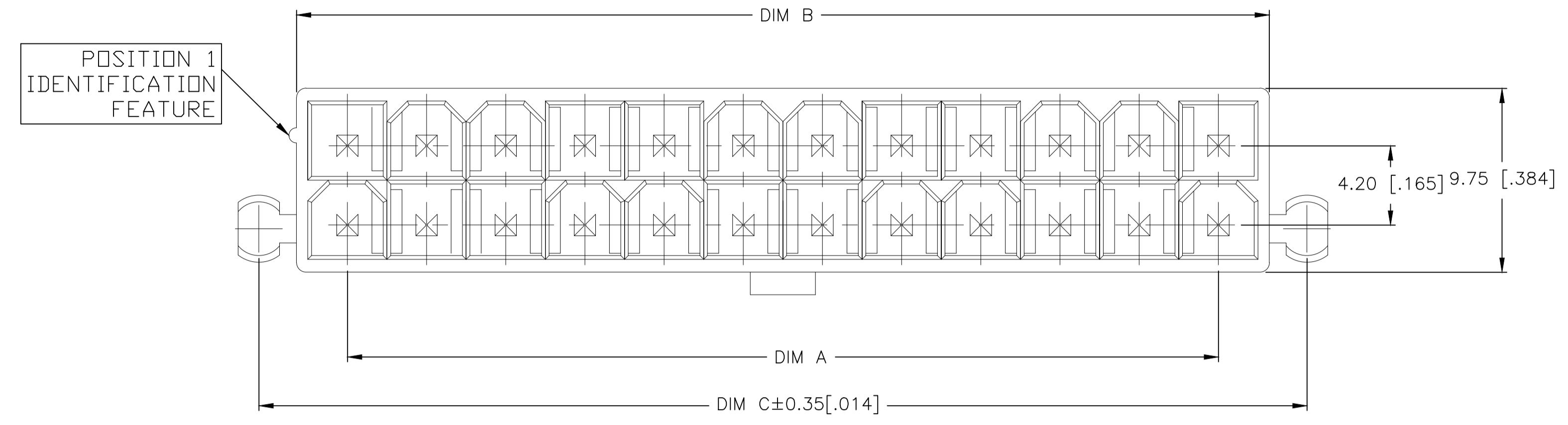

- 1 MATERIAL:  
HOUSING: POLYAMIDE, UL94V-0, NATURAL  
CONTACTS: HIGH PERFORMANCE COPPER ALLOY, TIN PLATED
- 2 GLOW WIRE APPROVED, CONTACT TE ENGINEERING FOR SPECIFICATION.
- 3 MATES WITH VAL-U-LOK(TM) RECEPTACLE HOUSINGS:  
X-1586019-X(UL94-V0)  
X-1586765-X(UL94-V2,GLOW WIRE)

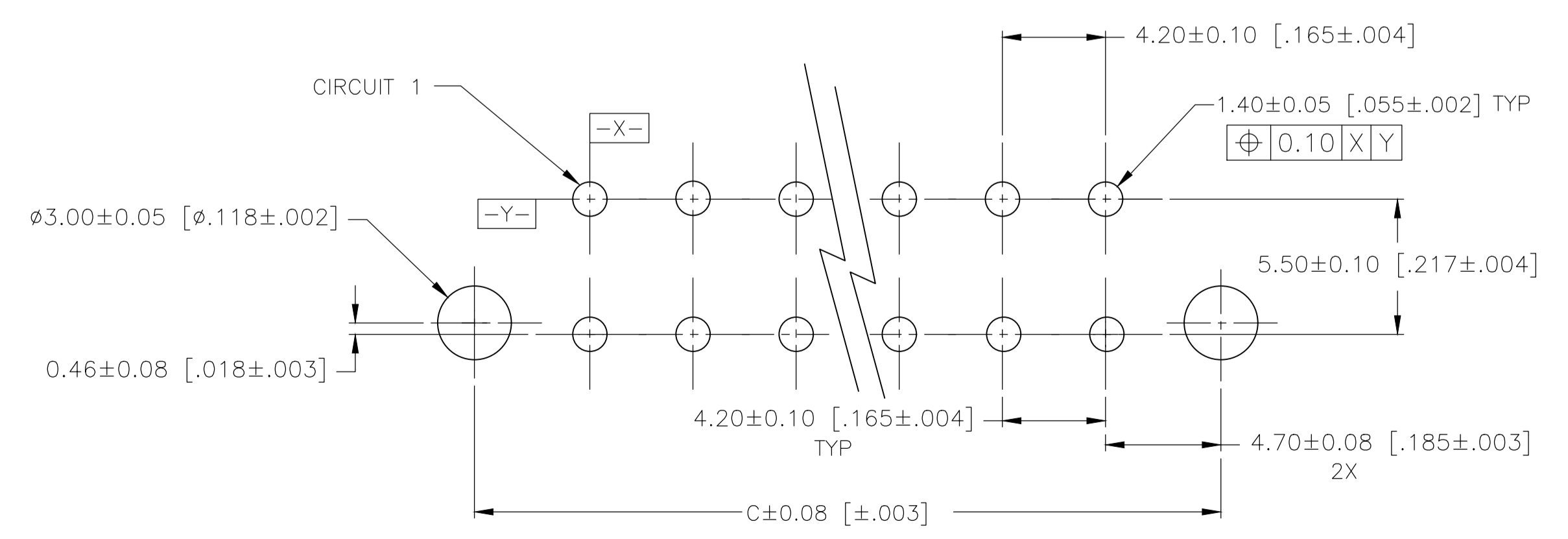
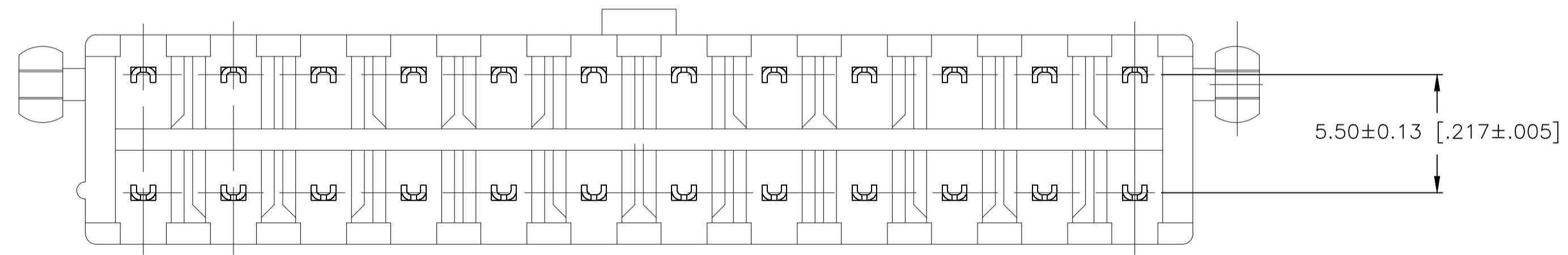
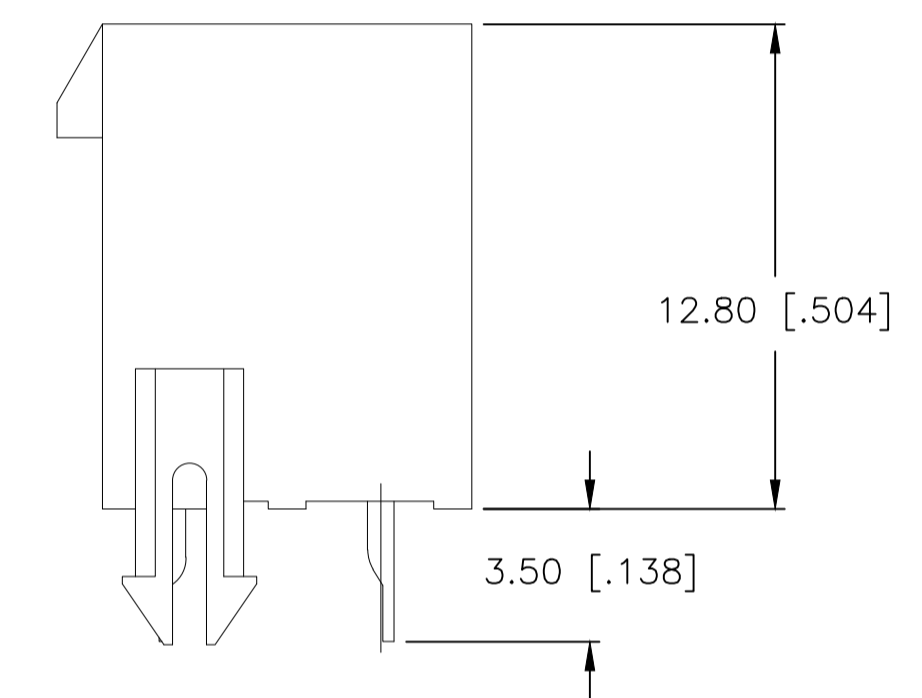
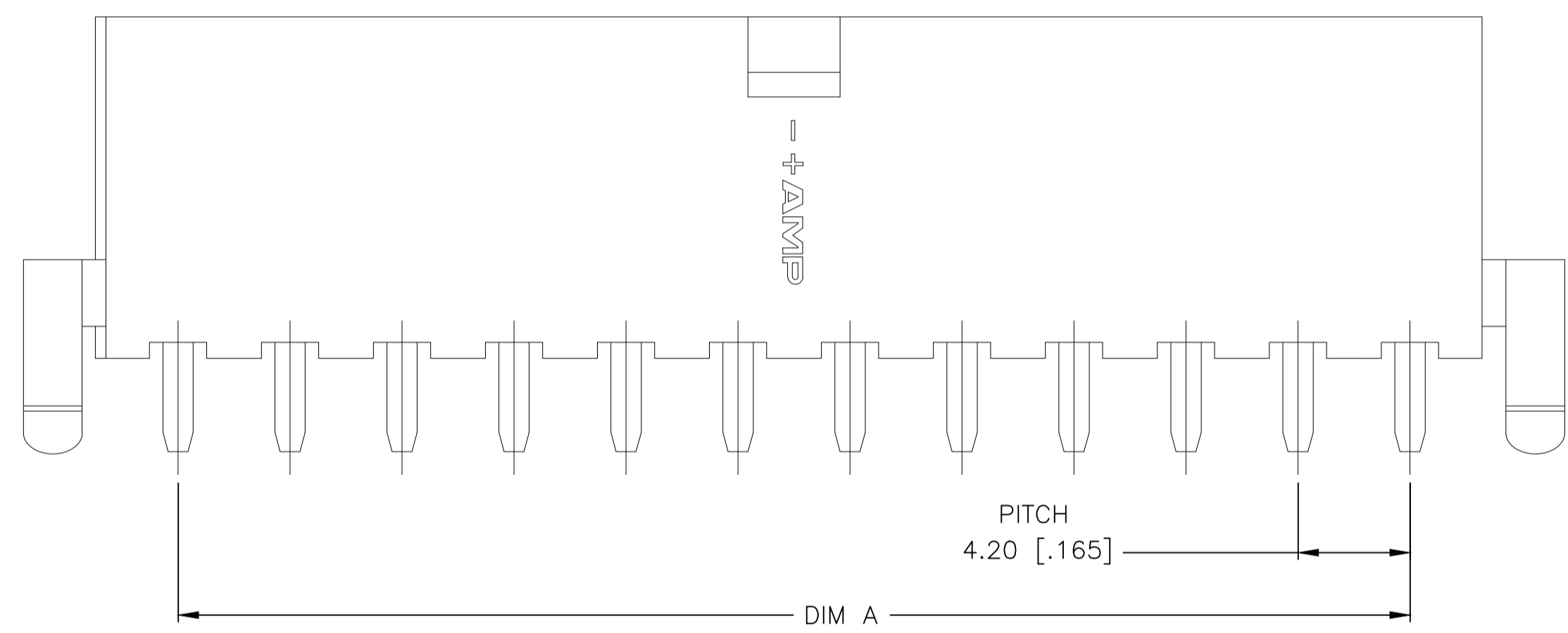
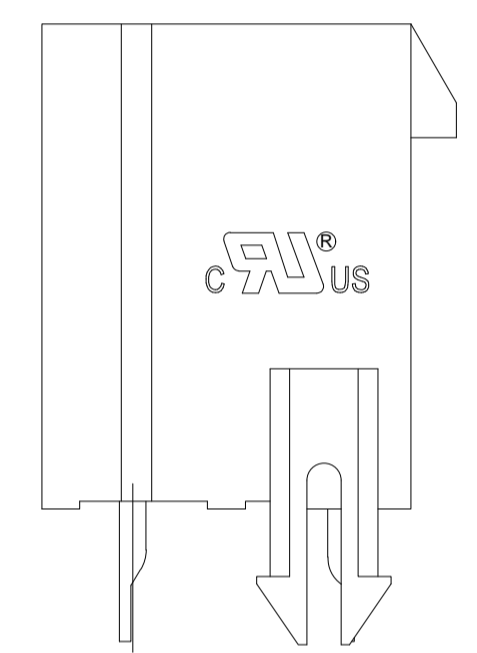

PCB LAYOUT: COMPONENT SIDE  
RECOMMENDED BOARD THICKNESS 1.78 [.070]

| POS | DIM A                     | DIM B  | DIM C        | PART NUMBER |
|-----|---------------------------|--|--------------|-------------|
| 24  | 46.2 ± 0.2 [1.819 ± .008] | 51.6 <sup>+0.5</sup> / <sub>0</sub> [2.031 <sup>+0.02</sup> / <sub>0</sub> ] | 55.6 [2.189] | 2-2825274-4 |
| 22  | 42.0 ± 0.2 [1.654 ± .008] | 47.4 <sup>+0.5</sup> / <sub>0</sub> [1.866 <sup>+0.02</sup> / <sub>0</sub> ] | 51.4 [2.024] | 2-2825274-2 |
| 20  | 37.8 ± 0.2 [1.488 ± .008] | 43.2 <sup>+0.5</sup> / <sub>0</sub> [1.701 <sup>+0.02</sup> / <sub>0</sub> ] | 47.2 [1.858] | 2-2825274-0 |
| 18  | 33.6 ± 0.2 [1.323 ± .008] | 39.0 <sup>+0.5</sup> / <sub>0</sub> [1.536 <sup>+0.02</sup> / <sub>0</sub> ] | 43.0 [1.693] | 1-2825274-8 |
| 16  | 29.4 ± 0.2 [1.157 ± .008] | 34.8 <sup>+0.5</sup> / <sub>0</sub> [1.370 <sup>+0.02</sup> / <sub>0</sub> ] | 38.8 [1.528] | 1-2825274-6 |
| 14  | 25.2 ± 0.2 [.992 ± .008]  | 30.6 <sup>+0.5</sup> / <sub>0</sub> [1.205 <sup>+0.02</sup> / <sub>0</sub> ] | 34.6 [1.362] | 1-2825274-4 |
| 12  | 21.0 ± 0.2 [.827 ± .008]  | 26.4 ± 0.2 [1.039 ± .008]  | 30.4 [1.197] | 1-2825274-2 |
| 10  | 16.8 ± 0.1 [.661 ± .004]  | 22.2 ± 0.2 [.874 ± .008]   | 26.2 [1.031] | 1-2825274-0 |
| 8   | 12.6 ± 0.1 [.496 ± .004]  | 18.0 ± 0.2 [.709 ± .008]   | 22.0 [.866]  | 2825274-8   |
| 6   | 8.4 ± 0.1 [.331 ± .004]   | 13.8 ± 0.2 [.543 ± .008]   | 17.8 [.701]  | 2825274-6   |
| 4   | 4.2 ± 0.1 [.165 ± .004]   | 9.6 ± 0.2 [.378 ± .008]  | 13.6 [.535]  | 2825274-4   |
| 2   |                           | 5.4 ± 0.2 [.213 ± .008]  | 9.4 [.370]   | 2825274-2   |

THIS DRAWING IS A CONTROLLED DOCUMENT.

DIMENSIONS: mm [INCHES]

TOLERANCES UNLESS OTHERWISE SPECIFIED:

|        |               |
|--------|---------------|
| 0 PL   | ±             |
| 1 PL   | ± 0.5 [0.2]   |
| 2 PL   | ± 0.25 [0.10] |
| 3 PL   | ±             |
| 4 PL   | ±             |
| ANGLES | ±             |

MATERIAL: 1

FINISH:

WARREN HUO 15AUG2017  
DANIEL ZHANG 15AUG2017  
DANIEL ZHANG 15AUG2017

NAME: VERTICAL HEADER WITH PEGS, WITHOUT DRAIN HOLES, VAL-U-LOK(TM), HCS

PRODUCT SPEC: 108-150000

APPLICATION SPEC: 114-13172

SIZE: A1

SCALE: N/A

SHEET: 1 OF 2

REV: A1

| REVISIONS |    |             |      |     |
|-----------|----|-------------|------|-----|
| #         | LR | DESCRIPTION | DATE | OWN |
| -         | -  | SEE SHEET 1 | -    | -   |

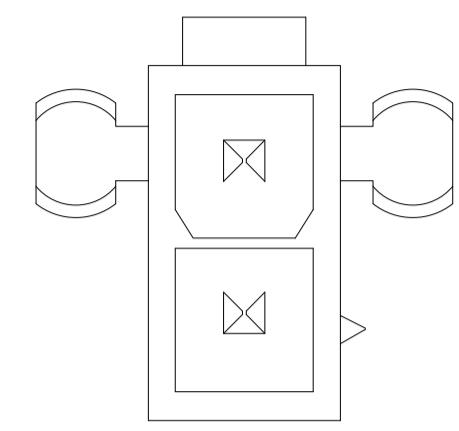

2825274-2

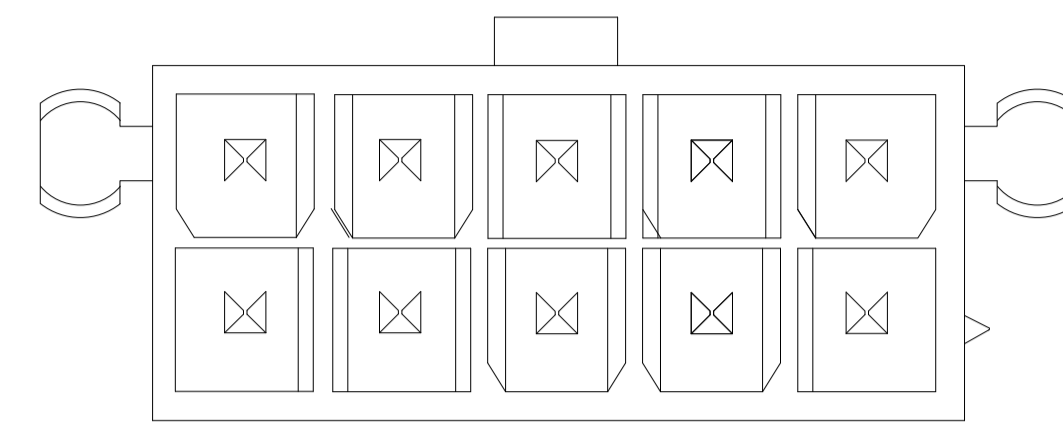

1-2825274-0

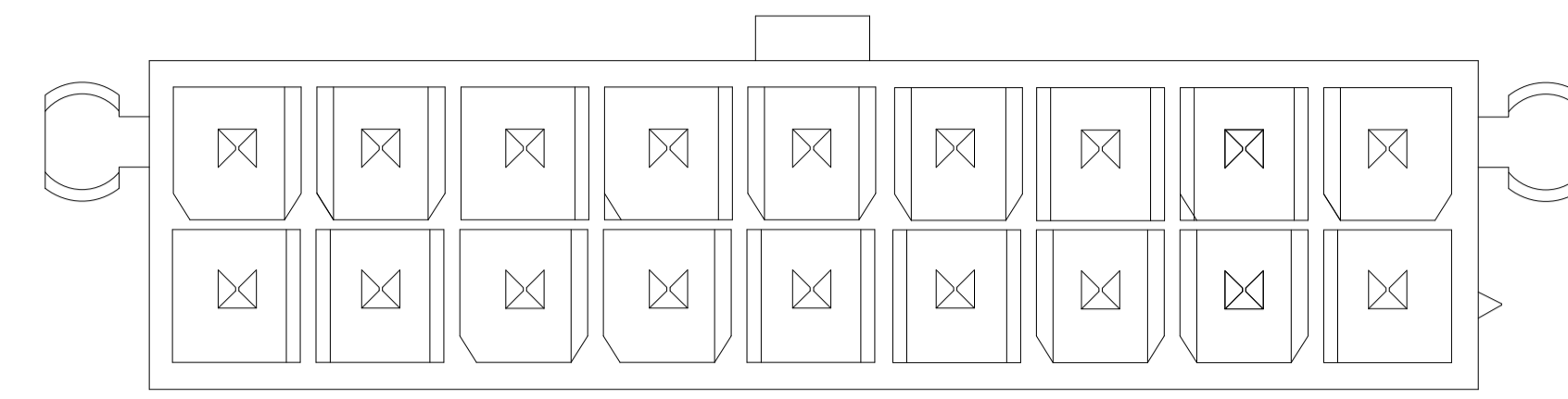

1-2825274-8

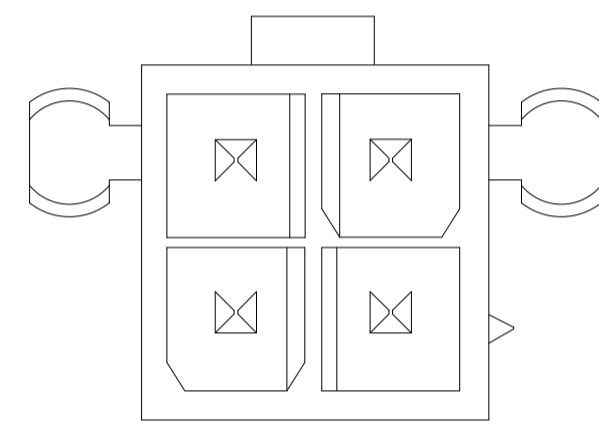

2825274-4

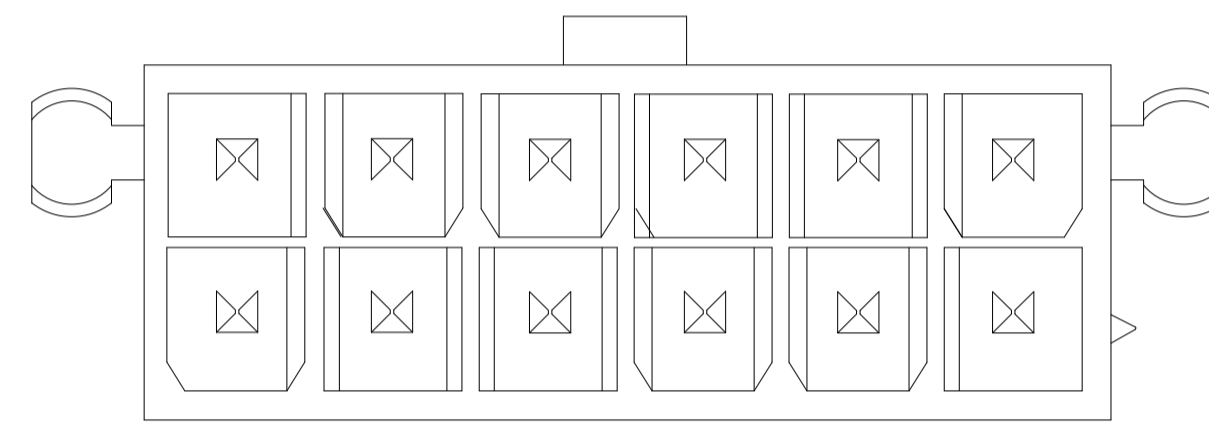

1-2825274-2

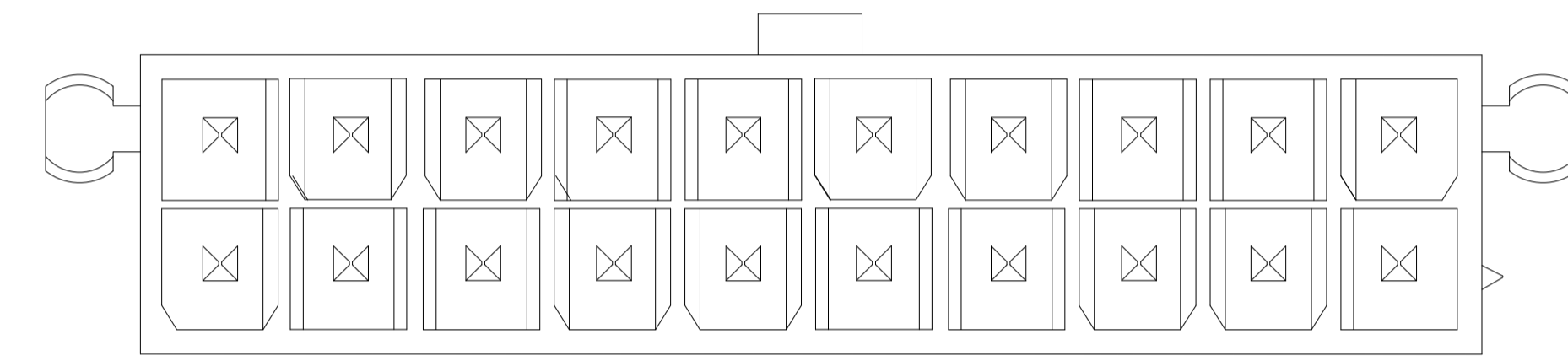

2-2825274-0

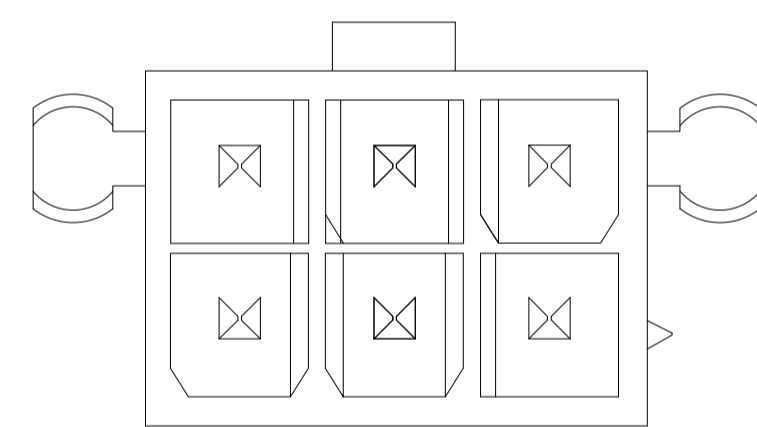

2825274-6

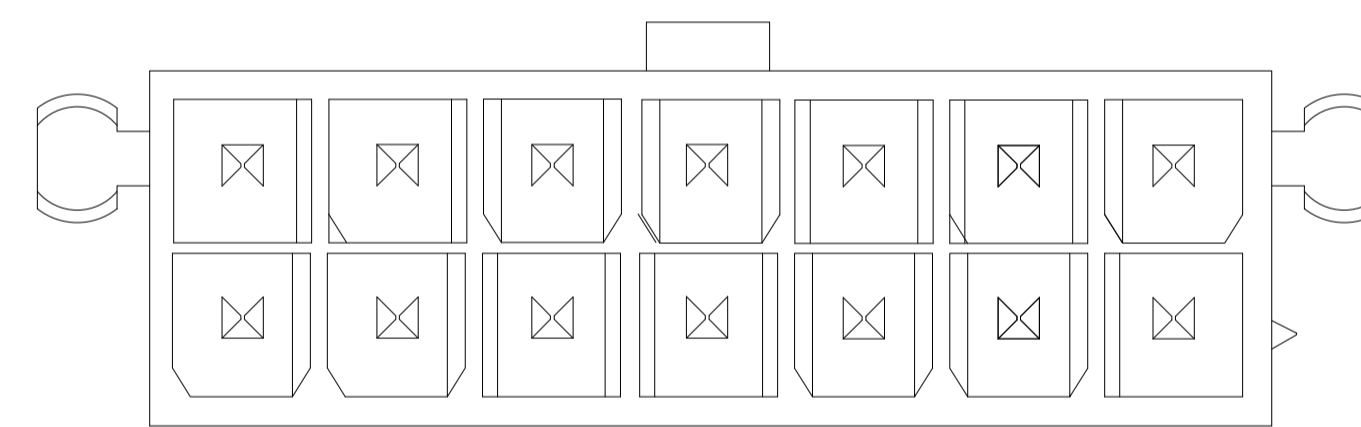

1-2825274-4

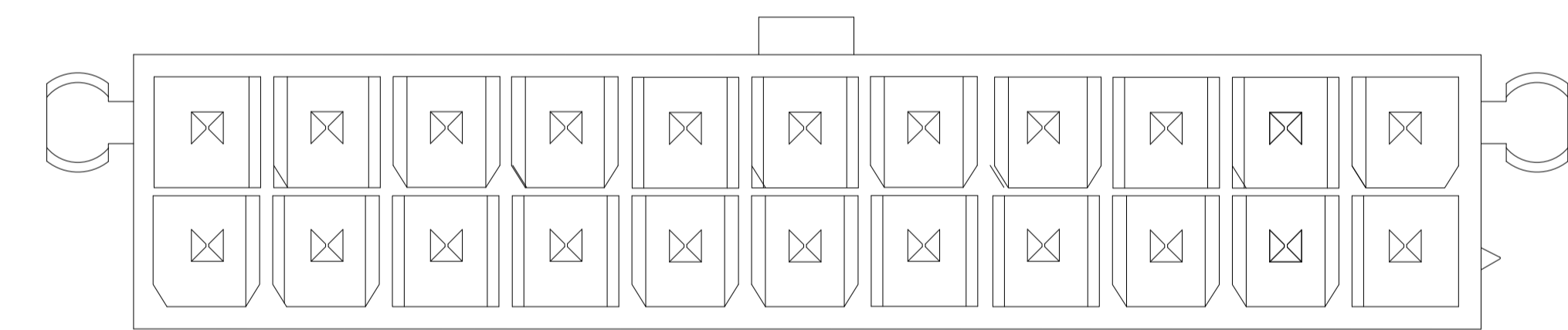

2-2825274-2

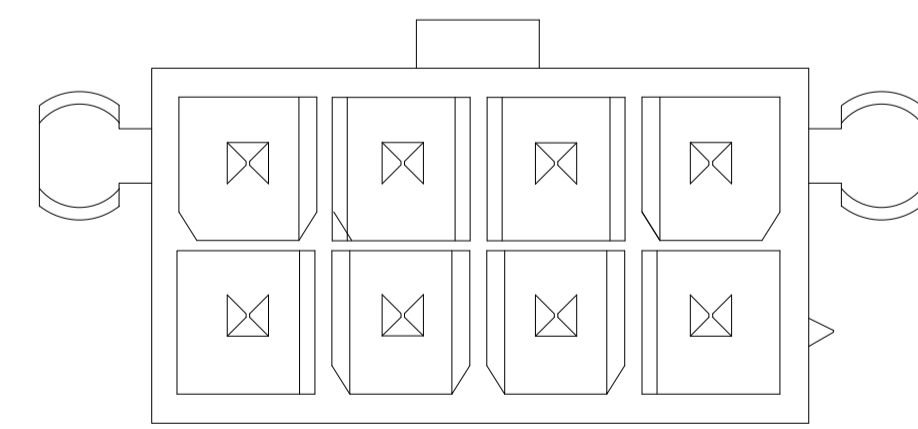

2825274-8

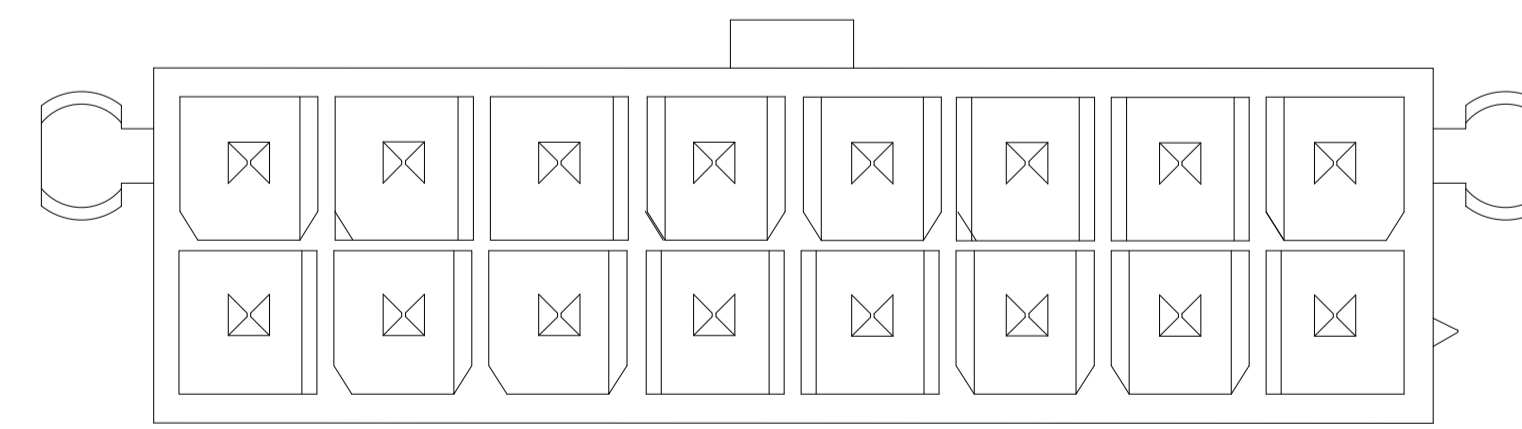

1-2825274-6

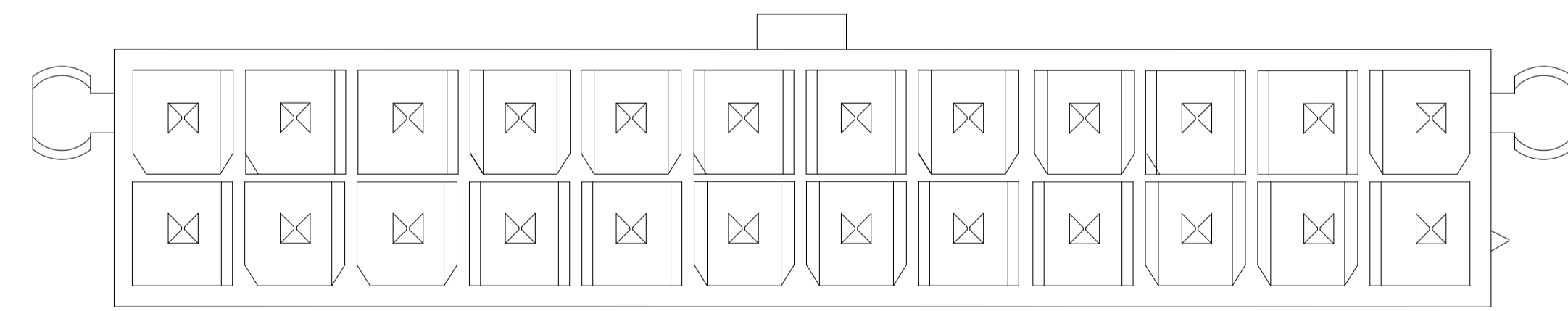

2-2825274-4

|  |  |                                   |                               |  |
|--|--|-----------------------------------|-------------------------------|--|
| THIS DRAWING IS A CONTROLLED DOCUMENT. |  | DWN<br>WARREN_HUO<br>15AUG2017    | TE Connectivity               |  |
| DIMENSIONS:<br>mm [INCHES]             |  | CHK<br>DANIEL_ZHANG<br>15AUG2017  | NAME                          |  |
| TOLERANCES UNLESS OTHERWISE SPECIFIED: |  | APRO<br>DANIEL_ZHANG<br>15AUG2017 | PRODUCT SPEC                  |  |
| 0 PLC ±                                |  | PRODUCT SPEC                      | 108-150000                    |  |
| 1 PLC ± 0.5 [02]                       |  | APPLICATION SPEC                  | 114-13172                     |  |
| 2 PLC ± 0.25 [010]                     |  | WEIGHT                            | A1 00779 ©=2825274            |  |
| 3 PLC ±                                |  | CUSTOMER DRAWING                  | SCALE N/A SHEET 2 OF 2 REV A1 |  |
| 4 PLC ±                                |  |                                   |                               |  |
| ANGLES ±                               |  |                                   |                               |  |
| FINISH                                 |  |                                   |                               |  |

单击下面可查看定价，库存，交付和生命周期等信息

[>>TE Connectivity\(泰科\)](#)