

DESIGNED FOR USE WITH	.141 S.R. CABLE
CABLE ENTRY DIAMETER MINIMUM	
HOUSING	.145
CONTACT	.0369

REVISIONS			
REV	DESCRIPTION	DATE	APPROVED
03 ₀	REVISED	6/30/97	PCV 7/1/97

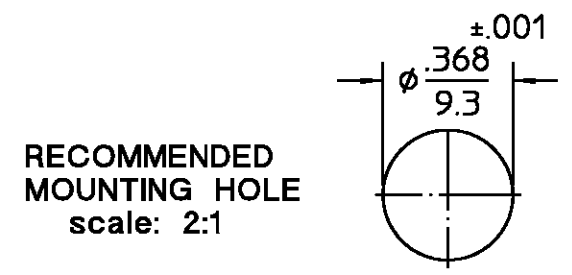

NOTES:
1. CAPTURED CENTER CONTACT

COMPONENT	MATERIAL	FINISH
HOUSING, OUTER MOUNTING NUT WASHER	STAINLESS STEEL PER ASTM-A484 AND ASTM-A582, TYPE 303	PASSIVATE PER QQ-P-35
INNER HOUSING	STAINLESS STEEL PER ASTM-A484 AND ASTM-A582, TYPE 303	GOLD PLATE PER MIL-G-45204
DIELECTRIC	PTFE FLUOROCARBON PER ASTM-D-1457	N/A
CENTER CONTACT CONTACT SLEEVE	BERYLLIUM COPPER PER ASTM-B-196 OR ASTM-B-197, ALLOY C17300, CONDITION H	GOLD PLATE PER MIL-G-45204
CONTACT RING	BERYLLIUM COPPER PER ASTM-B-194, ALLOY C17200, CONDITION H	GOLD PLATE PER MIL-G-45204
RETAINING RING	BERYLLIUM COPPER PER ASTM-B-194, ALLOY C17200, CONDITION H	NICKEL PLATE PER QQ-N-290
LOCKWASHER	CARBON STEEL 1050	GOLD PLATE PER MIL-G-45204
SPRING	MUSIC WIRE	NICKEL PLATE PER QQ-N-290

ELECTRICAL	ELECTRICAL (cont)	ENVIRONMENTAL
Nominal Impedance (Ohms) 50	RF High Potential @ Sea Level (VRMS MIN @ 5 MHz) 670	Temperature Rating -65° to +125°C
Frequency Range (GHz) DC to 22	I.R.(Megohms MIN) 5000	Vibration MIL-STD-202, Method 204, Condition D
Volt Rating (VRMS MAX) @ Sea Level 335	MECHANICAL	Shock MIL-STD-202, Method 213, Condition I
VSWR 1.05+.005f(GHz) DC to 18 GHz	Interface Dimensions MIL-STD-348A FIG. 321	Thermal Shock MIL-STD-202, Method 107, Condition B
1.05+.009f(GHz) DC to 22 GHz	Mating Characteristics:	Moisture Resistance MIL-STD-202, Method 106
Insertion Loss (dB MAX) .03x√f(GHz)	Insertion (MAX Lbs) 3	Corrosion - MIL-STD-202, Method 101, Condition B
RF Leakage (dB MIN) (Interface Only, Fully Mated) -(90-f(GHz))	Withdrawal (MIN Oz) 1	
Corona, 70,000 Ft (VRMS MIN) 250	Force to Engage (In-Lbs MAX) 3 & Disengage (In-Lbs MAX) 15	
Dielectric Withstanding Voltage (VRMS MIN) @ Sea Level 1000	Center Contact Captivation:	
Contact Resistance (Milliohms MAX)	Axial (Lbs) 6	
Center Contact 2.0	Cable Retention:	
Outer Contact 2.0	Axial Force (Lbs MIN) 30	
Cable to Housing 0.5	Torque (In-Oz MIN) 16	
	Weight (Grams)	

COMPONENT	MATERIAL	FINISH
UNLESS OTHERWISE SPECIFIED DIMENSIONS ARE IN INCHES		
FRAC. ± 1/64	DEC. ±.005	ANGLES ± 1°
DRAWN BY KCM	DATE 1/29/88	AMP Incorporated 140 Fourth Avenue Waltham, MA 02451-7599
CHECKED BY MH/M	3/30/88	
APPD BY DC	3/30/88	
USE ASSY PROCEDURE		TITLE OSP FLOATING PANEL FEEDTHRU CABLE JACK DIRECT SOLDER ATTACHMENT
NO. A.P. 408-08281 (45-046)		SIZE B
		CODE IDENT NO. 26805
		4522-7941-02
		REV 03 ₀
SCALE 4:1		SHEET 1 OF 1

.XXX = in
XX.X = mm (REF)

单击下面可查看定价，库存，交付和生命周期等信息

[>>TE Connectivity\(泰科\)](#)