

REVISIONS			
REV	DESCRIPTION	DATE	APPROVED
01 <sub>0</sub>	RELEASED		
02 <sub>0</sub>	MAJOR REDESIGN PER ECN 89-1221-6 REDRAWN ON CAD PER ECN 88-0678	LROSS 2-6-90	<i>PJA</i> 2-12-90

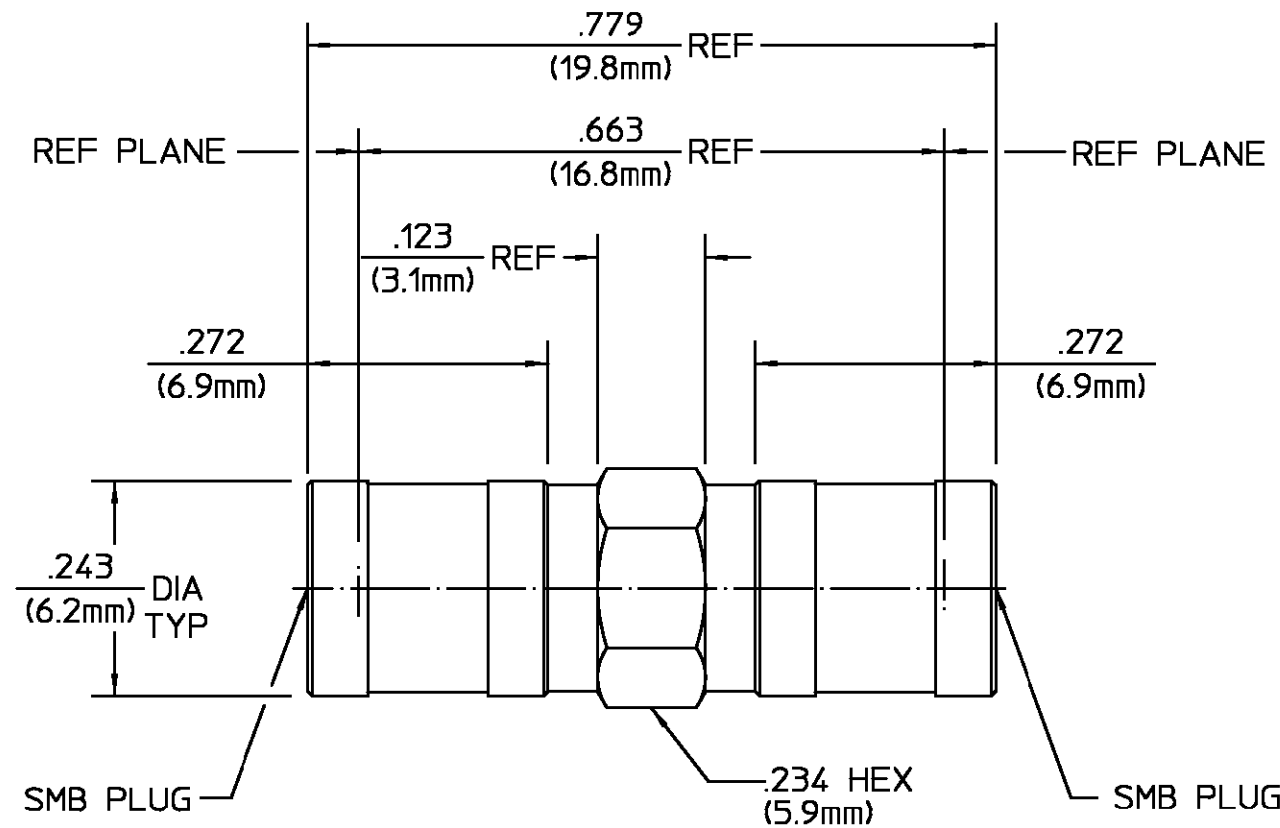

HOUSING SLEEVE	BRASS PER QQ-B-626 COMP. 360	GOLD PLATE PER MIL-G-45204 OVER COPPER PLATE PER MIL-C-14550
DIELECTRIC	TFE FLUOROCARBON PER ASTM-D-1457, MIL-P-19468, AND FED. SPEC L-P-403	N/A
CENTER CONTACT	BERYLLIUM COPPER PER ASTM B196, ALLOY 173	GOLD PLATE PER MIL-G-45204 OVER COPPER PLATE PER MIL-C-14550
RETAINING RING	BERYLLIUM COPPER PER QQ-C-530	GOLD PLATE PER MIL-G-45204 OVER COPPER PLATE PER MIL-C-14550

COMPONENT	MATERIAL	FINISH
UNLESS OTHERWISE SPECIFIED DIMENSIONS ARE IN INCHES TOLERANCE ON	DRAWN BY E.J.C. DATE 5-26-71	AMP Incorporated 140 Fourth Avenue Waltham, MA 02451-7599
FRAC. DEC. ANGLES	CHECKED BY P.R.B. 6-1-71	
± 1/64 ± .005 ± 1°	APP'D BY B.K.W. 6-1-71	
These drawings and specifications are the property of Omni Spectra Incorporated and shall not be reproduced or copied or used in whole or in part as the basis for the manufacture or sale of item(s) without written permission.	USE ASSY PROCEDURE	TITLE SMB PLUG TO PLUG ADAPTER
	NO. AP. N/A	SIZE B CODE IDENT NO. 26805 5181-0000-09 REV 02 <sub>0</sub>
		SCALE 5:1 SHEET 1 OF 1

NOTES:  
1. CAPTURED CENTER CONTACT

CUSTOMER DRAWING

AMP PART # 1060492-1  
SHEET 1 OF 1 REV A

单击下面可查看定价，库存，交付和生命周期等信息

[>>TE Connectivity\(泰科\)](#)