

Molded Parts Specification Control Drawing

Part Number : 101A062-X-14
Description : Cap, Round End

NOTES

1. All dimensions are in $\frac{\text{inches}}{[\text{millimeters}]}$
2. Dimensions appearing in table are as follows:
 - a - As Supplied
 - b - After Unrestricted Recovery
3. Coating is optional. As supplied dimensions appearing in table are for uncoated parts. When coating is added, entry diameters will be reduced by .06 max.
4. Recovered parts may have angularity of 30° - 45°.

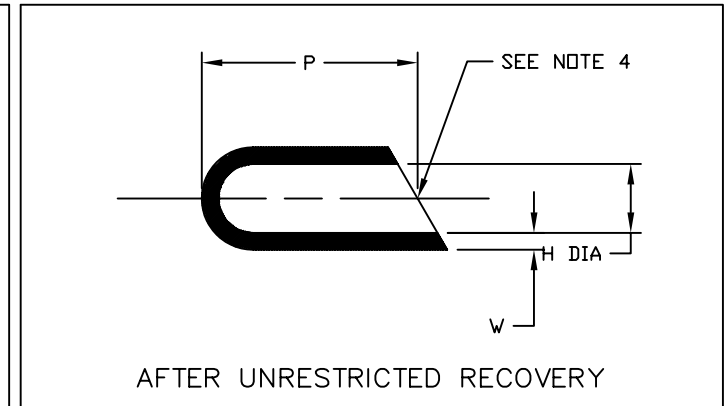
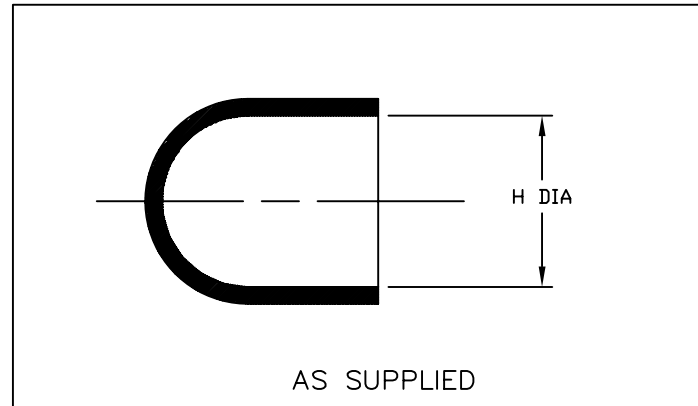

TABLE OF DIMENSIONS				
PART NUMBER	H		P	W
	Min a	Max b	±.25 b	±20% b
101A062-X-14	$\frac{1.00}{[25,4]}$	$\frac{.45}{[11,4]}$	$\frac{1.50}{[38,1]}$	$\frac{.09}{[2,29]}$

If this document is printed it becomes uncontrolled. Check for the latest revision

tyco
Electronics **Raychem**

TYCO ELECTRONICS
300 CONSTITUTION DRIVE
MENLO PARK, CALIFORNIA 94025

© 2006 Tyco Electronics Corporation. All rights reserved

Revision : A
Date : 12/6/06
Page 1 of 2

Part Number : 101A062-X-14
Description : Cap, Round End
DCR MP060172

Molded Parts Specification Control Drawing

Part Number : 101A062-X-14

Description : Cap, Round End

COMPATABILITY CHART					
MATERIAL DASH NO.	MATERIAL DESCRIPTION	RT SPEC	COATING SLASH NO.	COATING S NO.	COATING DESCRIPTION
-3	Polyolefin, Semi-rigid	RT-301	N.A.		

ORDERING INFORMATION

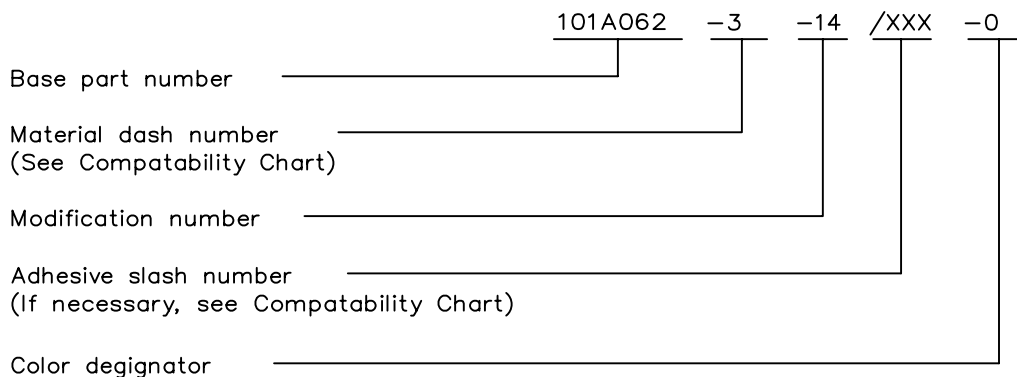

THIS DRAWING IS SUBJECT TO CHANGE WITHOUT NOTICE; CONSULT YOUR
NEAREST FIELD REPRESENTATIVE FOR CURRENT REVISION

If this document is printed it becomes uncontrolled. Check for the latest revision

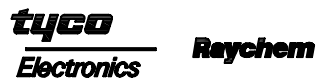

TYCO ELECTRONICS
300 CONSTITUTION DRIVE
MENLO PARK, CALIFORNIA 94025

© 2006 Tyco Electronics Corporation. All rights reserved

Revision : A

Date : 12/6/06

Page 2 Of 2

Part Number : 101A062-X-14

Description : Cap, Round End

DCR MP060172

单击下面可查看定价，库存，交付和生命周期等信息

[>>TE Connectivity\(泰科\)](#)