

DRAWING MADE IN THIRD ANGLE PROJECTION

THIS DRAWING IS A CONTROLLED DOCUMENT FOR AMP INCORPORATED. IT IS SUBJECT TO CHANGE AND THE CONTROLLING ENGINEERING ORGANIZATION SHOULD BE CONTACTED FOR THE LATEST REVISION.

LOC	DIST	P	F	LTR	DESCRIPTION	DATE	APPROVED
G	14			H	REVISED & REDRAWN PER G-5803	6/12/92	DKS / AJK

THIS DRAWING IS UNPUBLISHED. RELEASED FOR PUBLICATION BY AMP INCORPORATED. ALL INTERNATIONAL RIGHTS RESERVED. © COPYRIGHT 19

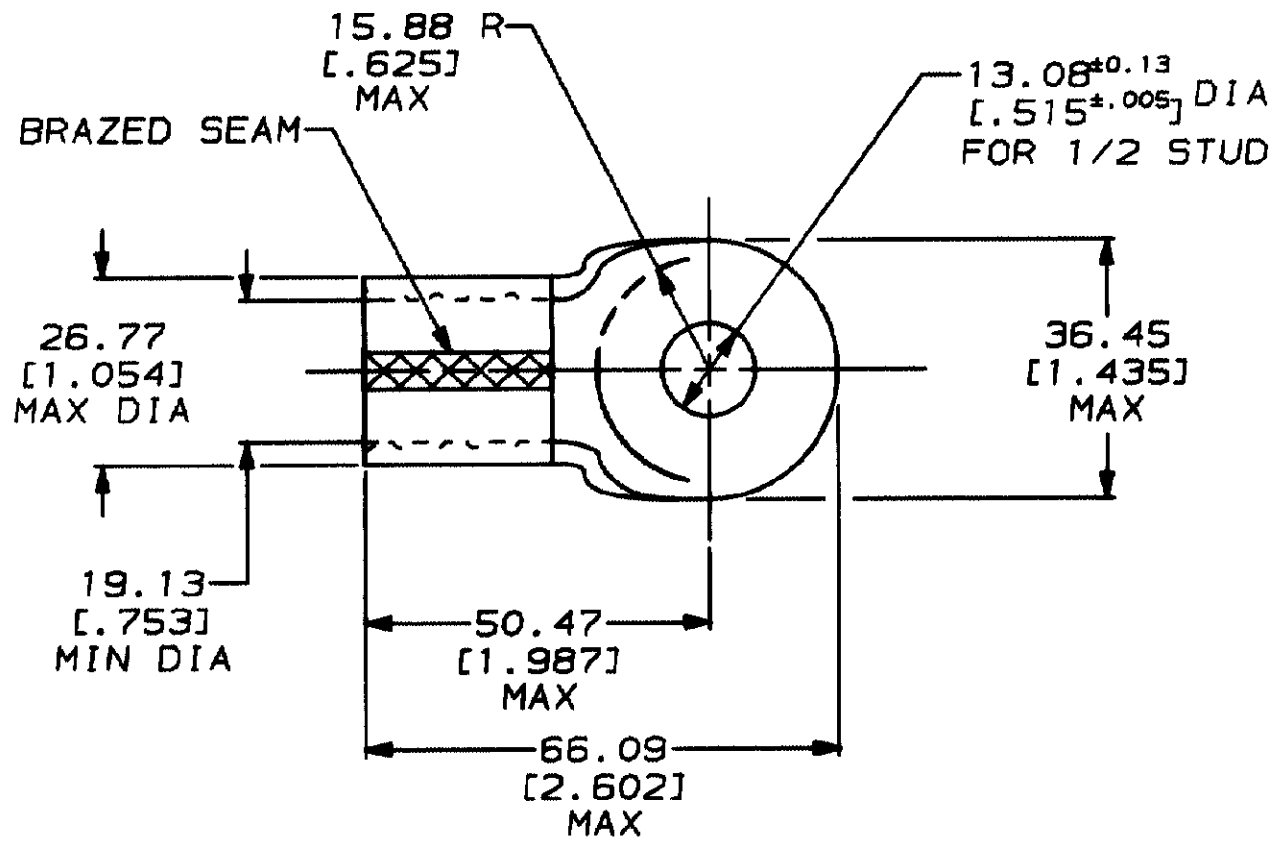

322254
PART NO

DO NOT SCALE PRINT. UNLESS SPECIFIED DIMENSIONS IN mm (IN) TOLERANCES ON:  
 2 PLC DEC ± 0.20(.008)  
 3 PLC DEC ± -  
 ANGLES ± -

MATERIAL  
 COPPER ASTM B-152 ANNEALED

FINISH  
 TIN PLATE  
 0.00254(.000100) MIN THK PER MIL-T-10727

DR 6/12/92  
 DK SCHUM

CHK 6/26/92  
 RD HEIN

APPD 6/26/92  
 AJ KAUFMAN

APPD 6/26/92  
 CR RHOADS

PRODUCT SPEC  
 -

APPLICATION SPEC  
 -

WEIGHT -

**AMP** AMP Incorporated  
 Harrisburg, PA 17105-3608

NAME  
 TERMINAL, RING TONGUE, SOLISTRAND™  
 WIRE SIZE: 127.0-152.0mm<sup>2</sup> [250-300] MCM

SIZE <b>A</b>	CAGE CODE 00779	DRAWING NO <b>C-322254</b>
SCALE 1:1	SHEET 1 of 1	

AMP 1489-32 REV 3-92

12 JUN 1992 10:22:16 AMP26463 <U5128A>DEPT1123>DWG1123>U. SOL 1STRAND>U. MCM CUSTOMER DRAWING

单击下面可查看定价，库存，交付和生命周期等信息

[>>TE Connectivity\(泰科\)](#)