

THIS DRAWING IS UNPUBLISHED. RELEASED FOR PUBLICATION
 © COPYRIGHT BY TYCO ELECTRONICS CORPORATION. ALL RIGHTS RESERVED.

LOC	DIST	REVISIONS			
P	LTR	DESCRIPTION	DATE	DWN	APVD
AD	25	H1	REVISED PER ECO-07-018173	13AUG07	DH DB

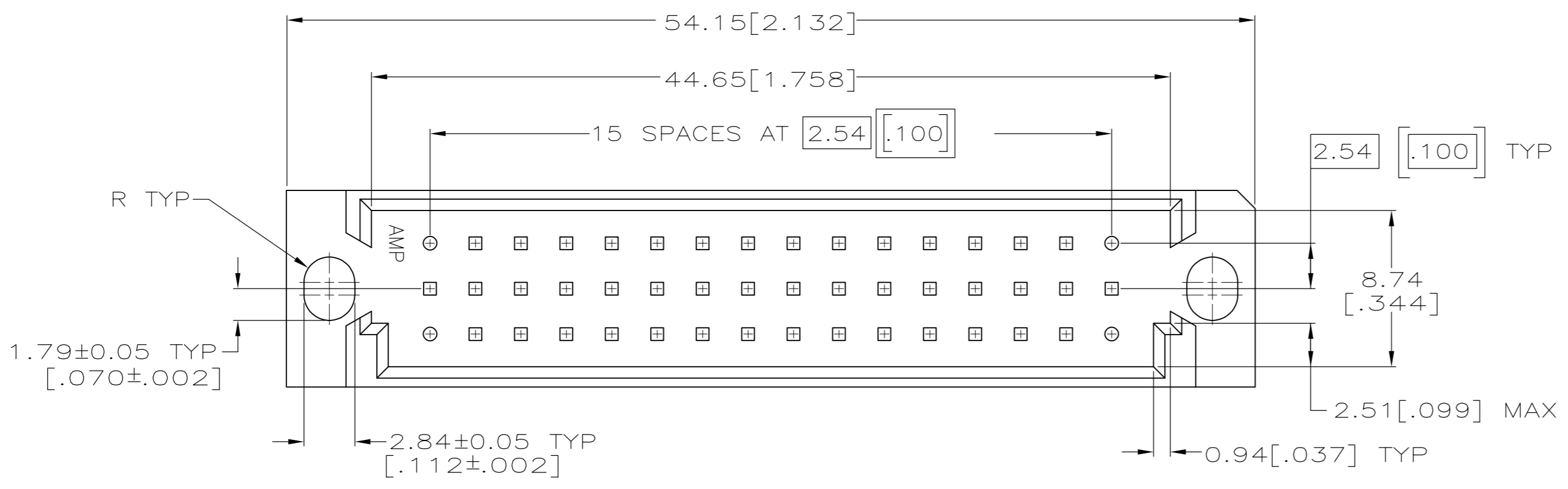

- ① HOUSING MATERIAL: GLASS-FILLED POLYESTER. COLOR: GRAY.
- ② INTERFERENCE CAVITIES LOCATED AT POSITIONS 1,16 IN ROWS "A" AND "C".
- ③ AMP PART NUMBER MOLDED IN THIS APPROXIMATE AREA.

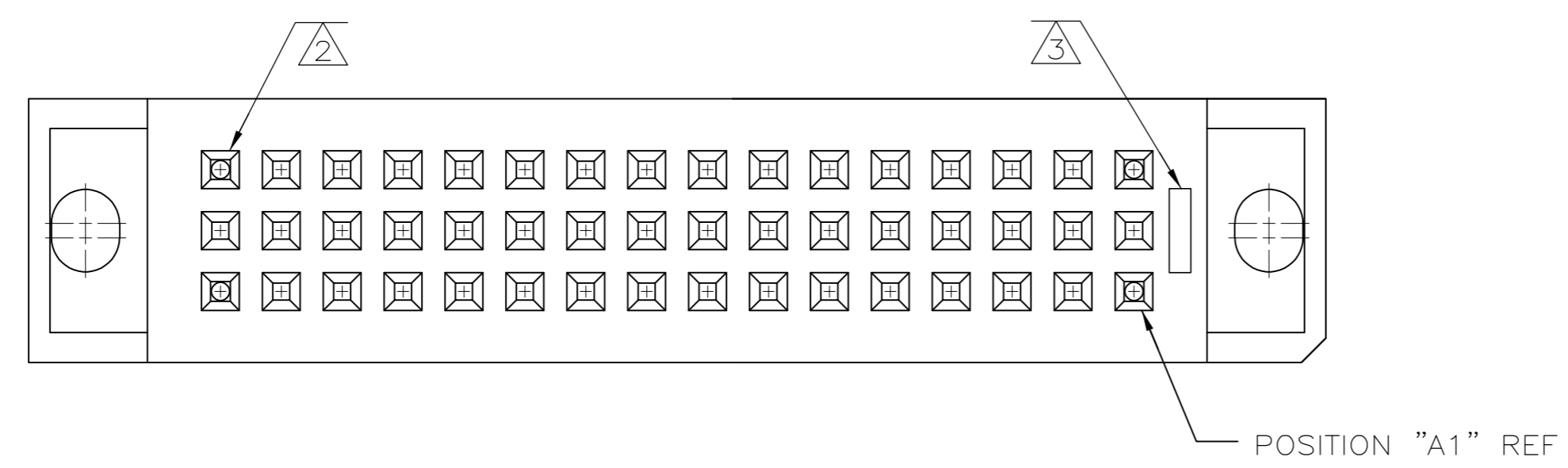
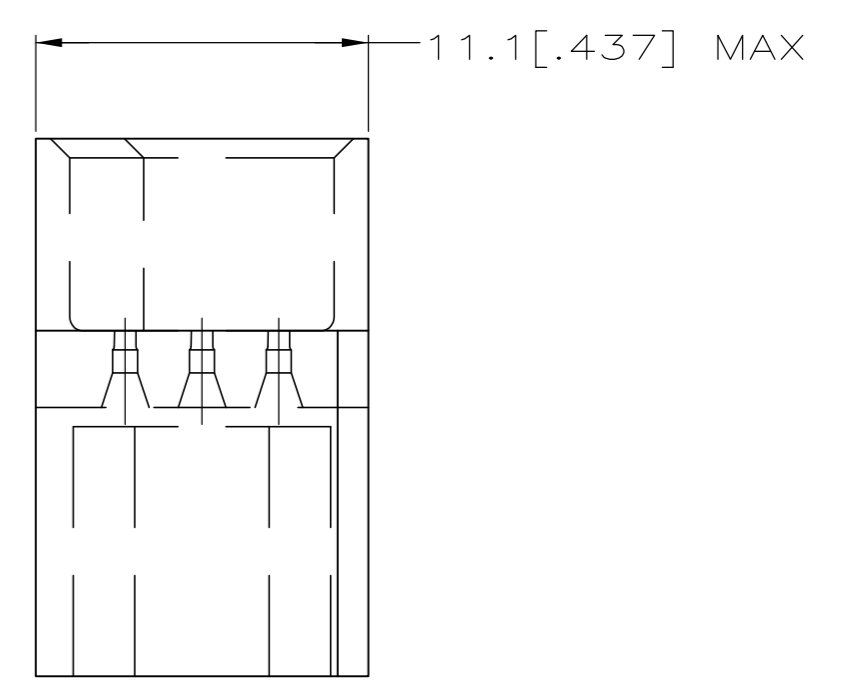
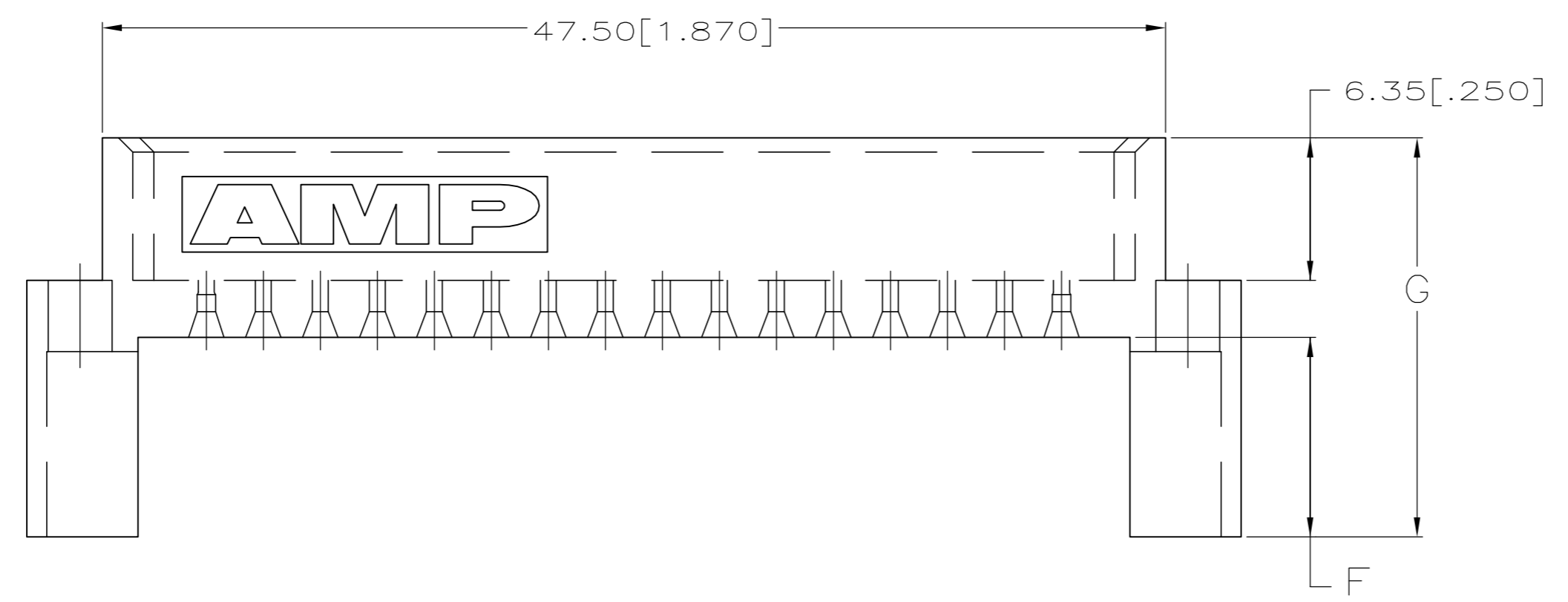

OBSOLETE	17.78 [.700]	8.89 [.350]	-	-	650437-2
	13.08 [.515]	4.19 [.165]	13.23 [.521]	1.57 [.062]	650437-1
	G	F	CONNECTOR TAIL LENGTH	PC BOARD THK	PART NUMBER

THIS DRAWING IS A CONTROLLED DOCUMENT.

DWN	L. BRINER	10/26/89
CHK	J. HUNT	9/23/93
APVD	-	-
PRODUCT SPEC	-	-
APPLICATION SPEC	-	-
WEIGHT	-	-
CUSTOMER DRAWING	SCALE 4:1	SHEET 1 OF 1

TOLERANCES UNLESS OTHERWISE SPECIFIED:

0 PLC	±	-
1 PLC	±	-
2 PLC	±	-
3 PLC	±	0.13 [.005]
4 PLC	±	-
ANGLES	±	-
FINISH	±	-

MATERIAL: ①

NAME: SHROUD, EUROCARD WITH MOUNTING HOLES

SIZE: A2 CAGE CODE: 00779 DRAWING NO: C-650437 RESTRICTED TO: -

650437

A

单击下面可查看定价，库存，交付和生命周期等信息

[>>TE Connectivity\(泰科\)](#)